



IN REPLY REFER TO:

UNITED STATES
DEPARTMENT OF THE INTERIOR
GEOLOGICAL SURVEY
P. O. Drawer U
Artesia, New Mexico

September 27, 1963

Cactus Drilling Company
P. O. Box 1826
Hobbs, New Mexico

Re: New Mexico 01167
Expiring September 30, 1963

Gentlemen:

Your Notice of Intention to Drill well No. 1 Sealey (copy attached) in the NE $\frac{1}{4}$ SE $\frac{1}{4}$, sec. 5, T. 19 S., R. 31 E., N.M.P.M., Eddy County, New Mexico to a depth of 3,700 feet to test the Queen-Grayburg formations is hereby approved subject to compliance with the provisions of the Oil and Gas Operating Regulations and subject to the following conditions:

1. Drilling operations so authorized are subject to the attached sheet for general conditions of approval.
2. A daily progress report is to be furnished in duplicate from spud date until completion of the well.
3. Drilling rig must not be moved from well without prior approval from the Survey (30 CFR 221.34c).

Very truly yours,

Wade Scott James A. Knapp

James A. Knapp
District Engineer

P.S.: If the lease is to be considered for extension by diligent drilling operations, the lease rental must be timely paid.

RECEIVED

SEP 30 1963

D. C. C.
ARTESIA, OFFICE

UNITED STATES
DEPARTMENT OF THE INTERIOR
GEOLOGICAL SURVEY



RECEIVED

NOV 10 1917

WASHINGTON

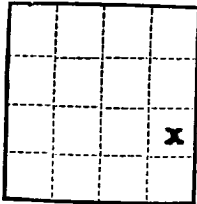

(SUBMIT IN TRIPLICATE)

UNITED STATES
DEPARTMENT OF THE INTERIOR
GEOLOGICAL SURVEY

Land Office New MexicoLease No. NM 01167Unit I

SUNDRY NOTICES AND REPORTS ON WELLS

NOTICE OF INTENTION TO DRILL	<input checked="" type="checkbox"/>	SUBSEQUENT REPORT OF WATER SHUT-OFF	
NOTICE OF INTENTION TO CHANGE PLANS		SUBSEQUENT REPORT OF SHOOTING OR ACIDIZING	
NOTICE OF INTENTION TO TEST WATER SHUT-OFF		SUBSEQUENT REPORT OF ALTERING CASING	
NOTICE OF INTENTION TO RE-DRILL OR REPAIR WELL		SUBSEQUENT REPORT OF RE-DRILLING OR REPAIR	
NOTICE OF INTENTION TO SHOOT OR ACIDIZE		SUBSEQUENT REPORT OF ABANDONMENT	
NOTICE OF INTENTION TO PULL OR ALTER CASING		SUPPLEMENTARY WELL HISTORY	
NOTICE OF INTENTION TO ABANDON WELL			

(INDICATE ABOVE BY CHECK MARK NATURE OF REPORT, NOTICE, OR OTHER DATA)

September 27, 1963

Well No. 1 is located 2310 ft. from N line and 660 ft. from E line of sec. 5NE/4SE/4
($\frac{1}{4}$ Sec. and Sec. No.)19 S
(Twp.)31 E
(Range)NMPM
(Meridian)Shugart
(Field)Eddy
(County or Subdivision)New Mexico
(State or Territory)

Furnish later

The elevation of the derrick floor above sea level is ft.

DETAILS OF WORK

(State names of and expected depths to objective sands; show sizes, weights, and lengths of proposed casings; indicate mudding jobs, cementing points, and all other important proposed work)

Well designated as Seeley Federal #1.

We propose to drill this well with cable tools from 0 to Total Depth of 3700 feet using the following pipe program:

Hole	Pipe	Depth	Cement
10"	8-5/8"	850'	50' sx
8"	5-1/2"	3700'	150' sx

Elevation: 3583.0 Ground Level.

I understand that this plan of work must receive approval in writing by the Geological Survey before operations may be commenced.

Company Cactus Drilling CompanyAddress Box 1826, Hobbs, New MexicoBy Geo. W. BakerTitle Vice-President

RECEIVED
SEP 27 1963
U. S. GEOLOGICAL SURVEY
ALBUQUERQUE, NEW MEXICO

NEW MEXICO OIL CONSERVATION COMMISSION WELL LOCATION AND ACREAGE DEDICATION PLAT

FORM C-128
Revised 5/1/57

SEE INSTRUCTIONS FOR COMPLETING THIS FORM ON THE REVERSE SIDE

SECTION A

Operator CACTUS DRILLING CO.		Lease SEELEY SEELEY FEDERAL		Well No. 1
Unit Letter 1	Section 5	Township 19 SOUTH	Range 31 EAST	County EDDY
Actual Surface Location of Well: 2310 feet from the SOUTH line and 660 feet from the EAST line				
Ground Level Elev. 3583.0	Producing Formation Queen Grayburg	Pool Shugart	Dedicated Acreage: 40 Acres	

1. Is the Operator the only owner in the dedicated acreage outlined on the plat below? YES ☒ NO ☐ ("Owner" means the person who has the right to drill into and to produce from any pool and to appropriate the production either for himself or for himself and another. (65-3-29 (a) NMSA 1955 Comp.)
2. If the answer to question one is "no," have the interests of all the owners been consolidated by a written agreement or otherwise? YES ☐ NO ☐ . If answer is "yes," Type of Consolidation _____
3. If the answer to question one is "no," list all the owners and their respective interests below:

Owner	Land Description

SECTION B

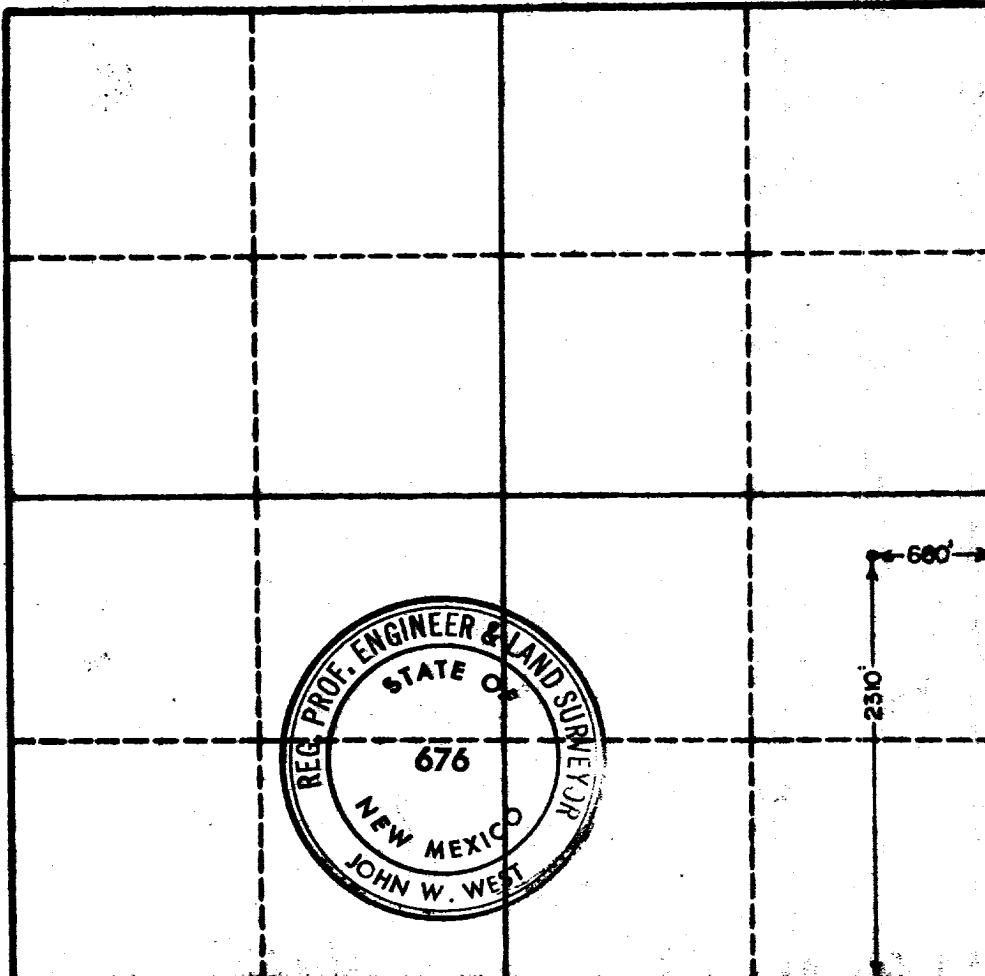

CERTIFICATION

I hereby certify that the information in SECTION A above is true and complete to the best of my knowledge and belief.

Name
Position Geologist
Company Cactus Drilling Co
Date Sept 27, 1963

I hereby certify that the well location shown on the plat in SECTION B was plotted from field notes of actual surveys made by me or under my supervision, and that the same is true and correct to the best of my knowledge and belief.

Date Surveyed 9-26-63
Registered Professional Engineer and/or Land Surveyor, JOHN W. WEST
JOHN W. WEST P.E. & L.S. NO. 676

0 230 460 690 920 1150 1380 1610 1840 2070 2300 2530 2760 2990 3220 3450 3680 3910 4140 4370 4600 4830 5060 5290 5520 5750 5980 6210 6440 6670 6900 7130 7360 7590 7820 8050 8280 8510 8740 8970 9200 9430 9660 9890 10120 10350 10580 10810 11040 11270 11500 11730 11960 12190 12420 12650 12880 13110 13340 13570 13800 14030 14260 14490 14720 14950 15180 15410 15640 15870 16100 16330 16560 16790 17020 17250 17480 17710 17940 18170 18400 18630 18860 19090 19320 19550 19780 20010 20240 20470 20700 20930 21160 21390 21620 21850 22080 22310 22540 22770 23000