

Form 9-331a
(Feb. 1951)Budget Bureau No. 42-R358.4.
Form Approved.

(SUBMIT IN TRIPLICATE)

UNITED STATES
DEPARTMENT OF THE INTERIOR
GEOLOGICAL SURVEY

Land Office _____

Lease No. **W-025778-A**

Unit _____

SUNDRY NOTICES AND REPORTS ON WELLS

NOTICE OF INTENTION TO DRILL	<input checked="" type="checkbox"/>	SUBSEQUENT REPORT OF WATER SHUT-OFF	
NOTICE OF INTENTION TO CHANGE PLANS		SUBSEQUENT REPORT OF SHOOTING OR ACIDIZING	
NOTICE OF INTENTION TO TEST WATER SHUT-OFF		SUBSEQUENT REPORT OF ALTERING CASING	
NOTICE OF INTENTION TO RE-DRILL OR REPAIR WELL		SUBSEQUENT REPORT OF RE-DRILLING OR REPAIR	
NOTICE OF INTENTION TO SHOOT OR ACIDIZE		SUBSEQUENT REPORT OF ABANDONMENT	
NOTICE OF INTENTION TO PULL OR ALTER CASING		SUPPLEMENTARY WELL HISTORY	
NOTICE OF INTENTION TO ABANDON WELL			

(INDICATE ABOVE BY CHECK MARK NATURE OF REPORT, NOTICE, OR OTHER DATA)

Corrected Form. 9-331a, submitted November 18, 1963
showed incorrect location.

November 20, 1963

Federal Kechane et al "C"

Well No. **2** is located **2310** ft. from **[N]** line and **330** ft. from **[E]** line of sec. **28****SE 1/4, NE 1/4, Sec 28****18-3****31-E****NMPM**

(1/4 Sec. and Sec. No.)

(Twp.)

(Range)

(Meridian)

Shogart**Kodj****New Mexico**

(Field)

(County or Subdivision)

(State or Territory)

The elevation of the derrick floor above sea level is _____ ft.

DETAILS OF WORK

(State names of and expected depths to objective sands; show sizes, weights, and lengths of proposed casings; indicate mudding jobs, cementing points, and all other important proposed work)

It is proposed to drill to approximately 5200' with Rotary Tools and complete in the Delaware sand.

Hole Size	Csg. Size	Wt./Ft.	New or SH	Depth	Comment
11"	8-5/8"	21#	New	700	Circulate * 550 Sacks
7-7/8"	5-1/2"	17#	SH	5200	

* Base of Salt.

I understand that this plan of work must receive approval in writing by the Geological Survey before operations may be commenced.

Company **Gulf Oil Corporation**Address **Box 670,**
Hobbs, New MexicoBy **C. E. BORLAND**
Area Production Manager

NEW MEXICO OIL CONSERVATION COMMISSION
WELL LOCATION AND ACREAGE DEDICATION PLAT

FORM C-128
Revised 5/1/57

SEE INSTRUCTIONS FOR COMPLETING THIS FORM ON THE REVERSE SIDE

SECTION A

Operator GULF OIL CORPORATION		Lease FEDERAL KECHANE ET AL "C"		Well No. 2
Unit Letter H	Section 28	Township 18 SOUTH	Range 31 EAST	County EDDY
Actual Footage Location of Well: 2310 feet from the NORTH line and 330 feet from the EAST line				
Ground Level Elev.	Producing Formation Delaware	Pool Singleton Delaware	Dedicated Acreage: 40 Acres	

1. Is the Operator the only owner in the dedicated acreage outlined on the plat below? YES **XX** NO ____ . ("Owner" means the person who has the right to drill into and to produce from any pool and to appropriate the production either for himself or for himself and another. (65-3-29 (e) NMSA 1935 Comp.)
2. If the answer to question one is "no," have the interests of all the owners been consolidated by communitization agreement or otherwise? YES ____ NO ____ . If answer is "yes," Type of Consolidation ____
3. If the answer to question two is "no," list all the owners and their respective interests below:

Owner	Land Description

SECTION B

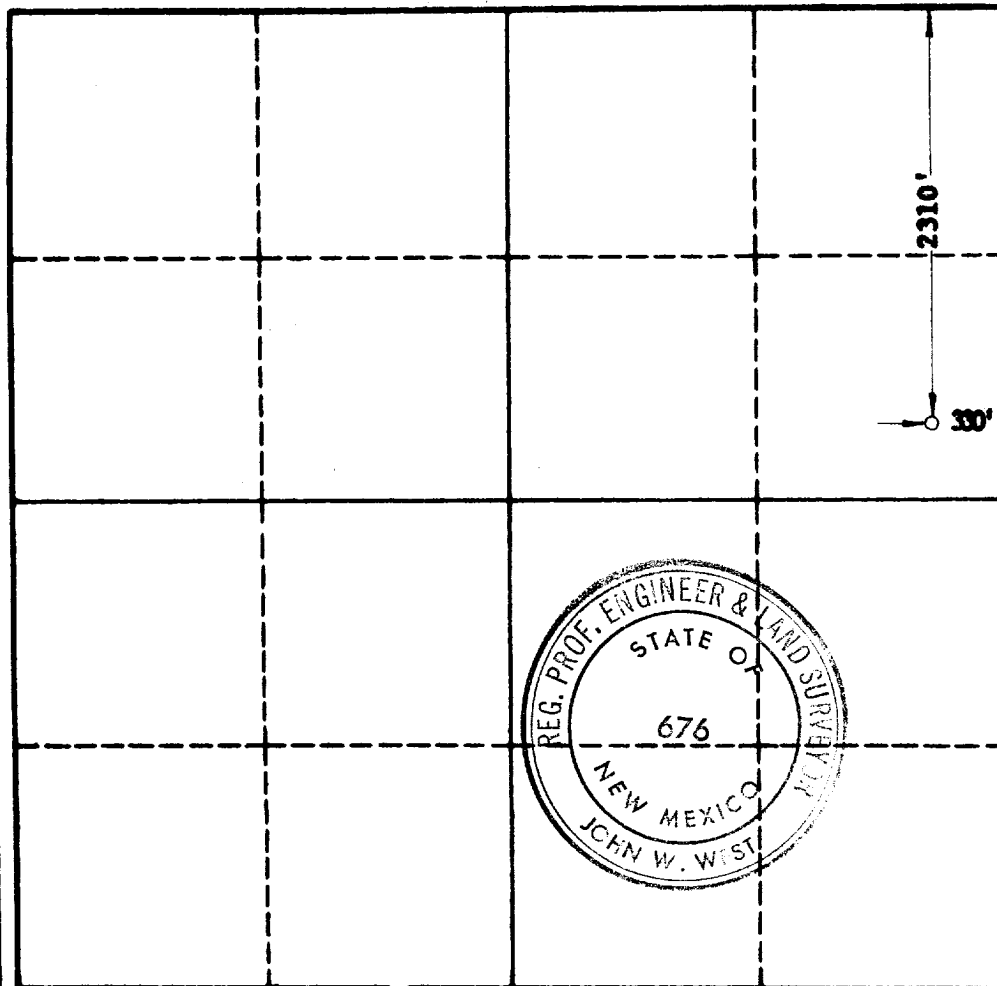

CERTIFICATION

I hereby certify that the information in SECTION A above is true and complete to the best of my knowledge and belief.

Name **ORIGINAL SIGNED BY**
C. D. BORLAND

Position
Area Production Manager

Company
Gulf Oil Corporation

Date
November 18, 1963

I hereby certify that the well location shown on the plat in SECTION B was plotted from field notes of actual surveys made by me or under my supervision, and that the same is true and correct to the best of my knowledge and belief.

Date Surveyed
11-12-63

Registered Professional Engineer and/or Land Surveyor, **JOHN W. WEST**

John W. West

Certificate No.
N. M. - P. E. & L. S. NO. 676

0 330 660 990 1320 1650 1980 2310 2640 2000 1500 1000 500