

NO. OF COPIES RECEIVED	6
DISTRIBUTION	
SANTA FE	1
FILE	1
U.S.G.S.	2
LAND OFFICE	
OPERATOR	2

# NEW MEXICO OIL CONSERVATION COMMISSION

Form C-101  
Revised 1-1-65

4A. Indicate Type of Lease	
STATE <input type="checkbox"/>	FFE <input checked="" type="checkbox"/>
5. State Oil & Gas Lease No.	

## APPLICATION FOR PERMIT TO DRILL, DEEPEN, OR PLUG BACK

1a. Type of Work		7. Unit Agreement Name	
b. Type of Well DRILL <input checked="" type="checkbox"/> RE-ENTRY DEEPEN <input type="checkbox"/> PLUG BACK <input type="checkbox"/>		8. Farm or Lease Name Santa Fe	
c. Type of Well OIL WELL <input type="checkbox"/> GAS WELL <input checked="" type="checkbox"/> OTHER <input type="checkbox"/>		Land Improvement Co.	
2. Name of Operator Ernest A. Hanson		9. Well No. 1	
3. Address of Operator P. O. Box 1515, Roswell, New Mexico		10. Field and Pool, or Wildcat Wildcat	
4. Location of Well UNIT LETTER C LOCATED 660 FEET FROM THE North LINE AND 1980 FEET FROM THE West LINE OF SEC. 17 TWP. 19-S RGE. 26-E NMPM		12. County Eddy	
19. Proposed Depth 9400'		19A. Formation Morrow sd.	
20. Rotary or C.T. Rotary		21. Elevations (Show whether DF, RT, etc.) 3385' GL	
21A. Kind & Status Plug. Bond Statewide		21B. Drilling Contractor Leatherwood Drlg.	
22. Approx. Date Work will start 8-25-67			

## PROPOSED CASING AND CEMENT PROGRAM

SIZE OF HOLE	SIZE OF CASING	WEIGHT PER FOOT	SETTING DEPTH	SACKS OF CEMENT	EST. TOP
7-7/8"	8-5/8"	17#	1338'	760	Circulated
	5-1/2"		9400'	250	8600'

This well was originally drilled as the McFarland Corp. - #1 Santa Fe Land Improvement Co. It is proposed to re-enter the captioned well with a rotary rig and clean out the old hole to 6400 feet, set a whipstock, and drill a new 7-7/8" hole to 9350 feet. 5-1/2", 17#, J-55 casing will be set and cemented at 9350 feet with 250 sacks. The Morrow sand will then be drilled in with tubing and air, and completed open hole.

RECEIVED

APPROVAL VALID  
FOR 90 DAYS UNLESS  
DRILLING COMMENCED,

AUG 28 1967

EXPIRES 11-27-67

O. C. C.  
ARTESIA, OFFICE

IN ABOVE SPACE DESCRIBE PROPOSED PROGRAM: IF PROPOSAL IS TO DEEPEN OR PLUG BACK, GIVE DATA ON PRESENT PRODUCTIVE ZONE AND PROPOSED NEW PRODUCTIVE ZONE. GIVE BLOWOUT PREVENTER PROGRAM, IF ANY.

I hereby certify that the information above is true and complete to the best of my knowledge and belief.

Signed George A. Hanson Title Exploration Manager Date 8-14-67

(This space for State Use)

APPROVED BY W. A. Gressett TITLE DATE 8-14-67

CONDITIONS OF APPROVAL, IF ANY:

NE EXICO OIL CONSERVATION COMMISSIC  
WELL LOCATION AND ACREAGE DEDICATION PLAT

Form C-102  
Supersedes C-128  
Effective 1-1-65

All distances must be from the outer boundaries of the Section.

Operator <b>Ernest A. Hanson</b>			Lease <b>Santa Fe Land Improvement Co</b>		Well No. <b>1</b>
Unit Letter <b>C</b>	Section <b>17</b>	Township <b>T-19-S</b>	Range <b>R-26-E</b>	County <b>Eddy</b>	
Actual Footage Location of Well: <b>660</b> feet from the <b>North</b> line and <b>1980</b> feet from the <b>West</b> line					
Ground Level Elev. <b>3385'</b>	Producing Formation <b>Morrow sand</b>		Pool <b>Wildcat</b>	Dedicated Acreage: <b>320</b> Acres	

1. Outline the acreage dedicated to the subject well by colored pencil or hachure marks on the plat below.
2. If more than one lease is dedicated to the well, outline each and identify the ownership thereof (both as to working interest and royalty).
3. If more than one lease of different ownership is dedicated to the well, have the interests of all owners been consolidated by communitization, unitization, force-pooling, etc?

☐ Yes ☐ No If answer is "yes," type of consolidation AUG 13 1967

If answer is "no," list the owners and tract descriptions which have actually been consolidated. (Use reverse side of this form if necessary.) ARTESIA, OFFSHORE

No allowable will be assigned to the well until all interests have been consolidated (by communitization, unitization, forced-pooling, or otherwise) or until a non-standard unit, eliminating such interests, has been approved by the Commission.

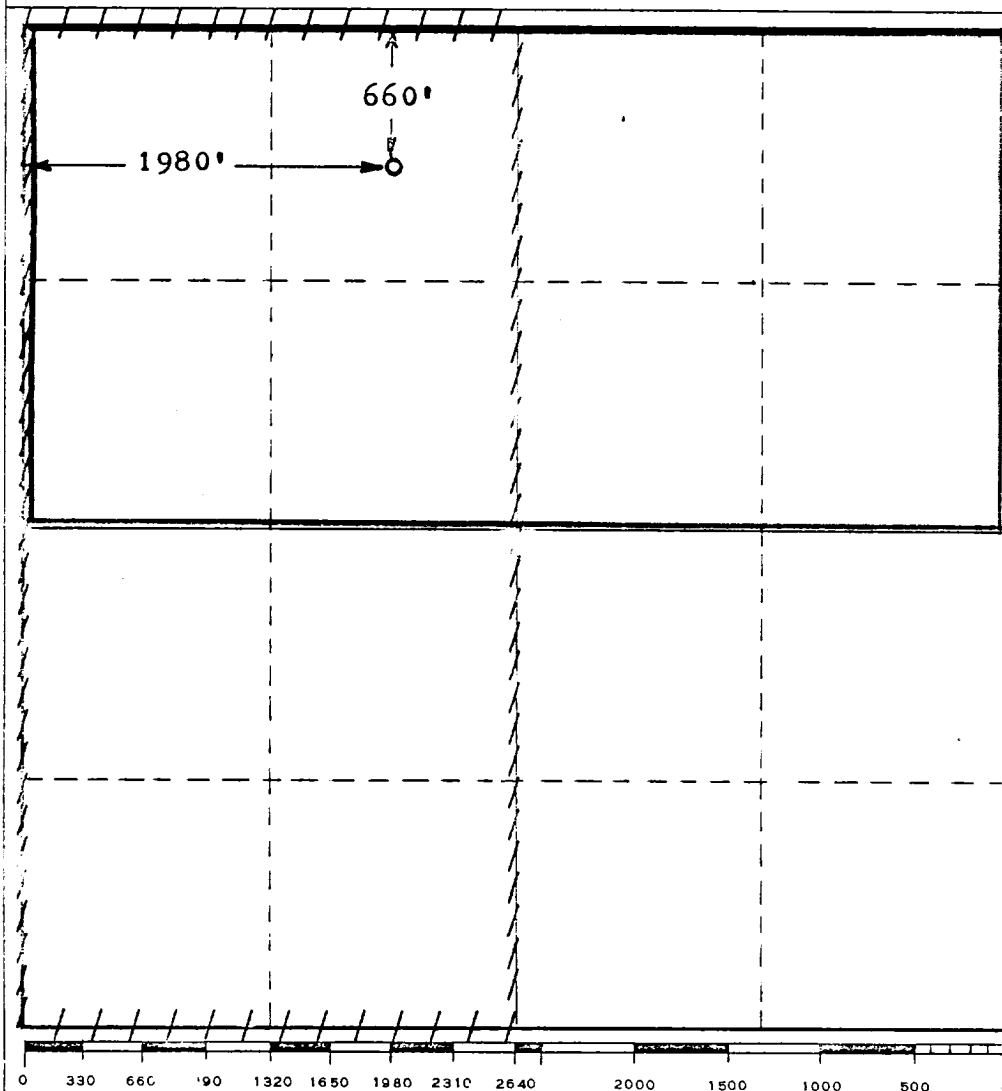

CERTIFICATION

I hereby certify that the information contained herein is true and complete to the best of my knowledge and belief.

Name Ernest A. Hanson  
Position Exploration Manager  
Company Ernest A. Hanson  
Date August 14, 1967

I hereby certify that the well location shown on this plat was plotted from field notes of actual surveys made by me or under my supervision, and that the same is true and correct to the best of my knowledge and belief.

Date Surveyed August 14, 1967  
Registered Professional Engineer and/or Land Surveyor Ernest A. Hanson  
Certificate No. 751