

REQUEST FOR (OIL) - ~~(GAS)~~ ALLOWABLE

New Well
~~XXXXXXXXXX~~

This form shall be submitted by the operator before an initial allowable will be assigned to any completed Oil or Gas well. Form C-104 is to be submitted in QUADRUPLICATE to the same District Office to which Form C-101 was sent. The allowable will be assigned effective 7:00 A.M. on date of completion or recompletion, provided this form is filed during calendar month of completion or recompletion. The completion date shall be that date in the case of an oil well when new oil is delivered into the stock tanks. Gas must be reported on 15.025 psia at 60° Fahrenheit.

Midland, Texas

11-20-64

(Place)

(Date)

WE ARE HEREBY REQUESTING AN ALLOWABLE FOR A WELL KNOWN AS:

MONSANTO COMPANY

Hondo

Well No. 1

in NE

NW

(Company or Operator)

(Lease)

C

Sec. 31

T. 19S

R. 25E

NMPM, Wildcat (Upper Penn)

Pool

Unit Letter

Eddy

County. Date Spudded. 9-15-64

Date Drilling Completed 11-5-64

Elevation 3568' RKB

Total Depth 9300

PBTD 7790'

Please indicate location:

Top Oil/Gas Pay 7577'

Name of Prod. Form. Upper Penn

PRODUCING INTERVAL -

Perforations 7759'-7776'

Open Hole None

Depth Casing Shoe 7898'

Depth Tubing 7759'

OIL WELL TEST -

Natural Prod. Test: 0 bbls. oil, 3 bbls water in 3 hrs, 0 min. Size Swab

Test After Acid or Fracture Treatment (after recovery of volume of oil equal to volume of load oil used): 75 bbls. oil, 100 bbls water in 5 hrs, 0 min. Size 3 1/2" 64"

GAS WELL TEST -

Natural Prod. Test: MCF/Day; Hours flowed Choke Size

Tubing, Casing and Cementing Record

Method of Testing (pitot, back pressure, etc.):

Test After Acid or Fracture Treatment: MCF/Day; Hours flowed

Choke Size Method of Testing:

Acid or Fracture Treatment (Give amounts of materials used, such as acid, water, oil, and sand): Acidized Upper Penn. w/500 gal. mud acid.

Casing Press. 2800 Tubing Press. 2800 Date first new oil run to tanks November 17, 1964

Oil Transporter The Permian Corporation

Gas Transporter None

Remarks:

NOV 23 1964

O. C. C.

ARTESIA, OFFICE

I hereby certify that the information given above is true and complete to the best of my knowledge.

Approved. NOV 23 1964, 19

MONSANTO COMPANY

(Company or Operator)

By:

(Signature)

Title

District Engineer

Send Communications regarding well to:

Name MONSANTO COMPANY ATTN: Prod. Dept

Address Drawer 1829, Midland, Texas

OIL CONSERVATION COMMISSION

By:

Title

Oil and Gas Inspector

OIL CONSERVATION COMMISSION	
ARTESIA DISTRICT OFFICE	
No. Copy of Record	5
DISPOSITION	
COPIES DESTROYED	
COPIES	2
ORIGINALS	1
REPRODUCED	1
OTHER	
U. S. G. O.	
RECEIVED	
FILE	1 -
BUREAU OF LANDS	

NEW MEXICO OIL CONSERVATION COMMISSION
WELL LOCATION AND ACREAGE DEDICATION PLAT

FORM C-128
Revised 5/1/57

SEE INSTRUCTIONS FOR COMPLETING THIS FORM ON THE REVERSE SIDE

SECTION A

Operator MONSANTO COMPANY		Lease Hondo		Well No. 1
Unit Letter C	Section 31	Township 19S	Range 25E	County Eddy
Actual Footage Location of Well: 660 feet from the North line and 1980 feet from the West line				
Ground Level Elev. 3551'	Producing Formation Upper Penn	Pool Wilcoat	Dedicated Acreage: 40 Acres	

1. Is the Operator the only owner in the dedicated acreage outlined on the plat below? YES ☒ NO ____ . ("Owner" means the person who has the right to drill into and to produce from any pool and to appropriate the production either for himself or for himself and another. (65-3-29 (e) NMSA 1935 Comp.)
2. If the answer to question one is "no," have the interests of all the owners been consolidated by communitization agreement or otherwise? YES ____ NO ____ . If answer is "yes," Type of Consolidation **RECEIVED**
3. If the answer to question two is "no," list all the owners and their respective interests below:

Owner	Land Description NOV 23 1964
	O. C. C. ARTESIA, OFFICE

SECTION B

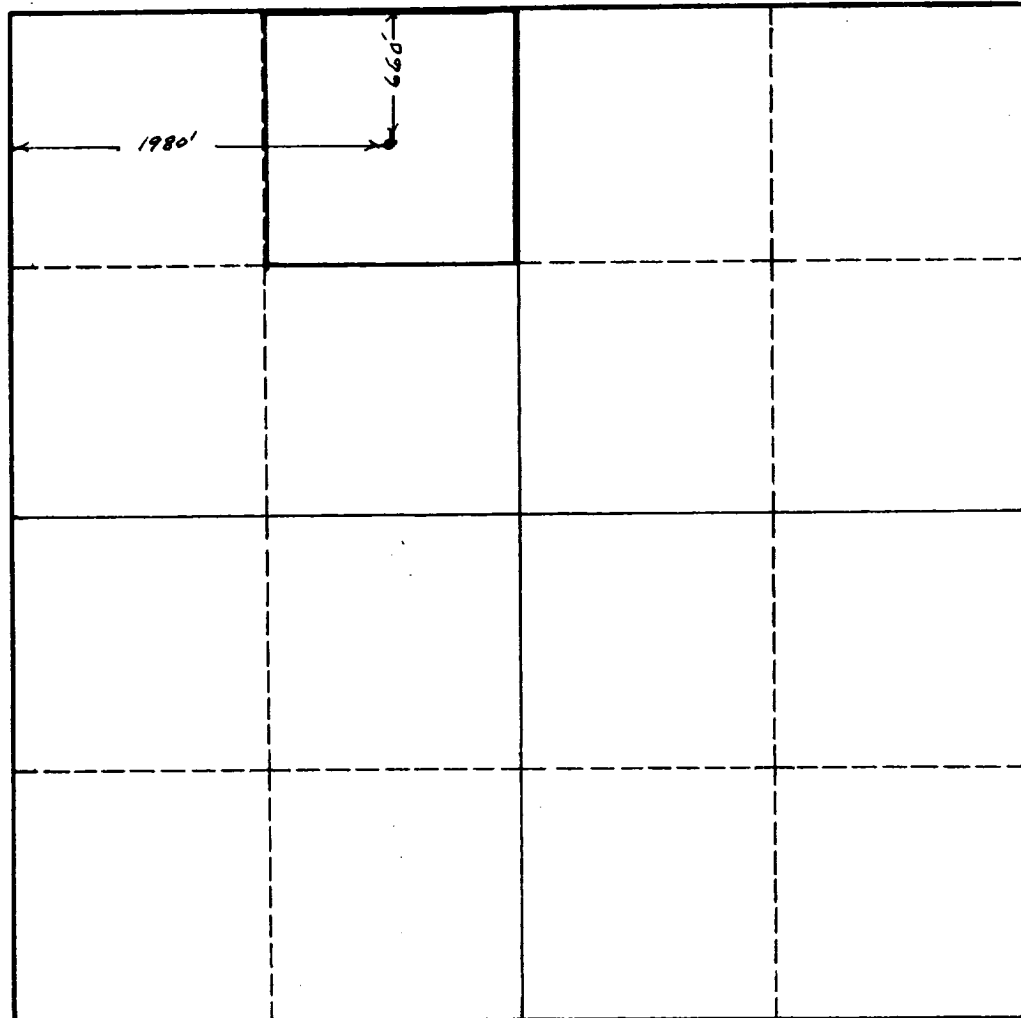

CERTIFICATION

I hereby certify that the information in SECTION A above is true and complete to the best of my knowledge and belief.

Name
P. G. Anderson

Position
Dist Eng

Company
MONSANTO COMPANY

Date
11-20-64

I hereby certify that the well location shown on the plat in SECTION B was plotted from field notes of actual surveys made by me or under my supervision, and that the same is true and correct to the best of my knowledge and belief.

Date Surveyed

Registered Professional Engineer
and/or Land Surveyor

Certificate No.

0 330 660 990 1320 1650 1980 2310 2640 2000 1500 1000 500 0

INSTRUCTIONS FOR COMPLETION OF FORM C-128

1. Operator shall furnish and certify to the information called for in Section A.
2. Operator shall outline the dedicated acreage for *both* oil and gas wells on the plat in Section B.
3. A registered professional engineer or land surveyor registered in the State of New Mexico or approved by the Commission shall show on the plat the location of the well and certify this information in the space provided.
4. All distances shown on the plat must be from the outer boundaries of the Section.
5. If additional space is needed for listing owners and their respective interests as required in question 3 of Section A, please use space below.

OIL CONSERVATION COMMISSION		
ARTISTIA DISTRICT OFFICE		
No. Copies Received	3	
EXHIBITION		
	NO.	EST. NO.
COUNTY		
SANTA FE	/	
LOCATION		
STATE LAND		
U. S. G. S.	/	
TRANSFER		
FILE	/-	
BUREAU OF LANDS		

MONSANTO COMPANY
HYDROCARBONS DIVISION
602 W. MISSOURI
MIDLAND, TEXAS 79704

RECEIVED

NOV 23 1964

O. O. C.
ARTESIA, OFFICE

November 20, 1964

New Mexico Oil Conservation Commission
Drawer DD
Artesia, New Mexico ✓

Gentlemen:

The following is a tabulation of the deviation tests conducted while drilling our Hondo No. 1 well located in NE/4 of NW/4 of Section 31, T-19S, R-25E, Eddy County, New Mexico which has been completed as an oil well from the Upper Penn formation.

<u>Depth</u>	<u>Deviation from the Vertical</u> (Degrees)
553'	1/2
700'	3/4
1139'	2 1/4
1264'	2
1500'	1 3/4
2025'	1 3/4
2580'	2
3635'	2
4065'	2 1/4
4370'	1 1/2
4870'	2 1/2
5151'	3 1/4
5646'	3 3/4
6205'	2 1/2
6665'	2 1/2
7330'	1
8070'	3/4
8308'	1
8875'	1
9300'	1 TOTAL DEPTH

I, A. W. Wood, being first duly sworn on oath, state that I have knowledge of the facts and matter herein set forth and that the same are true and correct.

Name A. W. Wood
Title Regional Production Supt.

Subscribed and sworn to before me this 20th day of November, 1964.

C. L. Fly
Notary Public Midland County, Texas

10-1-1942
10-1-1942
10-1-1942
10-1-1942

OIL CONSERVATION COMMISSION		
ATC DISTRICT OFFICE		
No. Copies Distributed 3		
DATE 10-1-1942		
	1	RECEIVED
EX-100		
SALES	1	
OPERATING	1	
STATE LAWS		
U.S. G.		
PAID		
RECEIVED	1	
SUPPLY		

NEW MEXICO OIL CONSERVATION COMMISSION
SANTA FE, NEW MEXICO

Form G-110
Revised 7/1/55

(File the original and 4 copies with the appropriate district office)

CERTIFICATE OF COMPLIANCE AND AUTHORIZATION
TO TRANSPORT OIL AND NATURAL GAS

Company or Operator Monsanto Company Lease Hondo

Well No. 1 Unit Letter C S 31 T 195 R 25E Pool Wildcat (Upper Penn)

County Eddy Kind of Lease (State, Fed. or Patented) Federal

If well produces oil or condensate, give location of tanks: Unit C S 31 T 195 R 25E

Authorized Transporter of Oil or ~~Condensate~~ The Permian Corporation

Address P. O. Box 3119, Midland, Texas

(Give address to which approved copy of this form is to be sent)

Authorized Transporter of Gas None

Address _____ Date Connected _____

(Give address to which approved copy of this form is to be sent)

If Gas is not being sold, give reasons and also explain its present disposition:

No gas pipe line in area. Gas is being flared.

Reasons for Filing: (Please check proper box) New Well (x)

Change in Transporter of (Check One): Oil () Dry Gas () C'head () Condensate ()

Change in Ownership () Other ()

Remarks: (Give explanation below)

RECEIVED

NOV 23 1964

O. C. C.
ARTESIA, OFFICE

The undersigned certifies that the Rules and Regulations of the Oil Conservation Commission have been complied with.

Executed this the 20 day of Nov 19 64

By J. E. Anderson

Approved NOV 23 1964 19

Title Dist. Eng

OIL CONSERVATION COMMISSION

Company Monsanto Company

By M. L. Armstrong

Address P.O. Drawer 1829

Title Oil and Gas Inspector

Midland, Texas

5

DISTRIBUTION	
OFFICER	REMARKS
1	
2	
3	
4	
5	
6	
7	
8	
9	
10	
11	
12	
13	
14	
15	
16	
17	
18	
19	
20	
21	
22	
23	
24	
25	
26	
27	
28	
29	
30	
31	
32	
33	
34	
35	
36	
37	
38	
39	
40	
41	
42	
43	
44	
45	
46	
47	
48	
49	
50	
51	
52	
53	
54	
55	
56	
57	
58	
59	
60	
61	
62	
63	
64	
65	
66	
67	
68	
69	
70	
71	
72	
73	
74	
75	
76	
77	
78	
79	
80	
81	
82	
83	
84	
85	
86	
87	
88	
89	
90	
91	
92	
93	
94	
95	
96	
97	
98	
99	
100	