

NEW MEXICO OIL CONSERVATION COMMISSION
WELL LOCATION AND ACREAGE DEDICATION PLAT

FORM C-128
Revised 5/1/57

SEE INSTRUCTIONS FOR COMPLETING THIS FORM ON THE REVERSE SIDE

SECTION A

Operator TENNECO OIL COMPANY			Lease JONES FED. "E"		Well No. 1
Unit Letter H	Section 23	Township 19 SOUTH	Range 31 EAST	County EDDY	
Actual Footage Location of Well: 1980 feet from the NORTH line and 660 feet from the EAST line					
Ground Level Elev. 3920 ft.	Producing Formation Strawn	Pool Indefinite		Dedicated Acreage: 10 Acres	

1. Is the Operator the only owner in the dedicated acreage outlined on the plat below? YES ☒ NO ☐ ("Owner" means the person who has the right to drill into and to produce from any pool and to appropriate the production either for himself or for himself and another. (65-3-29 (e) NMSA 1935 Comp.)
2. If the answer to question one is "no," have the interests of all the owners been consolidated by communization agreement or otherwise? YES ☐ NO ☐ If answer is "yes," Type of Consolidation **RECEIVED**
3. If the answer to question two is "no," list all the owners and their respective interests below:

Owner	Land Description NOV 16 1964
O. C. C. ARTESIA, OFFICE	

SECTION B

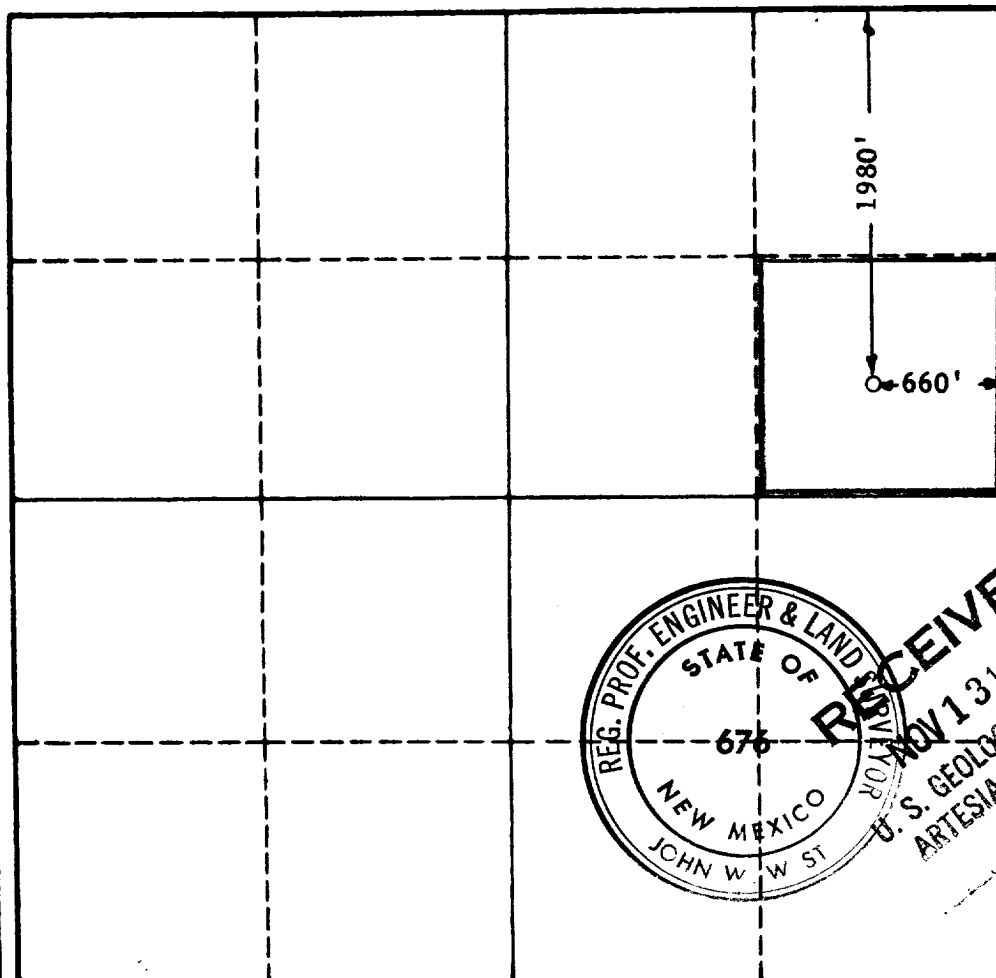

CERTIFICATION

I hereby certify that the information in SECTION A above is true and complete to the best of my knowledge and belief.

Name **A.W. Lang**
Position **Dist. Prod. Superintendent**
Company **Tenneco Oil Company**
Date **11-11-64**

I hereby certify that the well location shown on the plat in SECTION B was plotted from field notes of actual survey made by me or under my supervision, and that the same is true and correct to the best of my knowledge and belief.

Date Surveyed
NOV. 7, 1964
Registered Professional Engineer and/or Land Surveyor, **JOHN W. WEST**
Certificate No. **676**
N.M. - P.E. & L.S. NO. 676