



IN REPLY REFER TO:

UNITED STATES  
DEPARTMENT OF THE INTERIOR  
GEOLOGICAL SURVEY  
F. O. Stader 1057  
Roswell, New Mexico

to RECEIVED  
copy 57.  
JAN 23 1964

January 22, 1964

O. C. C.  
ARTESIA, OFFICE

Yates Petroleum Corp.  
309 Carper Bldg.  
Artesia, New Mexico

Gentlemen:

Your Notice of Intention to Drill well No. 3 Perkins "AD" (copy attached) in the SW 1/4 sec. 5, T. 19 S., R. 30 E., N.M.P.M., Eddy County, New Mexico, lease New Mexico 01144, to a depth of 3,200 feet to test the Grayburg formation, has been forwarded to this office for approval.

Pursuant to authority delegated to the Regional Oil and Gas Supervisor on May 10, 1962, 27 F.R. 4814, I hereby approve the Notice of Intention to Drill described in the foregoing subject to the following conditions:

1. Drilling operations so authorized are subject to the attached sheet for general conditions of approval.
2. A daily progress report is to be furnished in duplicate from spud date until completion of the well.
3. Drilling rig must not be moved from well without prior approval from the Survey (30 CFR 221.34c).

If the lease is to be considered for extension by diligent drilling operations, the lease rental must be timely paid.

Very truly yours,

CARL C. TBAYWICK  
Acting Oil & Gas Supervisor

Attachment

Copy to: Washington  
Mining Branch (2)  
NMOCC-Artesia (2) (w/2 cys Notice) -  
Artesia  
Roswell (2)

JAKnauf:hb 1/20/64

UNITED STATES  
DEPARTMENT OF THE INTERIOR  
BUREAU OF LAND MANAGEMENT

WASH. D. C.

10-10707-10-10707-10

( )  
The following information is being furnished to you for your information and use only. It is not to be used for any other purpose without the express written consent of the Bureau of Land Management.

The following information is being furnished to you for your information and use only. It is not to be used for any other purpose without the express written consent of the Bureau of Land Management.

The following information is being furnished to you for your information and use only. It is not to be used for any other purpose without the express written consent of the Bureau of Land Management.

The following information is being furnished to you for your information and use only. It is not to be used for any other purpose without the express written consent of the Bureau of Land Management.

The following information is being furnished to you for your information and use only. It is not to be used for any other purpose without the express written consent of the Bureau of Land Management.

( ) The following information is being furnished to you for your information and use only. It is not to be used for any other purpose without the express written consent of the Bureau of Land Management.

Very truly yours,

Special Agent in Charge

( )  
( )  
( )  
( )

10-10707-10-10707-10

UNITED STATES  
DEPARTMENT OF THE INTERIOR  
GEOLOGICAL SURVEY

## APPLICATION FOR PERMIT TO DRILL, DEEPEN, OR PLUG BACK

## 1a. TYPE OF WORK

DRILL ☒DEEPEN ☐PLUG BACK ☐

## b. TYPE OF WELL

OIL  
WELL ☒GAS  
WELL ☐OTHER ☐SINGLE  
ZONE ☐MULTIPLE  
ZONE ☐

## 2. NAME OF OPERATOR

Yates Petroleum Corporation

## 3. ADDRESS OF OPERATOR

309 Carper Bldg., Artesia, New Mexico

## 4. LOCATION OF WELL (Report location clearly and in accordance with any State requirements.\*)

At surface

1980' FWL &amp; 330 FWL Sec. 5 - 19 E - 30 E

At proposed prod. zone

Yates, Queen Penrose and upper Grayburg Sand

## 14. DISTANCE IN MILES AND DIRECTION FROM NEAREST TOWN OR POST OFFICE\*

## 15. DISTANCE FROM PROPOSED\*

LOCATION TO NEAREST  
PROPERTY OR LEASE LINE, FT.  
(Also to nearest drlg. line, if any)

## 18. DISTANCE FROM PROPOSED LOCATION\*

TO NEAREST WELL, DRILLING, COMPLETED,  
OR APPLIED FOR, ON THIS LEASE, FT.

## 16. NO. OF ACRES IN LEASE

2520.45

## 19. PROPOSED DEPTH

3200'

17. NO. OF ACRES ASSIGNED  
TO THIS WELL

40

## 20. ROTARY OR CABLE TOOLS

Cable

## 21. ELEVATIONS (Show whether DF, RT, GR, etc.)

3392 GL

## 22. APPROX. DATE WORK WILL START\*

1-24-64

## 23.

## PROPOSED CASING AND CEMENTING PROGRAM

SIZE OF HOLE	SIZE OF CASING	WEIGHT PER FOOT	SETTING DEPTH	QUANTITY OF CEMENT
12"	8 5/8"	240	450	Circulate to surface
8"	5 1/2"	140	total depth	Circulate to surface

IN ABOVE SPACE DESCRIBE PROPOSED PROGRAM: If proposal is to deepen or plug back, give data on present productive zone and proposed new productive zone. If proposal is to drill or deepen directionally, give pertinent data on subsurface locations and measured and true vertical depths. Give blowout preventer program, if any.

## 24.

SIGNED

Richard C. Norman

TITLE

Geologist

DATE

January 18, 1964

(This space for Federal or State office use)

PERMIT NO.

APPROVAL DATE

APPROVED BY

TITLE

DATE

CONDITIONS OF APPROVAL, IF ANY:

\*See Instructions On Reverse Side

## Instructions

**General:** This form is designed for submitting proposals to perform certain well operations, as indicated, on all types of lands and leases for appropriate action by either a Federal or a State agency, or both, pursuant to applicable Federal and/or State laws and regulations. Any necessary special instructions concerning the use of this form and the number of copies to be submitted, particularly with regard to local, area, or regional procedures and practices, either are shown below or will be issued by, or may be obtained from, the local Federal and/or State office.

**Item 1:** If the proposal is to redrill to the same reservoir at a different subsurface location or to a new reservoir, use this form with appropriate notations. Consult applicable State or Federal regulations concerning subsequent work proposals or reports on the well.

**Item 4:** If there are no applicable State requirements, locations on Federal or Indian land should be described in accordance with Federal requirements. Consult local State or Federal office for specific instructions.

**Item 14:** Needed only when location of well cannot readily be found by road from the land or lease description. A plat, or plats, separate or on this reverse side, showing the roads to, and the surveyed location of, the well, and any other required information, should be furnished when required by Federal or State agency offices.

**Items 15 and 18:** If well is to be, or has been directionally drilled, give distances for subsurface location of hole in any present or objective production zone.

**Item 22:** Consult applicable Federal or State regulations, or appropriate officials, concerning approval of the proposal before operations are started.

NUMBER OF COPIES RECEIVED	
DISTRIBUTION	
SANTA FE	
FILE	
U.S.G.S.	
LAND OFFICE	
TRANSPORTER	OIL GAS
PRODUCTION OFFICE	
OPERATOR	

**NEW MEXICO OIL CONSERVATION COMMISSION**  
**WELL LOCATION AND ACREAGE DEDICATION PLAT**  
 SEE INSTRUCTIONS FOR COMPLETING THIS FORM ON THE REVERSE SIDE

FORM C-128  
 Revised 5/1/57

**SECTION A**

Operator <b>Yates Petroleum Corporation</b>			Lease <b>Perkins-AD</b>		Well No. <b>3</b>
Unit Letter <b>E</b>	Section <b>5</b>	Township <b>19 South</b>	Range <b>30 East</b>	County <b>Eddy</b>	
Actual Footage Location of Well: <b>3392</b> feet from the <b>W</b> line and <b>1980</b> feet from the <b>N</b> line					
Ground Level Elev. <b>3342</b>	Producing Formation		Pool	Dedicated Acreage: <b>40</b> Acres	

1. Is the Operator the only owner in the dedicated acreage outlined on the plat below? YES \_\_\_\_\_ NO \_\_\_\_\_. ("Owner" means the person who has the right to drill into and to produce from any pool and to appropriate the production either for himself or for himself and another. (65-3-29 (e) NMSA 1935 Comp.)
2. If the answer to question one is "no," have the interests of all the owners been consolidated by communitization agreement or otherwise? YES \_\_\_\_\_ NO \_\_\_\_\_. If answer is "yes," Type of Consolidation \_\_\_\_\_
3. If the answer to question two is "no," list all the owners and their respective interests below:

Owner	Land Description

**SECTION B**

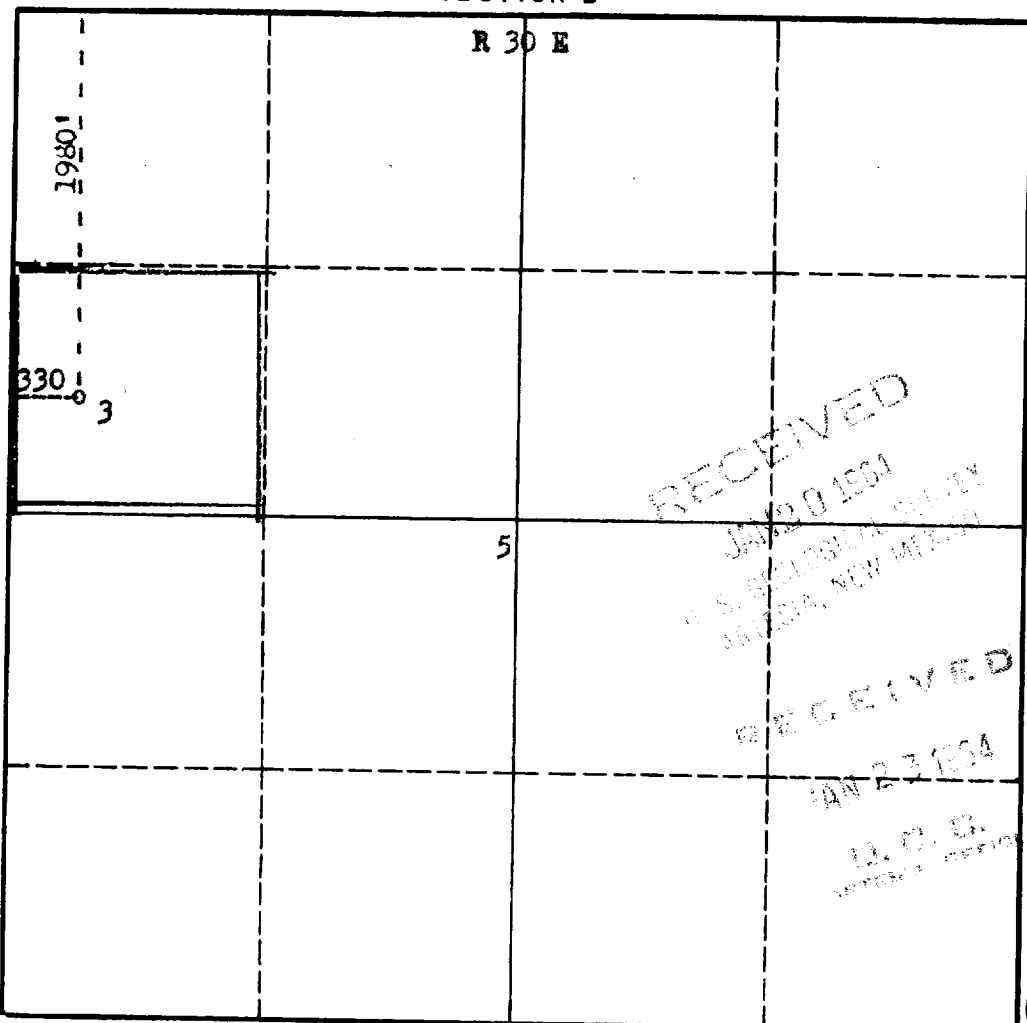

**CERTIFICATION**

I hereby certify that the information in SECTION A above is true and complete to the best of my knowledge and belief.

*Richard C. Norman*  
 Name

Position  
**Geologist**

Company  
**Yates Petroleum Corp.**

Date  
**January 18, 1964**

I hereby certify that the well location shown on the plat in SECTION B was plotted from field notes of actual surveys made by me or under my supervision, and that the same is true and correct to the best of my knowledge and belief.

Date Surveyed  
**January 17, 1964**

Registered Professional Engineer  
 and/or Land Surveyor

*James H. Brown*  
 Certificate No.  
**N.M.L.S. No. 542**

0 330 660 990 1320 1650 1980 2310 2640 2000 1500 1000 500

## INSTRUCTIONS FOR COMPLETION OF FORM C-128

1. Operator shall furnish and certify to the information called for in Section A.
2. Operator shall outline the dedicated acreage for *both* oil and gas wells on the plat in Section B.
3. A registered professional engineer or land surveyor registered in the State of New Mexico or approved by the Commission shall show on the plat the location of the well and certify this information in the space provided.
4. All distances shown on the plat must be from the outer boundaries of the Section.
5. If additional space is needed for listing owners and their respective interests as required in question 3 of Section A, please use space below.