

UNITED STATES
DEPARTMENT OF THE INTERIOR
GEOLOGICAL SURVEY

APPLICATION FOR PERMIT TO DRILL, DEEPEN, OR PLUG BACK

1a. TYPE OF WORK

DRILL ☒DEEPEN ☐PLUG BACK ☐

b. TYPE OF WELL

OIL
WELL ☐GAS
WELL ☒

OTHER

MAR 18 1966

SINGLE
ZONE ☒MULTIPLE
ZONE ☐

2. NAME OF OPERATOR

Texas Oil & Gas Corp.

O. C. C.

3. ADDRESS OF OPERATOR

ARTESIA, OFFICE

209 Vaughn Building, Amarillo, Texas

4. LOCATION OF WELL (Report location clearly and in accordance with any State requirements.)*

At surface

2310' FNL, 990' FEL, Sec 15, T-20-S, R-20-E

At proposed prod. zone Chaves County, New Mexico

Same As Above

14. DISTANCE IN MILES AND DIRECTION FROM NEAREST TOWN OR POST OFFICE*

12 Miles West of Hope, New Mexico

15. DISTANCE FROM PROPOSED*

LOCATION TO NEAREST

PROPERTY OR LEASE LINE, FT.

(Also to nearest drlg. line, if any)

990'

16. NO. OF ACRES IN LEASE

568.8

17. NO. OF ACRES ASSIGNED

TO THIS WELL

640

18. DISTANCE FROM PROPOSED LOCATION*

TO NEAREST WELL, DRILLING, COMPLETED,
OR APPLIED FOR, ON THIS LEASE, FT.

1st Well

19. PROPOSED DEPTH

7500'

20. ROTARY OR CABLE TOOLS.

Rotary

21. ELEVATIONS (Show whether DF, RT, GR, etc.)

EST 4800' GL

22. APPROX. DATE WORK WILL START*

March 15, 1966

23.

PROPOSED CASING AND CEMENTING PROGRAM

SIZE OF HOLE	SIZE OF CASING	WEIGHT PER FOOT	SETTING DEPTH	QUANTITY OF CEMENT
17 1/2"	13 3/8"	48#	120'	175 SX
12 1/4"	8 5/8"	24#	1600'	1000 SX
7 7/8"	4 1/2"	9.5#, 10.5#, 11.6#	7500'	200 SX

1. Drill 17 1/2" hole to approximately 120', set conductor casing and circulate cement.
2. Drill 12 1/4" hole to approximately 1600' or a depth sufficient to penetrate the Glorieta, set 8 5/8" and circulate cement. If cement will not circulate, squeeze cement with 1" macaroni string.
3. Drill to TD of 7500' or sufficient depth to test Devonian with 7 7/8" bit. Set and cement 4 1/2" casing through productive zone.
4. Use hydraulic BOP throughout drilling of well.

IN ABOVE SPACE DESCRIBE PROPOSED PROGRAM: If proposal is to deepen or plug back, give data on present productive zone and proposed new productive zone. If proposal is to drill or deepen directionally, give pertinent data on subsurface locations and measured and true vertical depths. Give blowout preventer program, if any.

24.

SIGNED

M. W. Woodard

TITLE District Engineer

DATE March 10, 1966

(This space for Federal or State office use)

PERMIT NO.

APPROVAL DATE

APPROVED

COMMITTEE OF APPROVAL, IF ANY:

MAR 16 1966

H. L. BELMONT
ACTING DISTRICT ENGINEER

DECLARED WATER BACK

CEMENT BEHIND THE
CASING MUST BE CIRCULATEDNOTIFY USGS IN SUFFICIENT TIME TO
WITNESS CEMENTING THE DATE

*See Instructions On Reverse Side

NEW MEXICO OIL CONSERVATION COMMISSION
WELL LOCATION AND ACREAGE DEDICATION PLAT

Form No. 1
Revised 1-1-66
Effective 1-1-66

Owner: <u>TEXAS OIL & GAS CORP.</u>		Date: <u>FEB. 11, 1966</u>		Well No.: <u>1</u>	
Section: <u>10</u>	Range: <u>20 SOUTH</u>	Range: <u>20 EAST</u>	County: <u>CRAVES</u>		
North: <u>990</u>		East: <u>990</u>		Section: <u>10</u>	
West: <u>990</u>		East: <u>990</u>		Section: <u>10</u>	
North: <u>990</u>		East: <u>990</u>		Section: <u>10</u>	
West: <u>990</u>		East: <u>990</u>		Section: <u>10</u>	
North: <u>990</u>		East: <u>990</u>		Section: <u>10</u>	
West: <u>990</u>		East: <u>990</u>		Section: <u>10</u>	
North: <u>990</u>		East: <u>990</u>		Section: <u>10</u>	
West: <u>990</u>		East: <u>990</u>		Section: <u>10</u>	

1. Outline the acreage dedicated to the subject well by colored pencil or hatchure marks on the plat below.
2. If more than one lease is dedicated to the well, outline each and identify the ownership thereof (both as to working interest and royalty).
3. If more than one lease of different ownership is dedicated to the well, have the interests of all owners been consolidated by communitization, unitization, force-pooling, etc?

RECEIVED

MAR 18 1966

Yes ☒ No ☐ If answer is "yes," type of consolidation Parmout

If answer is "No," list the owners and tract descriptions which have actually been consolidated. (If so reverse side of this form if necessary.)

No additional work will be assigned to the well until all interests have been consolidated (by communitization, unitization, force-pooling, or otherwise) or until a non-standard unit, eliminating such interests, has been approved by the Commission.

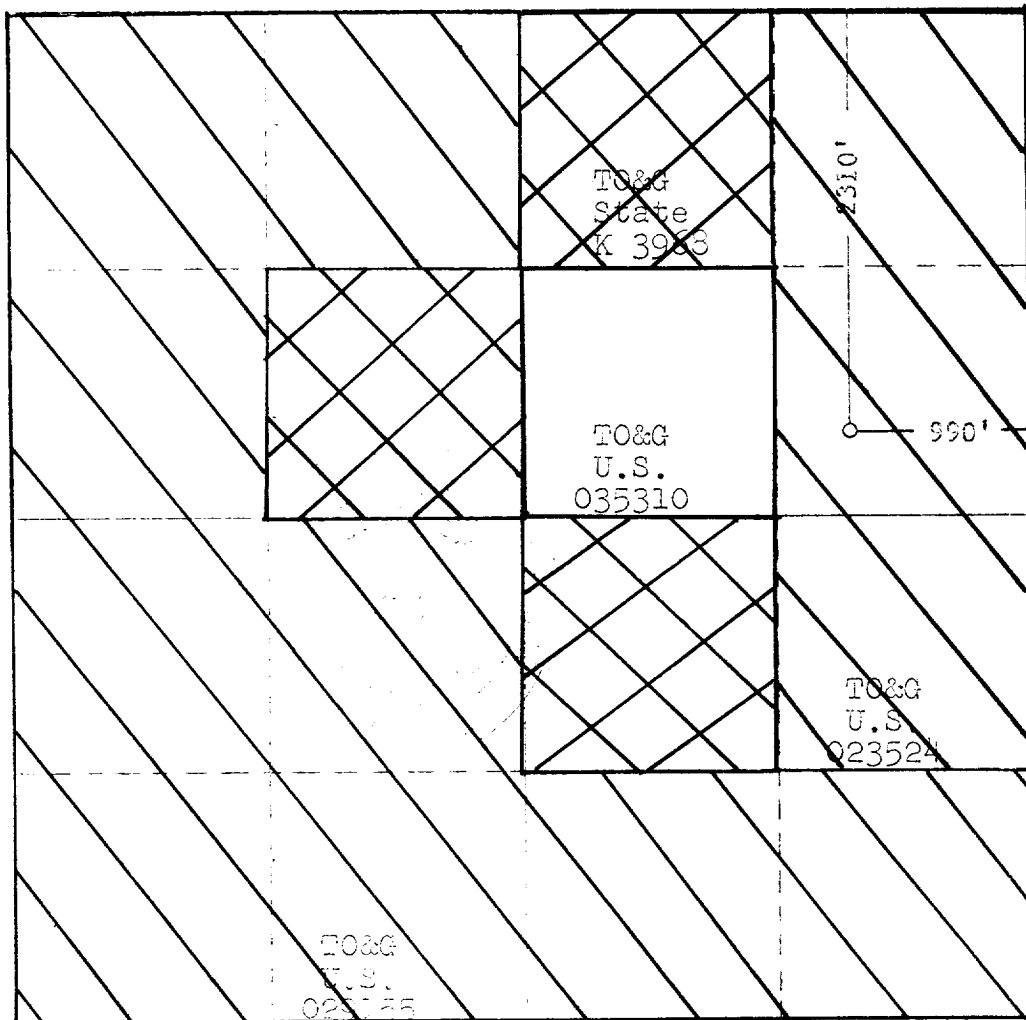

CERTIFICATION

I hereby certify that the information contained herein is true and complete to the best of my knowledge and belief.

Max W. Woodard

Max W. Woodard

District Engineer

Texas Oil & Gas Corp.

Date:

March 8, 1966

March 8, 1966

I hereby certify that the well location shown on this plat was plotted from field notes of actual surveys made by me or under my supervision, and that the same is true and correct to the best of my knowledge and belief.

2-26-1966

Registered Professional Engineer and/or Land Surveyor

John W. Woodard
676