

Form 9-331a
(Rev. 1951)

(SUBMIT IN TRIPLICATE)

Land Office **New Mexico**

Lease No. **02447**

Unit **B1g Eddy**

RECEIVED

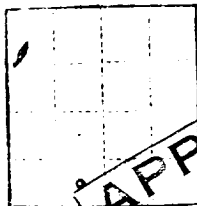

UNITED STATES
DEPARTMENT OF THE INTERIOR
GEOLOGICAL SURVEY

SUNDRY NOTICES AND REPORTS ON WELLS

NOTICE OF INTENTION TO DRILL	<input checked="" type="checkbox"/>	SUBSEQUENT REPORT OF WATER SHUT-OFF	<input type="checkbox"/>
NOTICE OF INTENTION TO CHANGE PLANS	<input type="checkbox"/>	SUBSEQUENT REPORT OF SHOOTING OR ACIDIZING	<input type="checkbox"/>
NOTICE OF INTENTION TO TEST WATER SHUT-OFF	<input type="checkbox"/>	SUBSEQUENT REPORT OF ALTERING CASING	<input type="checkbox"/>
NOTICE OF INTENTION TO RE-DRILL OR REPAIR WELL	<input type="checkbox"/>	SUBSEQUENT REPORT OF RE-DRILLING OR REPAIR	<input type="checkbox"/>
NOTICE OF INTENTION TO SHOOT OR ACIDIZE	<input type="checkbox"/>	SUBSEQUENT REPORT OF ABANDONMENT	<input type="checkbox"/>
NOTICE OF INTENTION TO PULL OR ALTER CASING	<input type="checkbox"/>	SUPPLEMENTARY WELL HISTORY	<input type="checkbox"/>
NOTICE OF INTENTION TO ABANDON WELL	<input type="checkbox"/>		

(INDICATE ABOVE BY CHECK MARK NATURE OF REPORT, NOTICE, OR OTHER DATA)

August 25, 1965

PERRY R. BASS - Sun-Tex Federal #1
Well No. 1 is located 660 ft. from [S] line and 1980 ft. from [W] line of sec. 27

SW 1/4 Sec. 27
(or Sec. 1 Sec. No.)
Lusk Strawn
(Field)

T-19-S
(Twp.)

R-31-E
(Range)

NMPN
(Meridian)

Eddy
(County or Subdivision)

New Mexico
(State or Territory)

*Not yet available.

The elevation of the derrick floor above sea level is * ft.

DETAILS OF WORK

(State names of and expected depths to objective sands; show sizes, weights, and lengths of proposed casings; indicate mudding jobs, cementing points, and all other important proposed work)

16" OD 65 #/ft. H-40 casing is to be set in 20" hole at 700', and cemented to the surface.
11-3/4" OD 47 #/ft. J-55 casing is to be set in 13-3/4" hole at 2600', and cemented back 200' from the bottom. This string will be pulled after setting the next string of casing.
8-5/8" OD casing, 24 #/ft., and 32 #/ft., is to be set at 4000', below Reef porosity, and cemented in two stages, with second stage being applied through stage collar at 2600', after pulling the 11-3/4" OD casing. 8-5/8" OD casing is to be cemented to the surface.
5 1/2" OD casing, 17 #/ft. & 20 #/ft. N-80, is to be set on bottom, and cemented in 7-7/8" hole with 450 sx, cementing the bottom of the casing from 12000' TD back to 10,000'.
Well is to be completed in the Pennsylvanian by gun-perforating the 5 1/2" OD casing opposite oil bearing zones, and stimulating as needed.

I understand that this plan of work must receive approval in writing by the Geological Survey before operations may be commenced.

Company **PERRY R. BASS**

Address **Box 1178**

Monahans, Texas

By *Walter D. Powers*
Asst. Div. Mgr.
Title

**MEXICO OIL CONSERVATION COMMISSION
WELL LOCATION AND ACREAGE DEDICATION PLAT**

Form C-102
Supersedes C-128
Effective 1-1-65

All distances must be from the outer boundaries of the Section.

Operator PERRY R. BASS			Lease SUN-TEX FED.		Well No. 1
Unit Letter N	Section 27	Township 19 SOUTH	Range 31 EAST	County EDDY	
Actual Footage Location of Well: 660 feet from the SOUTH line and 1980 feet from the WEST line					
Ground Level Elev.	Producing Formation STRAWN		Pool <i>under</i> LUSK STRAWN		Dedicated Acreage: 160 (SW 1/4) Acres

1. Outline the acreage dedicated to the subject well by colored pencil or hatchure marks on the plat below.
2. If more than one lease is dedicated to the well, outline each and identify the ownership thereof (both as to working interest and royalty).
3. If more than one lease of different ownership is dedicated to the well, have the interests of all owners been consolidated by communitization, unitization, force-pooling, etc?

☐ Yes ☐ No If answer is "yes," type of consolidation _____ **AUG 30 1965**

If answer is "no," list the owners and tract descriptions which have actually been consolidated. (Use reverse side of this form if necessary.) _____ **O. E. C. ARTESIA, OFFICE**

No allowable will be assigned to the well until all interests have been consolidated (by communitization, unitization, forced-pooling, or otherwise) or until a non-standard unit, eliminating such interests, has been approved by the Commission.

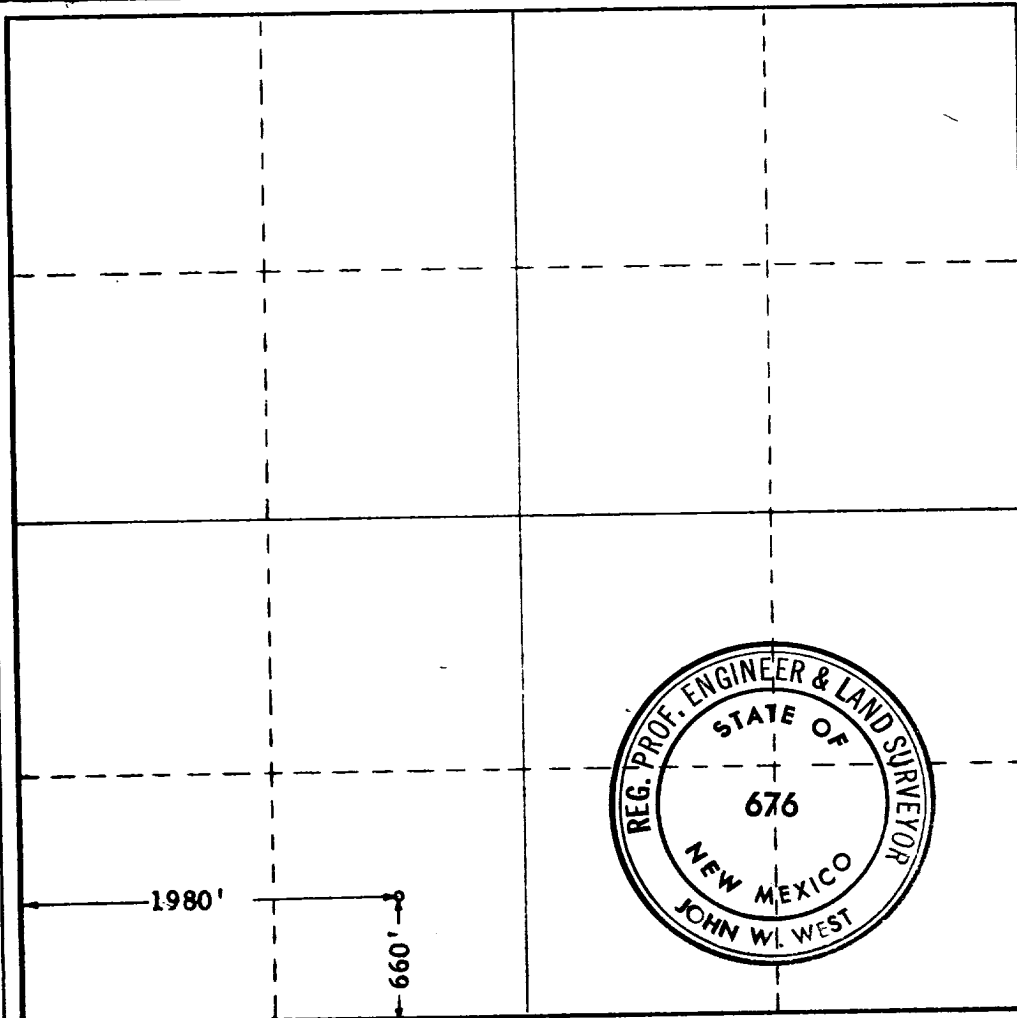

CERTIFICATION

I hereby certify that the information contained herein is true and complete to the best of my knowledge and belief.

Name
Archer L. Worley
Position
ENGINEER

Company
PERRY R. BASS, INC.

Date
8-26-1965

I hereby certify that the well location shown on this plat was plotted from field notes of actual surveys made by me or under my supervision, and that the same is true and correct to the best of my knowledge and belief.

Date Surveyed
8-25-65

Registered Professional Engineer and/or Land Surveyor

John W. West
Certificate No.

N. M. P. E. & L. S. No. 676

0 330 660 990 1320 1650 1980 2310 2640 2000 1500 1000 500 0