

NO. OF COPIES RECEIVED	9
DISTRIBUTION	
SANTA FE	1
FILE	1
U.S.G.S.	2
LAND OFFICE	7
OPERATOR	4

NEW MEXICO OIL & GAS COMMISSION  
**RECEIVED**  
 APPROVAL VALID  
 FOR 90 DAYS UNLESS  
 DRILLING COMMENCED, NOV 1 1966  
 EXPIRES 1-29-67 O. C. C.  
 ARTESIA, OFFICE

Form C-101  
 Revised 1-1-65

5A. Indicate Type of Lease
STATE <input checked="" type="checkbox"/> FEE <input type="checkbox"/>
5. State Oil & Gas Lease No.
OG-272

APPLICATION FOR PERMIT TO DRILL, DEEPEN, OR PLUG BACK

1a. Type of Work		7. Unit Agreement Name	
DRILL <input checked="" type="checkbox"/> DEEPEN <input type="checkbox"/> PLUG BACK <input type="checkbox"/>		N/A	
b. Type of Well		8. Farm or Lease Name	
OIL WELL <input checked="" type="checkbox"/> GAS WELL <input type="checkbox"/> OTHER <input type="checkbox"/>		Lowe State	
2. Name of Operator		9. Well No.	
Southwest Production Corporation		2	
3. Address of Operator		10. Field and Pool, or Wildcat	
520 Petroleum Bldg., Abilene, Texas		2nd East Millman	
4. Location of Well		12. County	
UNIT LETTER "H" LOCATED 1980 FEET FROM THE North LINE		Eddy	
990 East 11 TWP. 19S RGE. 28E NMPM			
19. Proposed Depth		19A. Formation	
2300		Queen-Grayburg	
20. Rotary or C.T.		Rotary	
21. Elevations (Show whether DF, RT, etc.)		21B. Drilling Contractor	
GL 3424.9		Eldorado Drlg. Co.	
21A. Kind & Status Plug. Bond		22. Approx. Date Work will start	
Blanket-Approved		November 15, 1966	

23.

PROPOSED CASING AND CEMENT PROGRAM

SIZE OF HOLE	SIZE OF CASING	WEIGHT PER FOOT	SETTING DEPTH	SACKS OF CEMENT	EST. TOP
9-5/8"	7"	20#	600	150	Circ.
6-1/4"	4-1/2"	9#	2300	100	1550

Plans are to drill surface hole with mud to depth of 600 feet, set 7" casing at that depth with 150 sacks of cement. Will drill to proposed depth of 2300 feet with air and/or mud (air when possible). If production is indicated, 4-1/2" casing will be run to TD, cemented with 100 sacks of cement, and producing zones will be selectively perforated and stimulated. All work will be done according to State regulations.

IN ABOVE SPACE DESCRIBE PROPOSED PROGRAM: IF PROPOSAL IS TO DEEPEN OR PLUG BACK, GIVE DATA ON PRESENT PRODUCTIVE ZONE AND PROPOSED NEW PRODUCTIVE ZONE. GIVE BLOWOUT PREVENTER PROGRAM, IF ANY.

I hereby certify that the information above is true and complete to the best of my knowledge and belief.

Signed R. L. Landberg Title Agent Date Nov. 1, 1966  
 (This space for State Use)

APPROVED BY W. A. Gressett TITLE OIL AND GAS INSPECTOR DATE NOV 1 1966  
 CONDITIONS OF APPROVAL, IF ANY:

NEW MEXICO OIL CONSERVATION COMMISSION  
WELL LOCATION AND ACREAGE DEDICATION PLAT

Form C-102  
Supersedes C-128  
Effective 1-1-65

All distances must be from the outer boundaries of the Section.

Operator <b>Southwest Production Corporation</b>			Lease <b>Low-Grade</b>		Well No. <b>2</b>
Unit Letter <b>H</b>	Section <b>11</b>	Township <b>19 South</b>	Range <b>28 East</b>	County <b>ddy</b>	
Actual Footage Location of Well: <b>1980</b> feet from the <b>North</b> line and <b>990</b> feet from the <b>East</b> line					
Ground Level Elev. <b>7774.9</b>	Producing Formation <b>Queen-Grayburg</b>		Pool <b>und. East Millman Q-G</b>		Dedicated Acreage: <b>40</b> Acres

1. Outline the acreage dedicated to the subject well by colored pencil or hachure marks on the plat below.
2. If more than one lease is dedicated to the well, outline each and identify the ownership thereof (both as to working interest and royalty).
3. If more than one lease of different ownership is dedicated to the well, have the interests of all owners been consolidated by communitization, unitization, force-pooling, etc?

**RECEIVED**

**NOV 1 1966**

☐ Yes ☐ No If answer is "yes," type of consolidation \_\_\_\_\_

If answer is "no," list the owners and tract descriptions which have actually been consolidated, or otherwise, on the reverse side of this form if necessary.) \_\_\_\_\_

No allowable will be assigned to the well until all interests have been consolidated (by communitization, unitization, forced-pooling, or otherwise) or until a non-standard unit, eliminating such interests, has been approved by the Commission.

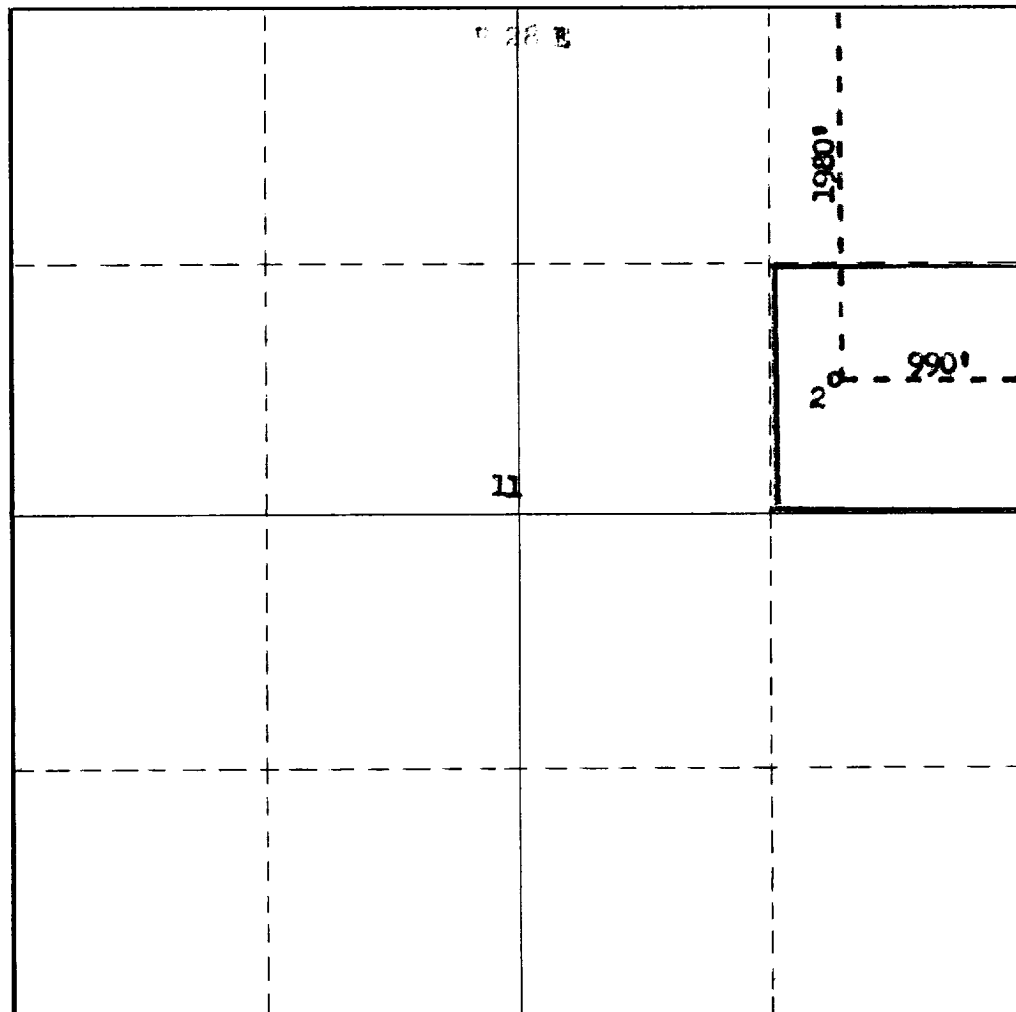

**CERTIFICATION**

I hereby certify that the information contained herein is true and complete to the best of my knowledge and belief.

**R.W. Landenberger, Jr.**

Name  
*R.W. Landenberger, Jr.*  
Position  
**Agent**

Company  
**Southwest Prod. Corp.**

Date  
**November 1, 1966**

I hereby certify that the well location shown on this plat was plotted from field notes of actual surveys made by me or under my supervision, and that the same is true and correct to the best of my knowledge and belief.

Date Surveyed  
**October 18, 1966**  
Registered Professional Engineer and/or Land Surveyor

*James H. Brown*  
Certificate No.  
**N.M.L.S. No. 542**

