

UNITED STATES
DEPARTMENT OF THE INTERIOR
GEOLOGICAL SURVEY

APPLICATION FOR PERMIT TO DRILL, DEEPEN, OR PLUG BACK

1a. TYPE OF WORK DRILL <input type="checkbox"/> DEEPEN <input type="checkbox"/> PLUG BACK <input type="checkbox"/>			5. LEASE DESIGNATION AND SERIAL NO. 0352858-B	
b. TYPE OF WELL OIL WELL <input type="checkbox"/> GAS WELL <input checked="" type="checkbox"/> OTHER <input type="checkbox"/> SINGLE ZONE <input checked="" type="checkbox"/> MULTIPLE ZONE <input type="checkbox"/>			6. IF INDIAN, ALLOTTEE OR TRIBE NAME	
2. NAME OF OPERATOR Yates Petroleum Corporation			7. UNIT AGREEMENT NAME	
3. ADDRESS OF OPERATOR 207 South 4th Street - Artesia, NM 88210			8. FARM OR LEASE NAME Mobil Federal CI	
4. LOCATION OF WELL (Report location clearly and in accordance with any State requirements.) At surface 810' FSL & 660' FWL of Sec. 5-19S-25E At proposed prod. zone			9. WELL NO. 2	
14. DISTANCE IN MILES AND DIRECTION FROM NEAREST TOWN OR POST OFFICE 8 Miles SW of Dayton, NM			10. FIELD AND POOL, OR WILDCAT Penasco Draw S.A. Yeso	
19. DISTANCE FROM PROPOSED LOCATION TO NEAREST PROPERTY OR LEASE LINE, FT. (Also to nearest drilg. unit line, if any) 660			11. SEC., T., R., M. OR BLM. AND SURVEY OR AREA Sec. 5-19S-25E Unit M NMPM	
16. NO. OF ACRES IN LEASE 403.69			12. COUNTY OR PARISH Eddy	
17. NO. OF ACRES ASSIGNED TO THIS WELL 40			13. STATE NM	
18. DISTANCE FROM PROPOSED LOCATION TO NEAREST WELL, DRILLING, COMPLETION, OR APPLIED FOR, ON THIS LEASE, FT.			20. ROTARY OR CABLE TOOLS Rotary	
21. ELEVATIONS (Show whether DF, RT, GR, etc.) 3494 GR.			22. APPROX. DATE WORK WILL START Dec. 15, 1972	

23. PROPOSED CASING AND CEMENTING PROGRAM

SIZE OF HOLE	SIZE OF CASING	WEIGHT PER FOOT	SETTING DEPTH	QUANTITY OF CEMENT
14"	10-5/8"	32.75#	Approx. 280'	Circulate
9-7/8"	7"	20 or 24#	Approx 970'	Circulate
6 1/2"	4 1/2 or 5 1/2"	9.5 or 15.5#	Total Depth	100 Sacks

Propose to drill a 1500' San Andres Test and set production string, perforate and sand frac. 7" water protection string will be set 100' below the Artesian zone and cemented to the surface. Casing will be tested in accordance with the MMOCC Rule 107.

Mud Program: - Fresh water gel to 970'; Water to total depth.
BOP Program: - Flow nipple only.

Anticipated top of San Andres - 554' KB
Anticipated Base of Artesian Zone - 868' KB

OPERATIONS	RECORD TYPE	DATE OF RECORD	DATE OF REVIEW
NO. OF COPIES	1	1	1
IN ABOVE SPACE DESCRIBE PROPOSED PROGRAM. If proposal is to deepen or plug back, give data on present productive zone and proposed new productive zone. If proposal is to drill or deepen directionally, give pertinent data on subsurface locations and measured and true vertical depths. Give blowout preventer program, if any.			
SIGNED _____ TITLE Engineer DATE 12-7-72			
OPERATOR'S NAME _____			
(This space for Federal or State office use)			

DECLARED WATER BASIN

CEMENT BEHIND THE CASING MUST BE CIRCULATED

NOTIFY US IN SUFFICIENT TIME TO WITNESS CLOSING THE CASING.

*See Instructions On Reverse Side

NEW MEXICO OIL CONSERVATION COMMISSION
WE LOCATION AND ACREAGE DEDICATION LAT

Form C-102
Supersedes C-128
Effective 1-1-65

All distances must be from the outer boundaries of the Section.

Operator Yates Petroleum Corporation		Lease LI Mobil Federal "CI"		Well No. 2
Unit Letter M	Section 5	Township 19 South	Range 25 East	County Eddy
Actual Footage Location of Well: 810' feet from the South line and 660' feet from the West line				
Ground Level Elev. 3594	Producing Formation San Andres	Pool Penasco Draw S.A.Yeso	Dedicated Acreage: 40 Acres	

1. Outline the acreage dedicated to the subject well by colored pencil or hatchure marks on the plat below.
2. If more than one lease is dedicated to the well, outline each and identify the ownership thereof (both as to working interest and royalty).
3. If more than one lease of different ownership is dedicated to the well, have the interests of all owners been consolidated by communitization, unitization, force-pooling, etc?

☐ Yes ☐ No If answer is "yes," type of consolidation _____

If answer is "no," list the owners and tract descriptions which have actually been consolidated. (Use reverse side of this form if necessary.) _____

No allowable will be assigned to the well until all interests have been consolidated (by communitization, unitization, forced-pooling, or otherwise) or until a non-standard unit, eliminating such interests, has been approved by the Commission.

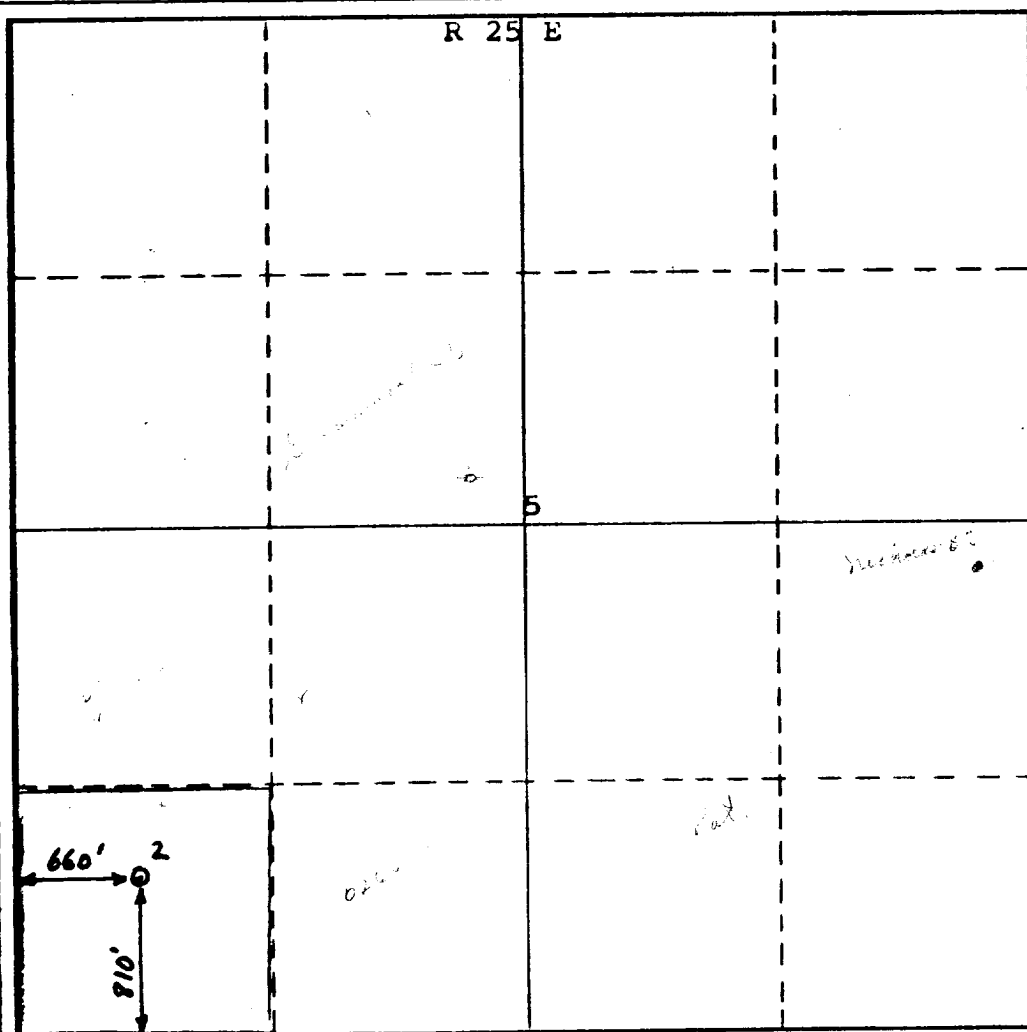

CERTIFICATION

I hereby certify that the information contained herein is true and complete to the best of my knowledge and belief.

Eddie M. Mahfood
Name

Eddie M. Mahfood

Position
Engineer

Company
Yates Petroleum Corp.

Date
12-7-72

I hereby certify that the well location shown on this plat was plotted from field notes of actual surveys made by me or under my supervision, and that the same is true and correct to the best of my knowledge and belief.

12-7-72

Date Surveyed

Registered Professional Engineer and/or Land Surveyor

Eddie M. Mahfood

Certificate No. #4605