

NEW MEXICO OIL CONSERVATION COMMISSION
WELL LOCATION AND ACREAGE DEDICATION PLAT

All distances must be from the outer boundaries of the Section.

Copy 2-1
Form C-102
Supersedes C-128
Effective 1-1-65
St. Louis
2/8/68

DAVID FASKEN

Lease

STATE "32"

Well No.

1

D

32

Township

20 South

Range

25 East

County

Eddy

1. Location of Well:

1000

feet from the North

line and

1000

feet from the West

line

2. Depth of Well:

3622'

Producing Formation

Morrow

Pool

Cemetery Morrow

Dedicated Acreage

320+ for

Acres

proration

3. Outline the acreage dedicated to the subject well by colored pencil or hatchure marks on the plat below.

and identify the ownership thereof (attach to working

RECEIVED

This well and lease was transferred from Indian Basin (Morrow) Gas Pool to Cemetery (Morrow) Gas Pool by N.M.O.C.C. Order No. R-5162 effective March 1, 1976.

the well, have the interests of all **MAR 11 1976**

Ownership in this governmental section has been communitized.

a Communitization **O. C. C.**
ARTESIA, OFFICE

The area outlined in red on the attached plat is assigned to this well for proration purposes only --- 320 ± acres.

have actually been consolidated. (Use reverse side of

been consolidated (by communitization, unitization, etc. such interests, has been approved by the Commis-

Robert H. Anger
3-10-76

ID FASKEN
L-5448

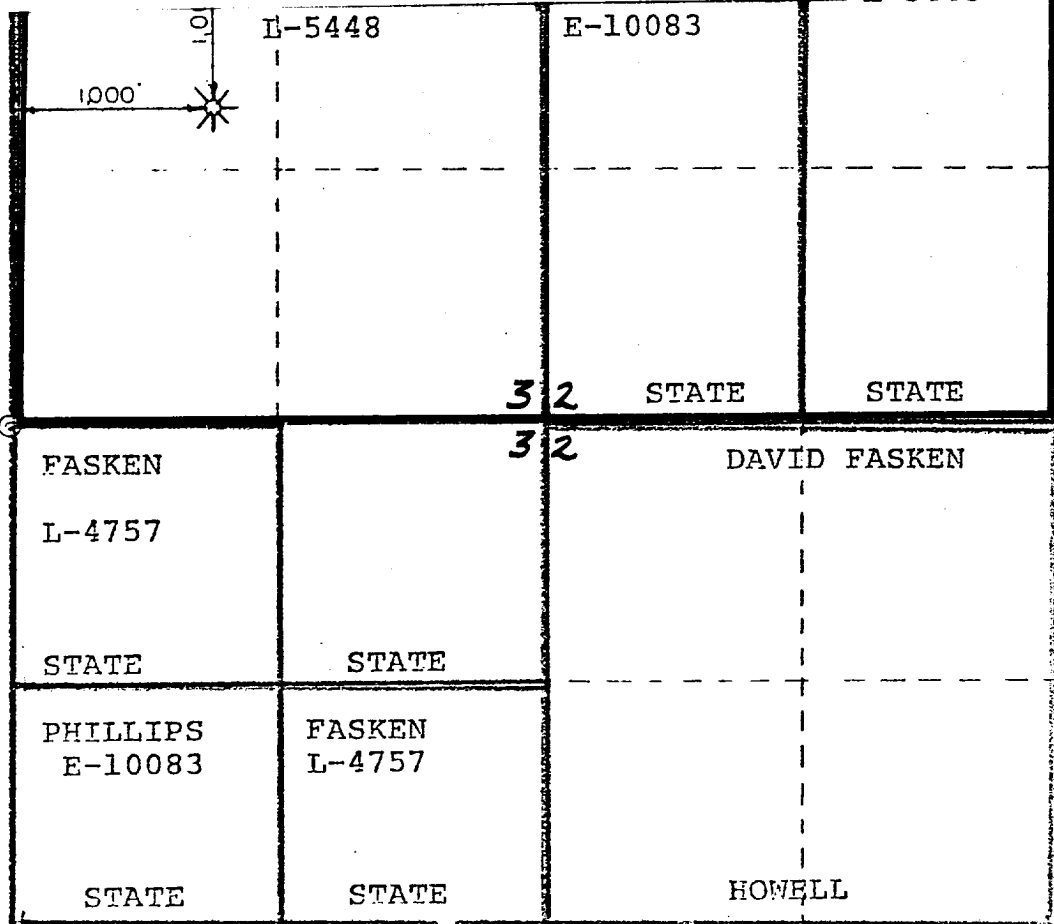

CERTIFICATION

I hereby certify that the information contained herein is true and complete to the best of my knowledge and belief.

Name

James B. Henry

Position

Agent

Company

David Fasken

Date

March 10, 1976

I hereby certify that the well location shown on this plat was plotted from field notes of actual surveys made by me or under my supervision, and that the same is true and correct to the best of my knowledge and belief.

Date Surveyed

October 10, 1973

Registered Professional Engineer and/or Land Surveyor

Certificate No.

1559