

HENRY ENGINEERING  
*Petroleum Engineers*  
807 FIRST NATIONAL BANK BUILDING  
MIDLAND, TEXAS 79701

March 4, 1974

RECEIVED

MAR - 5 1974

O. C. C.  
ARTESIA, OFFICE

New Mexico Oil Conservation Commission  
P. O. Drawer DD  
Artesia, New Mexico 88210

Re: Application to Drill  
David Fasken  
Gossett "20" No. 1  
Eddy County, New Mexico

Gentlemen:

On January 25, 1974 we filed Form C-101 "Application to Drill" for the above referenced well.

The elevation was erroneously reported. We would appreciate your changing it to 3522' G.L., as shown on the attached copy of the form.

Yours very truly,

HENRY ENGINEERING

*James B. Henry / JBH*

James B. Henry

JBH:bh

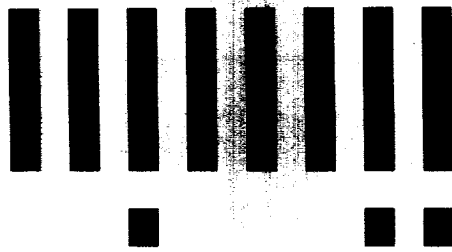

**LTR**



**Job separation sheet**



**N MEXICO OIL CONSERVATION COMMISS**  
**WELL LOCATION AND ACREAGE DEDICATION PLAT**

Fbrn C-102  
 Supersedes C-128  
 Effective 1-4-65

All distances must be from the outer boundaries of the Section.

<b>DAVID FASKEN</b>			Lease <b>GOSSETT "20"</b>		Well No. <b>1</b>
No. <b>660</b>	Section <b>20</b>	Township <b>20 South</b>	Range <b>25 East</b>	County <b>Eddy County</b>	
Distance from the <b>South</b> line and <b>1980</b> feet from the <b>East</b> line to the well is <b>3522'</b> to the formation <b>MARROW</b> East <b>CEMETERY</b> Dedicated Acreage: <b>320</b> Acres					

Outline the acreage dedicated to the subject well by colored pencil or hachure marks on the plat below.

If more than one lease is dedicated to the well, outline each and identify the ownership thereof (both as to working interest and royalty).

If more than one lease of different ownership is dedicated to the well, have the interests of all owners been consolidated by communitization, unitization, force-pooling, etc?

☐ Yes ☐ No If answer is "yes," type of consolidation \_\_\_\_\_

If answer is "no," list the owners and tract descriptions which have actually been consolidated. (Use reverse side of this form if necessary.) \_\_\_\_\_

No flow rule will be assigned to the well until all interests have been consolidated (by communitization, unitization, force pooling, or otherwise) or until a non-standard unit, eliminating such interests, has been approved by the Commission.

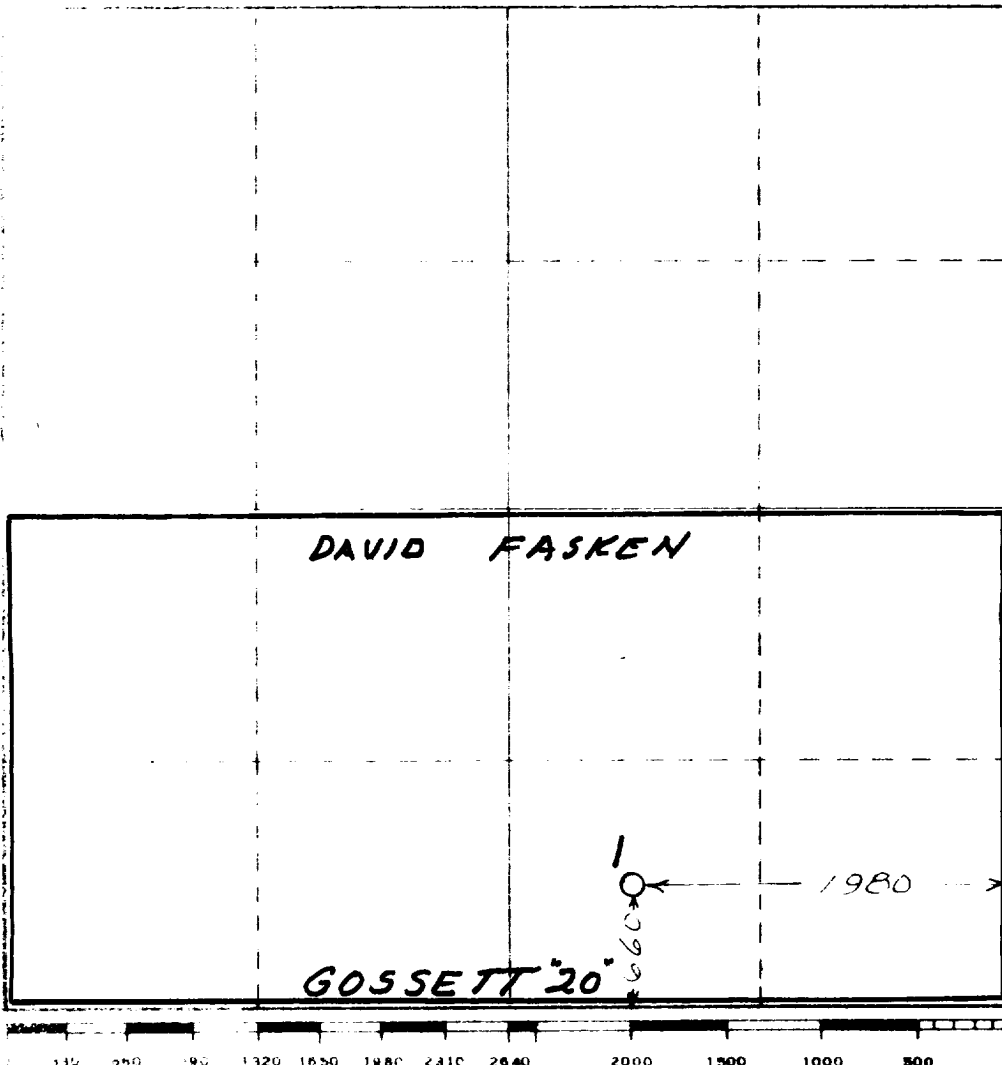

**CERTIFICATION**

I hereby certify that the information contained herein is true and complete to the best of my knowledge and belief.

Name James B. Henry  
 Position AGENT  
 Company DAVID FASKEN  
 Date Jan 25, 1974

I hereby certify that the well location shown on this plat was plotted from field notes of actual surveys made by me or under my supervision, and that the same is true and correct to the best of my knowledge and belief.

Date Surveyed January 25, 1974  
 Registered Professional Engineer and/or Land Surveyor HERSCHEL E. JONES 3640  
 Certificate No. \_\_\_\_\_

