

N. MEXICO OIL CONSERVATION COMMISSION
WELL LOCATION AND ACREAGE DEDICATION PLAT

Form C-102
Supersedes C-12b
Effective 1-4-65

All distances must be from the outer boundaries of the Section.

DAVID FASKEN			Lease GOSSETT "20"		Well No. 1
Section 20	Township 20 South	Range 25 East	County Eddy County		
Find the true location of well:					
660	feet from the South	line and 1980	feet from the East	line	
Produced Level Elev. 3522	Producing Formation MORROW	Foot 2nd CEMETERY Morrow Gap	Dedicated Acreage: 320		Acres

- Outline the acreage dedicated to the subject well by colored pencil or hachure marks on the plat below.
- If more than one lease is dedicated to the well, outline each and identify the ownership thereof (both as to working interest and royalty).
- If more than one lease of different ownership is dedicated to the well, have the interests of all owners been consolidated by communitization, unitization, force-pooling, etc?

☐ Yes ☐ No If answer is "yes," type of consolidation _____

If answer is "no," list the owners and tract descriptions which have actually been consolidated. (Use reverse side of this form if necessary.) _____

No allowable will be assigned to the well until all interests have been consolidated (by communitization, unitization, force pooling or otherwise) or until a non-standard unit, eliminating such interests, has been approved by the Commission.

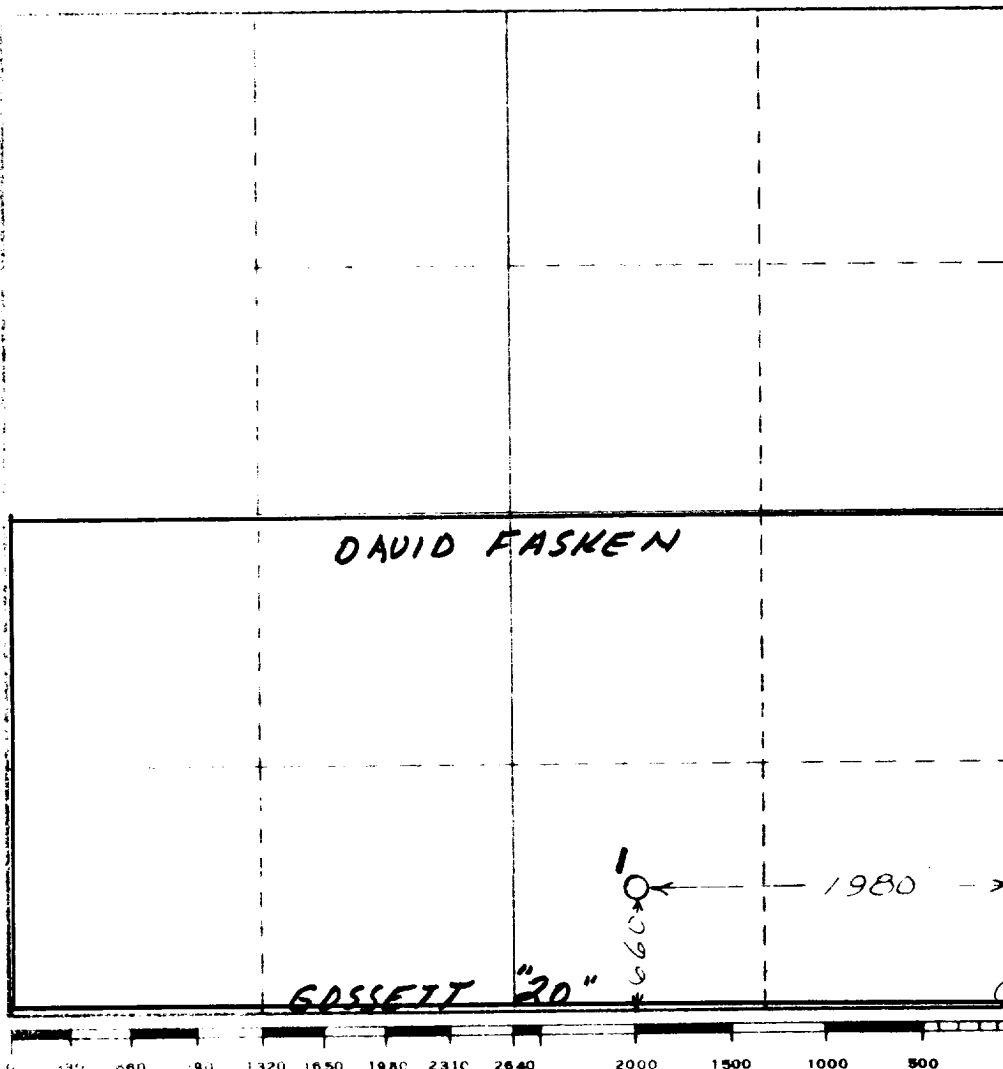

CERTIFICATION

I hereby certify that the information contained herein is true and complete to the best of my knowledge and belief.

Name **James B. Henry**
Position **AGENT**
Company **DAVID FASKEN**
Date **Jan 25, 1974**

I hereby certify that the well location shown on this plat was plotted from field notes of actual surveys made by me or under my supervision, and that the same is true and correct to the best of my knowledge and belief.

Date Survey **Jan 25, 1974**
Registered Professional Engineer and/or Land Surveyor **HERSCHEL JONES 3640**
Certificate No. **3640**

