

UNITED STATES NM OIL CONS. COMMISSION
DEPARTMENT OF THE INTERIOR
GEOLOGICAL SURVEY
Artesia, NM 88210

C/SF

APPLICATION FOR PERMIT TO DRILL, DEEPEN, OR PLUG BACK

1a. TYPE OF WORK

~~RE-ENTER~~ ☒ RE-ENTERDEEPEN ☐PLUG BACK ☐

b. TYPE OF WELL

OIL
WELL ☒GAS
WELL ☐OTHER ☐SINGLE
ZONE ☒MULTIPLE
ZONE ☐

2. NAME OF OPERATOR

CHAMA PETROLEUM COMPANY /

3. ADDRESS OF OPERATOR

5447 GLEN LAKES DRIVE, DALLAS, TEXAS 75231

4. LOCATION OF WELL (Report location clearly and in accordance with any State requirements.)

At surface

660' FSL AND 1980' FWL OF SECTION 34

At proposed prod. zone

11. DISTANCE IN MILES AND DIRECTION FROM NEAREST TOWN OR POST OFFICE*

16 MILES SOUTH OF ARTESIA, NEW MEXICO

15. DISTANCE FROM PROPOSED*

LOCATION TO NEAREST
PROPERTY OR LEASE LINE, FT.
(Also to nearest drlg. unit line, if any)

660'

18. DISTANCE FROM PROPOSED LOCATION*
TO NEAREST WELL, DRILLING COMPLETED,
OR APPLIED FOR, ON THIS LEASE, FT.

19. PROPOSED DEPTH

2950'

21. ELEVATIONS (Show whether DF, RT, GR, etc.)

3527.1 GR

23

PROPOSED CASING AND CEMENTING PROGRAM

SIZE OF HOLE	SIZE OF CASING	WEIGHT PER FOOT	SETTING DEPTH	QUANTITY OF CEMENT
17-1/2"	*13-3/8"	48# H-40	485'	CEMENT CIRCULATED
12-1/4"	* 9-5/8"	36# K-55	3000'	CEMENT CIRCULATED

* THIS CASING RUN AND CEMENTED WHEN WELL WAS ORIGINALLY DRILLED.

PLANS ARE TO DRILL OUT PLUGS AND CLEAN OUT TO DEPTH OF 2950 FEET AND ATTEMPT COMPLETION IN YESO OR AT LESSER DEPTH. PRODUCING ZONE WILL BE PERFORATED AND STIMULATED AS NECESSARY.

THIS WELL ORIGINALLY DRILLED BY J.M. HUBER CORP. AS WELL NO.1 IRAMI FEDERAL COM TO TOTAL DEPTH OF 9600 FEET DURING PERIOD 3-14-74 TO 4-21-74 AND SUBSEQUENTLY PLUGGED AND ABANDONED.

RECEIVED
MAR 25 1982SEE ATTACHED FOR: SUPPLEMENTAL DRILLING DATA
BOP SKETCH
SURFACE USE AND OPERATIONS PLANPosted ID-1
+ NL Book
Re-Entry
4-16-82OIL & GAS
U.S. GEOLOGICAL SURVEY
ROSWELL, NEW MEXICO

AS ABOVE SPECIFIED IN PROPOSED PROGRAM: If proposal is to deepen or plug back, give data on present productive zone and proposed new productive zone. If proposal is to drill or deepen directionally, give pertinent data on subsurface locations and measured and true vertical depths. Give blowout preventer program, if any.

24

SIGNED

Arthur R. Brown

TITLE

Agent for
CHAMA PETROLEUM COMPANY

DATE MARCH 23, 1982

PERMIT NO.

APPROVAL DATE

APPROVED BY

CONDITIONS OF APPROVAL (If any)

APPROVED

10-6-82) GEORGE H. STEWART

APR 9 1982

FOR

JAMES A. GILLHAM
DISTRICT SUPERVISOR

NEW MEXICO OIL CONSERVATION COMMISSION
WELL LOCATION AND ACREAGE DEDICATION LAT

Form C-102
Supersedes C-128
Effective 1-1-65

All distances must be from the outer boundaries of the Section.

Operator CHAMA PETROLEUM COMPANY			Lease IRAMI FEDERAL		Well No. 1
Unit Letter N	Section 34	Township 19 SOUTH	Range 25 EAST	County EDDY	
Actual Footage Location of Well: 660 feet from the SOUTH line and 1980 feet from the WEST line					
Ground Level Elev.	Producing Formation YESO	Pool WILDCAT		Dedicated Acreage: 40 Acres	

- Outline the acreage dedicated to the subject well by colored pencil or hachure marks on the plat below.
- If more than one lease is dedicated to the well, outline each and identify the ownership thereof (both as to working interest and royalty).
- If more than one lease of different ownership is dedicated to the well, have the interests of all owners been consolidated by communitization, unitization, force-pooling, etc?

☐ Yes ☐ No If answer is "yes," type of consolidation _____

If answer is "no," list the owners and tract descriptions which have actually been consolidated. (Use reverse side of this form if necessary.) _____

No allowable will be assigned to the well until all interests have been consolidated (by communitization, unitization, forced-pooling, or otherwise) or until a non-standard unit, eliminating such interests, has been approved by the Commission.

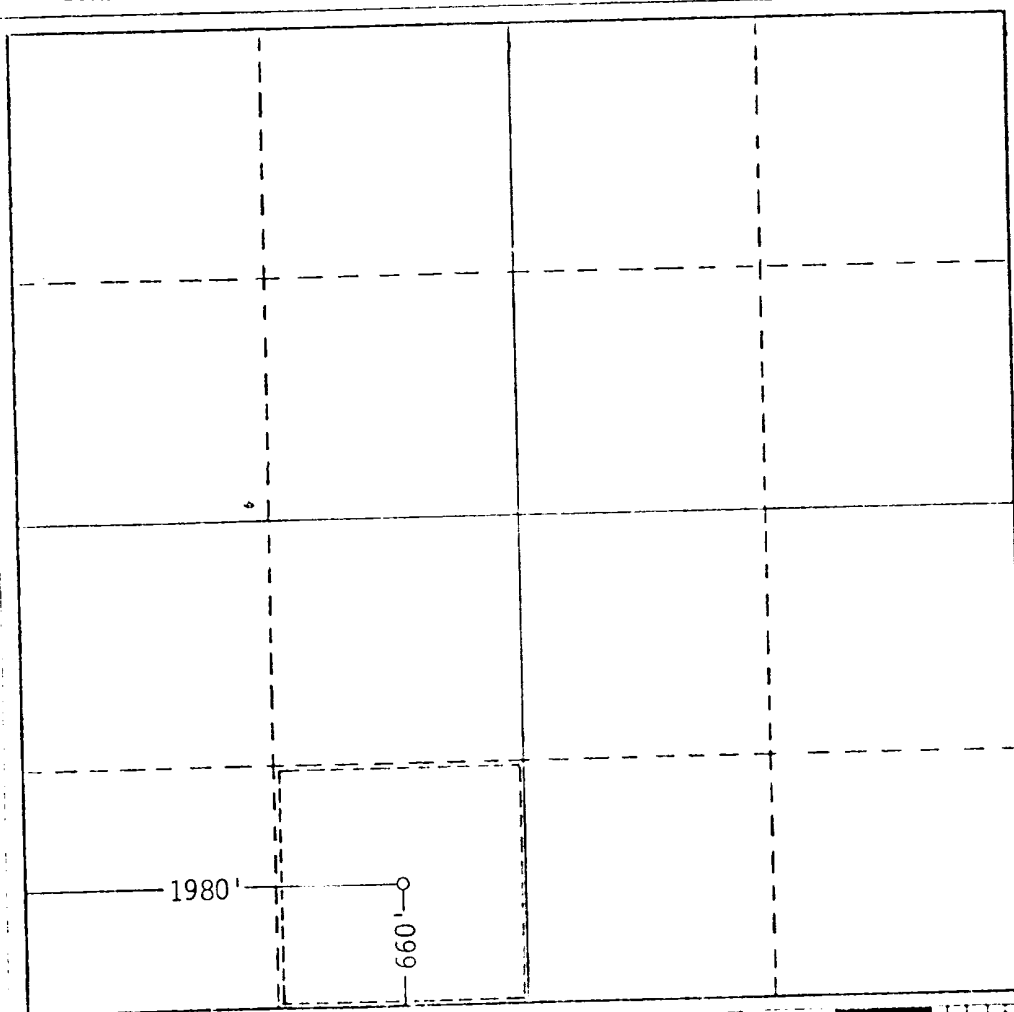

CERTIFICATION

I hereby certify that the information contained herein is true and complete to the best of my knowledge and belief.

Arthur R. Brown
Name
Arthur R. Brown
Position
Agent for
Company
CHAMA PETROLEUM COMPANY
Date
MARCH 22, 1982

I hereby certify that the well location shown on this plat was plotted from field notes of actual surveys made by me or under my supervision, and that the same is true and correct to the best of my knowledge and belief.

SEE ORIGINAL PLAT

Date Surveyed
Registered Professional Engineer
and/or Land Surveyor

Certification

SUPPLEMENTAL DRILLING DATA

CHAMA PETROLEUM COMPANY WELL NO.1 IRAMI FEDERAL

1. SURFACE FORMATION: Recent

2. TOPS OF GEOLOGIC MARKERS:

Grayburg	530
San Andres	830
Glorieta	2388
Yeso	2488

3. ANTICIPATED POSSIBLE HYDROCARBON BEARING ZONES:

San Andres	Oil
Yeso	Oil

4. PROPOSED CASING AND CEMENTING PROGRAM:

Casing as shown on form 9-331 C was run and cemented when well was originally drilled. No additional casing is planned.

5. PRESSURE CONTROL EQUIPMENT:

Blowout prevention equipment will be in use during re-entry operations. A BOP sketch is attached.

6. CIRCULATING MEDIUM:

Surface to 2950 feet: Water base fluid conditioned as necessary for control of viscosity and weight.

7. AUXILARY EQUIPMENT:

Drill string safety valves will be maintained on the rig floor while re-entry operations are in progress.

8. TESTING, LOGGING, AND CORING PROGRAMS:

No drillstem tests or coring are planned.

No logging is planned other than correlation logs.

9. ABNORMAL PRESSURES, TEMPERATURES, OR HYDROGEN SULFIDE GAS:

None anticipated.

10. ANTICIPATED STARTING DATE:

It is planned that operations will commence upon approval of this application, with re-entry and completion operations lasting about two weeks.

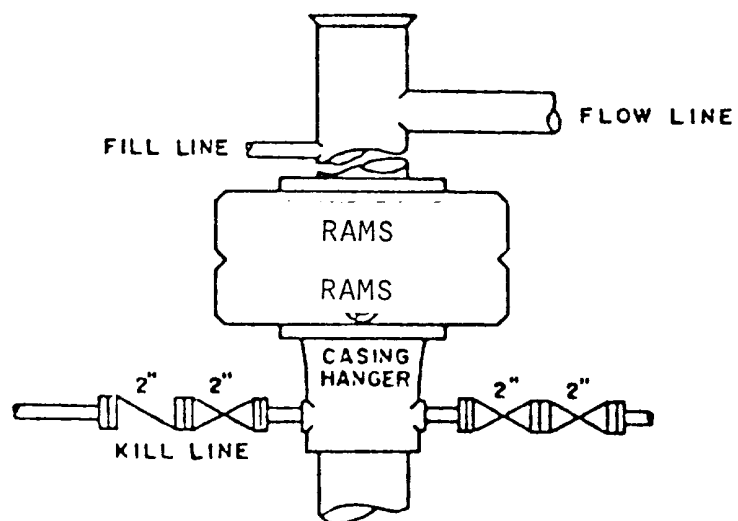

BOP STACK

2000 PSI WORKING PRESSURE

BOP ARRANGEMENT

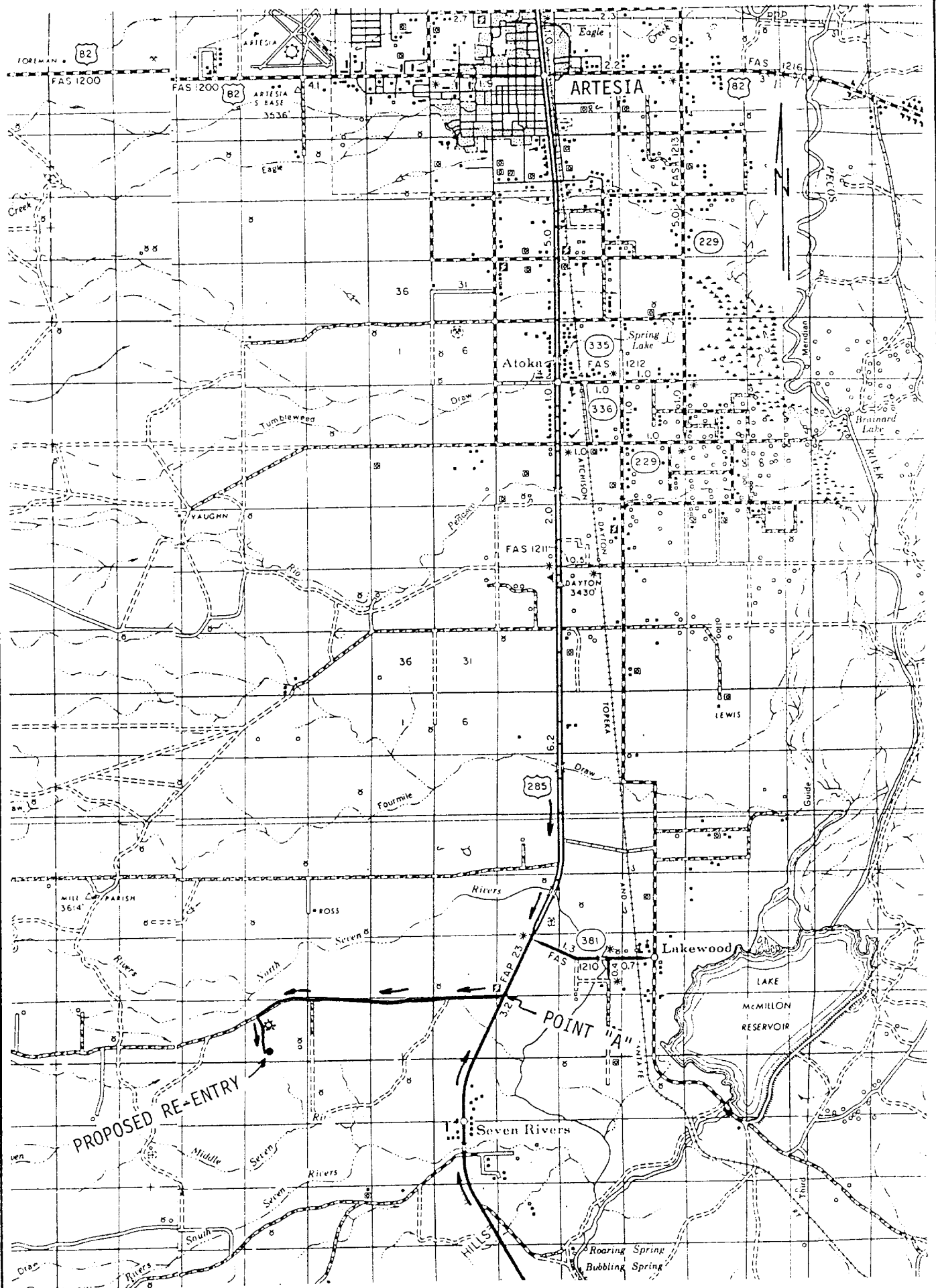

EXHIBIT "A"

CHAMA PETROLEUM COMPANY
 WELL NO. 1 IRAMI FEDERAL
 660' FSL & 1980' FWL SEC. 34, T. 19 S., R. 25 E.
 EDDY COUNTY, N.M. SCALE: 1/2" = 1 MI.

