

NEW MEXICO OIL CONSERVATION COMMISSION
WELL LOCATION AND ACREAGE DEDICATION PLAT

Form O-10
Supersedes O-10-1
Effective 1-1-67

All distances must be from the outer boundaries of the Section

Owner READ & STEVENS, INC.			Lease ALLIRISH		Well No. 1
Section Letter P	Section 30	Township 20 SOUTH	Range 25 EAST	County EDDY	
Actual Well Location of Wells					
990 feet from the EAST line and		660 feet from the SOUTH line			
Ground Level Elev. 3586.1	Producing Formation Wolfcamp	Pool (Suggested) <i>Wolfcamp Cemetery Wolfcamp</i>		Dedicated Acreage SE/4 - 160.00	

1. Outline the acreage dedicated to the subject well by colored pencil or hatchure marks on the plat below.
2. If more than one lease is dedicated to the well, outline each and identify the ownership thereof (both as to working interest and royalty).
3. If more than one lease of different ownership is dedicated to the well, have the interests of all owners been consolidated by communitization, unitization, force-pooling, etc?

Yes ☐ No ☐ If answer is "yes," type of consolidation _____

If answer is "no," list the owners and tract descriptions which have actually been consolidated. (Use reverse side of this form if necessary.) _____

No allowable will be assigned to the well until all interests have been consolidated (by communitization, unitization, forced-pooling, or otherwise) or until a non-standard unit, eliminating such interests, has been approved by the Commission.

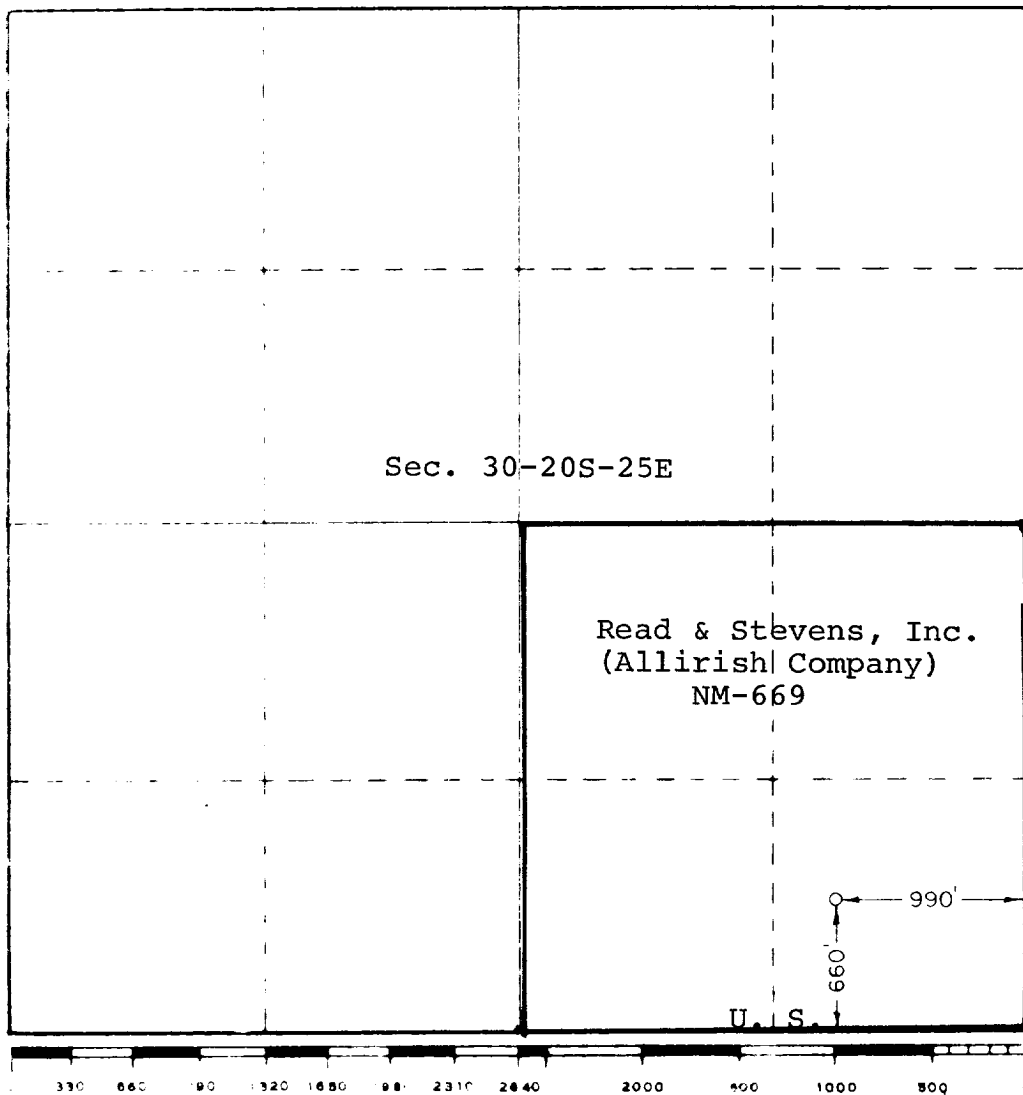

CERTIFICATION

I hereby certify that the information contained herein is true and complete to the best of my knowledge and belief

John L. Anderson, Jr.
Name

John L. Anderson, Jr.

Position
Agent

Company
Read & Stevens, Inc.

Date
February 24, 1975

RECEIVED

I hereby certify that the well location shown on this plat was located from notes of actual surveys made by me under appropriate provisions of law and is true and correct to the best of my knowledge and belief

