

NEW MEXICO OIL CONSERVATION COMMISSION
WELL LOCATION AND ACREAGE DEDICATION PLAT

All distances must be from the outer boundaries of the Section.

MARK PRODUCTION COMPANY			Lease FOSTER		Well No. 1
Tract Letter J	Section 21	Township 20 SOUTH	Range 24 EAST	County EDDY	
Approximate Location of Well: 2130 feet from the SOUTH line and 1980 feet from the EAST line					
Surface Elev. 3730	Producing Formation Morrow	Pool Wildcat	Dedicated Acreage 320		

1. Outline the acreage dedicated to the subject well by colored pencil or hachure marks on the plat below.
2. If more than one lease is dedicated to the well, outline each and identify the ownership thereof (both as to working interest and royalty).
3. If more than one lease of different ownership is dedicated to the well, have the interests of all owners been consolidated by communitization, unitization, force-pooling, etc?

RECEIVED

JAN 13 1975

☐ Yes ☒ No If answer is "yes," type of consolidation _____

O. C. C.

ARTESIA OFFICE

If answer is "no," list the owners and tract descriptions which have actually been consolidated. (Use reverse side of this form if necessary.) 1 owner - Foster

No allowable will be assigned to the well until all interests have been consolidated (by communitization, unitization, forced-pooling, or otherwise) or until a non-standard unit, eliminating such interests, has been approved by the Commission.

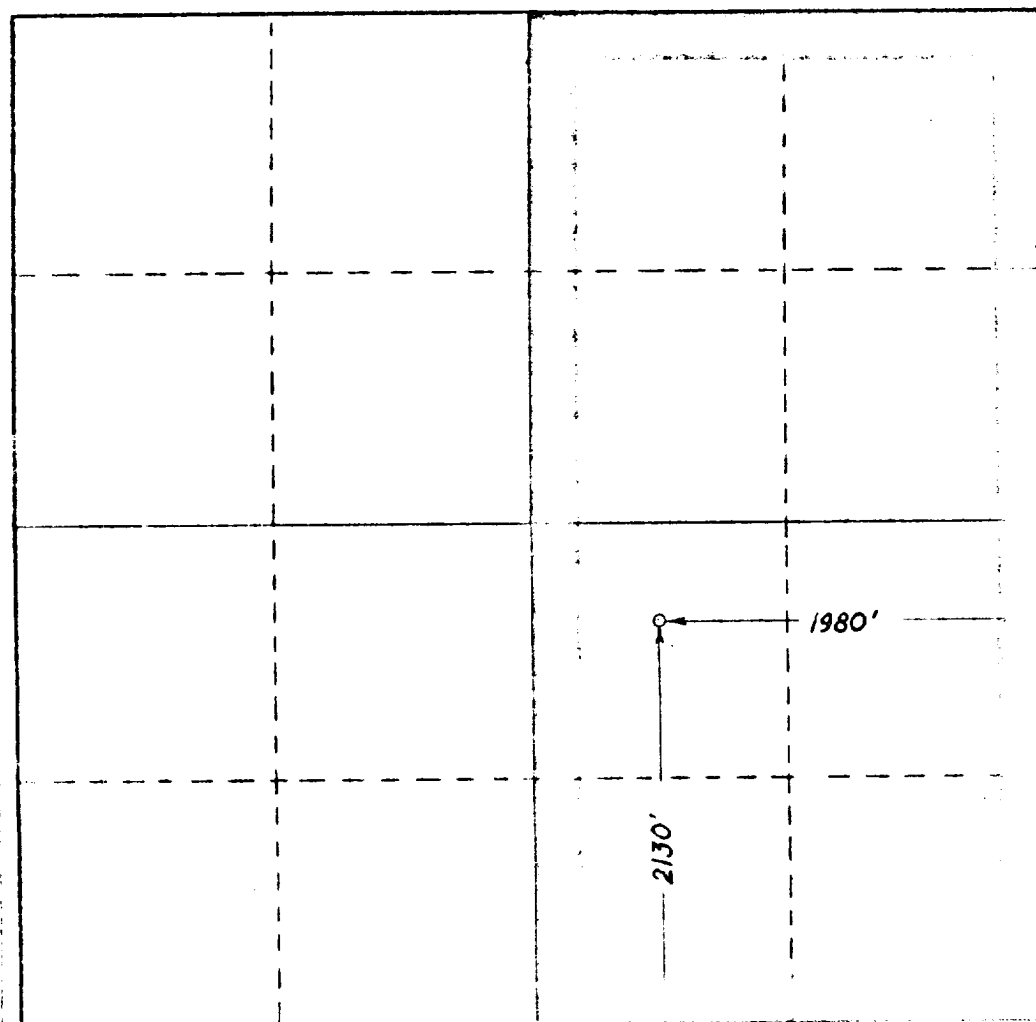

CERTIFICATION

I hereby certify that the information contained herein is true and complete to the best of my knowledge and belief.

Marjorie Lotz
Name

Marjorie Lotz

Position

Production Clerk

Company

Mark Production Company

Date

January 10, 1974

I hereby certify that the well location shown on this plat was plotted from field notes of actual surveys made by me or under my supervision and that the same is true and correct to the best of my knowledge.

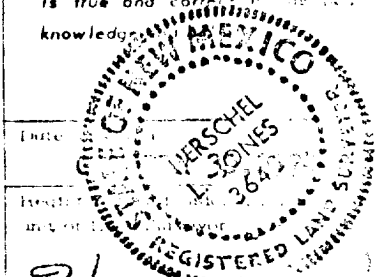

Date

Location

and of

3640
Certificate No.

