

CISF 13

Form C-101

Revised February 10, 1994

Instructions on back

Submit to Appropriate District Office

State Lease - 6 Copies

Fee Lease - 5 Copies

District I
PO Box 1980, Hobbs, NM 88241-1980
District II
PO Drawer DD, Artesia, NM 88211-0719
District III
1000 Rio Brazos Rd., Aztec, NM 87410
District IV
PO Box 2088, Santa Fe, NM 87504-2088

State of New Mexico
Energy, Minerals & Natural Resources Department

OIL CONSERVATION DIVISION
PO Box 2088
Santa Fe, NM 87504-2088

AMENDED REPORT

APPLICATION FOR PERMIT TO DRILL, RE-ENTER, DEEPEN, PLUGBACK, OR ADD A ZONE

Operator Name and Address. SOUTHWEST ROYALTIES, INC. P.O. BOX 11390 MIDLAND, TX 79702		' OGRID Number
		' API Number 30 - 015 21863
' Property Code	' Property Name JULIE COM	' Well No. 1

7 Surface Location

UL or lot no.	Section	Township	Range	Lot Ida	Feet from the	North/South line	Feet from the	East/West line	County
H	17	19 N	25E		1980	NORTH	990	EAST	EDDY

8 Proposed Bottom Hole Location If Different From Surface

UL or lot no.	Section	Township	Range	Lot Ida	Feet from the	North/South line	Feet from the	East/West line	County
H	17	19 N	25E		1650	NORTH	330	EAST	EDDY

' Proposed Pool 1 N. DANGER DRAW (CISCO CANYON)	' Proposed Pool 2
--	-------------------

" Work Type Code P	" Well Type Code 0	" Cable/Rotary C	" Lease Type Code P	" Ground Level Elevation 3523
" Multiple NO	" Proposed Depth 7800	" Formation CISCO CANYON	" Contractor	" Spud Date 12-1-97

21 Proposed Casing and Cement Program

Hole Size	Casing Size	Casing weight/foot	Setting Depth	Sacks of Cement	Estimated TOC
17 1/2	13-3/8	54	415	300	Surf
11	8-5/8	24	1125	200	Surf
7-7/8	5-1/2	17	8052	280	6900

" Describe the proposed program. If this application is to DEEPEN or PLUG BACK give the data on the present productive zone and proposed new productive zone. Describe the blowout prevention program, if any. Use additional sheets if necessary.

SQUEEZE OFF INJ. ZONE FROM 4762-4954'. DRILL OUT CEMENT PLUGS & RET @ 5465' & @ 6700'. KICK OFF FROM TOP OF PLUG @ 7690' & MILL WINDOW IN 5-1/2" CSG. DRILL w/4-3/4" BIT 100' RADIUS TO HORIZONTAL & MAINTAIN DIRECTIONAL BETWEEN 7775 & 7800'. DRILL ± 700' LATERAL TO PROPOSED BOTTOM HOLE LOCATION LISTED ABOVE. ACIDIZE ZONE & RUN PUMPING EQUIPMENT TO KOP.

* NOTE : BOTTOM CIBP WAS REPORTED ON 11-18-86 TO BE @ 7960'. THIS IS BELOW OLD PERFS @7776-7848' & IS THEREFORE EXPECTED TO BE @ 7690'. WE WILL TAG THIS PLUG BEFORE KICKING OFF.

" I hereby certify that the information given above is true and complete to the best of my knowledge and belief.

Signature: *James Blount*

Printed name: JAMES BLOUNT

Title: AREA SUPERVISOR

Date: 10-7-97

Phone: 1 800 433 7945

OIL CONSERVATION DIVISION

Approved by:

Title: ORIGINAL SIGNED BY TIM W. GUM
DISTRICT II SUPERVISOR

Approval Date: 4-2-98

Expiration Date:

Conditions of Approval:
Attached

W F Ch al Jim Steve G. KS M L DW OCO

District I
 PO Box 1980, Hobbs, NM 88241-1980
 District II
 PO Drawer DD, Artesia, NM 88211-0719
 District III
 1000 Rio Brazos Rd., Aztec, NM 87410
 District IV
 PO Box 2088, Santa Fe, NM 87504-2088

State of New Mexico
 Energy, Minerals & Natural Resources Department

OIL CONSERVATION DIVISION
 PO Box 2088
 Santa Fe, NM 87504-2088

Form C-102
 Revised February 10, 1994
 Instructions on back
 Submit to Appropriate District Office
 State Lease - 4 Copies
 Fee Lease - 3 Copies

AMENDED REPORT

WELL LOCATION AND ACREAGE DEDICATION PLAT

API Number 30 015 21863		Pool Code	Pool Name N. DAGGER DRAW (CISCO CANYON)
Property Code	Property Name JULIE COM		Well Number 1
OGRID No.	Operator Name SOUTHWEST ROYALTIES, INC.		Elevation 3523'

10 Surface Location

UL or lot no.	Section	Township	Range	Lot Ida	Feet from the	North/South line	Feet from the	East/West line	County
H	17	19 27S	25E		1980	North	990	East	Eddy

11 Bottom Hole Location If Different From Surface

UL or lot no.	Section	Township	Range	Lot Ida	Feet from the	North/South line	Feet from the	East/West line	County
H	17	19 27S	25E		1650	North	330	East	Eddy

12 Dedicated Acres 40	13 Joint or Infill N	14 Consolidation Code	15 Order No.
--------------------------	-------------------------	-----------------------	--------------

NO ALLOWABLE WILL BE ASSIGNED TO THIS COMPLETION UNTIL ALL INTERESTS HAVE BEEN CONSOLIDATED OR A NON-STANDARD UNIT HAS BEEN APPROVED BY THE DIVISION

16				17 OPERATOR CERTIFICATION I hereby certify that the information contained herein is true and complete to the best of my knowledge and belief Signature: <u>James Blount</u> Printed Name: JAMES BLOUNT Title: Area Supervisor Date: 10-7-97
				18 SURVEYOR CERTIFICATION I hereby certify that the well location shown on this plat was plotted from field notes of actual surveys made by me or under my supervision, and that the same is true and correct to the best of my belief. Date of Survey: Signature and Seal of Professional Surveyor:
				Certificate Number

SOUTHWEST ROYALTIES

PROJECT JULIE Com #1

PAGE _____ OF _____

BY _____ DATE _____

CURRENT

AS SWD

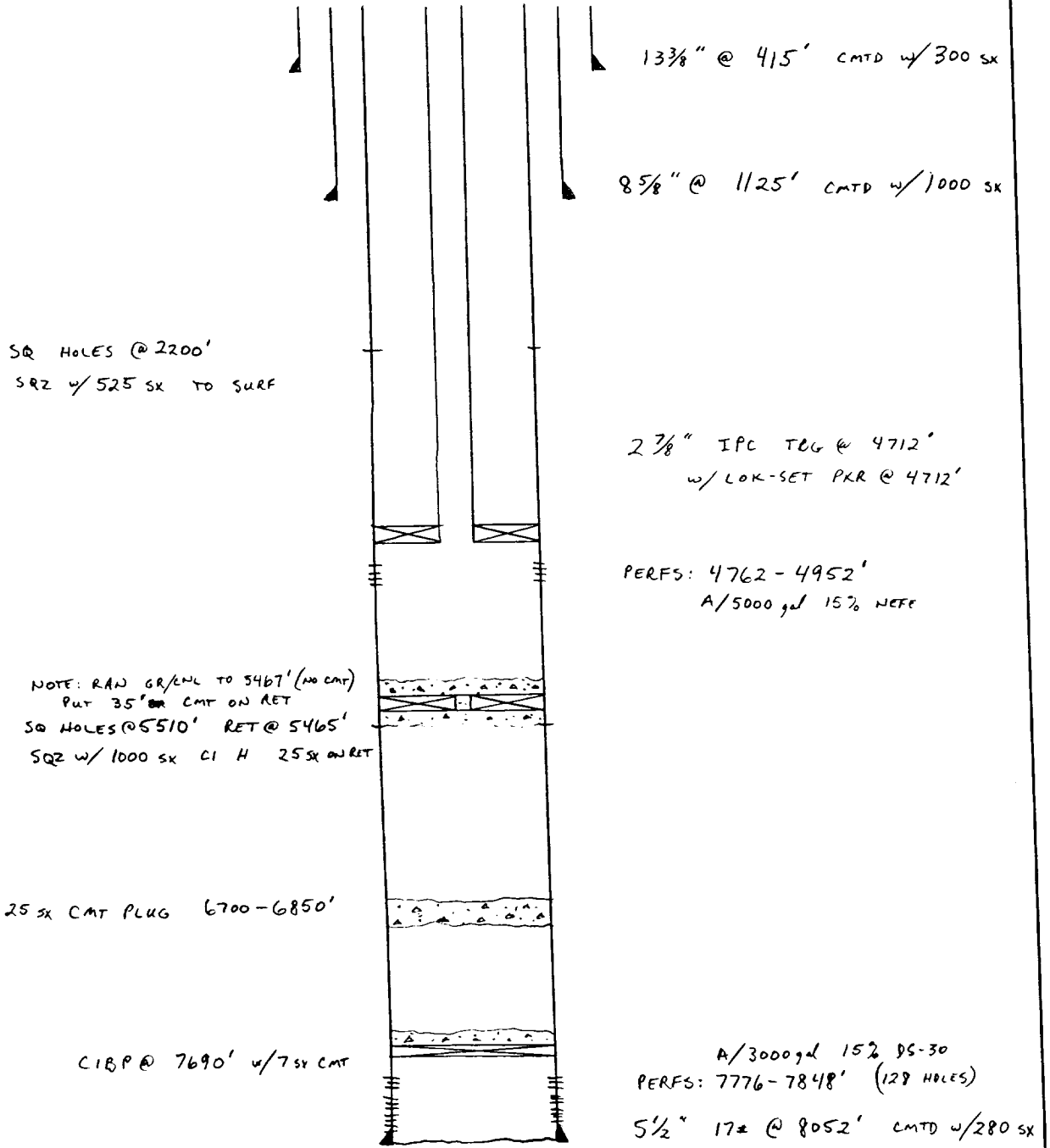

JOB 9/12/97

SOUTHWEST ROYALTIES, INC.

Structure : JULIE COM NO. 1 Slot : slot #1
 Field : N. DAGGER DRAW Location : EDDY COUNTY, NM.

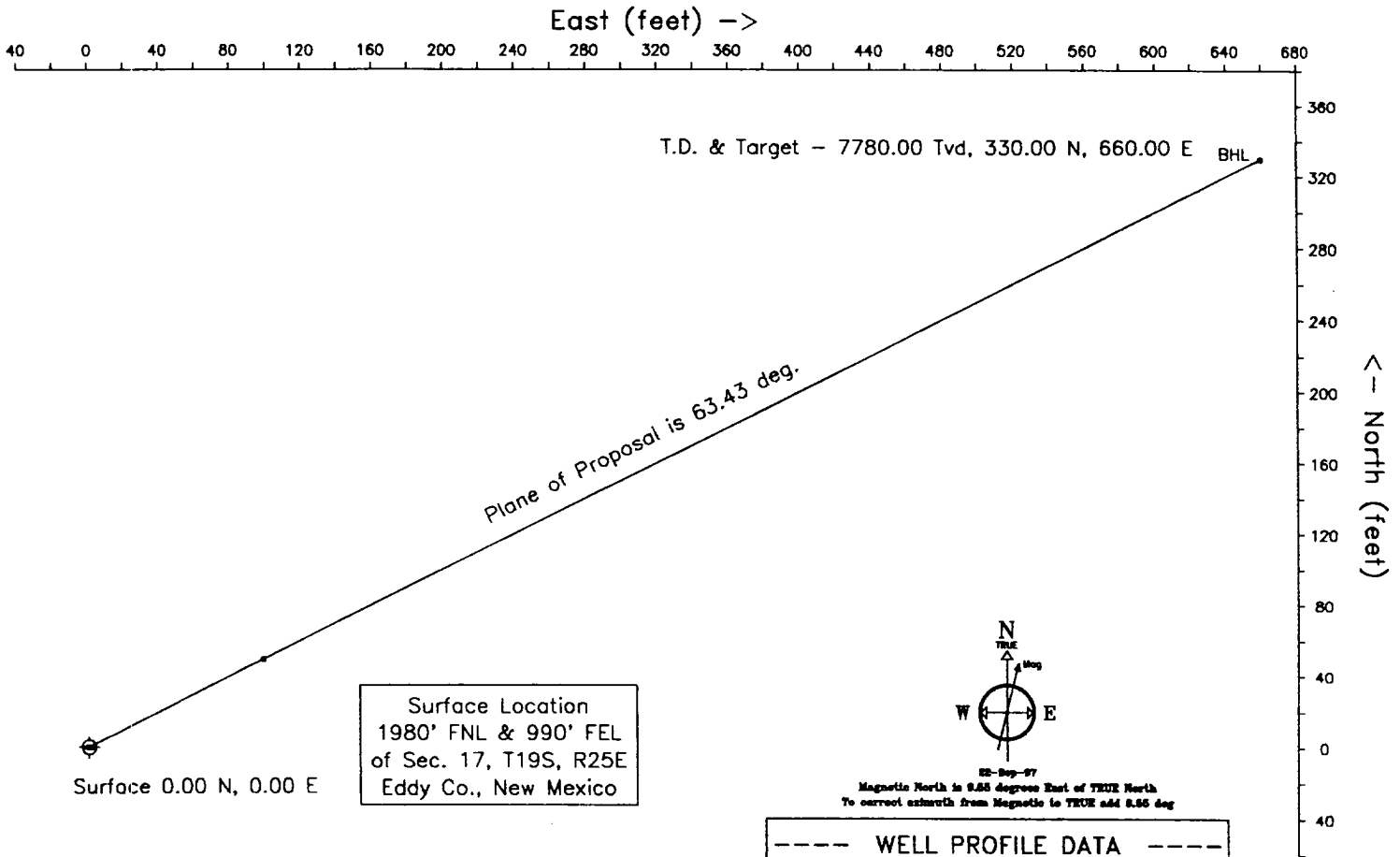

Surface Location
 1980' FNL & 990' FEL
 of Sec. 17, T19S, R25E
 Eddy Co., New Mexico

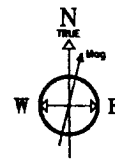

02-Sep-97
 Magnetic North is 0.55 degrees East of TRUE North
 To correct azimuth from Magnetic to TRUE add 0.55 deg

----- WELL PROFILE DATA -----									
Point	MD	Inc	Dr	Tvd	North	East	V. Dist	Dep/100	
Surf	0.00	0.00	0.00	0.00	0.00	0.00	0.00	0.00	
KOP	7670.00	0.00	83.43	7670.00	0.00	0.00	0.00	0.00	
End of Build	7842.79	90.00	83.43	7780.00	110.00	110.00	110.00	02.00	
TD & Target BHL	8470.69	90.00	83.43	7780.00	737.90	737.90	778.00	0.00	

