

NO. OF COPIES RECEIVED	
DISTRIBUTION	
SANTA FE	1
FILE	1
U.S.G.S.	2
LAND OFFICE	1
OPERATOR	1

NEW MEXICO OIL CONSERVATION COMMISSION

30-015-23685  
Form C-101  
Revised 1-1-65

MAR 04 1981

C. C. D.  
ARTESIA OFFICE

5A. Indicate Type of Lease  
STATE  FEE

5. State Oil & Gas Lease No.  
B-8876

APPLICATION FOR PERMIT TO DRILL, DEEPEN, OR PLUG BACK

1a. Type of Work		7. Unit Agreement Name	
b. Type of Well DRILL <input checked="" type="checkbox"/> DEEPEN <input type="checkbox"/> PLUG BACK <input type="checkbox"/> OIL WELL <input checked="" type="checkbox"/> GAS WELL <input type="checkbox"/> OTHER <input type="checkbox"/> SINGLE ZONE <input checked="" type="checkbox"/> MULTIPLE ZONE <input type="checkbox"/>		Turkey Track Sec. 3 Ut.	
2. Name of Operator Marbob Energy Corp. ✓		8. Farm or Lease Name Turkey Track Sec. 3 Ut.	
3. Address of Operator P.O. Box 304, Artesia, N.M. 88210		9. Well No. 24	
4. Location of Well UNIT LETTER G LOCATED 2310 FEET FROM THE North LINE AND 1650 FEET FROM THE East LINE OF SEC. 3 TWP. 19S RGE. 29E NMPM		10. Field and Pool, or Wildcat Turkey Track SR-Q-G	
		12. County Eddy	
		19. Proposed Depth 3000'	19A. Formation Grayburg
		20. Rotary or C.T. Rotary	
21. Elevations (Show whether DF, RT, etc.) 3415'	21A. Kind & Status Plug. Bond Statewide active	21B. Drilling Contractor Stewart Bros Drlg. Co.	22. Approx. Date Work will start 3/4/81

PROPOSED CASING AND CEMENT PROGRAM

SIZE OF HOLE	SIZE OF CASING	WEIGHT PER FOOT	SETTING DEPTH	SACKS OF CEMENT	EST. TOP
11"	8 5/8"	24#	300'	Circulate	
7 7/8"	4 1/2"	10.50#	2950'	400 sax	

We propose to drill to approximately 300' and run 8 5/8" 24# casing, circulate cement, drill on to test the Grayburg formation at approximately 3000' and set 4 1/2" production string w/400 sax cement, 50/50 poz C, 2% gel. We do not anticipate gas at this depth and will not set up a blowout preventer program at this time.

APPROVAL ID-1  
API + M. Brub  
3-6-81

APPROVAL VALID FOR 180 DAYS  
PERMIT EXPIRES 9-4-81  
UNLESS DRILLING UNDERWAY

IN ABOVE SPACE DESCRIBE PROPOSED PROGRAM; IF PROPOSAL IS TO DEEPEN OR PLUG BACK, GIVE DATA ON PRESENT PRODUCTIVE ZONE AND PROPOSED NEW PRODUCTIVE ZONE. GIVE BLOWOUT PREVENTER PROGRAM, IF ANY.

I hereby certify that the information above is true and complete to the best of my knowledge and belief.  
Signed Carolyn Orris Title Production Clerk Date 3/3/81

(This space for State Use)

APPROVED BY W.A. Gressett TITLE SUPERVISOR, DISTRICT II DATE 3-4-81

CONDITIONS OF APPROVAL, IF ANY:

MEXICO OIL CONSERVATION COMMISSION  
WELL LOCATION AND ACREAGE DEDICATION PLAT

Form O-102  
Superseded by O-108  
Effective 10/1/85

All distances are to be from the center boundaries of the Section.

Operator <b>MARBOb ENERGY CORPORATION</b>		Lease <b>TURKEY TRACK UNIT</b>			Well No. <b>24</b>
Unit Letter <b>G</b>	Section <b>3</b>	Township <b>19 South</b>	Range <b>29 East</b>	County <b>Eddy</b>	
Sectional Position Location of Well: <b>2310</b> feet from the <b>North</b> line and <b>1650</b> feet from the <b>East</b> line					
Oil Level Elev. <b>3415</b>	Producing Formation <b>Grayburg</b>	Pool <b>Turkey Track SR-O-G</b>	Dedicated Acreage: <b>40</b> Acres		

1. Outline the acreage dedicated to the subject well by colored pencil or hatchure marks on the plat below.
2. If more than one lease is dedicated to the well, outline each and identify the ownership thereof (both as to working interest and royalty).
3. If more than one lease of different ownership is dedicated to the well, have the interests of all owners been consolidated by communitization, unitization, force-pooling, etc?

Yes  No If answer is "yes," type of consolidation \_\_\_\_\_

If answer is "no," list the owners and tract descriptions which have actually been consolidated. (Use reverse side of this form if necessary.) \_\_\_\_\_

No allowable will be assigned to the well until all interests have been consolidated (by communitization, unitization, forced-pooling, or otherwise) or until a non-standard unit, eliminating such interests, has been approved by the Commission.

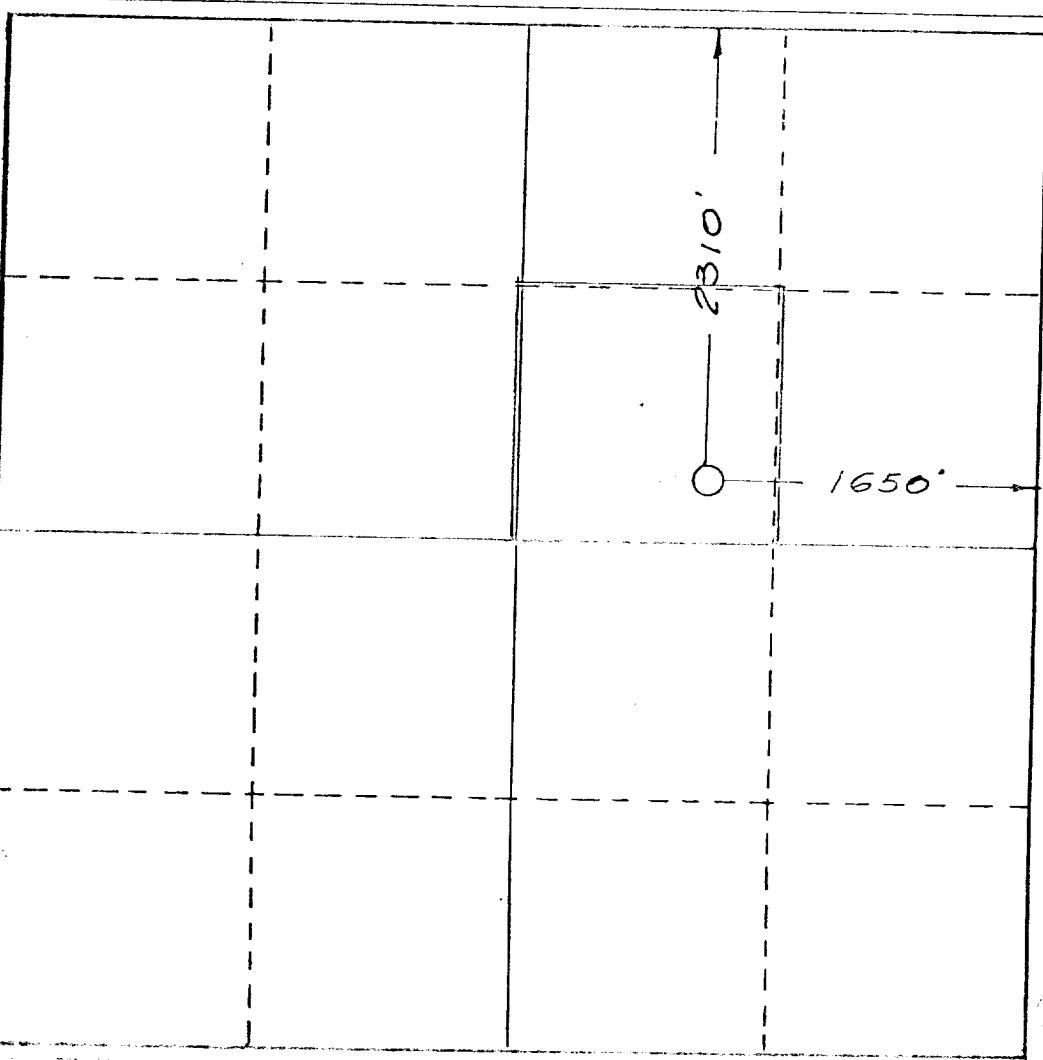

CERTIFICATION

I hereby certify that the information contained herein is true and complete to the best of my knowledge and belief.

*Carolyn Orris*  
Name

Carolyn Orris

Position  
Production Clerk

Company  
Marbob Energy Corp.

Date  
3/3/81

I hereby certify that the well location shown on this plat was plotted from field notes of actual surveys made by me or under my supervision, and that the same is true and correct to the best of my knowledge and belief.

Date Surveyed  
**May 15, 1980**

Registered Professional Engineer and/or Land Surveyor

*John W. Dineen*

Certificate No. **1559**

