

RECEIVED  
NEW MEXICO OIL CONSERVATION COMMISSION

AUG 07 1981

O. C. D.  
ARTESIA, OFFICE

30-015-23890

Form C-101  
Revised 1-1-65

NO. OF COPIES RECEIVED	
DISTRIBUTION	
SANTA FE	
FILE	1
U.S.G.S.	
LAND OFFICE	
OPERATOR	1

APPLICATION FOR PERMIT TO DRILL, DEEPEN, OR PLUG BACK

1a. Type of Work DRILL <input checked="" type="checkbox"/> DEEPEN <input type="checkbox"/> PLUG BACK <input type="checkbox"/>		7. Unit Agreement Name <u>Debbie</u>
b. Type of Well OIL WELL <input type="checkbox"/> GAS WELL <input checked="" type="checkbox"/> OTHER <input type="checkbox"/> SINGLE ZONE <input type="checkbox"/> MULTIPLE ZONE <input type="checkbox"/>		8. Farm or Lease Name <u>Debbie</u>
2. Name of Operator <u>Ralph Nix</u>		9. Well No. <u>#1</u>
3. Address of Operator <u>P.O. Box 617, Artesia, New Mexico 88210</u>		10. Field and Pool, or Wildcat <u>Wind Cemetery Morrow</u>
4. Location of Well UNIT LETTER <u>I</u> LOCATED <u>1980</u> FEET FROM THE <u>South</u> LINE AND <u>660</u> FEET FROM THE <u>East</u> LINE OF SEC. <u>11</u> TWP. <u>20 S</u> RGE. <u>24 E</u> NMRM		12. County <u>Eddy</u>
19. Proposed Depth <u>9600"</u>		19A. Formation <u>Morrow</u>
20. Rotary or C.T. <u>Rotary</u>		21. Elevations (Show whether DP, RT, etc.) <u>'3608' GL</u>
21A. Kind & Status Plug. Bond <u>Blanket</u>		22. Approx. Date Work will start <u>As soon as possible</u>

23. PROPOSED CASING AND CEMENT PROGRAM

SIZE OF HOLE	SIZE OF CASING	WEIGHT PER FOOT	SETTING DEPTH	SACKS OF CEMENT	EST. TOP
17 1/2"	13 3/8th	48#	400'	circ. cement	
11"	8 5/8th	24#	1400'	circ. cement	
7 7/8"	5 1/2	15.5#-17#	9600'	350 sx.	

Blowout Prevent: Hydraulic B.O.P. with 3" flanged choke manifold.  
Size 10", Series 900 Shaffer Double Type.  
One 80 gallon 3 valve accumulator.

Gas not dedicated.

APPROVAL VALID FOR 180 DAYS  
PERMIT EXPIRES 2-11-82  
UNLESS DRILLING UNDERWAY

IN ABOVE SPACE DESCRIBE PROPOSED PROGRAM IF PROPOSAL IS TO DEEPEN OR PLUG BACK, GIVE DATA ON PRESENT PRODUCTIVE ZONE AND PROPOSED NEW PRODUCTIVE ZONE. GIVE BLOWOUT PREVENTER PROGRAM, IF ANY.

I hereby certify that the information above is true and complete to the best of my knowledge and belief.

Signed William J. Mc... Title \_\_\_\_\_ Date August 7, 1981

(This space for State Use)

APPROVED BY W.A. Gressett TITLE SUPERVISOR, DISTRICT II DATE AUG 11 1981

CONDITIONS OF APPROVAL, IF ANY:

Cement must be circulated to  
surface behind 13 3/8" & 8 5/8" casing

Notify N.M.O.C.C. in sufficient  
time to witness cementing  
the 8 5/8" casing

All distances must be from the outer boundaries of the Section.

Operator <b>Ralph Nix</b>		Lease <b>Debbie</b>		Well No. <b>'1'</b>
Unit Letter <b>I</b>	Section <b>11</b>	Township <b>20 South</b>	Range <b>24 East</b>	County <b>Eddy</b>
Actual Footage Location of Well:				
<b>660</b> feet from the <b>East</b> line and <b>1980</b> feet from the <b>South</b> line				
Ground Level Elev. <b>3608</b>	Producing Formation <b>Morrow</b>	Pool <b>und</b> <b>Cemetery</b>	Dedicated Acreage: <b>320</b>	Acres

1. Outline the acreage dedicated to the subject well by colored pencil or hatchure marks on the plat below.
2. If more than one lease is dedicated to the well, outline each and identify the ownership thereof (both as to working interest and royalty).
3. If more than one lease of different ownership is dedicated to the well, have the interests of all owners been consolidated by communitization, unitization, force-pooling, etc?

☐ Yes ☒ No If answer is "yes," type of consolidation will be communitized if productive

If answer is "no," list the owners and tract descriptions which have actually been consolidated. (Use reverse side of this form if necessary.)  
No allowable will be assigned to the well until all interests have been consolidated (by communitization, unitization, forced-pooling, or otherwise) or until a non-standard unit, eliminating such interests, has been approved by the Division.

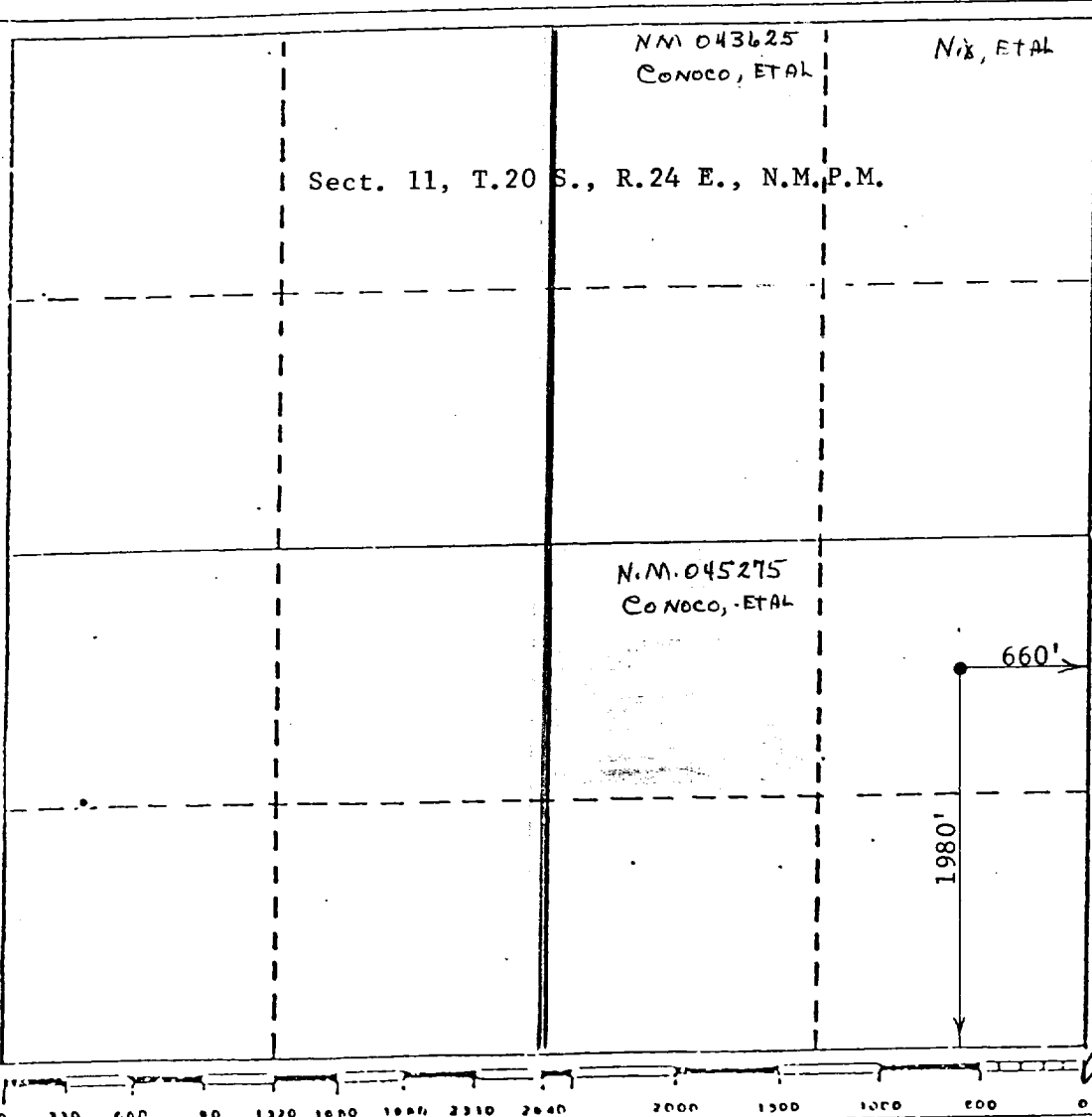

**CERTIFICATION**

I hereby certify that the information contained herein is true and complete to the best of my knowledge and belief.

*William J. McCaw*  
Name  
William J. McCaw  
Position  
Operation Manager  
Company  
Ralph Nix  
Date  
August 7, 1981

I hereby certify that the well location shown on this plat was plotted from field notes of actual surveys made by me or under my supervision, and that the same is true and correct to the best of my knowledge and belief.

**JOHN D. JAQUES**  
NEW MEXICO  
August 4, 1981  
Registered Professional Engineer  
and/or Land Surveyor  
John D. Jaques, P.E. & L.S.  
Certificate No. 6290