

NO. OF COPIES RECEIVED	
DISTRIBUTION	
SANTA FE	<input checked="" type="checkbox"/>
FILE	<input checked="" type="checkbox"/>
U.S.G.S.	<input checked="" type="checkbox"/>
LAND OFFICE	<input checked="" type="checkbox"/>
OPERATOR	<input checked="" type="checkbox"/>

NEW MEXICO OIL CONSERVATION COMMISSION

Form C-101
Revised 1-1-65

AUG 19 '88

O.C.D.

5A. Indicate Type of Lease
STATE <input checked="" type="checkbox"/> FEE <input type="checkbox"/>
5. State Oil & Gas Lease No.
K-4169

APPLICATION FOR PERMIT TO DRILL, DEEPEN, OR PLUG BACK

1a. Type of Work		7. Unit Agreement Name	
b. Type of Well OIL WELL <input checked="" type="checkbox"/> GAS WELL <input type="checkbox"/> OTHER <input type="checkbox"/>		8. Farm or Lease Name	
2. Name of Operator		9. Well No.	
3. Address of Operator		10. Field and Pool, or Wildcat	
4. Location of Well		12. County	
UNIT LETTER <u>G</u> LOCATED <u>1980</u> FEET FROM THE <u>North</u> LINE		Eddy	
AND <u>1980</u> FEET FROM THE <u>East</u> LINE OF SEC. <u>26</u> TWP. <u>19S</u> RGE. <u>29E</u> NMPM			
19. Proposed Depth		19A. Formation	
8350		Bone Springs	
20. Rotary or C.T.		Reverse Unit	
21. Elevations (Show whether DF, RT, etc.)		22. Approx. Date Work will start	
3353.3 GR		ASAP	
21A. Kind & Status Plug. Bond		21B. Drilling Contractor	
Blanket			

PROPOSED CASING AND CEMENT PROGRAM

SIZE OF HOLE	SIZE OF CASING	WEIGHT PER FOOT	SETTING DEPTH	SACKS OF CEMENT	EST. TOP
15"	11 3/4"	42#	350'	600	Circulate
11"	8 5/8"	24# & 32#	3100'	1400	Circulate
7 7/8"	4 1/2"	11.6# & 13.5#	8350'	650	

Dig out well-head and flange up B.O.P.
Drill out plugs. Set pipe at 8350'. Proceed to test zones of interest. If oil not found in quantity, well will be plugged according to State Regulations.

For: The Petroleum Corp. - Peter A. H. #1
P & A 12-12-81
ATD 10,250

APPROVAL VALID FOR 180 DAYS
PERMIT EXPIRES 2/15/89
UNLESS DRILLING UNDERWAY

POST 10#1
NL 8-26-88

IN ABOVE SPACE DESCRIBE PROPOSED PROGRAM; IF PROPOSAL IS TO DEEPEN OR PLUG BACK, GIVE DATA ON PRESENT PRODUCTIVE ZONE AND PROPOSED NEW PRODUCTIVE ZONE. GIVE BLOWOUT PREVENTER PROGRAM, IF ANY.

I hereby certify that the information above is true and complete to the best of my knowledge and belief.

Signed Frank A. Murg Title Operator Date August 19, 1988

(This space for State Use)

Original Signed By

APPROVED BY Mike Williams TITLE

DATE AUG 19 1988

CONDITIONS OF APPROVAL, IF ANY:

**NEW MEXICO OIL CONSERVATION COMMISSION
WELL LOCATION AND ACREAGE DEDICATION PLAT**

Form C-122
Supersede C-120
Effective 1-1-65

All distances must be from the outer boundaries of the Section

Lessor MorOilCo., Inc.			Lease Halcon State			Well No. #1		
Section G	Section 26	Township 19 SOUTH	Range 29 EAST	County EDDY				
Well Location of Well: 1980 feet from the NORTH line and 1980 feet from the EAST line								
Level Elev. 3353.3	Producing Formation Bone Springs		Pool Undes.			Estimated Acreage 40		

Outline the acreage dedicated to the subject well by colored pencil or hatchure marks on the plat below.

If more than one lease is dedicated to the well, outline each and identify the ownership thereof (both as to working interest and royalty). **SEE BACK** Royalty - State of New Mexico

If more than one lease of different ownership is dedicated to the well, have the interests of all owners been consolidated by communitization, unitization, force-pooling, etc?

☐ Yes ☒ No If answer is "yes," type of consolidation will communitization upon completion

If answer is "no," list the owners and tract descriptions which have actually been consolidated. (If on reverse side of this form if necessary.)

No allowable will be assigned to the well until all interests have been consolidated (by communitization, unitization, forced-pooling, or otherwise) or until a non-standard unit, eliminating such interests, has been approved by the Commission.

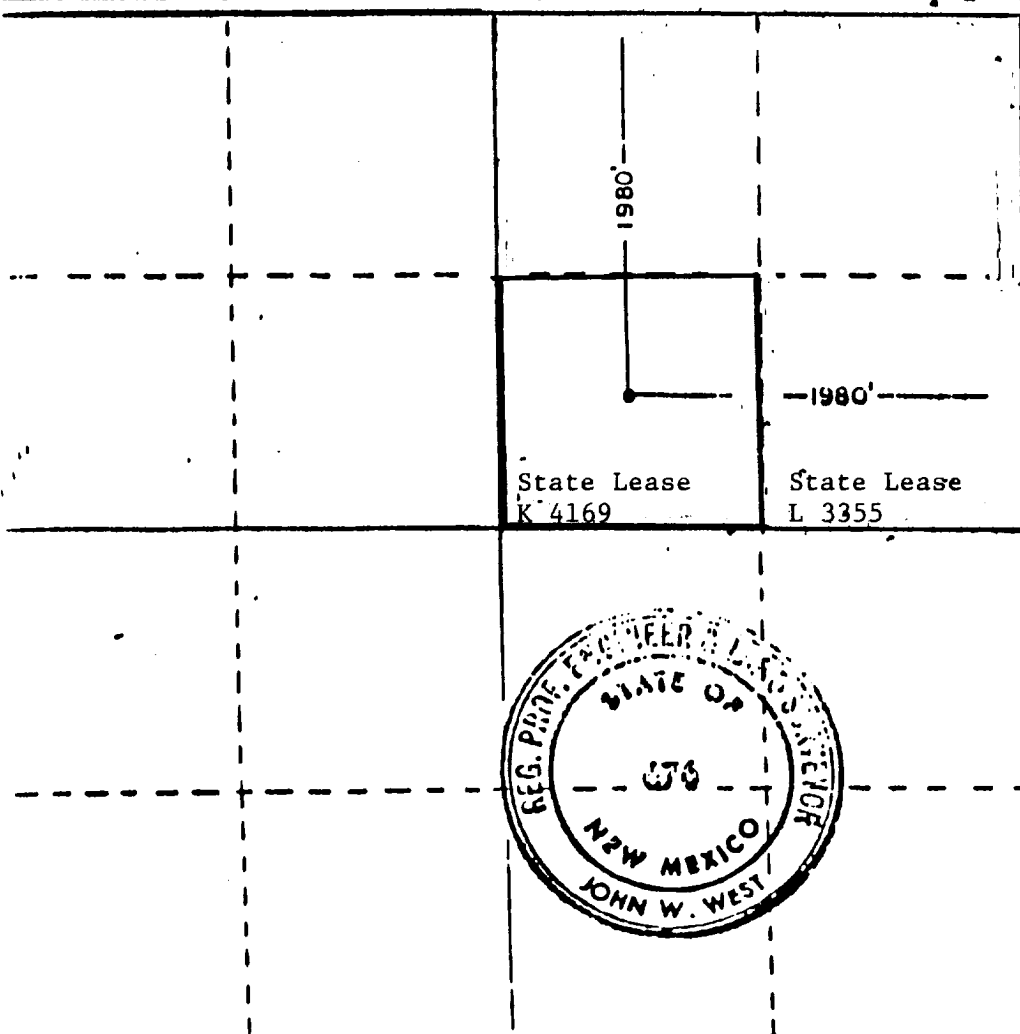

CERTIFICATION

I hereby certify that the information contained herein is true and complete to the best of my knowledge and belief.

Frank S. Morgan

Frank S. Morgan

Position

Operator

Company

MorOilCo., Inc.

Date

9/19/88

I hereby certify that the well location shown on this plat was plotted from field notes of actual surveys made by me or under my supervision and that the same is true and correct to the best of my knowledge and belief.

Date Surveyed

8-4-81

Registered Professional Engineer
in Land Surveying

John W. West

Certificate No. **JOHN W. WEST 578**
PATRICK A. BUREAU 5908

BLOWOUT PREVENTER A CHOKE MANIFOLD

API 3M-8410-RdS

