

STATE OF NEW MEXICO  
ENERGY AND MINERALS DEPARTMENT

C.L. CONSERVATION DIVISION

P. O. BOX 2088

SANTA FE, NEW MEXICO 87501

RECEIVED BY

OCT 29 1984

O.C.D.  
ARTESIA, OFFICE

Form C-101 30-015-25070  
Revised 10-1-78

NO. OF COPIES RECEIVED	
DISTRIBUTION	
SANTA FE	<input checked="" type="checkbox"/>
FILL	<input checked="" type="checkbox"/>
U.S.G.S.	<input checked="" type="checkbox"/>
LAND OFFICE	<input checked="" type="checkbox"/>
OPERATOR	<input checked="" type="checkbox"/>

5A. Indicate Type of Lease  
STATE ☒ FEE ☐  
5. State Oil & Gas Lease No.

APPLICATION FOR PERMIT TO DRILL, DEEPEN, OR PLUG BACK

1a. Type of Work  
DRILL ☒ DEEPEN ☐ PLUG BACK ☐  
b. Type of Well  
OIL WELL ☒ GAS WELL ☐ OTHER ☐ SINGLE ZONE ☐ MULTIPLE ZONE ☐

3. Name of Operator  
Tenneco Oil Company ☒  
7. Unit Agreement Name

4. Address of Operator  
7990 IH-10 West, San Antonio, TX 78230  
8. Farm or Lease Name  
State HL 2

6. Location of Well  
UNIT LETTER E LOCATED 1650 FEET FROM THE North LINE  
9. Well No.  
2

AND 330 FEET FROM THE West LINE OF SEC. 2 TWP. 19S RGE. 29E NMPM  
10. Field and Pool, or Wildcat  
Turkey Track W-4-6-11

12. County  
Eddy

19. Proposed Depth  
3300'  
19A. Formation  
San Andres  
19B. Rotary or C.T.  
Rotary  
1. Elevations (show whether D.P., R.T., etc.)  
3409.2 GR  
21A. Kind & Status Plug. Bond  
Blanket  
21B. Drilling Contractor  
22. Approx. Date Work will start  
10/30/84

PROPOSED CASING AND CEMENT PROGRAM

SIZE OF HOLE	SIZE OF CASING	WEIGHT PER FOOT	SETTING DEPTH	SACKS OF CEMENT	EST. TOP
12-1/4"	8-5/8	24#	300'	190	Surface
7-7/8	5-1/2	15.5#	3300'	522	Surface

- Construct suitable location. Reserve pits, working pits, rat hole, mouse hole, cellar may be provided by operator or drilling contractor, and will be determined in conjunction with selection of drilling contractor/rig.
- MIRU. Drill 12-1/4" hole to 300' +/- . Plan to dry drill from 80' +/- to 300'.
- CCM to run casing. SLM out of hole. Set 8-5/8" casing in full compression at 300' +/- . Run casing, cement and centralize.
- WOC 18 hours. Cut of 8-5/8" casing. Install (See Note #1) wellhead. Test weld to 680 psi (1/2 of csg collapse strength for SOW heads).
- NU following BOPE: 3M Double Ram BOPE (pipe on BTM. - Blinds on top). Test to 1000 PSIG when testing casing.
- PU 7-7/8 bit and following BHA: Slick. RIH to top of float collar. Test casing to 1000 psi for 30 minutes. Test is satisfactory if pressure does not decrease more than 10% of test pressure by end of test. Record test on IADC Report and include details in daily drilling report to TOC SWD. Insure compliance with State of NM Rule 107 before testing and drilling out.

Continued on reverse side.

APPROVAL VALID FOR 180 DAYS  
PERMIT EXPIRES 4-30-85  
UNLESS DRILLING UNDERWAY

ABOVE SPACE DESCRIBE PROPOSED PROGRAM. IF PROPOSAL IS TO DEEPEN OR PLUG BACK, GIVE DATA ON PRESENT PRODUCTIVE ZONE AND PROPOSED NEW PRODUCTIVE ZONE. GIVE BLOWOUT PREVENTER PROGRAM, IF ANY.

I hereby certify that the information above is true and complete to the best of my knowledge and belief.

Signed Ladell Collier Title Geological Engineer Date October 25, 1984

(This space for State Use)

Original Signed By  
Mike Williams

PROVED BY Oil & Gas Inspector

DATE OCT 30 1984

Post ID-1

11-2-84

New loc + API

7. Drill 7-7/8" hole to +/- 3300'. Log, as per G.E. Beware of washouts/cave-ins around rig substructure.
8. RIH w/DP and bit to TD. CCM to run 5-1/2" casing, or to P&A. If well is to be P&A'd, RIH open-ended and set cement plugs in accordance with regulatory agency instructions.
9. If not P&A'd, set 5-1/2" production casing @ 3,000'. Run casing, cement and centralize as per attached casing and cementing program. Fill casing every 20 joints while running in hole. Set full casing weight on slips. Check float equip operation.
10. C.O. casing. ND BOPE and install (See Note #2) tubing head. Test to 1500 psi. NU dry hole tree. Release rig.

Notes: 1. 8-5/8" x 11' 3M SOW casing head w/2 - 2" LPO, 1 solid bull plug and 1 3M ball valve.

2. 11" x 7-1/16" 3M tubing head w/2 - 2" LPO, 1 solid bull plug and a 3M ball valve.

/ MEXICO OIL CONSERVATION COMMISSION  
WELL LOCATION AND ACREAGE DEDICATION PLAT

Form C-102  
Supersedes C-128  
Effective 1-1-65

All distances must be from the outer boundaries of the Section.

Operator <b>TENNECO OIL COMPANY</b>			Lease <b>STATE H.L. 2</b>		Well No. <b>2</b>
Initial Letter <b>E</b>	Section <b>2</b>	Township <b>19-SOUTH</b>	Range <b>29-EAST</b>	County <b>EDDY</b>	
Actual Footage Location of Well: <b>1650</b> feet from the <b>NORTH</b> line and <b>330</b> feet from the <b>WEST</b> line					
Ground Level Elev. <b>3409.2 FEET</b>	Producing Formation <b>SAN ANDRES</b>		Pool <b>TURKEY TRACK</b>		Dedicated Acreage: <b>40</b> Acres

1. Outline the acreage dedicated to the subject well by colored pencil or hachure marks on the plat below.
2. If more than one lease is dedicated to the well, outline each and identify the ownership thereof (both as to working interest and royalty).
3. If more than one lease of different ownership is dedicated to the well, have the interests of all owners been consolidated by communitization, unitization, force-pooling, etc?

☐ Yes ☐ No If answer is "yes," type of consolidation \_\_\_\_\_

If answer is "no," list the owners and tract descriptions which have actually been consolidated. (Use reverse side of this form if necessary.) \_\_\_\_\_

No allowable will be assigned to the well until all interests have been consolidated (by communitization, unitization, forced-pooling, or otherwise) or until a non-standard unit, eliminating such interests, has been approved by the Commission.

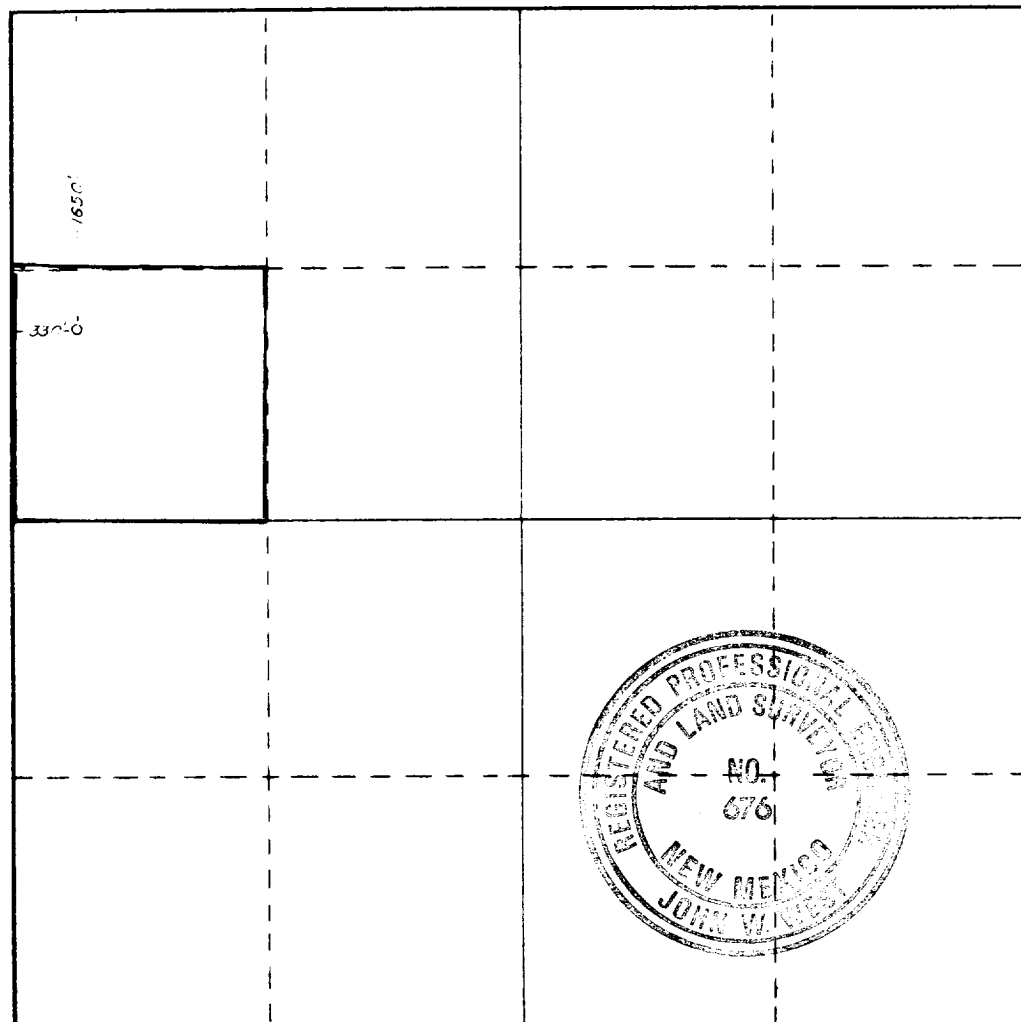

**CERTIFICATION**

I hereby certify that the information contained herein is true and complete to the best of my knowledge and belief.

*Ladell Collier*

Name

Ladell Collier

Position

Geological Engineer

Company

Tenneco Oil Co.

Date

October 25, 1984

I hereby certify that the well location shown on this plat was plotted from field notes of actual surveys made by me or under my supervision, and that the same is true and correct to the best of my knowledge and belief.

Date Surveyed

10/17/84

Registered Professional Engineer  
and/or Land Surveyor

*John W. West*

Certificate No. **JOHN W. WEST, 676**  
**RONALD J. EIDSON, 3239**

