

30-015-25181

NO. OF COPIES RECEIVED	
DISTRIBUTION	
ANTAFE	✓
FILE	✓
U.S.G.S.	2
LAND OFFICE	
OPERATOR	✓

RECEIVED BY
FEB 4 1985
O. C. D.
ARTESIA, OFFICE

NEW MEXICO OIL CONSERVATION COMMISSION

Form C-101
Revised 1-1-65

5A. Indicate Type of Lease
STATE FEE

5. State Oil & Gas Lease No.

7. Unit Agreement Name

8. Farm or Lease Name
Anderson Com.

9. Well No.
1

10. Field and Pool, or Wildcat
Cemetery Morrow

12. County
Eddy

19. Proposed Depth
9800'

19A. Formation
Morrow

20. Rotary or C.T.
Rotary

21. Elevations (Show whether DF, RT, etc.)
3404.3' 66'

21A. Kind & Status Plug. Bond
Blanket

21B. Drilling Contractor
Hondo Drilling

22. Approx. Date Work will start
February 8, 1985

APPLICATION FOR PERMIT TO DRILL, DEEPEN, OR PLUG BACK

1a. Type of Work

b. Type of Well
 DRILL DEEPEN PLUG BACK
 OIL WELL GAS WELL OTHER SINGLE ZONE MULTIPLE ZONE

2. Name of Operator
Chama Petroleum Company ✓ **314-739-1728**

3. Address of Operator
P.O. Box 31405 Dallas, Texas 75231

4. Location of Well
 UNIT LETTER **W-2 B** LOCATED **660** FEET FROM THE **North** LINE
 AND **1980** FEET FROM THE **East** LINE OF SEC. **10** TWP. **20S** RGE. **25E** NMPM

23.

PROPOSED CASING AND CEMENT PROGRAM

SIZE OF HOLE	SIZE OF CASING	WEIGHT PER FOOT	SETTING DEPTH	SACKS OF CEMENT	EST. TOP
17 1/2"	13 3/8"	48#	350'	350 Sx	Circ.
11"	8 5/8"	24# & 28#	2800' 400	900 Sx	Circ.
7 7/8"	4 1/2" of 5 1/2"	11.6# or 17#	9800'	850 Sx	7500'

Propose to drill the well to evaluate the Morrow Formation. After reaching TD, logs will be run and casing set if evaluation is positive. Perforate, test and stimulate as necessary to establish production. BOP program attached. Gas not dedicated.

APPROVAL MAILED FOR 180 DAYS
 FEBRUARY 8 11-85
 UNLESS DRILLING UNDERWAY

IN ABOVE SPACE DESCRIBE PROPOSED PROGRAM: IF PROPOSAL IS TO DEEPEN OR PLUG BACK, GIVE DATA ON PRESENT PRODUCTIVE ZONE AND PROPOSED NEW PRODUCTIVE ZONE. GIVE BLOWOUT PREVENTER PROGRAM, IF ANY.

I hereby certify that the information above is true and complete to the best of my knowledge and belief.

Signed *Mike Williams* Title President Date January 30, 1985

(This space for State Use) _____
 APPROVED BY Mike Williams
Oil & Gas Inspector DATE FEB 11 1985

CONDITIONS OF APPROVAL, IF ANY:
 use 8 5/8 casing

N MEXICO OIL CONSERVATION COMMISS
WELL LOCATION AND ACREAGE DEDICATION PLAT

Form C-102
 Superseded C-128
 Effective 1-1-65

All distances must be from the outer boundaries of the Section

Operator CHAMA PETROLEUM CO.			Lease CHAMA & ANDERSON COM		Well No. 1
Tract Letter B	Section 10	Township 20 SOUTH	Range 25 EAST	County EDDY	
Actual Fracture Location of Well: 660 feet from the NORTH line and 1980 feet from the EAST line					
Ground Level Elev. 3404.3	Producing Formation MORROW - PENN	Pool CEMETARY MORROW		Dedicated Acreage: 3.20 Acres	

1. Outline the acreage dedicated to the subject well by colored pencil or hachure marks on the plat below.
2. If more than one lease is dedicated to the well, outline each and identify the ownership thereof (both as to working interest and royalty).
3. If more than one lease of different ownership is dedicated to the well, have the interests of all owners been consolidated by communitization, unitization, force-pooling, etc?

Yes No If answer is "yes," type of consolidation Will be communitized upon completion

If answer is "no," list the owners and tract descriptions which have actually been consolidated. (Use reverse side of this form if necessary.) _____

No allowable will be assigned to the well until all interests have been consolidated (by communitization, unitization, forced-pooling, or otherwise) or until a non-standard unit, eliminating such interests, has been approved by the Commission.

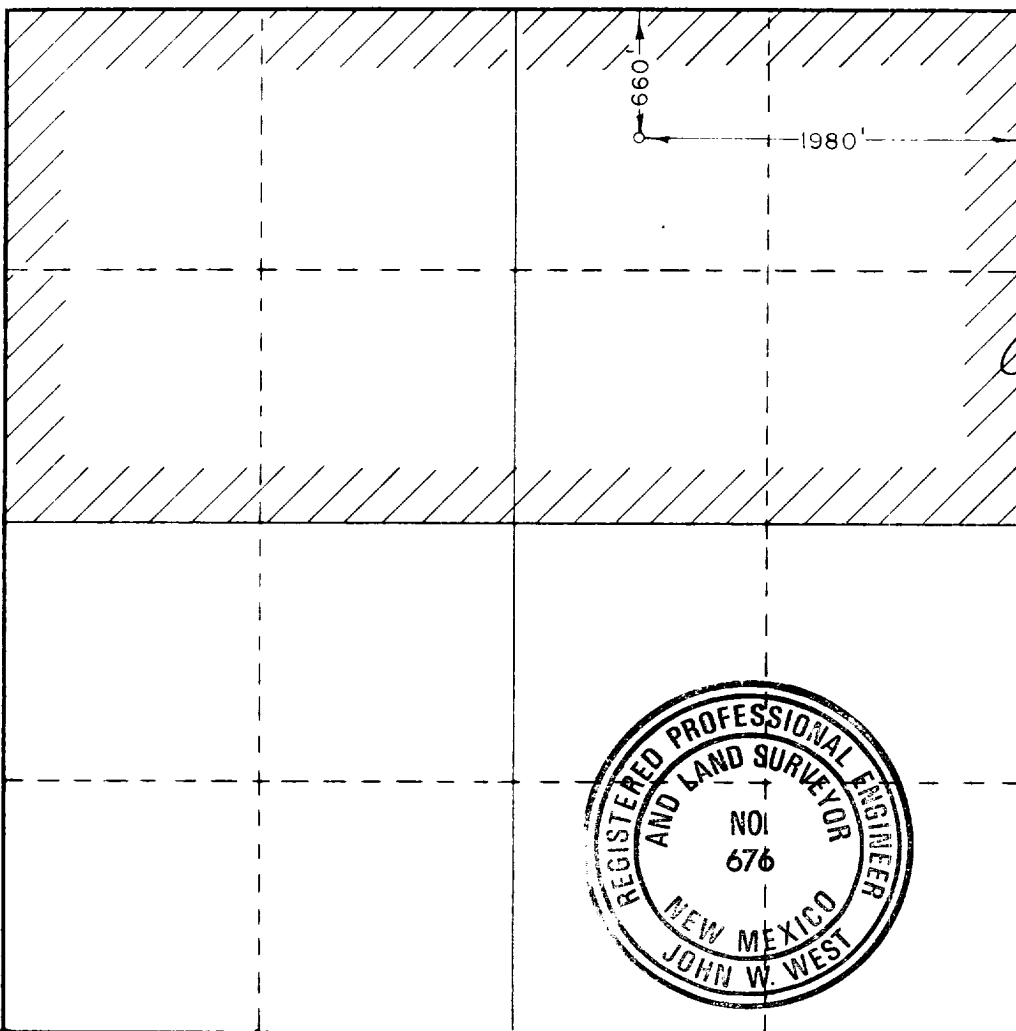

CERTIFICATION

I hereby certify that the information contained herein is true and complete to the best of my knowledge and belief.

Name *John W. West*
 Position
 AGENT
 Company
 CHAMA PETROLEUM CO.
 Date
 FEBRUARY 2, 1985

I hereby certify that the well location shown on this plat was plotted from field notes of actual surveys made by me or under my supervision, and that the same is true and correct to the best of my knowledge and belief.

Date Surveyed
 FEBRUARY 2, 1985
 Registered Professional Engineer
 and/or Land Surveyor

John W. West

Certificate No. JOHN W. WEST, 676
 RONALD J. EIDSON, 3239

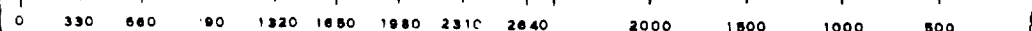

BLOWOUT PREVENTER SKETCH
Chama Petroleum Company
Well #1 Anderson Com.
660' FNL & 1980' FEL Sec. 10, 20S, 25E

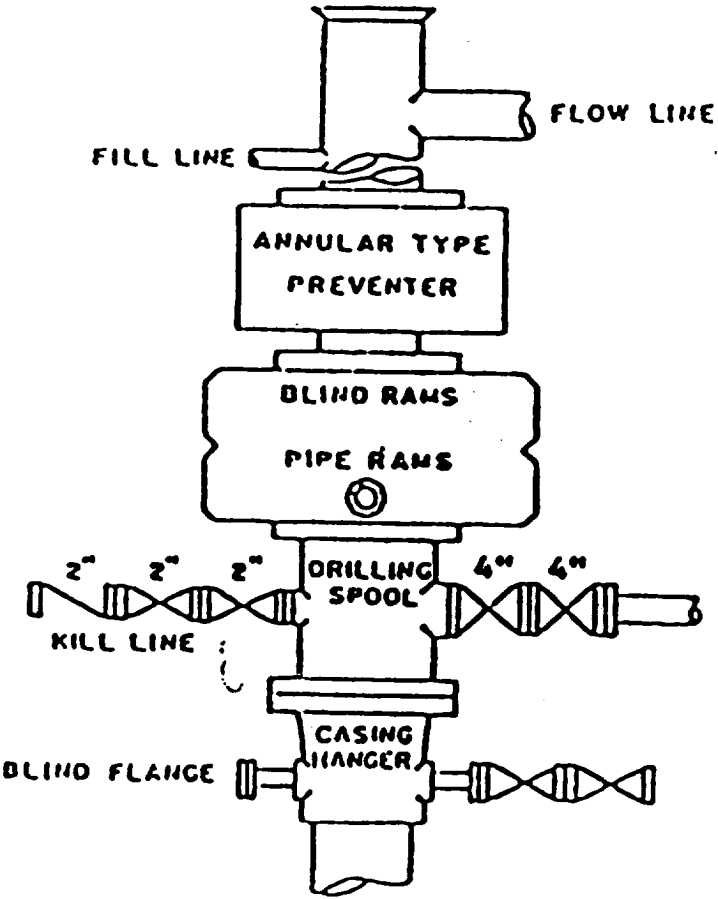

900 SERIES