

Submit to Appropriate District Office
State Lease - 6 copies
Fee Lease - 5 copies

State of New Mexico
Energy, Minerals and Natural Resources Department

Form C-101
Revised 1-1-89

FILE

OIL CONSERVATION DIVISION

DISTRICT I
P.O. Box 1980, Hobbs, NM 88240

APR 27 '89
P.O. Box 2088
Santa Fe, New Mexico 87504-2088

DISTRICT II
P.O. Drawer DD, Artesia, NM 88210

O. C. D.
ARTESIA OFFICE

DISTRICT III
1000 Rio Brazos Rd., Aztec, NM 87410

API NO. (assigned by OCD on New Wells)

30-015-26113

5. Indicate Type of Lease
STATE FEE

6. State Oil & Gas Lease No.
L-3355

7. Lease Name or Unit Agreement Name

Petco State

8. Well No.
#3

9. Pool name or Wildcat
Parkway Delaware

APPLICATION FOR PERMIT TO DRILL, DEEPEN, OR PLUG BACK

1a. Type of Work:
DRILL RE-ENTER DEEPEN PLUG BACK
b. Type of Well:
OIL WELL GAS WELL OTHER
SINGLE ZONE MULTIPLE ZONE

2. Name of Operator
Strata Production Company

3. Address of Operator
648 Petroleum Bldg., Roswell, New Mexico 88201

4. Well Location
Unit Letter N : 330 Feet From The South Line and 2310 Feet From The West Line

Section 26 Township 19S Range 29E NMPM Eddy County

10. Proposed Depth 4900'
11. Formation Delaware
12. Rotary or C.T. Rotary

13. Elevations (Show whether DF, RT, GR, etc.) 3324.6 GR
14. Kind & Status Plug. Bond Blanket
15. Drilling Contractor WEK
16. Approx. Date Work will start ASAP

17. PROPOSED CASING AND CEMENT PROGRAM					
SIZE OF HOLE	SIZE OF CASING	WEIGHT PER FOOT	SETTING DEPTH	SACKS OF CEMENT	EST. TOP
17 1/2"	13 3/8"	48#	350'	350 sx	Circ.
12 1/4"	8 5/8"	24#	3200'	3100 sx	Circ.
7 7/8"	5 1/2"	17.5#	4900'	650 sx	

Drill 17 1/2" hole to a depth of 350' and cement with 350 sx. CI "C" and circ. to surface.
Drill 12 1/4" hole to a depth of 3200' and 8 5/8" 24#. ~~D.V. tool set at 1600' approx.~~
~~1st. stage: 1000 sx CI "C". 2nd. stage 2100 sx to surface.~~ Drill to a total depth of 4900'. Sufficient to test zones of interest.

Mud Program: Surface-350' spud mud. 350' to T.D. with ~~brine and cut brine~~ Fresh Water
M.W. 9-9.5 Visc. 32-36 W.L. 10-15.

BOP diagram attached.

APPROVAL VALID FOR 180 DAYS
PERMIT EXPIRES 11/4/89
UNLESS DRILLING UNDERWAY

POSTED TO
APR. 21
5-5-89

IN ABOVE SPACE DESCRIBE PROPOSED PROGRAM: IF PROPOSAL IS TO DEEPEN OR PLUG BACK, GIVE DATA ON PRESENT PRODUCTIVE ZONE AND PROPOSED NEW PRODUCTIVE ZONE. GIVE BLOWOUT PREVENTER PROGRAM, IF ANY.

I hereby certify that the information above is true and complete to the best of my knowledge and belief.

SIGNATURE James G. McClelland TITLE Vice-President of Adm. DATE April 26, 1989

TYPE OR PRINT NAME James G. McClelland TELEPHONE NO. 505-622-1127

(This space for State Use)

Original Signed By
Mike Williams

MAY 4 1989

APPROVED BY _____ TITLE _____ DATE _____

CONDITIONS OF APPROVAL, IF ANY:

Notify N.M.O.C.C. in sufficient time to witness cementing the 8 5/8 casing

Submit to Appropriate District Office
 State Lease - 4 copies
 Fee Lease - 3 copies

State of New Mexico
 Energy, Minerals and Natural Resources Department

Form C-102
 Revised 11-89

OIL CONSERVATION DIVISION
 P.O. Box 2088
 Santa Fe, New Mexico 87504-2088

DISTRICT I
 P.O. Box 1980, Hobbs, NM 88240

DISTRICT II
 P.O. Drawer DD, Artesia, NM 88210

DISTRICT III
 1000 Rio Brazos Rd., Aztec, NM 87410

WELL LOCATION AND ACREAGE DEDICATION PLAT
 All Distances must be from the outer boundaries of the section

Operator Strata Production Co.			Lease Peteo State			Well No 3		
Unit Letter N	Section 26	Township 19 South	Range 29 East	County Eddy		NMPM		
Actual Footage Location of Well: 330 feet from the south line and			2310 feet from the west line			Dedicated Acreage 40 Acres		
Ground level Elev. 3324.6			Producing Formation Delaware			Und. Parkway Delaware		

- Outline the acreage dedicated to the subject well by colored pencil or hatchure marks on the plat below.
- If more than one lease is dedicated to the well, outline each and identify the ownership thereof (both as to working interest and royalty).
- If more than one lease of different ownership is dedicated to the well, have the interest of all owners be consolidated by communitization, unitization, force pooling, etc.?
 - Yes
 - No
 If answer is "yes" type of consolidation
 If answer is "no" list the owners and tract descriptions which have actually been consolidated. (Use reverse side of this form if necessary.)
 No allowable will be assigned to the well until all interests have been consolidated (by communitization, unitization, forced pooling, or otherwise) or until a non-standard unit, eliminating such interest, has been approved by the Division.

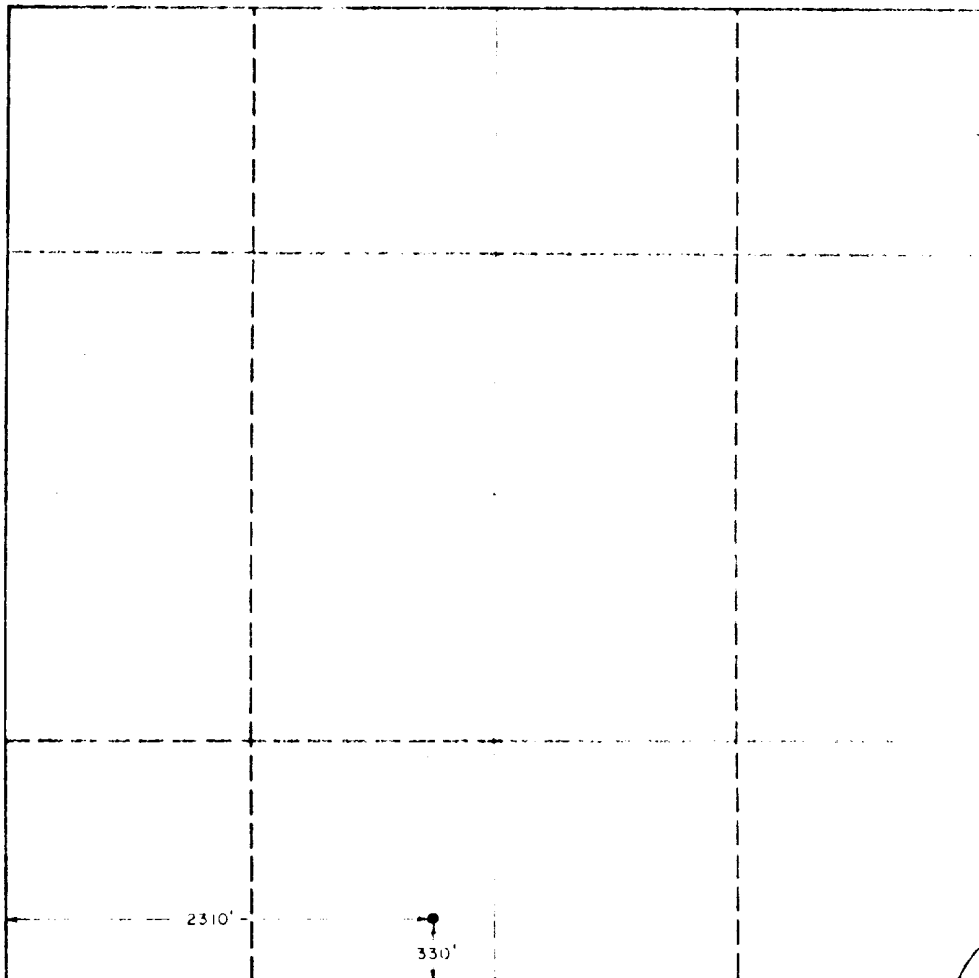

OPERATOR CERTIFICATION

I hereby certify that the information contained herein is true and complete to the best of my knowledge and belief.

James G. McClelland
 Signature

James G. McClelland
 Printed Name
Vice-President Adm.
 Position
Strata Production Comp.
 Company
April 26, 1989
 Date

SURVEYOR CERTIFICATION

I hereby certify that the well location shown on this plat was plotted and measured in accordance with actual surveying data and that I am a duly licensed and supervised professional land surveyor and that I am duly qualified to perform the duties herein.

John W. West
 Signature
April 26, 1989
 Date



LOCATION VERIFICATION MAP

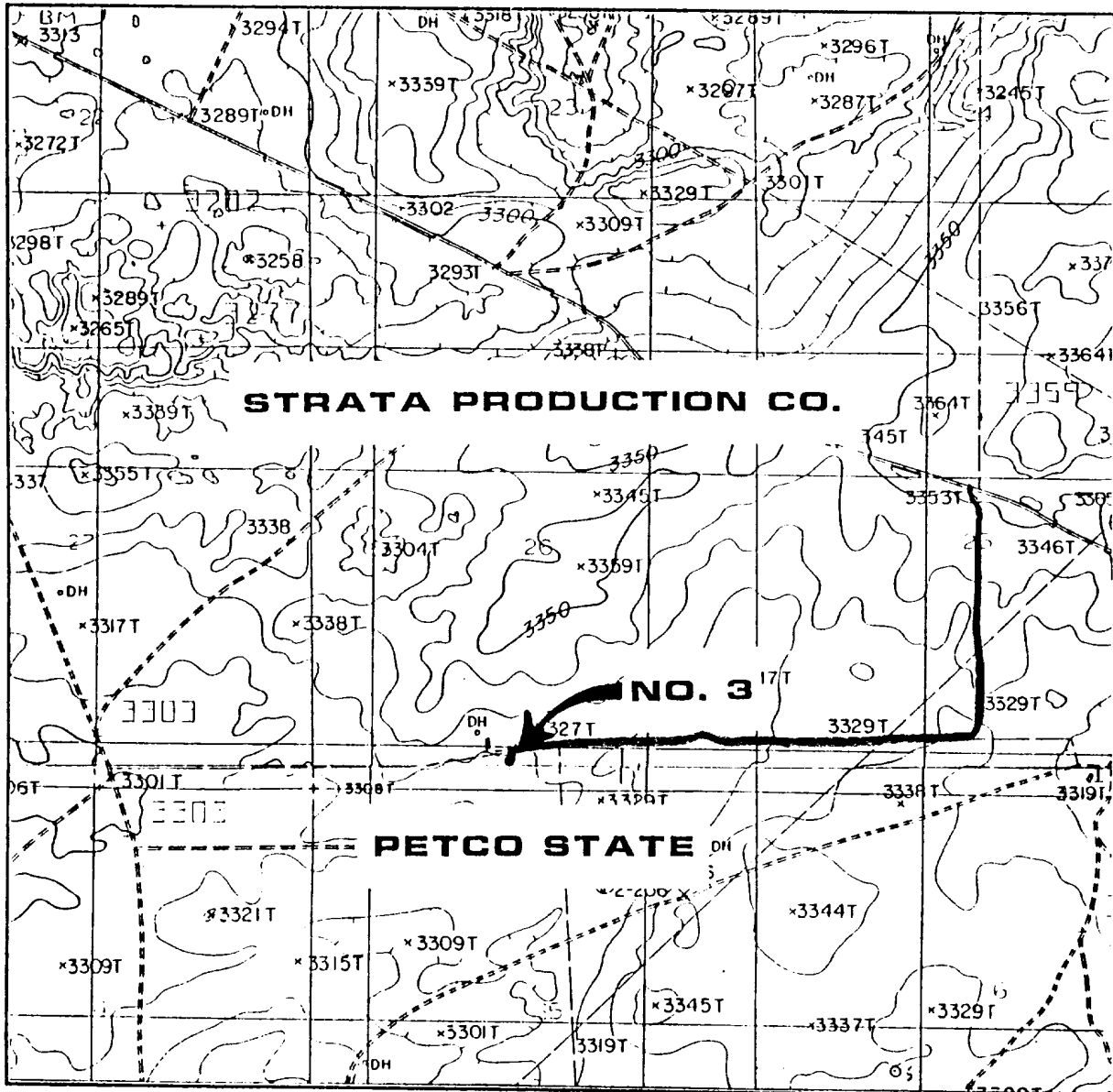

SCALE: 1" = 2000'

CONTOUR INTERVAL 10 ft.

SEC. 26 TWP. 19 S. RGE. 29 E.

SURVEY N.M.P.M.

COUNTY Eddy STATE N.M.

DESCRIPTION 330' FSL & 2310' FWL

ELEVATION 3324.6

OPERATOR Strata Production Co.

LEASE Petco State

U.S.G.S. TOPOGRAPHIC MAP

Illinois Camp NE, N.M.

& Illinois Camp SE, N.M.

30-015-26113

Oseid- 21712
Property- 10741
Pool- 49625

2447910
2447930
2447950

2-1-90
DLH-M-SFL
3308-4734
CH-LD
1600-4702

Speed
No. 2-153C
MASTINGS, MN
LOS ANGELES, CHICAGO, LOGAN, OH
MORGENTHAU, TX, LECUST GROVE, GA
U.S.A.

NC Tops DGM 2/6/90

TX	400 ?	log	starts too deep
BX	1200 ?	"	" "
Yates	1500 ?	"	" "
Capitan Reef			
Delaware	3578		