

District I
PO Box 1980, Hobbs, NM 88241-1980

District II
811 South First, Artesia, NM 88210

District III
1000 Rio Brazos Rd., Aztec, NM 87410

District IV
2040 South Pacheco, Santa Fe, NM 87505

State of New Mexico
Energy, Minerals & Natural Resources Department

OIL CONSERVATION DIVISION
2040 South Pacheco
Santa Fe, NM 87505

Form C-101
Revised October 18, 1994
Instructions on back
Submit to Appropriate District Office
State Lease - 6 Copies
Fee Lease - 5 Copies

☐ AMENDED REPORT

APPLICATION FOR PERMIT TO DRILL, RE-ENTER, DEEPEN, PLUGBACK, OR ADD A ZONE

Operator Name and Address SDX Resources, Inc. PO Box 5061 Midland, TX 79704 915/685-1761		OGRID Number 020451
Property Name State 20		API Number 30-015-22567
Property Code 29219	Well No. 2	

Surface Location

UL or lot no.	Section	Township	Range	Lot Idn	Feet from the	North/South line	Feet from the	East/West Line	County
K	20	19S	28E		1980	South	2180	West	Eddy

Proposed Bottom Hole Location If Different From Surface

UL or lot no.	Section	Township	Range	Lot Idn	Feet from the	North/South line	Feet from the	East/West Line	County
Yates, TRUS Millman, QN-GB-SA, East					Proposed Pool 2				

Work Type Code E	Well Type Code O	Cable/Rotary R	Lease Type Code S	Ground Level Elevation 3462
Multiple No	Proposed Depth 2800	Formation GB	Contractor L&R	Spud Date 12-15-01

Proposed Casing and Cement Program

Hole Size	Casing Size	Casing weight/foot	Setting Depth	Sacks of Cement	Estimated TOC
	Existing: 13-3/8"		418	700	Surf
	Existing: 9-5/8"		2835	1400	Surf

Describe the proposed program. If this application is to DEEPEN or PLUG BACK give the data on the present productive zone and proposed new productive zone. Describe the blowout prevention program, if any. Use additional sheets if necessary.

Formerly: Monsanto Co.'s Delta State Com #1 (API #30-015-22567)

Propose to re-enter well by drlg out cmt plugs in 9-5/8" csg to 2800'. Will run cased hole logs, perf & stimulate as necessary for optimum production. Will use double ram 3000# manual BOP.

I hereby certify that the information given above is true and complete to the best of my knowledge and belief.

Signature: *Bonnie Atwater*

Printed name: Bonnie Atwater

Title: Regulatory Tech

OIL CONSERVATION DIVISION

Approved By: ORIGINAL SIGNED BY TIM W. GUN
DISTRICT II SUPERVISOR

Title:

Approval Date: JAN 16 2002

Expiration Date: JAN 16 2003

District I
PO Box 1980, Hobbs, NM 88241-1980
District II
PO Drawer DD, Artesia, NM 88211-0719
District III
1000 Rio Brazos Rd., Aztec, NM 87410
District IV
PO Box 2088, Santa Fe, NM 87504-2088

State of New Mexico
Energy, Minerals & Natural Resources Department

OIL CONSERVATION DIVISION
PO Box 2088
Santa Fe, NM 87504-2088

Form C-102
Revised February 21, 1994
Instructions on back
Submit to Appropriate District Office
State Lease - 4 Copies
Fee Lease - 3 Copies

☐ AMENDED REPORT

WELL LOCATION AND ACREAGE DEDICATION PLAT

1 API Number		2 Pool Code		3 Pool Name Millman QN-GB-SA	
4 Property Code		5 Property Name State 20			6 Well Number 2
7 OGRID No. 020451		8 Operator Name SDX Resources, Inc.			9 Elevation 3462 GR

10 Surface Location

UL or lot no. K	Section 20	Township 19S	Range 28E	Lot Ida	Feet from the 1980	North/South line South	Feet from the 2180	East/West line West	County Eddy
--------------------	---------------	-----------------	--------------	---------	-----------------------	---------------------------	-----------------------	------------------------	----------------

11 Bottom Hole Location If Different From Surface

UL or lot no.	Section	Township	Range	Lot Ida	Feet from the	North/South line	Feet from the	East/West line	County
---------------	---------	----------	-------	---------	---------------	------------------	---------------	----------------	--------

12 Dedicated Acres 40	13 Joint or Infill	14 Consolidation Code	15 Order No.
--------------------------	--------------------	-----------------------	--------------

NO ALLOWABLE WILL BE ASSIGNED TO THIS COMPLETION UNTIL ALL INTERESTS HAVE BEEN CONSOLIDATED
OR A NON-STANDARD UNIT HAS BEEN APPROVED BY THE DIVISION

<p>16</p>				<p>17 OPERATOR CERTIFICATION</p> <p>I hereby certify that the information contained herein is true and complete to the best of my knowledge and belief</p> <p><i>Chuck Morgan</i></p> <p>Signature Chuck Morgan</p> <p>Printed Name Engineer</p> <p>Title 1/8/02</p> <p>Date</p>	
				<p>18 SURVEYOR CERTIFICATION</p> <p>I hereby certify that the well location shown on this plat was plotted from field notes of actual surveys made by me or under my supervision, and that the same is true and correct to the best of my belief.</p> <p>Date of Survey</p> <p>Signature and Seal of Professional Surveyor:</p> <p>Original on File</p> <p>Certificate Number</p>	

**MEXICO OIL CONSERVATION COMMISSION
WELL LOCATION AND ACREAGE DEDICATION PLAT**

Form C-102
Supersedes C-128
Effective 1-1-65

All distances must be from the outer boundaries of the Section.

Operator MONSANTO COMPANY			Lease Delta State <i>Com.</i>		Well No. 1
Unit Letter K	Section 20	Township 19-S	Range 28-E	County EDDY	
Actual Footage Location of Well: 1980 feet from the South line and 2180 feet from the West line					
Ground Level Elev: 3476'	Producing Formation Morrow		Pool <i>S. Millman</i>	Dedicated Acreage: 320+ or - Acres	

1. Outline the acreage dedicated to the subject well by colored pencil or hatchure marks on the plat below.
2. If more than one lease is dedicated to the well, outline each and identify the ownership thereof (both as to working interest and royalty).
3. If more than one lease of different ownership is dedicated to the well, have the interests of all owners been consolidated by communitization, unitization, force-pooling, etc?

☒ Yes ☐ No If answer is "yes," type of consolidation **COMMUNITIZATION**

If answer is "no," list the owners and tract descriptions which have actually been consolidated. (Use reverse side of this form if necessary.) _____

No allowable will be assigned to the well until all interests have been consolidated (by communitization, unitization, forced-pooling, or otherwise) or until a non-standard unit, eliminating such interests, has been approved by the Commission.

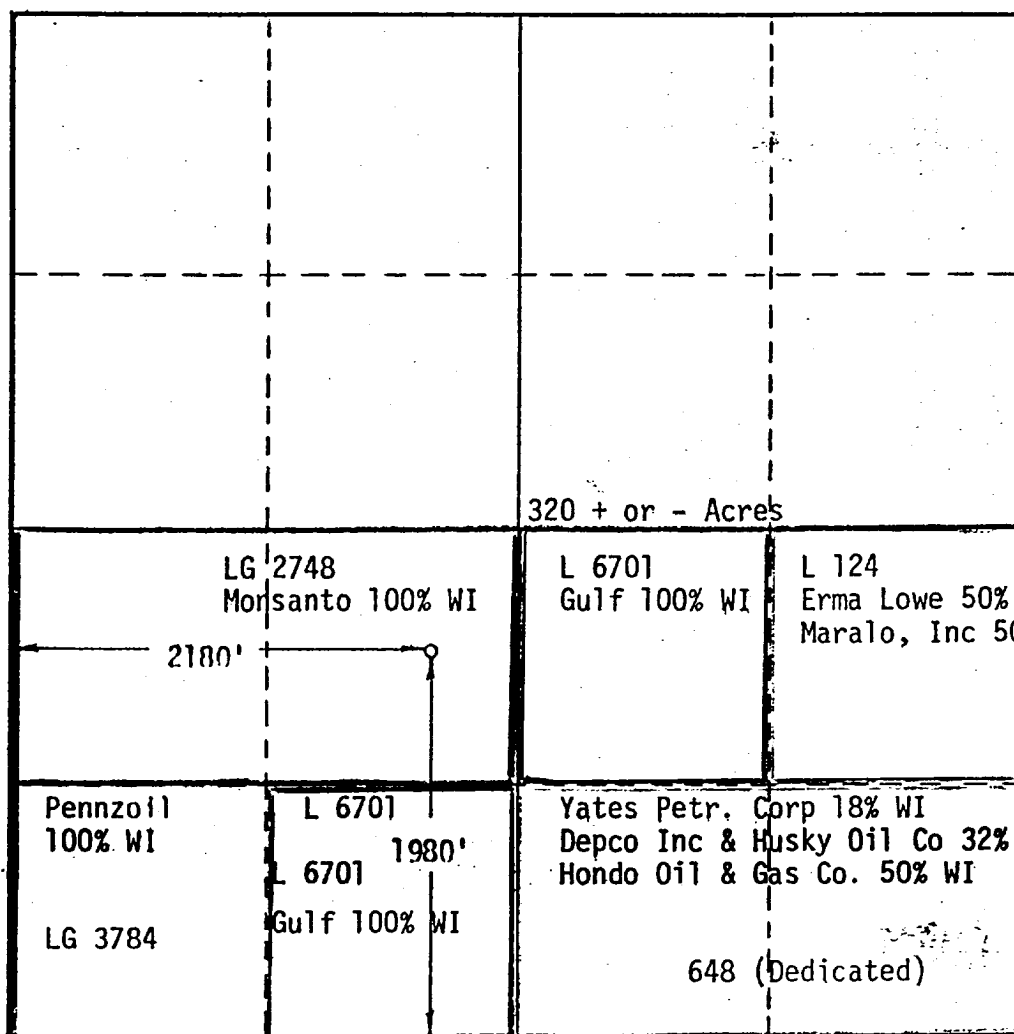

CERTIFICATION

I hereby certify that the information contained herein is true and complete to the best of my knowledge and belief.

Name

E. M. Scholl

Position

Regional Production Mgr.

Company

Monsanto Company

Date

5/25/78

I hereby certify that the well location shown on this plat was plotted from field notes of actual surveys made by me or under my supervision, and that the same is true and correct to the best of my knowledge and belief.

May 18, 1978

Date Surveyed

Richard B. Duniven

Registered Professional Engineer,
and/or Land Surveyor

Richard B. Duniven

Certificate No.

4882

0 330 660 990 1320 1650 1980 2310 2640 2970 3300 3630 3960 4290 4620 4950 5280 5610 5940 6270 6600

Blow Out Preventor Schematic

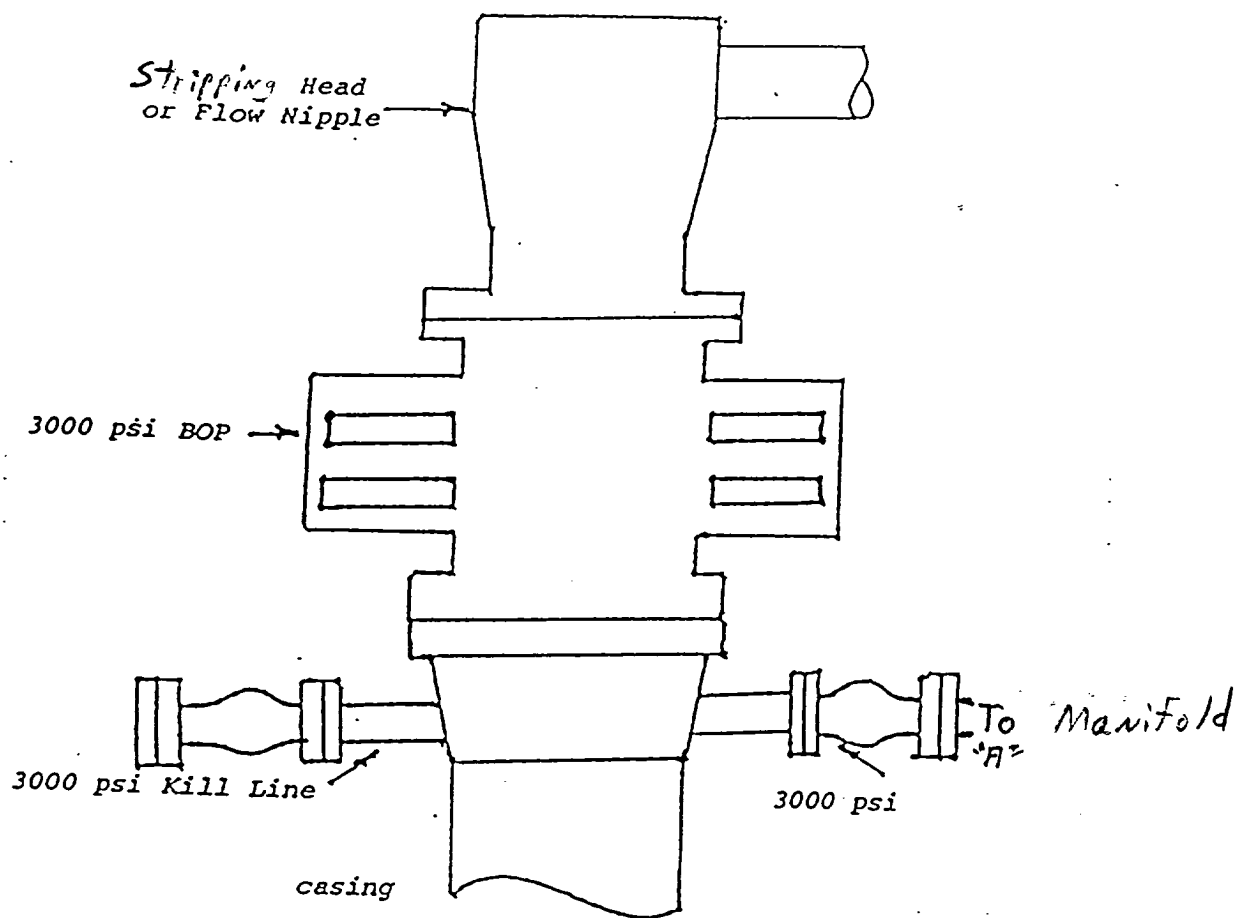

Reverse Unit
Manifold

Flanged Cross with Pressure
Gauge in Outside Opening

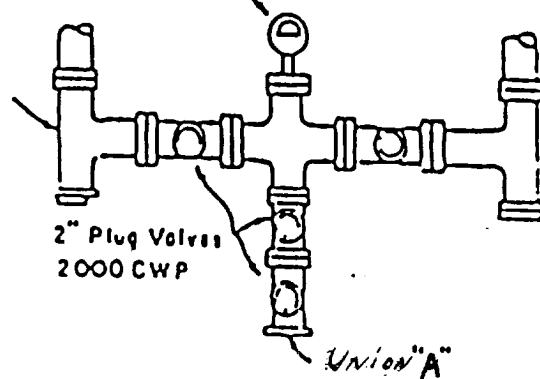

PLAN VIEW -

MANIFOLD