

APPROVED

JUL 23 1963

RONNIE E. SHOOK  
ACTING DISTRICT ENGINEER

(SUBMIT IN TRIPLICATE)

UNITED STATES  
DEPARTMENT OF THE INTERIOR  
GEOLOGICAL SURVEY

Land Office \_\_\_\_\_

Lease No. 10-050797

Unit \_\_\_\_\_

RECEIVED

JUL 24 1963

## SUNDRY NOTICES AND REPORTS ON WELLS, E. C.

ARTESIA, OFFICE

NOTICE OF INTENTION TO DRILL	<input checked="" type="checkbox"/>	SUBSEQUENT REPORT OF WATER SHUT-OFF	
NOTICE OF INTENTION TO CHANGE PLANS		SUBSEQUENT REPORT OF SHOOTING OR ACIDIZING	
NOTICE OF INTENTION TO TEST WATER SHUT-OFF		SUBSEQUENT REPORT OF ALTERING CASING	
NOTICE OF INTENTION TO RE-DRILL OR REPAIR WELL		SUBSEQUENT REPORT OF RE-DRILLING OR REPAIR	
NOTICE OF INTENTION TO SHOOT OR ACIDIZE		SUBSEQUENT REPORT OF ABANDONMENT	
NOTICE OF INTENTION TO PULL OR ALTER CASING		SUPPLEMENTARY WELL HISTORY	
NOTICE OF INTENTION TO ABANDON WELL			

(INDICATE ABOVE BY CHECK MARK NATURE OF REPORT, NOTICE, OR OTHER DATA)

JUL 24, 1963

Well No. 1111-31 is located \_\_\_\_\_ ft. from {N  
S} line and \_\_\_\_\_ ft. from {E  
W} line of sec. \_\_\_\_\_

\_\_\_\_\_ (1/4 Sec. and Sec. No.) \_\_\_\_\_ (Twp.) \_\_\_\_\_ (Range) \_\_\_\_\_ (Meridian)  
 \_\_\_\_\_ (Field) \_\_\_\_\_ (County or Subdivision) \_\_\_\_\_ (State or Territory)

The elevation of the derrick floor above sea level is \_\_\_\_\_ ft.

## DETAILS OF WORK

(State names of and expected depths to objective sands; show sizes, weights, and lengths of proposed casings; indicate mudding jobs, cementing points, and all other important proposed work)

Run three joints 7 7/8" casing 100' with 15 rods to test oil surface at 100'. Then 4" rotary hole to top of the Russell sand expected at a depth of 300' and cementing casing with 10 rods (to lead to hole) to fill 15' of void to top of the salt between casing and hole). Drill 4" rotary tool hole through Russell sand. Will then decide to use for injection or producing purposes.

I understand that this plan of work must receive approval in writing by the Geological Survey before operations may be commenced.

Company \_\_\_\_\_

Address \_\_\_\_\_

Artesia, New Mexico

By \_\_\_\_\_

Title Agent

**NEW MEXICO OIL CONSERVATION COMMISSION**  
**WELL LOCATION AND ACREAGE DEDICATION PLAT**

FORM C-128  
 Ed. 5/1/57

SEE INSTRUCTIONS FOR COMPLETING THIS FORM ON THE REVERSE SIDE

**SECTION A**

Operator <b>Neil H. Mills</b>			Lease <b>Federal 12-050797</b>		Well No. <b>ARTESIA 07195-34</b>
Unit Letter <b>F</b>	Section <b>13</b>	Township <b>20 South</b>	Range <b>28 East</b>	County <b>Gray</b>	
Actual Footage Location of Well: <b>2630</b> feet from the <b>North</b> line and <b>1980</b> feet from the <b>West</b> line					
Ground Level Elev. <b>3251</b>	Producing Formation <b>Yates (Russell) sand</b>		Pool <b>Russell</b>	Dedicated Acreage: <b>40</b> Acres	

1. Is the Operator the only owner in the dedicated acreage outlined on the plat below? YES ☒ NO \_\_\_\_ . ("Owner" means the person who has the right to drill into and to produce from any pool and to appropriate the production either for himself or for himself and another. (65-3-29 (e) NMSA 1935 Comp.)
2. If the answer to question one is "no," have the interests of all the owners been consolidated by communization agreement or otherwise? YES \_\_\_\_ NO \_\_\_\_ . If answer is "yes," Type of Consolidation \_\_\_\_\_
3. If the answer to question two is "no," list all the owners and their respective interests below:

Owner	Land Description

**SECTION B**

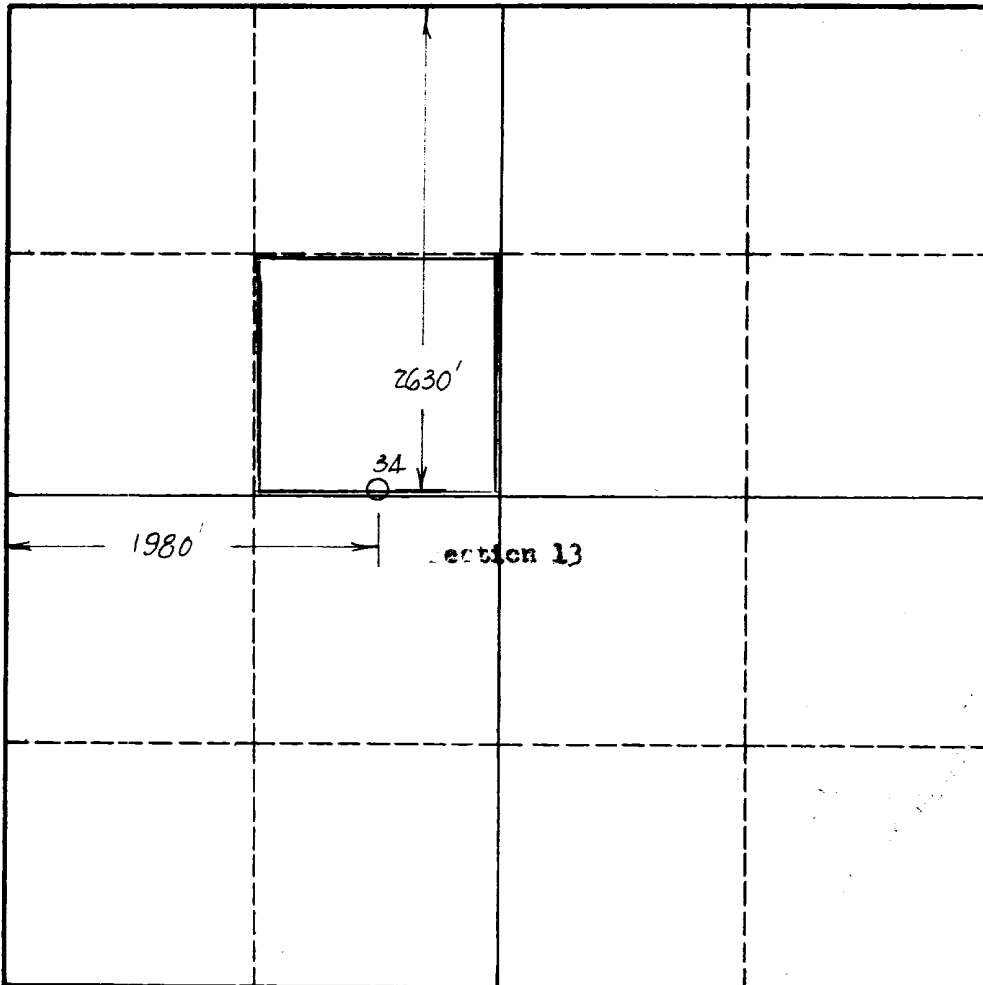

**CERTIFICATION**

I hereby certify that the information in SECTION A above is true and complete to the best of my knowledge and belief.

Name	<b>Neil H. Mills</b>
Position	<b>Agent</b>
Company	<b>Neil H. Mills</b>
Date	<b>7-22-63</b>

I hereby certify that the well location shown on the plat in SECTION B was plotted from field notes of actual surveys made by me or under my supervision, and that the same is true and correct to the best of my knowledge and belief.

Date Surveyed	<b>7-22-63</b>
Registered Professional Engineer and/or Land Surveyor	<b>Neil H. Mills</b>
Certificate No.	<b>772</b>

### INSTRUCTIONS FOR COMPLETION OF FORM C-128

1. Operator shall furnish and certify to the information called for in Section A.
2. Operator shall outline the dedicated acreage for *both* oil and gas wells on the plat in Section B.
3. A registered professional engineer or land surveyor registered in the State of New Mexico or approved by the Commission shall show on the plat the location of the well and certify this information in the space provided.
4. All distances shown on the plat must be from the outer boundaries of the Section.
5. If additional space is needed for listing owners and their respective interests as required in question 3 of Section A, please use space below.

30-015-10420

OGRIP 153653

PAOP 18883

POOI 52820

Administrative Order WFX-744  
Ready Oil and Gas Management  
November 24, 1998

IT IS THEREFORE ORDERED THAT:

The applicant, Ready Oil and Gas Management, be and the same is hereby authorized to inject water into the Yates formation at approximately 795 feet to approximately 828 feet through 2 3/8-inch plastic lined tubing set in a packer located within 100 feet of the uppermost injection perforations in the following described wells for purposes of secondary recovery to wit:

**Wills Well No.34**

API No.30-015-10420  
2630' FNL & 1980' FWL – Unit 'F'  
Injection Interval: 798 feet to 827 feet  
Packer Setting: 775 feet  
Maximum Injection Pressure: 450 psig

**Well No.43**

API No.30-015-20229  
1990' FSL & 1337' FWL – Unit 'K'  
Injection Interval: 795 feet to 828 feet  
Packer Setting: 782 feet  
Maximum Injection Pressure: 450 psig

Both in Section 13, Township 20 South, Range 28 East, Eddy County, New Mexico.

Non-Standard Order # R-2511