



UNITED STATES  
DEPARTMENT OF THE INTERIOR  
GEOLOGICAL SURVEY  
P. O. Drawer U  
Artesia, New Mexico 88210

*Copy to J.*

April 21, 1965

RECEIVED

Mr. A. L. Porter  
New Mexico Oil Conservation Commission  
P. O. Box 2088  
Santa Fe, New Mexico 87501

Re: Oil-Potash Area

APR 22 1965

O. C. C.  
ARTESIA, OFFICE

Dear Mr. Porter:

Attached is an "information copy" of a Notice of Intention to Drill a well to a depth of 2,000 feet to test the Yates-Seven Rivers formations in the NW $\frac{1}{4}$ SE $\frac{1}{4}$  sec. 22, T. 20 S., R. 30 E., N.M.P.M., Eddy County, New Mexico, filed by Elwyn C. Hale, 120 Requa Road, Piedmont, California. The location is on Federal oil and gas lease Las Cruces 063610.

Sincerely yours,

(Orig. Signed by J. A. Knauf)

James A. Knauf  
District Engineer

Attachment

Copy w/notice to: N.M.O.C.C., Artesia ✓  
U.S.G.S., Roswell  
U. S.G.S., Carlsbad

UNITED STATES  
DEPARTMENT OF THE INTERIOR  
GEOLOGICAL SURVEY



RECEIVED

APR 2 1890

U. S. GEOLOGICAL SURVEY  
WASHINGTON, D. C.

TO THE DIRECTOR  
OF THE GEOLOGICAL SURVEY  
WASHINGTON, D. C.

FROM THE  
DIRECTOR OF THE  
GEOLOGICAL SURVEY

UNITED STATES  
DEPARTMENT OF THE INTERIOR  
GEOLOGICAL SURVEY

## APPLICATION FOR PERMIT TO DRILL, DEEPEN, OR PLUG BACK

1a. TYPE OF WORK DRILL <input checked="" type="checkbox"/> DEEPEN <input type="checkbox"/> <b>R PLUG BACK ED</b>		5. LEASE DESIGNATION AND SERIAL NO. Las Cruces 063610
b. TYPE OF WELL OIL WELL <input checked="" type="checkbox"/> GAS WELL <input type="checkbox"/> OTHER <input type="checkbox"/> SINGLE ZONE <input type="checkbox"/> MULTIPLE ZONE <input type="checkbox"/>		6. IF INDIAN, ALLOTTEE OR TRIBE NAME
2. NAME OF OPERATOR Elwyn C. Hale		7. UNIT AGREEMENT NAME
3. ADDRESS OF OPERATOR 120 Requa Road, Piedmont, California.		8. FARM OR LEASE NAME Federal
4. LOCATION OF WELL (Report location clearly and in accordance with any State requirements.)* At surface 1980' FSL and 1980' FEL Sect. 22-T20S-R30E N.M.P.M. At proposed prod. zone Yates-Seven Rivers.		9. WELL NO. 1
14. DISTANCE IN MILES AND DIRECTION FROM NEAREST TOWN OR POST OFFICE* 18 miles northeast of Carlsbad New Mexico		10. FIELD AND POOL, OR WILDCAT Extension <i>we</i>
15. DISTANCE FROM PROPOSED* LOCATION TO NEAREST PROPERTY OR LEASE LINE, FT. (Also to nearest drlg. line, if any) 660'	16. NO. OF ACRES IN LEASE 1040	11. SEC., T., R., M., OR BLK. AND SURVEY OR AREA Sect. 22-T20S-R30E
18. DISTANCE FROM PROPOSED LOCATION* TO NEAREST WELL, DRILLING, COMPLETED, OR APPLIED FOR, ON THIS LEASE, FT. None	19. PROPOSED DEPTH 2000'	12. COUNTY OR PARISH Eddy
21. ELEVATIONS (Show whether DF, RT, GR, etc.) 3250 GL		13. STATE New Mexico
22. APPROX. DATE WORK WILL START* 4-24-65		

PROPOSED CASING AND CEMENTING PROGRAM				
SIZE OF HOLE	SIZE OF CASING	WEIGHT PER FOOT	SETTING DEPTH	QUANTITY OF CEMENT
10"	8-5/8"	22#	550'	Circulated
8"	7"	17.5#	1550'	50 sacks

Plans are to set 8-5/8" casing in the anhydrite immediately above the salt section expected at approximately 550 feet. Cement will be circulated. Intermediate or salt protection string (7") will be tacked with 50 sacks 150' to 200' below the base of the salt, expected at 1400 feet. In the event of production the 7" will be cut and pulled. 4-1/2" casing will be used as production string. Cement will be circulated.

Note: The above program conforms to drilling and casing program as specified by NMOCG order # R 111A.

IN ABOVE SPACE DESCRIBE PROPOSED PROGRAM: If proposal is to deepen or plug back, give data on present productive zone and proposed new productive zone. If proposal is to drill or deepen directionally, give pertinent data on subsurface locations and measured and true vertical depths. Give blowout preventer program, if any.

24. SIGNED R. W. Landberg TITLE Agent DATE 4-21-65  
(This space for Federal or State office use)

PERMIT NO. \_\_\_\_\_ APPROVAL DATE \_\_\_\_\_

APPROVED BY \_\_\_\_\_ TITLE \_\_\_\_\_ DATE \_\_\_\_\_  
CONDITIONS OF APPROVAL, IF ANY:

NEW MEXICO OIL CONSERVATION COMMISSION  
WELL LOCATION AND ACREAGE DEDICATION PLAT

Form C-102  
Supersedes C-128  
Effective 1-1-55

All distances must be from the outer boundaries of the Section.

Operator <i>Yates-Seven Rivers</i>			Lease <i>Extension</i>			Well No. <i>1</i>
Unit Letter <i>J</i>	Section <i>2</i>	Township <i>10 N</i>	Range <i>10 E</i>	County <i>San Juan</i>		
Actual Footage Location of Well: <i>100</i> feet from the <i>North</i> line and <i>1000</i> feet from the <i>West</i> line						
Ground Level Elev. <i>1000</i>	Producing Formation <i>Yates-Seven Rivers</i>		Pool <i>Extension</i>		Dedicated Acreage: <i>100</i> Acres	

1. Outline the acreage dedicated to the subject well by colored pencil or hachure marks on the plat below.
2. If more than one lease is dedicated to the well, outline each and identify the ownership thereof (both as to working interest and royalty).
3. If more than one lease of different ownership is dedicated to the well, have the interests of all owners been consolidated by communitization, unitization, force-pooling, etc?

☐ Yes ☒ No If answer is "yes," type of consolidation ADD 2 2 1955

If answer is "no," list the owners and tract descriptions which have actually been consolidated. (Use reverse side of this form if necessary.) ARTESIA OFFICE

No allowable will be assigned to the well until all interests have been consolidated (by communitization, unitization, forced-pooling, or otherwise) or until a non-standard unit, eliminating such interests, has been approved by the Commission.

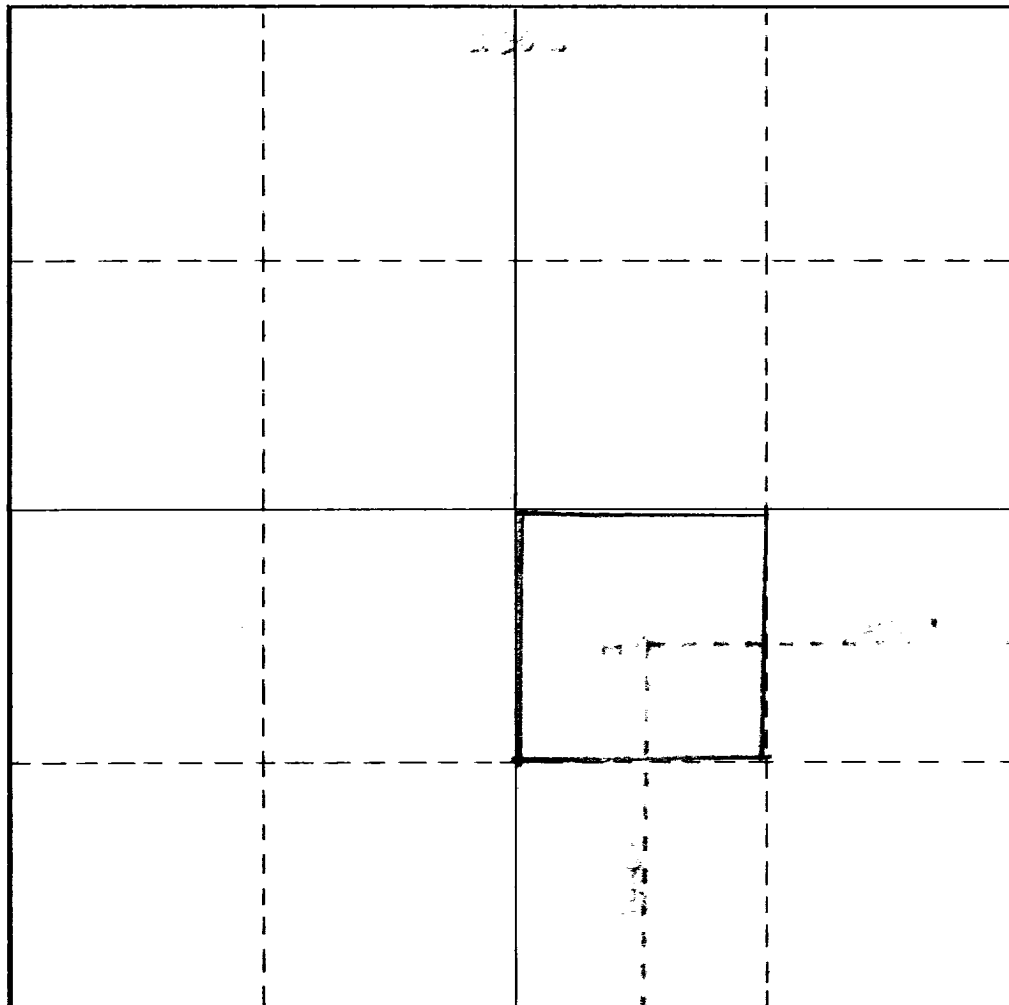

CERTIFICATION

I hereby certify that the information contained herein is true and complete to the best of my knowledge and belief.

*R. L. Londenberger, Jr.*  
Name

*R. L. Londenberger, Jr.*  
Position

*Agent*  
Company

*Elwyn C. Hale*  
Date

*4-11-55*

I hereby certify that the well location shown on this plat was plotted from field notes of actual surveys made by me or under my supervision, and that the same is true and correct to the best of my knowledge and belief.

Date Surveyed

Registered Professional Engineer and/or Land Surveyor

*James H. Duran*  
Certificate No.

0 330 660 990 1320 1650 1980 2310 2640 2000 1500 1000 500