

015 25

Form C-102
Supersedes C-128
Effective 1-1-65

N MEXICO OIL CONSERVATION COMMISS
WELL LOCATION AND ACREAGE DEDICATION, LAT
AMENDED - See notes below

All distances must be from the outer boundaries of the Section.

Operator DAVID FASKEN		Lease Avalon Federal "Com."			Well No. 1
Unit Letter P	Section 1	Township 21-South	Range 25-East	County Eddy	
Actual Footage Location of Well:					
3630 feet from the South line and		660 feet from the East line			
Ground Level Elev.	Producing Formation Morrow	Pool Catclaw Draw (Morrow Gas)	Dedicated Acreage: 636.61 Acres		

1. Outline the acreage dedicated to the subject well by colored pencil or hachure marks on the plat below. See attached plat with revised acreage - the original plat was Ex. RECEIVED Comm. agreement.
2. If more than one lease is dedicated to the well, outline each and identify the ownership thereof (both as to working interest and royalty). See attached plat

OCT - 1 1981

3. If more than one lease of different ownership is dedicated to the well, have the interests of all owners been consolidated by communitization, unitization, force-pooling, etc?
O. C. D.

Yes No If answer is "yes," type of consolidation ARTESIA, OFFICE
Communitization agreement fully executed

If answer is "no," list the owners and tract descriptions which have actually been consolidated. (Use reverse side of this form if necessary.) _____

No allowable will be assigned to the well until all interests have been consolidated (by communitization, unitization, forced-pooling, or otherwise) or until a non-standard unit, eliminating such interests, has been approved by the Commission.

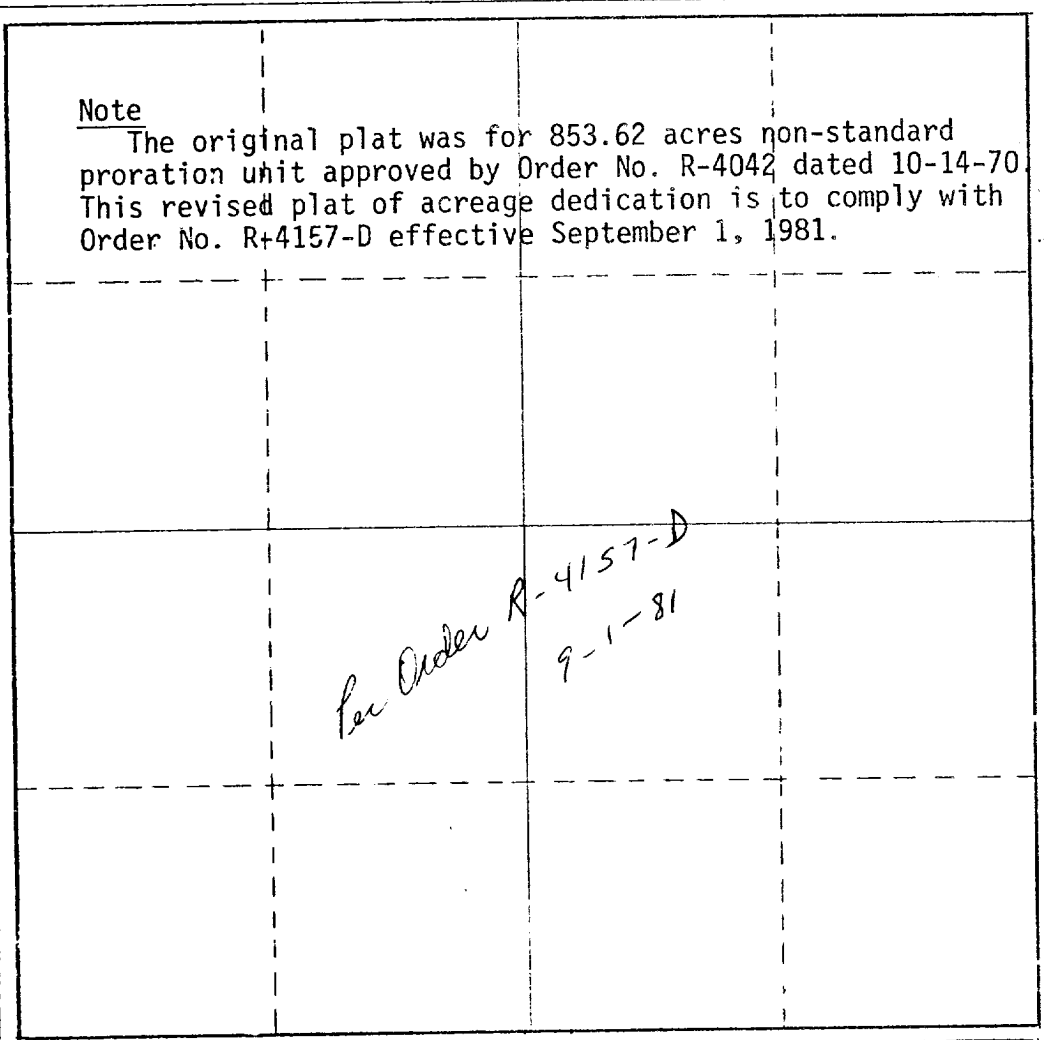

CERTIFICATION

I hereby certify that the information contained herein is true and complete to the best of my knowledge and belief.

Robert H. Angevine
Name

Robert H. Angevine
Position

Agent
Company

DAVID FASKEN
Date

September 29, 1981

I hereby certify that the well location shown on this plat was plotted from field notes of actual surveys made by me or under my supervision, and that the same is true and correct to the best of my knowledge and belief.

Date Surveyed

Registered Professional Engineer
and/or Land Surveyor

Certificate No.

