

Exxon Lse. No. _____ NEW MEXICO OIL CONSERVATION COMMISSION
State Lse. No. NM-27451 WELL LOCATION AND ACREAGE DEDICATION PLAT
Federal Lse. No. _____ All distances must be from the outer boundaries of the Section.

Form C-102
Supersedes C-128
Effective 1-4-65

Operator Exxon Corporation ✓			Lease <u>NASSER FEDERAL</u>		Well No. <u>1</u>
Unit Letter	Section <u>1</u>	Township <u>21 S</u>	Range <u>21 E</u>	County <u>EDDY</u>	
Actual Footage Location of Well: <u>1880</u> feet from the <u>NORTH</u> line and <u>1980</u> feet from the <u>WEST</u> line					
Ground Level Elev. <u>4512'</u>	Producing Formation <u>UPPER Penn.</u>		Pool <u>LITTLE BOX CANYON</u>	Dedicated Acreage: <u>320</u> Acres	

1. Outline the acreage dedicated to the subject well by colored pencil or hachure marks on the plat below.
2. If more than one lease is dedicated to the well, outline each and identify the ownership thereof (both as to working interest and royalty).
3. If more than one lease of different ownership is dedicated to the well, have the interests of all owners been consolidated by communitization, unitization, force-pooling, etc?

☐ Yes ☐ No If answer is "yes," type of consolidation: _____

If answer is "no," list the owners and tract descriptions which have actually been consolidated. (Use reverse side of this form if necessary.) _____

No allowable will be assigned to the well until all interests have been consolidated (by communitization, unitization, forced-pooling, or otherwise) or until a non-standard unit, eliminating such interests, has been approved by the Commission.

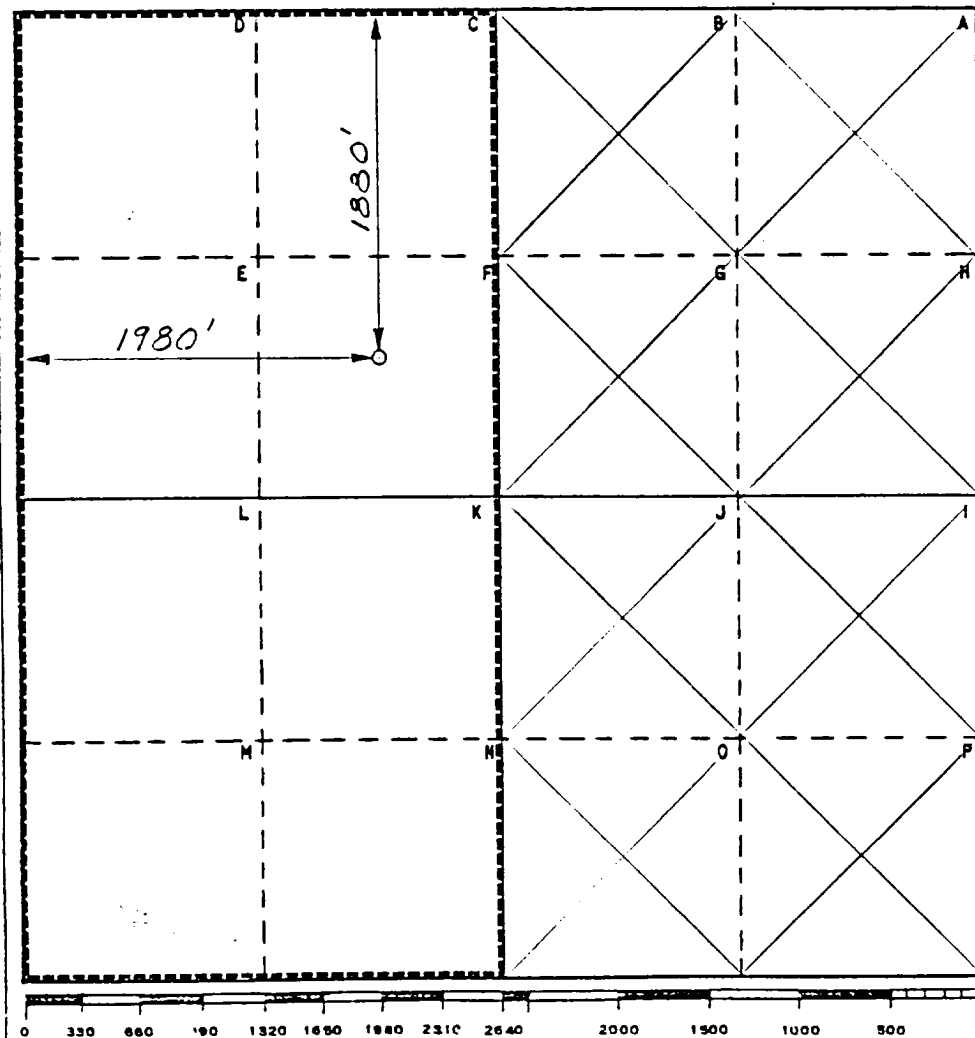

CERTIFICATION

I hereby certify that the information contained herein is true and complete to the best of my knowledge and belief.

Name
Melba Knippling
Position
UNIT HEAD
Company
Exxon Corporation
Box 1600 Midland, Texas
Date
3-5-85

I hereby certify that the well location shown on this plat was plotted from field notes of actual surveys made by me or under my supervision, and that the same is true and correct to the best of my knowledge and belief.

Date Surveyed
1-31-85

Registered Professional Engineer
and/or Land Surveyor

Bruce R. Pennell
Certificate No.
9062

WIA - 2791