

District I  
P.O. Box 1980, Hobbs, NM 88241-1980  
District II  
811 S. 1st Street, Artesia, NM 88210-2834  
District III  
1000 Rio Brazos Rd., Aztec, NM 87410  
District IV  
P.O. Box 2088, Santa Fe, NM 87504-2088

State of New Mexico  
Energy, Minerals & Natural Resources Department

Form C-102  
Revised February 10, 1994  
Instructions on back  
Submit to Appropriate District Office  
State Lease - 4 Copies  
Fee Lease - 3 Copies

OIL CONSERVATION DIVISION  
P.O. Box 2088  
Santa Fe, NM 87504-2088

RECEIVED

MAR 26 1996

☒ AMENDED REPORT

OIL CON. DIV.  
DIST. 2  
WELL LOCATION AND ACREAGE DEDICATION PLAT

<sup>1</sup> API Number 30/015/28143	<sup>2</sup> Pool Code 015475	<sup>3</sup> Pool Name Dagger Draw: Upper Penn Associated, South
<sup>4</sup> Property Code 6411	<sup>5</sup> Property Name North Indian Basin Unit	<sup>6</sup> Well Number 14
<sup>7</sup> OGRID No. 014021	<sup>8</sup> Operator Name Marathon Oil Company	<sup>9</sup> Elevation GL: 3696

UL or lot no.	Section	Township	Range	Lot. Idn	Feet from the	North/South Line	Feet from the	East/West line	County
C	2	21-S	23-E		660	North	2310	East	Eddy

<sup>11</sup> Bottom Hole Location If Different From Surface

UL or lot no.	Section	Township	Range	Lot. Idn	Feet from the	North/South Line	Feet from the	East/West line	County
<sup>12</sup> Dedicated Acres 320		<sup>13</sup> Joint or Infill Yes		<sup>14</sup> Consolidation Code		<sup>15</sup> Order No.			

NO ALLOWABLE WILL BE ASSIGNED TO THIS COMPLETION UNTIL ALL INTERESTS HAVE BEEN CONSOLIDATED  
OR A NON--STANDARD UNIT HAS BEEN APPROVED BY THE DIVISION

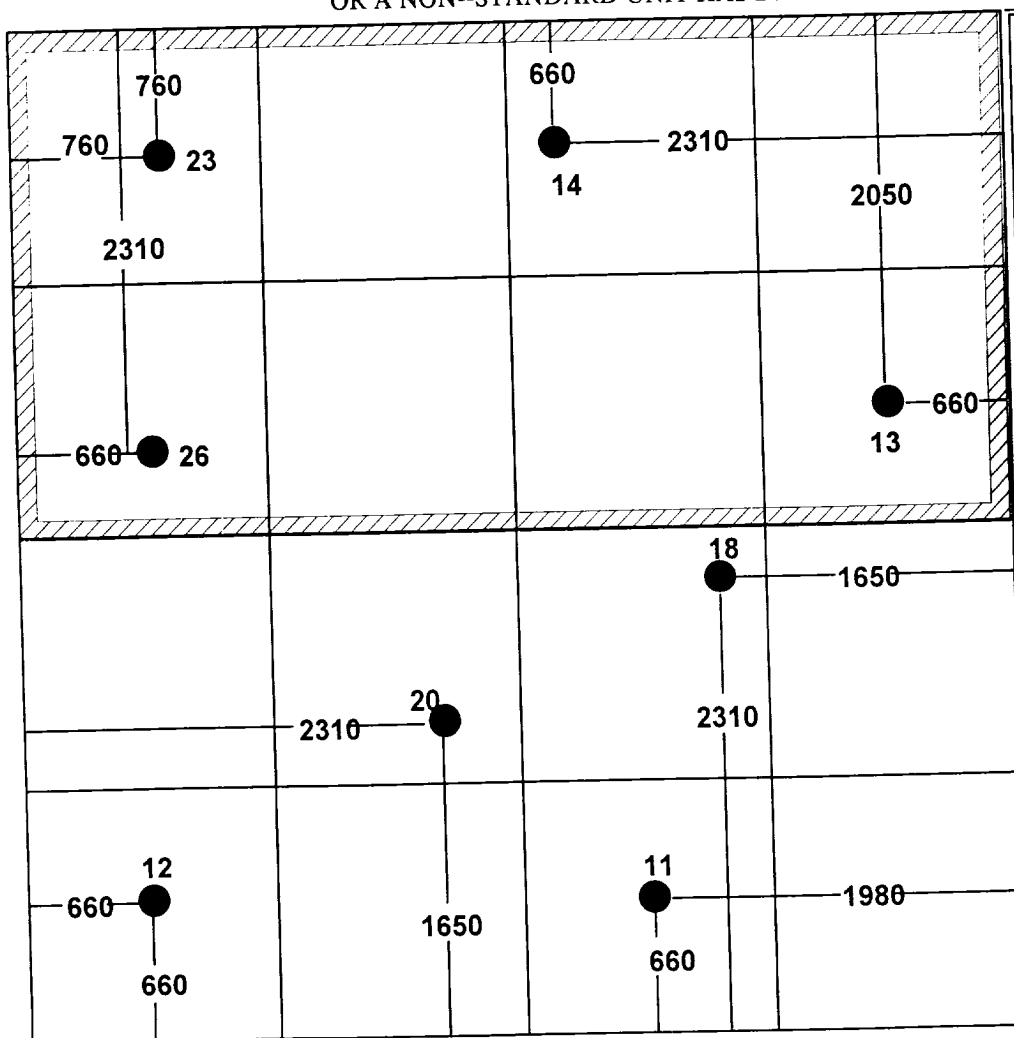

<sup>17</sup> OPERATOR CERTIFICATION  
I hereby certify that the information contained herein is true and complete to the best of my knowledge and belief.

*Thomas M. Price*  
Signature  
Thomas M. Price  
Printed Name  
Advanced Engineering Tech.  
Title  
3/22/96  
Date

<sup>18</sup> SURVEYOR CERTIFICATION  
I hereby certify that the well location shown on this plat was plotted from field notes of actual surveys made by me or under my supervision, and that the same is true and correct to the best of my belief.

\_\_\_\_\_  
Date of Survey  
\_\_\_\_\_  
Signature and Seal of Professional Surveyor:  
\_\_\_\_\_  
Certificate Number