

Submit 3 Copies To Appropriate District
Office
District I
1625 N. French Dr., Hobbs, NM 87240
District II
811 South First, Artesia, NM 87210
District III
1000 Rio Brazos Rd., Aztec, NM 87410
District IV
2040 South Pacheco, Santa Fe, NM 87505

State of New Mexico
Energy, Minerals and Natural Resources

OIL CONSERVATION DIVISION

2040 South Pacheco
Santa Fe, NM 87505

CISE

Form C-103
Revised March 25, 1999

SUNDRY NOTICES AND REPORTS ON WELLS (DO NOT USE THIS FORM FOR PROPOSALS TO DRILL OR TO DEEPEN OR PLUG BACK TO A DIFFERENT RESERVOIR. USE "APPLICATION FOR PERMIT" (FORM C-101) FOR SUCH PROPOSALS.)		WELL API NO. 30-015-31901
1. Type of Well: Oil Well <input type="checkbox"/> Gas Well <input type="checkbox"/> Other proposed gas well <input type="checkbox"/>		5. Indicate Type of Lease STATE <input checked="" type="checkbox"/> FEE <input type="checkbox"/>
2. Name of Operator Devon Energy Production Company, L.P. (6137)		6. State Oil & Gas Lease No.
3. Address of Operator 20 N. Broadway, Suite 1500 OKC, OK 73102 (W.Frank 405/552-4595)		7. Lease Name or Unti Agreement Name Big Cactus State
4. Well Location Unit Letter H 1980' feet from the north line and 810' feet from the east line Section 9 Township 21S Range 26E NMPM County Eddy, NM		8. Well No. 3
10. Elevation (Show whether DR, RKB, RT, GR, etc.) GL 3222'		9. Pool name or Wildcat Avalon (Morrow)

11. Check Appropriate Box to Indicate Nature of Notice, Report or Other Data

NOTICE OF INTENTION TO:

PERFORM REMEDIAL WORK ☐ PLUG AND ABANDON ☐
TEMPORARILY ABANDON ☐ CHANGE PLANS ☐
PULL OR ALTER CASING ☐ MULTIPLE COMPLETION ☐
OTHER: ☐

SUBSEQUENT REPORT OF:

REMEDIAL WORK ☐ ALTERING CASING ☐
COMMENCE DRILLING OPNS. ☐ PLUG AND ABANDONMENT ☐
CASING TEST AND CEMENT JOBS ☐
OTHER: amend C-102 and update drilling program for APD ☒

12. Describe proposed or completed operations. (Clearly state all pertinent details, and give pertinent dates, including estimated date of starting and proposed work). SEE RULE 1103. For Multiple Completions: Attach diagram of proposed completion or recompletion.

As per NMOCD request, attached is an amended form C-102 plat showing both wells in the proration unit.

Also, please be advised that Devon plans to drill the Big Cactus State #3 with fresh water to approximately 2000'.



I hereby certify that the information above is true and complete to the best of my knowledge and belief.

SIGNATURE Candace R. Graham TITLE Engineering Tech. DATE 07/24/2001

Type or print name Candace R. Graham X4520

Telephone No. (405)235-3611

(This space for State use)

APPROVED BY [Signature] **ORIGINAL SIGNED BY TIM W. GUM**
DISTRICT II SUPERVISOR TITLE _____

DATE AUG 07 2001

Conditions of approval, if any:

DISTRICT I
P. O. Box 1980
Hobbs, NM 88241-1980

State of New Mexico
Encl: Minerals, and Natural Resources Department

Form C-102
Revised 02-10-94

Instructions on back

DISTRICT II
P. O. Drawer DD
Artesia, NM 88211-0719

OIL CONSERVATION DIVISION
P. O. Box 2088
Santa Fe, New Mexico 87504-2088

Submit to the Appropriate
District Office
State Lease - 4 copies
Fee Lease - 3 copies

DISTRICT III
1000 Rio Brazos Rd.
Aztec, NM 87410

DISTRICT IV
P. O. Box 2088
Santa Fe, NM 87507-2088

☒ AMENDED REPORT
7-24-2001
C. Graham

WELL LOCATION AND ACREAGE DEDICATION PLAT

1 API Number		2 Pool Code		3 Pool Name AVALON (MORROW)					
4 Property Code		5 Property Name BIG CACTUS						6 Well Number 3	
7 OGRID No. 6137		8 Operator Name DEVON ENERGY PRODUCTION CO., L.P.						9 Elevation 3222'	
10 SURFACE LOCATION									
UL or lot no. H	Section 9	Township 21 SOUTH	Range 26 EAST, N.M.P.M.	Lot Ida	Feet from the 1980'	North/South line NORTH	Feet from the 810'	East/West line EAST	County EDDY
11 BOTTOM HOLE LOCATION IF DIFFERENT FROM SURFACE									
UL or lot no.	Section	Township	Range	Lot Ida	Feet from the	North/South line	Feet from the	East/West line	County
12 Dedicated Acres		13 Joint or Infill		14 Consolidation Code		15 Order No.			

NO ALLOWABLE WELL BE ASSIGNED TO THIS COMPLETION UNTIL ALL INTERESTS HAVE BEEN
CONSOLIDATED OR A NON-STANDARD UNIT HAS BEEN APPROVED BY THE DIVISION

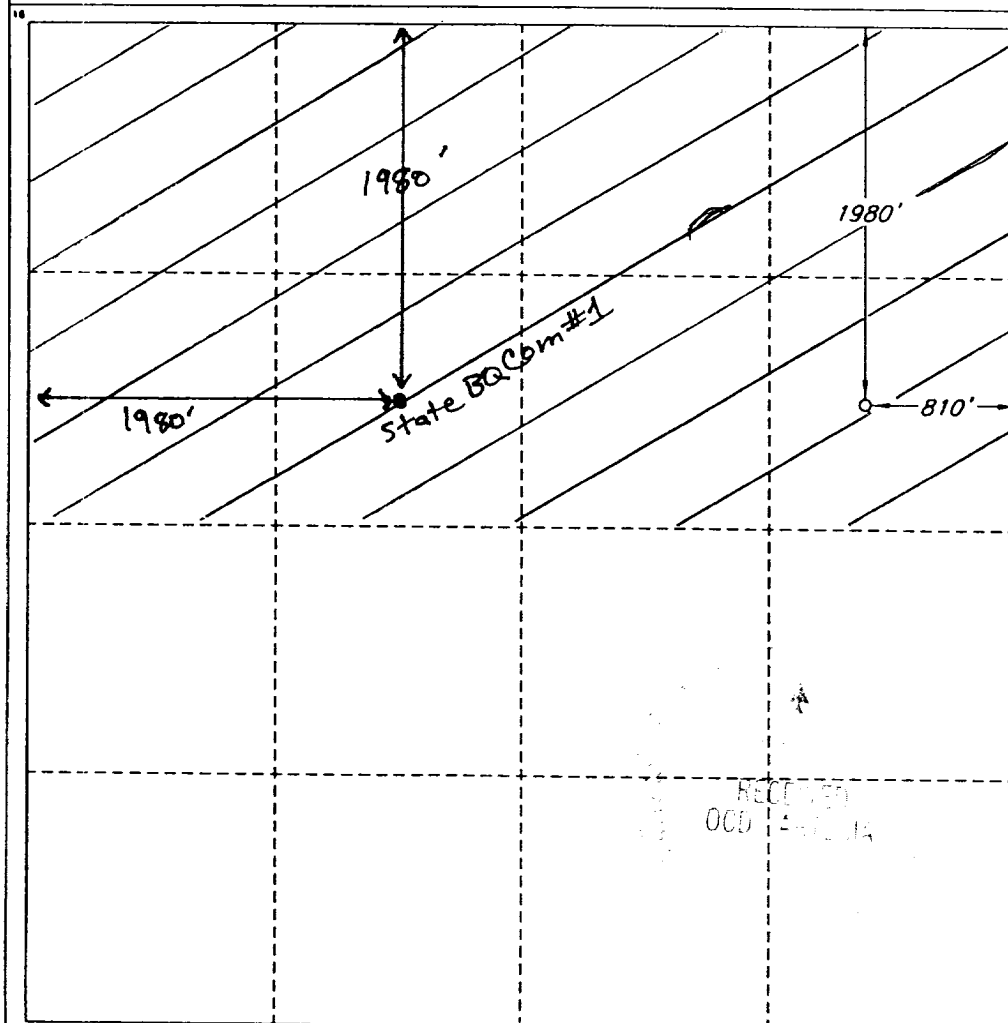

OPERATOR CERTIFICATION

I hereby certify that the information
contained herein is true and complete
to the best of my knowledge and belief.

Signature
Candace R. Graham
Printed Name
Candace R. Graham
Title
Engineering Tech.
Date
07-16-01

SURVEYOR CERTIFICATION

I hereby certify that the well
location shown on this plat was
plotted from field notes of actual
surveys made by me or under
my supervision, and that the
same is true and correct to the
best of my belief.

Date of Survey
JUNE 22, 2001

Signature and Seal of
Professional Surveyor

RECEIVED
OCD
V. L. BEZNER
R.P.S. #7920
JOB #77152-50 NE / J.C.P.