

UNITED STATES
DEPARTMENT OF THE INTERIOR
BUREAU OF LAND MANAGEMENT

FORM APPROVED
OMB No. 1004-0135
Expires November 30, 2000

SUNDRY NOTICES AND REPORTS ON WELLS

Do not use this form for proposals to drill or reenter an abandoned well. Use Form 3160-3 (APD) for such proposals.

Cons.
N.M. Div-Dist. 2
1301 W. Grand Avenue
Artesia, NM 88210

SUBMIT IN TRIPLICATE - Other instructions on reverse side

1. Type of Well

Oil Well Gas Well Other

2. Name of Operator

Yates Petroleum Corporation

3a. Address

105 South Fourth Street, Artesia, NM 88210

3b. Phone No. (include area code)

(505) 748-1471

4. Location of Well (Footage, Sec., T., R., M., or Survey Description)

237' FNL and 937' FWL Surface Location
660' FNL and 660' FWL Bottom Hole Location

7. If Unit or CA/Agreement, Name and/o

8. Well Name and No.

Lowe Staple AMR Fed. Com. #2

9. API Well No.

10. Field and Pool, or Exploratory Area

Wildcat Morrow

11. County or Parish, State

Eddy County, New Mexico

12. CHECK APPROPRIATE BOX(ES) TO INDICATE NATURE OF NOTICE, REPORT, OR OTHER DATA

| TYPE OF SUBMISSION | TYPE OF ACTION | | | |
|--|---|---|--|---|
| <input checked="" type="checkbox"/> Notice of Intent | <input type="checkbox"/> Acidize | <input type="checkbox"/> Deepen | <input type="checkbox"/> Production (Start/Resume) | <input type="checkbox"/> Water Shut-Off |
| <input type="checkbox"/> Subsequent Report | <input type="checkbox"/> Alter Casing | <input type="checkbox"/> Fracture Treat | <input type="checkbox"/> Reclamation | <input type="checkbox"/> Well Integrity |
| <input type="checkbox"/> Final Abandonment Notice | <input type="checkbox"/> Casing Repair | <input type="checkbox"/> New Construction | <input type="checkbox"/> Recomplete | <input type="checkbox"/> Other Change of well pad size. |
| | <input type="checkbox"/> Change Plans | <input type="checkbox"/> Plug and Abandon | <input type="checkbox"/> Temporarily Abandon | |
| | <input type="checkbox"/> Convert to Injection | <input type="checkbox"/> Plug Back | <input type="checkbox"/> Water Disposal | |

13. Describe Proposed or Completed Operations (clearly state all pertinent details, including estimated starting date of any proposed work and approximate duration thereof. If the proposal is to deepen directionally or recomplete horizontally, give subsurface locations and measured and true vertical depths of all pertinent markers and zones. Attach the Bond under which the work will be performed or provide the Bond No. on file with BLM/BIA. Required subsequent reports shall be filed within 30 days following completion of the involved operations. If the operation results in a multiple completion or recompletion in a new interval, a Form 3160-4 shall be filed once testing has been completed. Final Abandonment Notices shall be filed only after all requirements, including reclamation, have been completed, and the operator has determined that the site is ready for final inspection.)

The well pad layout has been changed for this well. Please replace the well pad layout submitted with the APD for the one attached to this Sundry Notice.

Thank you.

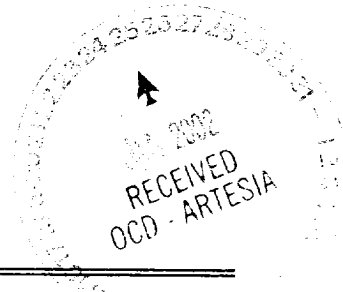

14. I hereby certify that the foregoing is true and correct

Name (Printed/typed)

Cy Cowan

Title

Regulatory Agent

Signature

Date

January 11, 2002

THIS SPACE FOR FEDERAL OR STATE USE

Approved by

/s/ JOE G. LARA

FIELD MANAGER

Date

JAN 24 2002

Conditions of approval, if any, are attached. Approval of this notice does not warrant or certify that the applicant holds legal or equitable title to those rights in the subject lease which would entitle the applicant to conduct operations thereon.

Office

CARLSBAD FIELD OFFICE

Title 18 U.S.C. Section 1001, make it a crime for any person knowingly and willfully to make to any department or agency of the United States any false, fictitious or fraudulent statements or representations as to any matter within its jurisdiction.

(Instructions on reverse)

File Copy

SA JOE G. LARA
BUREAU OF INDIAN AFFAIRS
ROSWELL OFFICE

2002 JAN 17 AM 11:23

RECEIVED

1-10-2002

LOWE STAPLE "AME" P2COM#2
SEC 22 - T215-224L.
T.O. 10500 MURKIN.

↑
WEST

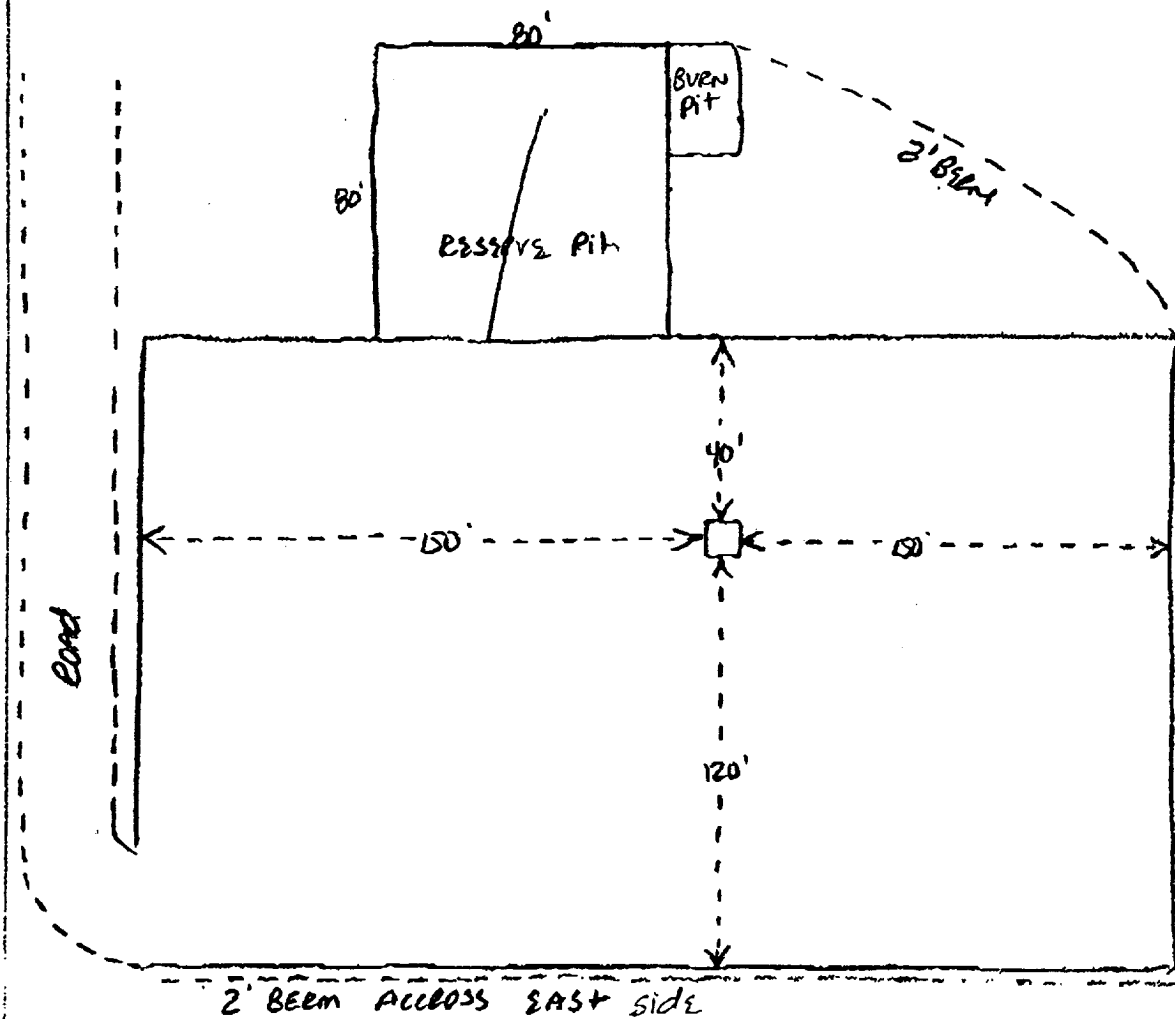

DATES P2CO WILL CIRCULATE THE ESSEVE PIT FROM
APPROX. 1800' TO APPROX. 8000'

THANKS
Jim Keogan

BUREAU OF LAND MGMT
ROSWELL OFFICE

2002 JAN 17 AM 11:23

RECEIVED