

NO. OF COPIES RECEIVED	5
DISTRIBUTION	
SANTA FE	1
FILE	1
U.S.G.S.	2
LAND OFFICE	
OPERATOR	1

# NEW MEXICO OIL CONSERVATION COMMISSION

SEP - 1 1976

D. D. O.

ARTESIA, OFFICE

30-015-21901

Form C-101  
Revised 14-65

5A. Indicate Type of Lease

STATE ☐

FEE ☒

5. State Oil & Gas Lease No.

## APPLICATION FOR PERMIT TO DRILL, DEEPEN, OR PLUG BACK

1a. Type of Work

b. Type of Well

DRILL ☒

DEEPEN ☐

PLUG BACK ☐

OIL WELL ☒

GAS WELL ☐

OTHER

SINGLE ZONE ☒

MULTIPLE ZONE ☐

2. Name of Operator

AMOCO PRODUCTION COMPANY

3. Address of Operator

P.O. DRAWER A, LEVELLAND, TEXAS 79336

4. Location of Well

UNIT LETTER N LOCATED 330 FEET FROM THE SOUTH LINE

AND 1650' FEET FROM THE WEST LINE OF SEC. 7 TWP. 22-S RGE. 28-E NMPM

7. Unit Agreement Name

Old Indian Draw Unit

8. Farm or Lease Name

Old Indian Draw Unit

9. Well No.

14

10. Field and Pool, or Wildcat

INDIAN DRAW DELAWARE

12. County

EDDY

19. Proposed Depth

3450

19A. Formation

20. Rotary or C.T.

ROTARY

21. Elevations (Show whether DF, RT, etc.)

3096.4

21A. Kind & Status Plug. Bond

BLANKET ON FILE

21B. Drilling Contractor

NA

22. Approx. Date Work will start

ASAP

23.

## PROPOSED CASING AND CEMENT PROGRAM

SIZE OF HOLE	SIZE OF CASING	WEIGHT PER FOOT	SETTING DEPTH	SACKS OF CEMENT	EST. TOP
12 1/4"	8 5/8"	24 #	400'	CIRCULATE	
7 7/8"	5 1/2"	14 - 15.5 #	3450'	Sufficient to tie back into surface pipe	

After drilling well, logs will be run and evaluations made, perforating and/or stimulating as necessary in attempting commercial production.

Mud Program: O-SCP - Water & Native Mud

SCP-TD - Brine & Native Mud

BOP Program attached

APPROVAL VALID  
FOR 90 DAYS UNLESS  
DRILLING COMMENCED,

EXPIRES 12-3-76

IN ABOVE SPACE DESCRIBE PROPOSED PROGRAM; IF PROPOSAL IS TO DEEPEN OR PLUG BACK, GIVE DATA ON PRESENT PRODUCTIVE ZONE AND PROPOSED NEW PRODUCTIVE ZONE. GIVE BLOWOUT PREVENTER PROGRAM, IF ANY.

I hereby certify that the information above is true and complete to the best of my knowledge and belief.

Signed Ray W. Cox Title Administrative Assistant

Date 8/31/76

(This space for State Use)

APPROVED BY W. A. Gressett

TITLE ADMINISTRATIVE ASSISTANT

DATE SEP 3 1976

CONDITIONS OF APPROVAL, IF ANY:

1-RC  
2-BASS  
1-Marathon

Cement must be circulated to surface behind 8 7/8" casing

NEW MEXICO OIL CONSERVATION COMMISSION  
WELL LOCATION AND ACREAGE DEDICATION PLAT

Form C-102  
Supersedes C-128  
Effective 1-1-65

All distances must be from the outer boundaries of the Section

Operator <b>AMOCO PRODUCTION COMPANY</b>		Lease <b>Old Indian Draw Unit</b>		Well No. <b>14</b>
Unit Letter <b>N</b>	Section <b>7</b>	Township <b>22 South</b>	Range <b>28 East</b>	County <b>Eddy</b>
Actual Footage Location of Well: <b>330</b> feet from the <b>south</b> line and <b>1650</b> feet from the <b>west</b> line				
Ground Level Elev. <b>3096.4</b>	Producing Formation <b>DELAWARE</b>	Pool <b>INDIAN DRAW DELAWARE</b>	Dedicated Acreage: <b>40</b> Acres	

1. Outline the acreage dedicated to the subject well by colored pencil or hachure marks on the plat below.
2. If more than one lease is dedicated to the well, outline each and identify the ownership thereof (both as to working interest and royalty).
3. If more than one lease of different ownership is dedicated to the well, have the interests of all owners been consolidated by communitization, unitization, force-pooling, etc?

☐ Yes ☐ No If answer is "yes," type of consolidation \_\_\_\_\_

If answer is "no," list the owners and tract descriptions which have actually been consolidated. (Use reverse side of this form if necessary.) \_\_\_\_\_

No allowable will be assigned to the well until all interests have been consolidated (by communitization, unitization, forced-pooling, or otherwise) or until a non-standard unit, eliminating such interests, has been approved by the Commission.

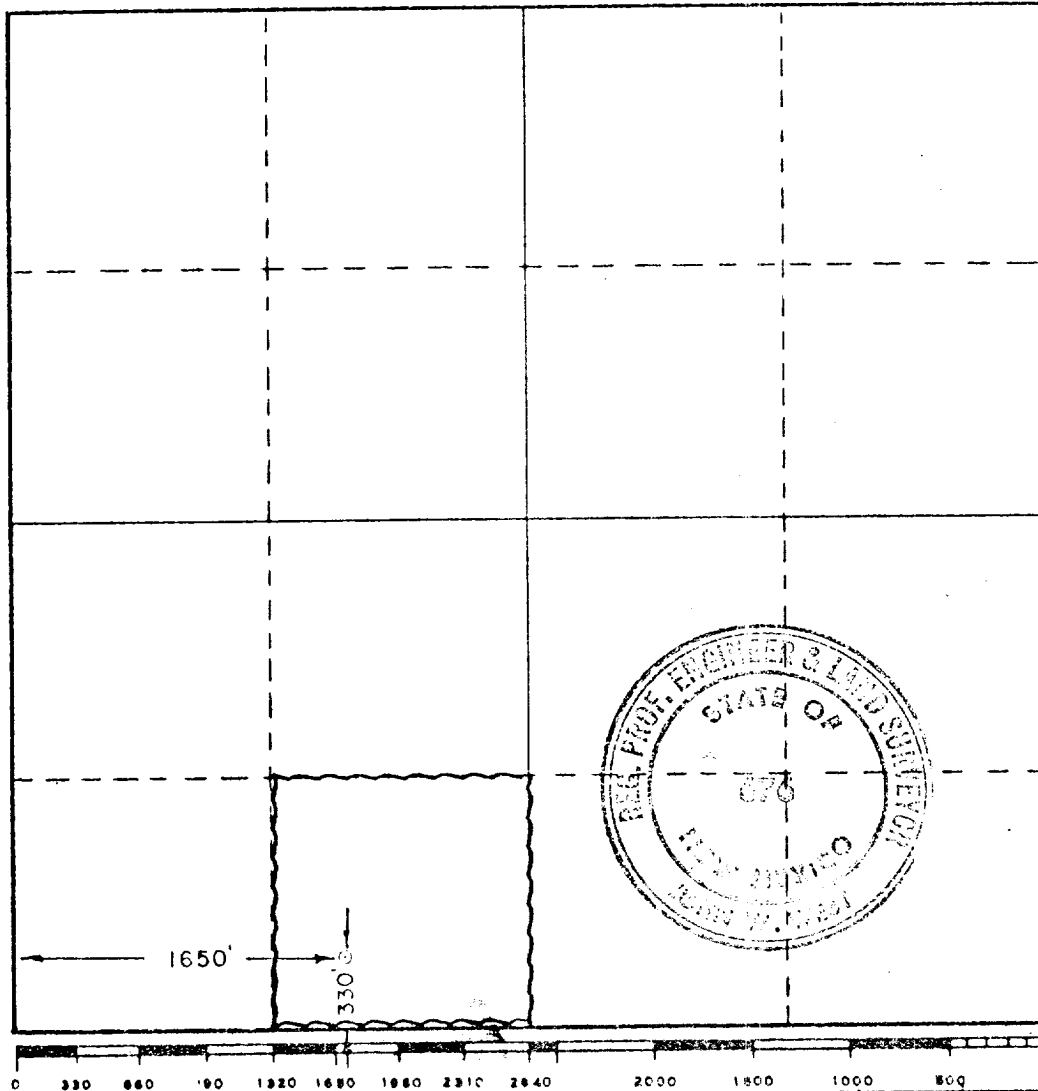

CERTIFICATION

I hereby certify that the information contained herein is true and complete to the best of my knowledge and belief.

Name  
**Ray W. Cox**  
Position  
**Administrative Assistant**  
Company  
**AMOCO PRODUCTION COMPANY**

Date  
**AUG. 20, 1976**

I hereby certify that the well location shown on this plat was plotted from field notes of actual surveys made by me or under my supervision, and that the same is true and correct to the best of my knowledge and belief.

Date Surveyed  
**Aug. 13, 1976**

Registered Professional Engineer and/or Land Surveyor

**John W. West**  
Certificate No.  
**678**

**ATTACHMENT "B"**  
**NOTES**

1. Blow-out preventers and master valve to be fluid operated and all fittings must be in good condition, 3,000# W.P. (6,000 p.s.i. test), minimum.
2. Equipment through which bit must pass shall be as large as the inside diameter of the casing that is being drilled through.
3. Nipple above blow-out preventer shall be same size as casing being drilled through.
4. Kelly cock required, 3,000# W.P. (6,000 p.s.i. test), minimum.
5. OMSCO or comparable safety valve must be available on rig floor at all times with proper connection or sub, 3,000# W.P. (6,000 p.s.i. test), minimum.
6. Blow-out preventers and master valve while drilling intermediate hole to 6,000' may be 2,000# W.P. (4,000 p.s.i. test), minimum.
7. Choke assembly, beyond second valve from cross, may be positioned (Optional) outside of derrick foundation.
8. Spool or cross may be eliminated if connections are available in the lower part of the blow-out preventer body.
9. Plug valves - gate valves are optional. Valves shown as 2" are minimum size.
10. Casing head and casing head spool, including attached valves, to be furnished by Pan American.
11. Rams in preventers will be installed as follows:

When drilling, use:

Top Preventer - Drill pipe rams  
Bottom Preventer - Blind rams or master valve

When running casing, use:

Top Preventer - Casing rams  
Bottom Preventer - Blind rams or master valve.

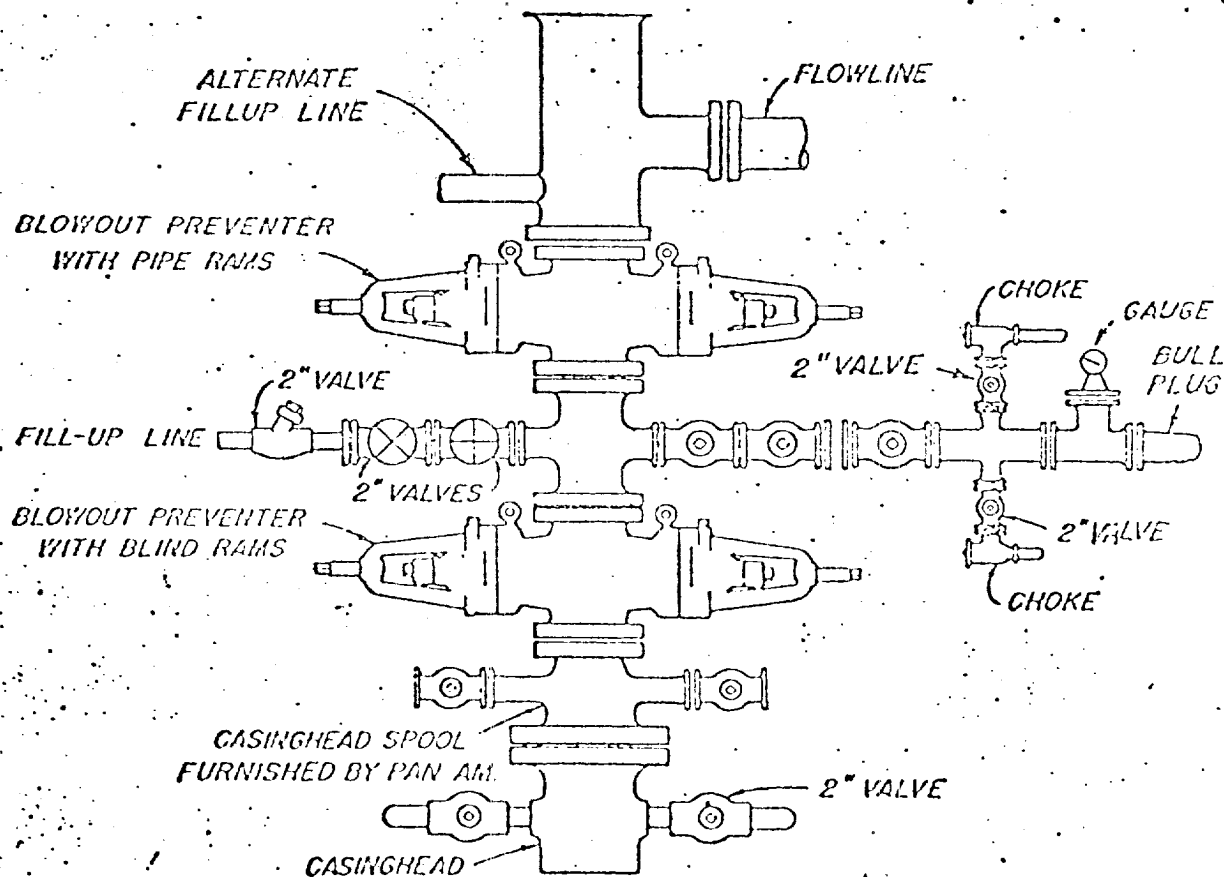

**BLOWOUT PREVENTER HOOK-UP**  
**PAN AMERICAN PETROLEUM CORP.**

**EXHIBIT D-1 MODIFIED**

JUNE 1, 1962

Amoco Production Company

ENGINEERING CHART  
(TRACING)

SHEET NO. OF

FILE

APPN.

DATE

BY

SUBJECT OLD INDIAN DRAW UNIT

SEC. 7, 18 & 19, T-22-S, R-28-E, Eddy Co., N.M.

R-28-E

NORTH

T  
22  
S

19

LEGEND

- EXISTING ROADS
- - - PROPOSED NEW ROADS
- · - · - PROPOSED FLOW LINE
- NEW WELLS
- EXISTING WELLS
- △ SWD WELL
- ⊗ TANK BATTERY

