

NO. OF COPIES RECEIVED	5
DISTRIBUTION	
SANTA FE	1
FILE	1
U.S.G.S.	2
LAND OFFICE	
OPERATOR	1

NEW MEXICO OIL CONSERVATION COMMISSION

JUN 3 1977

O. C. C.
ARTESIA, OFFICE

30-015-22171

Form C-101
Revised 1-1-65

5A. Indicate Type of Lease	
STATE <input type="checkbox"/>	FEE <input checked="" type="checkbox"/>
5. State Oil & Gas Lease No.	

APPLICATION FOR PERMIT TO DRILL, DEEPEN, OR PLUG BACK

1a. Type of Work		7. Unit Agreement Name	
b. Type of Well DRILL <input checked="" type="checkbox"/> DEEPEN <input type="checkbox"/> PLUG BACK <input type="checkbox"/> OIL WELL <input checked="" type="checkbox"/> GAS WELL <input type="checkbox"/> OTHER <input type="checkbox"/> SINGLE ZONE <input checked="" type="checkbox"/> MULTIPLE ZONE <input type="checkbox"/>		8. Farm or Lease Name Belcher 7	
2. Name of Operator HNG Oil Company		9. Well No. 1	
3. Address of Operator P.O. Box 2267, Midland, Texas 79702		10. Field and Pool, or Wildcat Wildcat	
4. Location of Well UNIT LETTER A LOCATED 330 FEET FROM THE North LINE AND 550 FEET FROM THE East LINE OF SEC. 7 TWP. 24S RGE. 28E NMPM		12. County Eddy	
19. Proposed Depth 3700'		19A. Formation Cherry Canyon	
20. Rotary or C.T. Rotary		21. Elevations (Show whether DF, RT, etc.) GR-3064.0	
21A. Kind & Status Plug. Bond Blanket-Active		21B. Drilling Contractor Capitan Drilling Co.	
22. Approx. Date Work will start 6-10-77			

23.

PROPOSED CASING AND CEMENT PROGRAM

SIZE OF HOLE	SIZE OF CASING	WEIGHT PER FOOT	SETTING DEPTH	SACKS OF CEMENT	EST. TOP
12 1/4"	8-5/8"	24#	600'	400	Surface
7-7/8"	4 1/2"	10.5#	T.D.	1500	Surface

BOP installed at 600' with 3000# capacity. Will use standard surface controlled BOP installation.

APPROVAL VALID
FOR 90 DAYS UNLESS
DRILLING COMMENCED,
EXPIRES 9-7-77

IN ABOVE SPACE DESCRIBE PROPOSED PROGRAM: IF PROPOSAL IS TO DEEPEN OR PLUG BACK, GIVE DATA ON PRESENT PRODUCTIVE ZONE AND PROPOSED NEW PRODUCTIVE ZONE. GIVE BLOWOUT PREVENTER PROGRAM, IF ANY.

I hereby certify that the information above is true and complete to the best of my knowledge and belief.

Signed Ouida Roach Ouida Roach Title Production Clerk Date 6-1-77

(This space for State Use)

APPROVED BY W. A. Gussert TITLE SUPERVISOR, DISTRICT H DATE JUN 7 1977

CONDITIONS OF APPROVAL, IF ANY:

Cement must be circulated to
surface behind 8 7/8" casing

NEW MEXICO OIL CONSERVATION COMMISSION
WELL LOCATION AND ACREAGE DEDICATION PLAT

Form O-102
Supersedes C-128
Effective 1-1-65

All distances must be from the outer boundaries of the Section

Operator H. N. G. Oil Co.		Lease Belcher 7		Well No. 1
Unit Letter A	Section 7	Township 24 South	Range 28 East	County Eddy
Actual Well Location of Well: 330 feet from the North line and 550 feet from the East line				
Ground Level Elev 3064.0	Producing Formation Cherry Canyon	Foot Wildcat	Dedicated Acreage 40 Acres	

1. Outline the acreage dedicated to the subject well by colored pencil or hatchure marks on the plat below.
2. If more than one lease is dedicated to the well, outline each and identify the ownership thereof (both as to working interest and royalty).
3. If more than one lease of different ownership is dedicated to the well, have the interests of all owners been consolidated by communitization, unitization, force-pooling, etc?

☐ Yes ☐ No If answer is "yes," type of consolidation _____

If answer is "no," list the owners and tract descriptions which have actually been consolidated (Use reverse side of this form if necessary.) _____

No allowable will be assigned to the well until all interests have been consolidated (by communitization, unitization, forced-pooling, or otherwise) or until a non-standard unit, eliminating such interests, has been approved by the Commission.

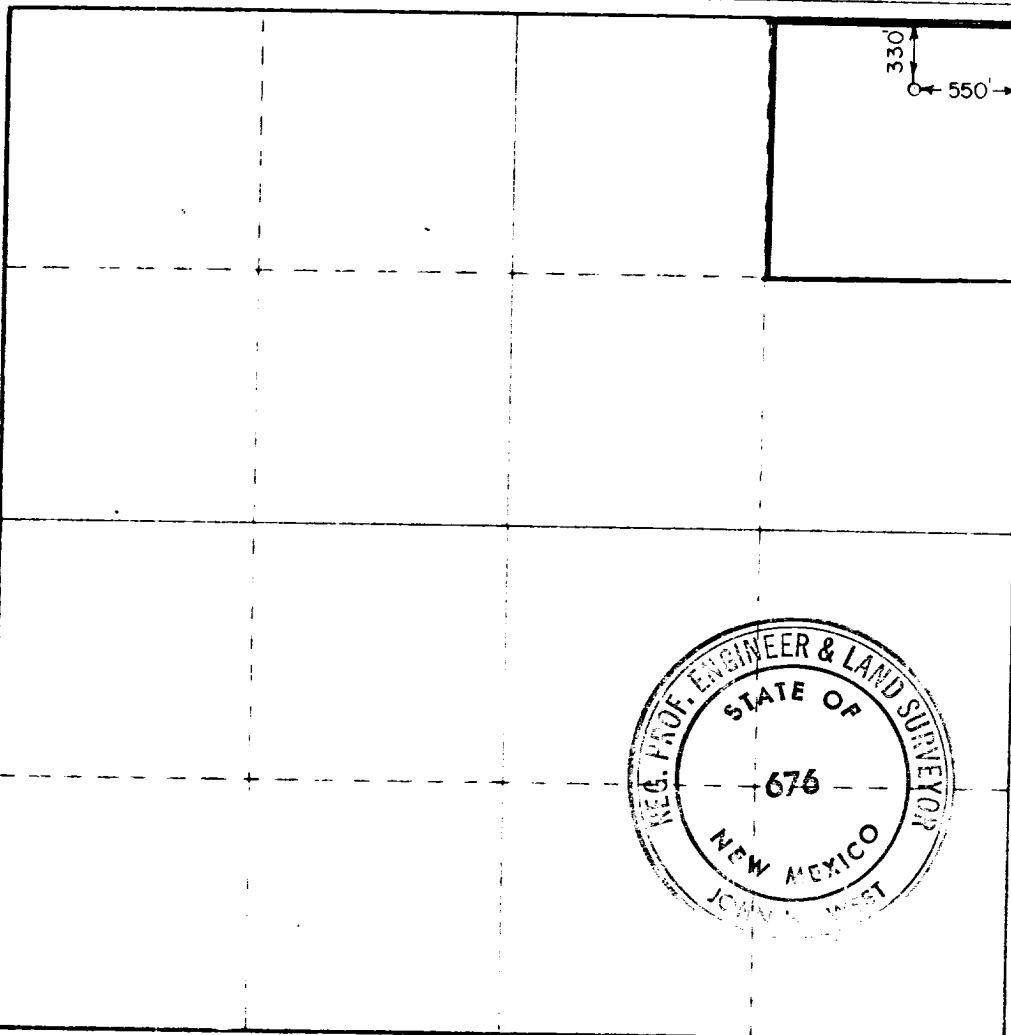

CERTIFICATION

I hereby certify that the information contained herein is true and complete to the best of my knowledge and belief

Ouida Roach

Name

Production Clerk

Position

HNG Oil Company

Company

6-1-77

Date

I hereby certify that the well location shown on this plat was plotted from field notes of actual surveys made by me or under my supervision, and that the same is true and correct to the best of my knowledge and belief

May 16, 1977

Registered Professional Engineer

and State Surveyor

John W. West

676

