

NE EXICO OIL CONSERVATION COMMISSION
WELL LOCATION AND ACREAGE DEDICATION PLAT

Form C-102
Supersedes C-128
Effective 1-1-65

All distances must be from the outer boundaries of the Section.

Operator J. C. BARNES OIL CO.			Lease BIG CHIEF COM			Well No. 2		
Unit Letter N	Section 22	Township 22S	Range 28 E	County Eddy				
Actual Footage Location of Well: 1980 feet from the W line and 660 feet from the SOUTH line								
Ground Level Elev. 3088	Producing Formation MORROW		Pool W. D. Watson, Jr.			Dedicated Acreage: 320 Acres		

1. Outline the acreage dedicated to the subject well by colored pencil or hachure marks on the plat below.
2. If more than one lease is dedicated to the well, outline each and identify the ownership thereof (both as to working interest and royalty).
3. If more than one lease of different ownership is dedicated to the well, have the interests of all owners been consolidated by communitization, unitization, force-pooling, etc?

☒ Yes ☐ No If answer is "yes," type of consolidation Communitization

If answer is "no," list the owners and tract descriptions which have actually been consolidated. (Use reverse side of this form if necessary.)

No allowable will be assigned to the well until all interests have been consolidated (by communitization, unitization, forced-pooling, or otherwise) or until a non-standard unit, eliminating such interests, has been approved by the Commission.

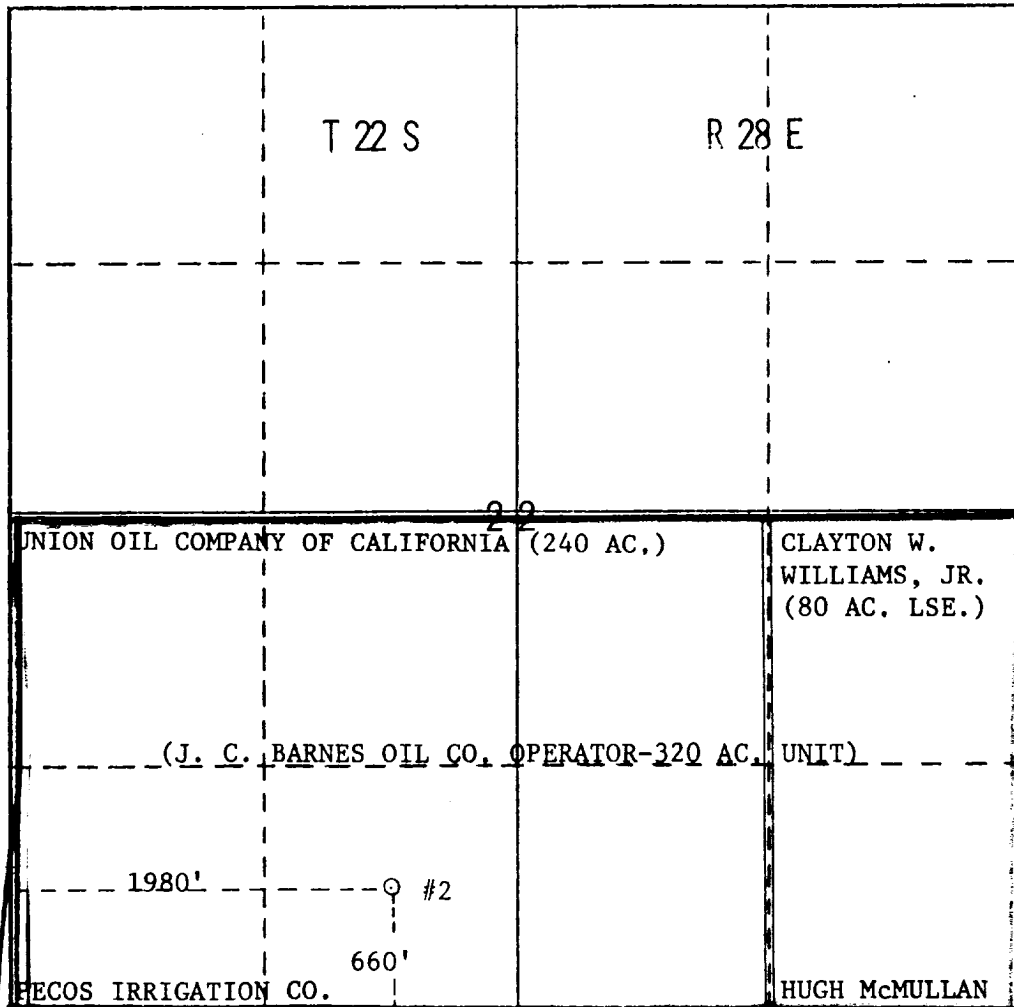

CERTIFICATION

I hereby certify that the information contained herein is true and complete to the best of my knowledge and belief.

Name W. D. Watson, Jr.
Position Field Supt.
Company J. C. Barnes Oil Co.
Date Oct 11, 1978

I hereby certify that the well location shown on this plat was obtained from field notes of a duly licensed surveyor, or under my supervision and that the same is true and correct to the best of my knowledge and belief.

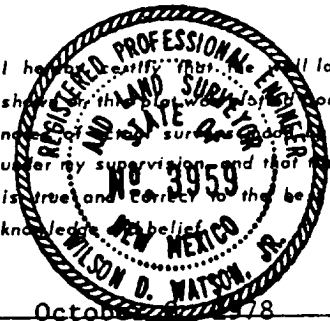

Date Surveyed October 11, 1978
W. D. Watson, Jr.
Registered Professional Engineer and/or Land Surveyor

Certificate No. 3959

