

MEXICO OIL CONSERVATION COMMISSION
WELL LOCATION AND ACREAGE DEDICATION PLAT

RECEIVED

Form C-122
Superseded C-128
Effective 1-1-65

All distances must be from the outer boundaries of the Section

APR 23 1991

| | | | | | |
|--|--------------------------------------|-------------------------------------|----------------------------------|----------------------------------|-------|
| Operator W.A. Moncrief, Jr. | | Lease Marathon State Com. | | Well No. 1 | |
| Unit Letter J | Section 11 | Township 24 South | Range 24 East | County ARTESIA, OFFICE | |
| Actual Footage Location of Well: 1980 feet from the South line and 1680 feet from the East line | | | | | |
| Ground Level Elev. 4100.2 4156.4 | Producing Formation STRAWN | | Dedicated Acreage: 320 | | Acres |

1. Outline the acreage dedicated to the subject well by colored pencil or hatchure marks on the plat below.
2. If more than one lease is dedicated to the well, outline each and identify the ownership thereof (both as to working interest and royalty).
3. If more than one lease of different ownership is dedicated to the well, have the interests of all owners been consolidated by communitization, unitization, force-pooling, etc?

☒ Yes ☐ No If answer is "yes," type of consolidation Communitization

If answer is "no," list the owners and tract descriptions which have actually been consolidated. (Use reverse side of this form if necessary.)

No allowable will be assigned to the well until all interests have been consolidated (by communitization, unitization, forced-pooling, or otherwise) or until a non-standard unit, eliminating such interests, has been approved by the Commission.

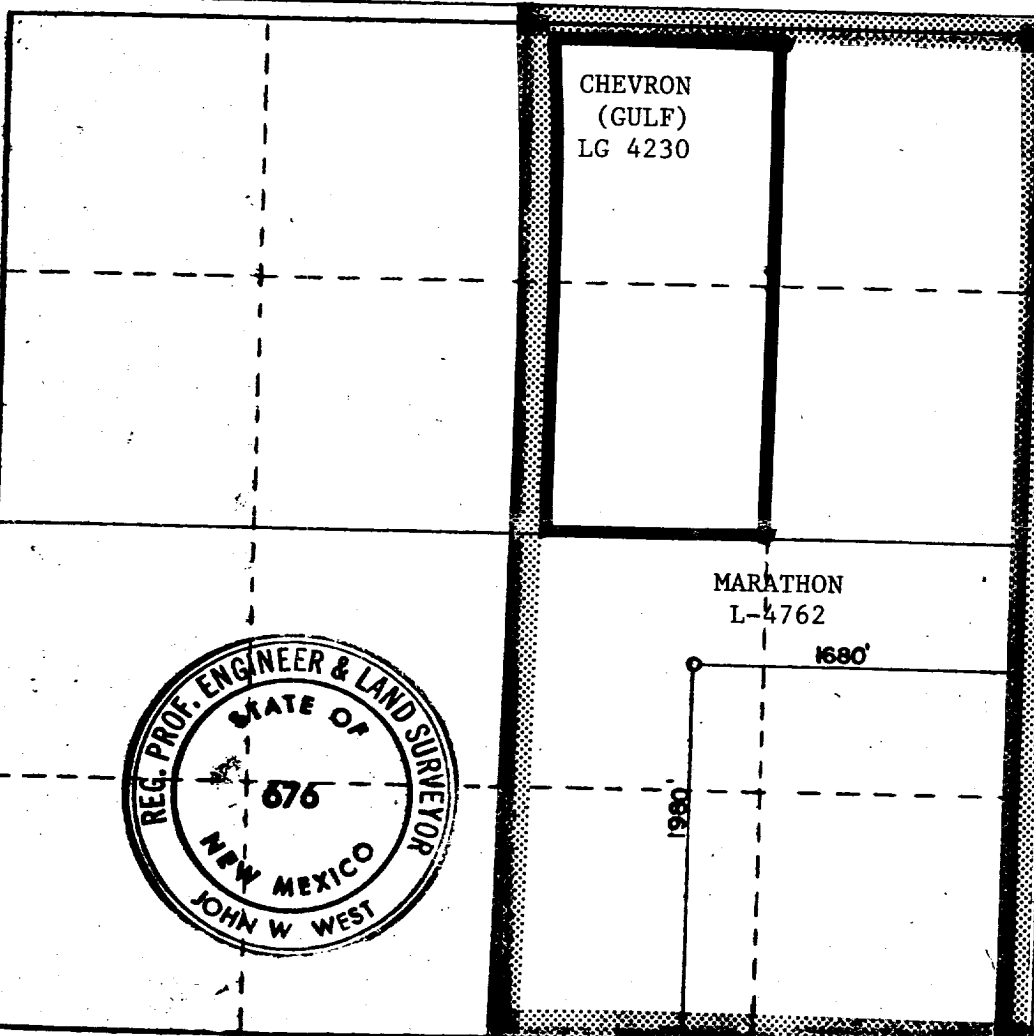

CERTIFICATION

I hereby certify that the information contained herein is true and complete to the best of my knowledge and belief.

Dewey E. Thornton
Name

Dewey E. Thornton

Position

Exploration Manager

Company

W. A. Moncrief, Jr.

Date

4-22-91

I hereby certify that the well location shown on this plat was plotted from field notes of actual surveys made by me or under my supervision, and that the same is true and correct to the best of my knowledge and belief.

Date Surveyed

December 18, 1979

Registered Professional Engineer and/or Land Surveyor

John W. West
Certificate No.

John W. West

576

Ronald J. Eidson

3239