

Carthel Federal No. 2

The Eastland Oil Company - Operator

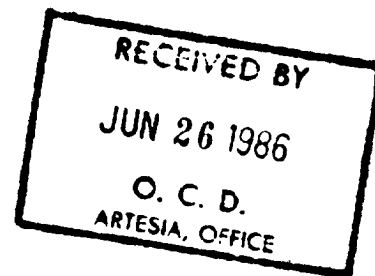

Attachment to Form C-104
IV Completion Data

Tubing, Casing, and Cementing Record

<u>Hole Size</u>	<u>Casing & Tubing Size</u>	<u>Depth Set</u>	<u>Sacks Cement</u>
6"	4-1/2"	11,785'	225-H

Liner Record

<u>Size</u>	<u>Top</u>	<u>Bottom</u>	<u>Sacks Cement</u>
7"	9,846	12,298	600-H
4-1/2"	12,119	13,270	160-H

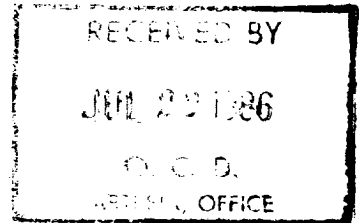

NEW MEXICO
OIL CONSERVATION DIVISION
P. O. DRAWER DD
ARTESIA, NEW MEXICO
88210

Date July 22, 1986

NOTICE OF LLANO'S GAS CONNECTION:

OPERATOR: Eastland Oil Company

LEASE: Carthel Federal Com.

WELL NUMBER AND UNIT: 2 G

LOCATION: 5-23S-29E

POOL: ~~Wildcat Atoka~~ N. Laguna Delada Atoka Pool

DATE WELL CONNECTED: July 2, 1986

DATE OF FIRST GAS SALES: July 2, 1986 12:45 P.M.

LLANO'S STATION NUMBER: 414

LLANO, INC.
TRANSPORTER

Doyle T. Forrester
REPRESENTATIVE

DOYLE T. FORRESTER
CONTRACT TECHNICIAN

OIL CONSERVATION DIVISION

Artesia, New Mexico

Eastland Oil Co.

Drawer 3488

Land, Tx 79702

3/27/86

Re: Wells placed in pool

Gentlemen:

As the result of Division Order R-8179 the following described well (~~a~~) (~~three-~~) been placed in the pool (~~to~~) shown below. This change in nomenclature has been made in our files. Please change your records to reflect the proper pool name. All subsequent reports must show this nomenclature until further notice.

North Laguna Salado - Atoka Gas Pool

Carthel Fed. Com. #2 6-5-23-29

Reporters are advised, by copy of this letter, to change their records to reflect the pool name as established by this order, effective 3/14/86.

Sincerely,
Darrell Moore
Darrell Moore
Geologist

Distribution:
Principal - Operator
Carthel Fed. Com.

My File

~~My File~~
Well File
DLM

Form 3160-4
(November, 1983)
(formerly 9-2338)
Lawyer DD
Artesia, NM

Plugged and Abandoned April, 1983, Original TD 3,270'
COMMISSION UNITED STATES
DEPARTMENT OF THE INTERIOR
88210 BUREAU OF LAND MANAGEMENT

SUBMIT IN DUP. TE*

(See other instructions on reverse side)

(Morrow)
Form approved.
Budget Bureau No. 1004-0137
Expires August 31, 1985

45F

WELL COMPLETION OR RECOMPLETION REPORT AND LOG *

1a. TYPE OF WELL: OIL WELL GAS WELL DRY Other _____
 b. TYPE OF COMPLETION: NEW WELL WORK OVER DEEP-EN PLUG BACK DIFF. RESRV. Other _____
 2. NAME OF OPERATOR
 The Eastland Oil Company ✓

5. LEASE DESIGNATION AND SERIAL NO.
 NM-59383
 6. IF INDIAN, ALLOTTEE OR TRIBE NAME
 7. UNIT AGREEMENT NAME
 8. FARM OR LEASE NAME
 Carthel Federal Com-
 9. WELL NO.

3. ADDRESS OF OPERATOR
 P.O. Drawer 3488, Midland, Texas 79702
 4. LOCATION OF WELL (Report location clearly and in accordance with any State requirements)*
 At surface 2030' FNL and 2080' FEL (Unit G, SW/4NE/4) JAN 17 1986
 At top prod. interval reported below
 Same
 At total depth

RECEIVED BY
 O. C. D.
 ARTESIA, OFFICE

11. FIELD AND POOL, OR WILDCAT
 Wildcat (Atoka)
 12. SEC. T., R., M., OR BLOCK AND SURVEY OR AREA
 Sec 5, T-23-S, R-29-E, NMPM

14. PERMIT NO. 30-015-23389 DATE ISSUED Nov 1, 1985 12. COUNTY OR PARISH Eddy 13. STATE New Mexico
 15. DATE SPUDDED 11-12-85 16. DATE T.D. REACHED 12-11-85 17. DATE COMPL. (Ready to prod.) 12-17-85 18. ELEVATIONS (DF, RKB, RT, GR, ETC.)* 3003' GR 19. ELEV. CASINGHEAD 3000'
 20. TOTAL DEPTH, MD & TVD 13,270' MD 21. PLUG, BACK T.D., MD & TVD 12,119' MD 22. IF MULTIPLE COMPL., HOW MANY* No 23. INTERVALS DRILLED BY ROTARY TOOLS 0-13,270' CABLE TOOLS ---
 24. PRODUCING INTERVAL(S), OF THIS COMPLETION—TOP, BOTTOM, NAME (MD AND TVD)* 11,990' - 12,014' Atoka (MD) 25. WAS DIRECTIONAL SURVEY MADE No

26. TYPE ELECTRIC AND OTHER LOGS RUN Compensated Neutron Gamma Ray, Dual Laterolog
 No additional logs run on re-entry (original completion)
 27. WAS WELL CORED No

29. CASING RECORD (Report all strings set in well)

CASING SIZE	WEIGHT, LB./FT.	DEPTH SET (MD)	HOLE SIZE	CEMENTING RECORD	AMOUNT PULLED
30"		30'	40"	5 yds Ready-mix	None
20"	94.5	496'	26"	700 sx 2% CaCl2	None
13-3/8"	54.5	2863'	17 1/2"	4000sx Lite, 200 sx Class	C None
9-5/8"	43.5	10249	12 1/4"	3400 sx Lite, 500 sx Class	C None
4 1/2"	13.5# & 11.6#	11785	6"	225 sx Class H	None

SIZE	TOP (MD)	BOTTOM (MD)	SACKS CEMENT*	SCREEN (MD)	SIZE	DEPTH SET (MD)	PACKER SET (MD)
7"	9846	12,298	600sx		2-3/8" BUE	11,825	11,728
4 1/2"	12119	13,270	160sx				

31. PERFORATION RECORD (Interval, size and number)
 11,990-12,014' 2 shots/ft (0.40") 48 holes (Atoka)
 32. ACID, SHOT, FRACTURE, CEMENT SQUEEZE, ETC.
 DEPTH INTERVAL (MD) 11,990-12,014 AMOUNT AND KIND OF MATERIAL USED 5,000 gals - 15% HCL
 Post ID-2
 1-31-86
 Comp Atoka

33.* PRODUCTION
 DATE FIRST PRODUCTION 12-15-85 PRODUCTION METHOD (Flowing, gas lift, pumping—size and type of pump) Flowing WELL STATUS (Producing or shut-in) Shut-in
 DATE OF TEST 12-16-85 HOURS TESTED 24 CHOKE SIZE 24/64 PROD'N. FOR TEST PERIOD → OIL—BBL. None GAS—MCF. 610 WATER—BBL. None GAS-OIL RATIO ---
 FLOW. TUBING PRESS. 180 CASING PRESSURE Packer CALCULATED 24-HOUR RATE → OIL—BBL. None GAS—MCF. 610 WATER—BBL. None OIL GRAVITY-API (CORR.) ---
 34. DISPOSITION OF GAS (Sold, used for fuel, vented, etc.) Vented TEST WITNESSED BY Travis Reed

35. LIST OF ATTACHMENTS
 None - Logs filed w/original completion on 12-16-81 JAN 15 1986
 36. I hereby certify that the foregoing and attached information is complete and correct as determined from all available records
 SIGNED George D. Neal TITLE Vice President-Production DATE 1-9-86

*(See Instructions and Spaces for Additional Data on Reverse Side)

37. SUMMARY OF POROUS ZONES: (Show all important zones of porosity and contents thereof; cored intervals; and all drill-stem, tests, including depth interval tested, cushion used, time tool open, flowing and shut-in pressures, and recoveries):

38. GEOLOGIC MARKERS

FORMATION	TOP	BOTTOM	DESCRIPTION, CONTENTS, ETC.	NAME	TOP	
					MEAS. DEPTH	TRUE VERT. DEPTH
Atoka	11,990	12,014	Production test - Dry gas BTU - 1025 wet S.G. - 0.592	Permian Delaware Bone Springs Wolfcamp Pennsylvanian Strawn Atoka Morrow Mississippian Barnett Sh	2920 6568 9860 11636 11720 12286 13210	

**UNITED STATES
DEPARTMENT OF THE INTERIOR
BUREAU OF LAND MANAGEMENT
NEW OIL CONS. COMMISSION**

SUBMIT IN TRIPLICATE*
(Other Instruct' on re-
verse side)

Budget Bureau No. 1001-1
Expires August 31, 1985

2157

5. LEASE DESIGNATION AND SERIAL
NM-59383

6. IF INDIAN, ALLOTTEE OR TRIBE NAME

7. UNIT AGREEMENT NAME

8. FARM OR LEASE NAME
Carthel Federal Com

9. WELL NO.
2

10. FIELD AND POOL OR WILDCAT
Wildcat (Atoka)

11. SEC., T., R., M., OR BLK. AND SURVEY OR AREA

Sec 5, T-23-S, R-29-E, NMPM

12. COUNTY OR PARISH
Eddy

13. STATE
New Mexico

SUNDRY NOTICES AND REPORTS ON WELLS

(Do not use this form for proposals to drill or to deepen or plug back to a different reservoir. Use "APPLICATION FOR PERMIT" for such proposals.)

RECEIVED BY
DEC 16 1985
O. C. D.
ARTESIA OFFICE

1. OIL WELL GAS WELL OTHER

2. NAME OF OPERATOR
The Eastland Oil Company ✓

3. ADDRESS OF OPERATOR
P. O. Drawer 3488, Midland, Texas 79702

4. LOCATION OF WELL (Report location clearly and in accordance with any State requirements. See also space 17 below.)
At surface

2030' FNL and 2080' FEL (Unit G, SW/4 NE/4)

14. PERMIT NO. 15. ELEVATIONS (Show whether DF, RT, GR, etc.)

API #30-015-23389 3003' GR

16. Check Appropriate Box To Indicate Nature of Notice, Report, or Other Data

NOTICE OF INTENTION TO:

SUBSEQUENT REPORT OF:

TEST WATER SHUT-OFF
FRACTURE TREAT
SHOOT OR ACIDIZE
REPAIR WELL
(Other) Run 4 1/2" casing

PULL OR ALTER CASING
MULTIPLE COMPLETE
ABANDON*
CHANGE PLANS XX

WATER SHUT-OFF
FRACTURE TREATMENT
SHOOTING OR ACIDIZING
(Other)

REPAIRING WELL
ALTERING CASING
ABANDONMENT*

(NOTE: Report results of multiple completion on Well Completion or Recompletion Report and Log form.)

17. DESCRIBE PROPOSED OR COMPLETED OPERATIONS (Clearly state all pertinent details, and give pertinent dates, including estimated date of starting any proposed work. If well is directionally drilled, give subsurface locations and measured and true vertical depths for all markers and zones pertinent to this work.)*

Using a workover rig and reverse circulation equipment, work was begun November 12, 1985 to drill out cement plugs and clean out well to depth of 12,119' in Atoka formation.

Total depth of 12,119' was reached on December 11, 1985 to top of 4 1/2" liner previously set below 7" liner. The top of 7" liner had been perforated for a production test from 9,954' to 10,177' on initial drilling.

To protect the well bore it is planned to set a designed string of 4 1/2" casing consisting of 600' of 13.5#, N-80; 9800' of 11.6#, N-80; and 1500' of 13.5#, N-80 on top, from 11,800' to surface. The casing will be cemented with 225 sacks Class H calculated to fill to 9500' in the 7" liner and 9 5/8" casing.

18. I hereby certify that the foregoing is true and correct

SIGNED George L. Neal TITLE Vice-President, Production DATE 12-11-85

(This space for Federal or State office use)

APPROVED BY _____ TITLE _____ DATE _____

CONDITIONS OF APPROVAL, IF ANY:

ACCEPTED FOR RECORD

Geo

*See Instructions on Reverse Side

DEC 13 1985

C/SF

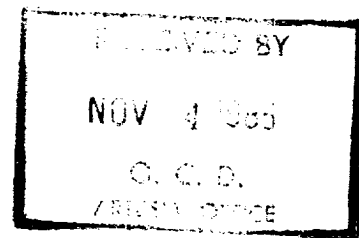

NM-59383
3160 (065)

Nov. 1, 1985

The Eastland Oil Company
P. O. Drawer 3488
Midland, Texas 79702

Dear Sir:

Your application for Permit to Re-enter Carthel Federal No. 2 in the SW $\frac{1}{4}$ NE $\frac{1}{4}$, sec. 5, T. 23 S., R. 29 E., Eddy County, New Mexico, lease NM-59383, to a depth of 12,100 feet to test the Atoka formation in the oil-potash area, is hereby approved as amended by stipulations attached to the application.

One copy of the application is returned herewith. Please notify the Bureau of Land Management office checked on the attached special stipulation, in sufficient time for a representative to witness all cementing operations.

Sincerely,

Francis R. Cherry, Jr.
District Manager, Roswell

Enclosure

cc:
~~NMOCD~~
CRA
Mining
Roswell District Files
NMSO Micrographics (943B-1)

ORMSETH/MS/10-31-85/1801M

Plugged and Abandoned April, 1983

Application to Re-enter a Test to 12,100' (Atoka) Orig: 1 T.D. 13,270' (Morrow)
Form 3160-3 (November 1983) (formerly 9-331C)
SUBMIT IN T. C. DATE* Form approved. Budget Bureau No. 1004-0136 Expires August 31, 1985

UNITED STATES DEPARTMENT OF THE INTERIOR
BUREAU OF LAND MANAGEMENT

NM OIL CONSORTIUM Instructions on reverse side

APPLICATION FOR PERMIT TO DRILL, DEEPEN, OR PLUG BACK

1a. TYPE OF WORK DRILL DEEPEN PLUG BACK

b. TYPE OF WELL OIL WELL GAS WELL OTHER SINGLE ZONE MULTIPLE ZONE

2. NAME OF OPERATOR The Eastland Oil Company

3. ADDRESS OF OPERATOR P.O. Drawer 3488, Midland, Texas 79702

4. LOCATION OF WELL (Report location clearly and in accordance with any State requirements*)
At surface 2030' FNL and 2080' FEL (Unit G. SW/4NE/4)
At proposed prod. zone 2030' FNL and 2080' FEL

14. DISTANCE IN MILES AND DIRECTION FROM NEAREST TOWN OR POST OFFICE*
13 miles ESE of Carlsbad, New Mexico

15. DISTANCE FROM PROPOSED* LOCATION TO NEAREST PROPERTY OR LEASE LINE, FT. (Also to nearest drlg. unit line, if any) 2030'

18. DISTANCE FROM PROPOSED LOCATION* TO NEAREST WELL, DRILLING, COMPLETED, OR APPLIED FOR, ON THIS LEASE, FT. 1270*

21. ELEVATIONS (Show whether DF, RT, GR, etc.) 3003' GR

16. NO. OF ACRES IN LEASE 602

19. PROPOSED DEPTH 12,100'

17. NO. OF ACRES ASSIGNED TO THIS WELL 320

20. ROTARY OR CABLE TOOLS Workover Rig-Reverse Unit

22. APPROX. DATE WORK WILL START* Aug 15, 1985

23. PROPOSED CASING AND CEMENTING PROGRAM

SIZE OF HOLE	SIZE OF CASING	WEIGHT PER FOOT	SETTING DEPTH	QUANTITY OF CEMENT
40"	30"	Conductor	30	Ready Mix
26"	20"	94.5#	496'	1375 sx - circulate
17 1/2"	13-3/8"	61# & 54.5#	2863'	4200 sx - circulate
12 1/4"	9-5/8"	43.5#	10249'	3900 sx - circulate
8 1/2"	7" liner	29-32#	9846'-12298'	600 sx circulate
6 1/2"	4 1/2" liner	13.5#	12119'-13275'	160 sx circulate

Attachments:

- Surface Use and Operation Plan
- Well Location and Acreage Dedication Plat
- Workover Procedure and Drilling Data

Gas is not dedicated

*Cibola Carthel Federal No.1 - P&A @ 3163'TD

IN ABOVE SPACE DESCRIBE PROPOSED PROGRAM: If proposal is to deepen or plug back, give data on present productive zone and proposed new productive zone. If proposal is to drill or deepen directionally, give pertinent data on subsurface locations and measured and true vertical depths. Give blowout preventer program, if any.

24. SIGNED George H. Neal TITLE Vice President - Production DATE 7-29-85

(This space for Federal or State office use)

PERMIT NO. _____ APPROVAL DATE _____

APPROVED BY _____ TITLE _____ DATE _____

APPROVAL SUBJECT TO GENERAL REQUIREMENTS AND SPECIAL STIPULATIONS ATTACHED

Subject to Like Approval by State *See Instructions On Reverse Side

All distances given by from the outer boundaries of the Section

Operator The Eastland Oil Company		Lease Carthel Federal		Well No. 2
Unit Letter G	Section 5	Township 23South	Range 29 East	County Eddy
Actual Footage Location of Well:				
2030	feet from the North	line and 2080	feet from the East	line
Ground Level Elev. 3003	Producing Formation Atoka	Pool Wildcat	Dedicated Acreage: 320 Acres	

1. Outline the acreage dedicated to the subject well by colored pencil or hachure marks on the plat below.
2. If more than one lease is dedicated to the well, outline each and identify the ownership thereof (both as to working interest and royalty).
3. If more than one lease of different ownership is dedicated to the well, have the interests of all owners been consolidated by communitization, unitization, force-pooling, etc?

Yes No If answer is "yes," type of consolidation _____

If answer is "no," list the owners and tract descriptions which have actually been consolidated. (Use reverse side of this form if necessary.) _____

No allowable will be assigned to the well until all interests have been consolidated (by communitization, unitization, forced-pooling, or otherwise) or until a non-standard unit, eliminating such interests, has been approved by the Division

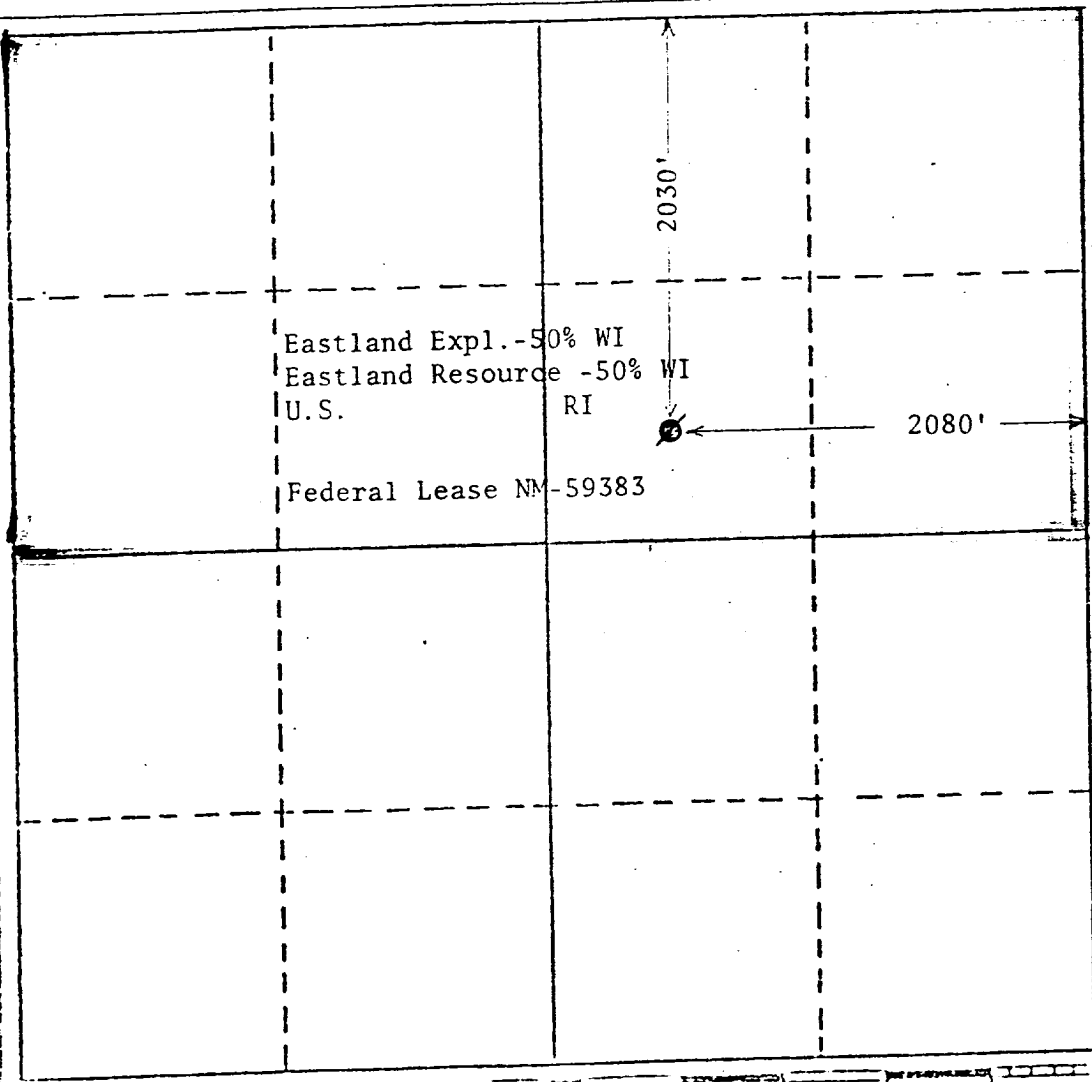

CERTIFICATION

I hereby certify that the information contained herein is true and complete to the best of my knowledge and belief.

George D. Neal
Name **George D. Neal**

Position
Vice President-Production

Company
The Eastland Oil Company

Date
June 25, 1985

I hereby certify that the well location shown on this plat was plotted from field notes of actual surveys made by me or under my supervision, and that the same is true and correct to the best of my knowledge and belief.

Date Surveyed
May 2, 1980

Registered Professional Engineer and/or Land Surveyor
John W. West

Certificate No. _____

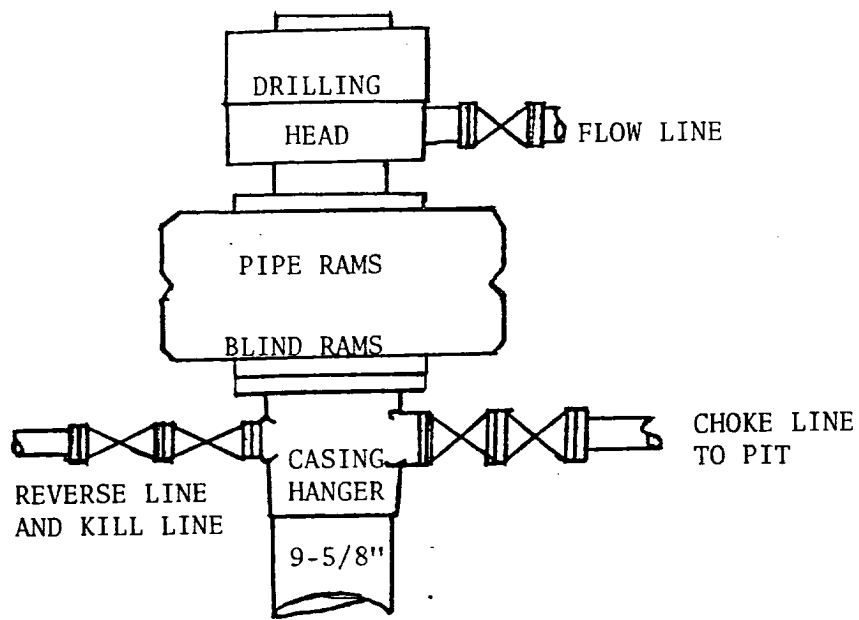

BLOWOUT PREVENTER
 5000 PSI
 9-5/8" CASING

THE EASTLAND OIL COMPANY
 Re-entry
 CARTHEL FEDERAL No. 2
 Sec. 5, T22S, R29E
 Eddy County, New Mexico

WORKOVER PLAN
THE EASTLAND OIL COMPANY
CARTEL FEDERAL NO. 2
2030' FNL & 2080' FEL, Sec. 5, T23S, R29E
Eddy County, New Mexico

- 1) Moved in and rigged up workover rig.
- 2) Nipple up 11" hydraulic double ram 5M BOP's on 9-5/8" casing head.
- 3) Rig up reverse unit and drilling head.
- 4) Test BOP and wellhead.
- 5) Pick up 8-1/2" bit and drill collar.
- 6) Drill out cement in 9-5/8" casing to 3032' using 3-1/2" tubing and brine water for drilling fluid.
- 7) Run bit to top of cement plug at 3993' and test casing and perms from 2994' to 3018' w/1500 psi for 30 minutes.
- 8) Drill cement plug from 3993' to 4113'.
- 9) Clean out and circulate hole to plug at 5950' and test casing to 1500 psi.
- 10) Drill cement plug from 5953' to 6102' (DV tool @ 6040').
- 11) Circulate hole and clean out to 9800'. → *Drill out plug 6602'*
- 12) Test casing to 1500 psi.
- 13) Clean out to top of 7" liner @ 9846'.
- 14) Check top of liner for junk, etc. *6772'*
- 15) Trip out of hole and pick up 6-1/2" bit and drill collars. *R.P.*
- 16) Trip in hole and drill cement plug inside 7" liner from 9846' to 10,288'.
- 17) Wash and circulate 7" liner to top of plug @ 12,010'.
- 18) Drill out cement to top of 4-1/2" liner @ 12,100'.
- 19) Test casing w/1500 psi.
- 20) Trip out of hole and lay down 3-1/2" tubing and drill collars.
- 21) Pick up 2" EUE N-80 tubing with 7" packer and test in hole to 8,000 psi.
- 22) Circulate hole at 11,970' with packer fluid in annulus and spot acid to perforate.
- 23) Nipple up wellhead.
- 24) Run Gamma Ray correlation log and collar log.
Perforate as indicated in Atoka from open hole logs.
- 25) Acidize as necessary for production and test by swabbing and flowing.

CORONADO EXPLORATION CORPORATION

CARTHEL FEDERAL COM. NO. 2

2030' FNL & 2080' FEL, SEC. 5., T-23-S, R-29-E

EDDY COUNTY, NEW MEXICO

LEASES: SEE FORM C-102 & ATTACHMENTS

This supplemental plan is submitted with the Application to Drill the above-described well in compliance with NTL-6 of the United States Department of the Interior.

- The surface is composed of a fine-grained sand, alluvium, quaternary in age.
- Estimated top of primary geologic markers are:

<u>Formation</u>	<u>Est. Depth</u>	<u>Subsea</u>
Base Rustler	655'	+ 2,354'
Bell Canyon	2,895'	- 114'
Cherry Canyon	3,932'	- 923'
Brushy Canyon	4,977'	- 1,968'
Bone Spring	6,533'	- 3,524'
3rd Bone Spring	9,460'	- 6,451'
Wolfcamp	10,132'	- 7,122'
Penn	11,276'	- 8,267'
Strawn	11,444'	- 8,435'
Atoka	11,663'	- 8,654'
Morrow Lime	12,326'	- 9,317'
Morrow Sands	12,445'	- 9,436'
Total Depth	13,600'	-10,591'

Elevations: GL - 3,003'. KB - 3,028' (estimated).

- The estimated depths at which anticipated water, oil or gas bearing formations are to be encountered are:

655' (-)	salt	Rustler Dolomite
3,932'	oil	Cherry Canyon Sand
10,132'	oil/gas	Wolfcamp Lime
11,444'	gas	Strawn
11,663'	gas	Atoka
12,445'	gas	Morrow Sands

Stipulations _____

FEDERAL COM. NO. 2 R 29 E

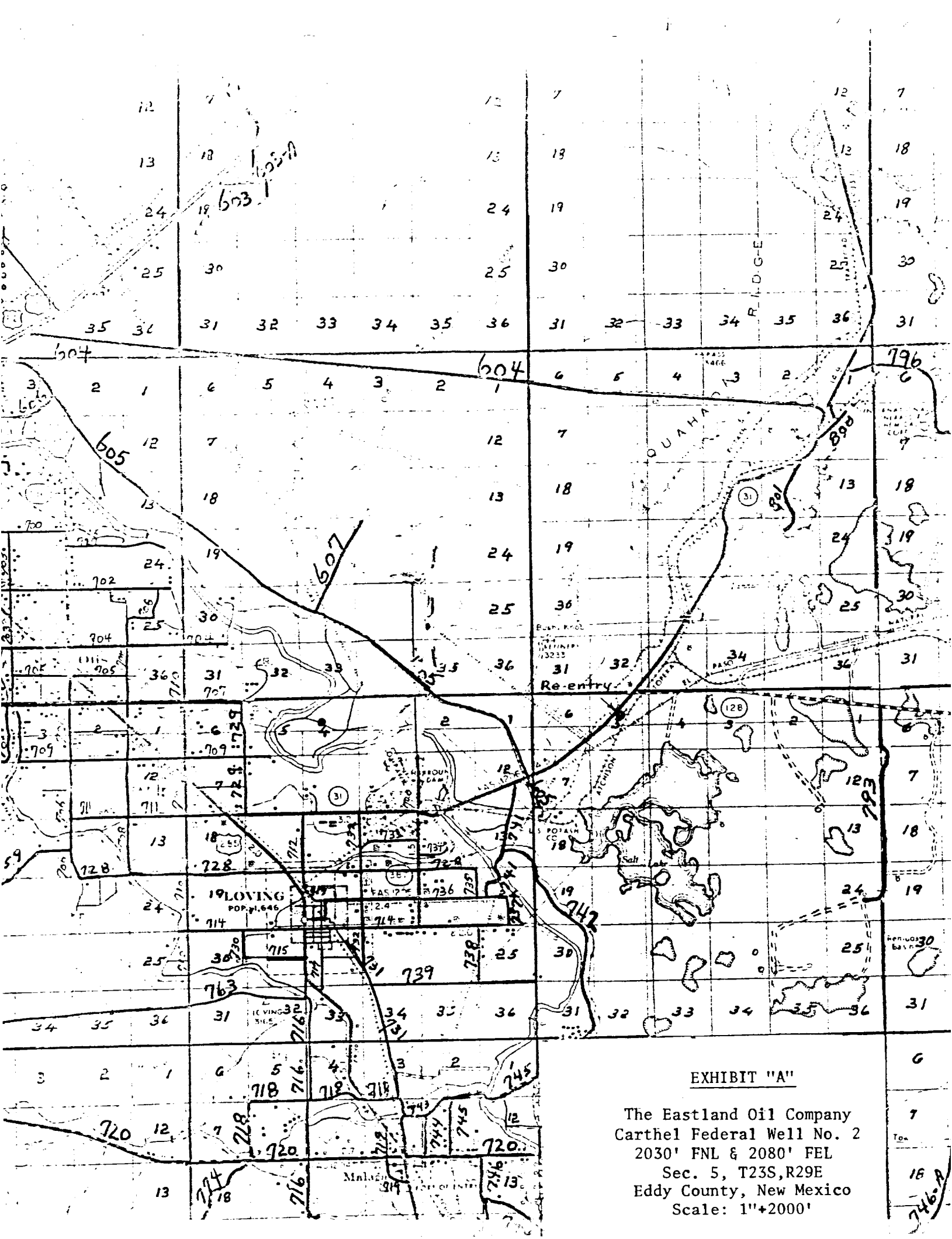

EXHIBIT "A"

The Eastland Oil Company
 Carthel Federal Well No. 2
 2030' FNL & 2080' FEL
 Sec. 5, T23S, R29E
 Eddy County, New Mexico
 Scale: 1"=2000'

6
7
16
746-A

WORKOVER RIG LAYOUT

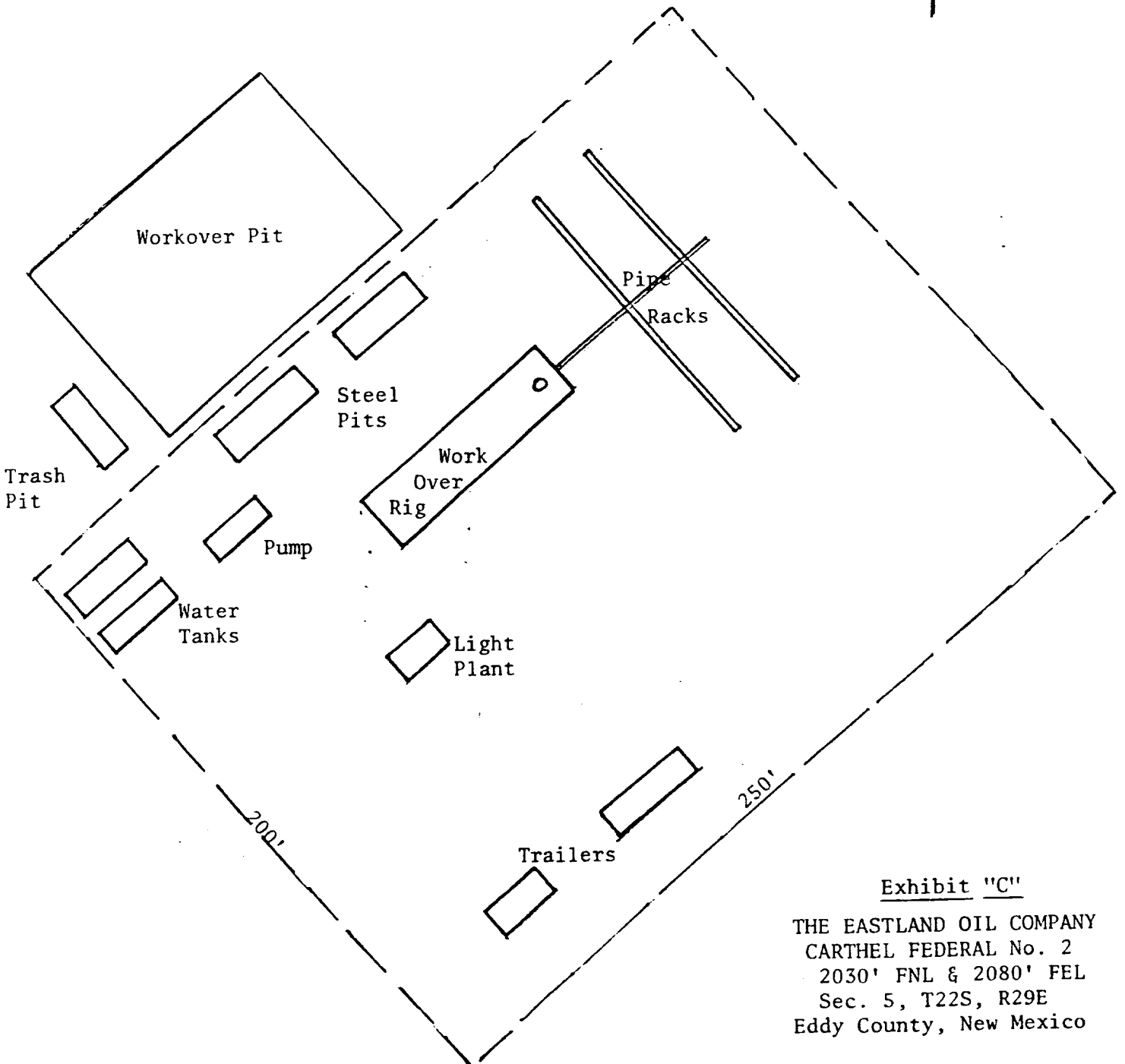
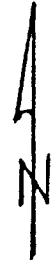

Exhibit "C"

THE EASTLAND OIL COMPANY
CARTEL FEDERAL No. 2
2030' FNL & 2080' FEL
Sec. 5, T22S, R29E
Eddy County, New Mexico

C184

UNITED STATES DEPARTMENT OF THE INTERIOR
GEOLOGICAL SURVEY
Albuquerque, NM 88210

5. LEASE
NM 0556291

6. IF INDIAN, ALLOTTEE OR TRIBE NAME

7. UNIT AGREEMENT NAME

8. FARM OR LEASE NAME
Carthel Federal *Com*

9. WELL NO.
2

10. FIELD OR WILDCAT NAME
Wildcat - *Moscow*

11. SEC., T., R., M., OR BLK. AND SURVEY OR AREA
Sec. 5-23S-29E

12. COUNTY OR PARISH | 13. STATE
~~Chaves~~ - EDDY | New Mexico

14. API NO.

15. ELEVATIONS (SHOW DF, KDB, AND WD)
3003.4 Gr.

SUNDRY NOTICES AND REPORTS ON WELLS

(Do not use this form for proposals to drill or to deepen or plug back to a different reservoir. Use Form 9-331-C for such proposals.)

RECEIVED BY
JUN 18 1984
O. C. D.
ARTESIA, OFFICE

1. oil well gas well other

2. NAME OF OPERATOR
Cibola Energy Corporation

3. ADDRESS OF OPERATOR
P.O. Box 1668, Albuquerque, NM 87103.

4. LOCATION OF WELL (REPORT LOCATION CLEARLY. See space 17 below.)
AT SURFACE: 2030' FNL & 2080' FEL
AT TOP PROD. INTERVAL:
AT TOTAL DEPTH:

16. CHECK APPROPRIATE BOX TO INDICATE NATURE OF NOTICE, REPORT, OR OTHER DATA

REQUEST FOR APPROVAL TO:		SUBSEQUENT REPORT OF:	
TEST WATER SHUT-OFF	<input type="checkbox"/>		<input type="checkbox"/>
FRACTURE TREAT	<input type="checkbox"/>		<input type="checkbox"/>
SHOOT OR ACIDIZE	<input type="checkbox"/>		<input type="checkbox"/>
REPAIR WELL	<input type="checkbox"/>		<input type="checkbox"/>
PULL OR ALTER CASING	<input type="checkbox"/>		<input type="checkbox"/>
MULTIPLE COMPLETE	<input type="checkbox"/>		<input type="checkbox"/>
CHANGE ZONES	<input type="checkbox"/>		<input type="checkbox"/>
ABANDON* (other)	<input type="checkbox"/>		<input checked="" type="checkbox"/>

NOTE: Report results of multiple completion or zone change on Form 9-330.
APR 29 1983
OIL & GAS

17. DESCRIBE PROPOSED OR COMPLETED OPERATIONS (Clearly state all pertinent details, and give pertinent dates, including estimated date of starting any proposed work. If well is directionally drilled, give subsurface locations and measured and true vertical depths for all markers and zones pertinent to this work.)*

Plugged well as follows:

1. CIBP with 35 sacks Class C Cement at 12,700'.
2. 30 sacks Class H Cement at 12,210', tagged at 12,010'.
3. 85 sacks Class H Cement at 10,288-9,800'.
4. 90 sacks Class H Cement at 6,772 - 6602'.
5. 60 sacks Class H Cement at 6,102 - 5953'.
6. 45 sacks Class C Cement at 4,113 - 3993'.
7. 725 sacks Class C Cement with 2% gel at 3032' - surface.

Dry hole marker was set at surface.

Location will cleaned and reclaimed as stated in Application to Drill by 6-30-83.

Subsurface Safety Valve: Manu. and Type _____ Set @ _____ Ft.

18. I hereby certify that the foregoing is true and correct

SIGNED _____ TITLE Oper. Manager DATE 4-22-83

APPROVED BY _____ (This space for Federal or State office use) TITLE _____ DATE 12-84

UNITED STATES DEPARTMENT OF THE INTERIOR GEOLOGICAL SURVEY

SUBMIT IN DUPL. E*

(See other instructions on reverse side)

Form approved, Budget Bureau No. 42-R355.5.

5. LEASE DESIGNATION AND SERIAL NO.

NM 0556291

6. IF INDIAN, ALLOTTEE OR TRIBE NAME

7. UNIT AGREEMENT NAME

8. FARM OR LEASE NAME

Carthel Federal

9. WELL NO.

2

10. FIELD AND POOL, OR WILDCAT

Wildcat - *Widow*

11. SEC., T., R., M., OR BLOCK AND SURVEY OR AREA

Sec. 5-23S-29E

12. COUNTY OR PARISH

Eddy

13. STATE

NM

WELL COMPLETION OR RECOMPLETION REPORT AND LOG*

1a. TYPE OF WELL: OIL WELL GAS WELL DRY Other

b. TYPE OF COMPLETION: NEW WELL WORK OVER DEEP-EN PLUG BACK DIFF. RESVR. Other

2. NAME OF OPERATOR: Cibola Energy Corporation

3. ADDRESS OF OPERATOR: P.O. Box 1668, Albuquerque, New Mexico 87103

4. LOCATION OF WELL (Report location clearly and in accordance with any State Requirements)* At surface 2030' FNL & 2080' FEL

At top prod. interval reported below

At total depth

14. PERMIT NO. O.C.D. DATE ISSUED ARTESIA, OFFICE

15. DATE SPUDDED 6-18-81 16. DATE T.D. REACHED 9-30-81 17. DATE COMPL. (Ready to prod.) P&A 3-1-83 18. ELEVATIONS (DF, REB, BT, GR, ETC.)* 3003.4 Gr.

20. TOTAL DEPTH, MD & TVD 13,270' 21. PLUG, BACK T.D., MD & TVD 22. IF MULTIPLE COMPL., HOW MANY* 23. INTERVALS DRILLED BY 24. PRODUCING INTERVAL(S), OF THIS COMPLETION—TOP, BOTTOM, NAME (MD AND TVD)*

19. ELEV. CASINGHEAD

25. WAS DIRECTIONAL SURVEY MADE

26. TYPE ELECTRIC AND OTHER LOGS RUN: Compensated Neutron Formation Density, Dual Induction

Table with 6 columns: CASING SIZE, WEIGHT, LB./FT., DEPTH SET (MD), HOLE SIZE, CEMENTING RECORD, AMOUNT PULLED. Rows include casing sizes 30", 20", 13 3/8", 9 5/8" and cementing records like 75 sx Class C w/2% CaCl.

Table with 8 columns: SIZE, TOP (MD), BOTTOM (MD), SACKS CEMENT*, SCREEN (MD), SIZE, DEPTH SET (MD), PACKER SET (MD). Rows include sizes 7" and 4 1/2" with corresponding depths and cement amounts.

Table with 2 columns: PERFORATION RECORD (Interval, size and number) and ACID, SHOT, FRACTURE, CEMENT SQUEEZE, ETC. Rows include intervals like 10,154-163' and acid treatments like 2500 gal 15% acid.

33.* PRODUCTION Cont'd on back DATE FIRST PRODUCTION PRODUCTION METHOD (Flowing, gas lift, pumping—size and type of pump) WELL STATUS (Producing or shut-in) P & A 3-1-83

Table with 8 columns: DATE OF TEST, HOURS TESTED, CHOKE SIZE, PROD'N. FOR TEST PERIOD, OIL—BBL., GAS—MCF., WATER—BBL., GAS-OIL RATIO. Includes flow tubing pressure and casing pressure data.

34. DISPOSITION OF GAS (Sold, used for fuel, vented, etc.) TEST WITNESSED BY

35. LIST OF ATTACHMENTS: Logs

36. I hereby certify that the foregoing and attached information is complete and correct as determined from all available records

SIGNED [Signature] TITLE Operations Manager ROSWELL, NEW MEXICO DATE 4-21-83

*(See Instructions and Spaces for Additional Data on Reverse Side)

INSTRUCTIONS

General: This form is designed for submitting a complete and correct well completion report and log on all types of lands and leases to either a Federal agency or a State agency, or both, pursuant to applicable Federal and/or State laws and regulations. Any necessary special instructions concerning the use of this form and the number of copies to be submitted, particularly with regard to local, area, or regional procedures and practices, either are shown below or will be issued by, or may be obtained from, the local Federal and/or State office. See instructions on items 22 and 24, and 33, below regarding separate reports for separate completions. If not filed prior to the time this summary record is submitted, copies of all currently available logs (drillers, geologists, sample and core analysis, all types electric, etc.), formation and pressure tests, and directional surveys, should be attached hereto, to the extent required by applicable Federal and/or State laws and regulations. All attachments should be listed on this form, see item 33.

Item 4: If there are no applicable State requirements, locations on Federal or Indian land should be described in accordance with Federal requirements. Consult local State or Federal office for specific instructions.

Item 18: Indicate which elevation is used as reference (where not otherwise shown) for depth measurements given in other spaces on this form and in any attachments.

Items 22 and 24: If this well is completed for separate production from more than one interval zone (multiple completion), so state in item 22, and in item 24 show the producing interval, or intervals, top(s), bottom(s) and name(s) (if any) for only the interval reported in item 33. Submit a separate report (page) on this form, adequately identified, for each additional interval to be separately produced, showing the additional data pertinent to such interval.

Item 29: "Sacks Cement": Attached supplemental records for this well should show the details of any multiple stage cementing and the location of the cementing tool.

Item 33: Submit a separate completion report on this form for each interval to be separately produced. (See instruction for items 22 and 24 above.)

4,040 - 4,060' 2 shots per foot 4000 gallons 15% acid
 2,994 - 3,018' 2 shots per foot 4000 gallons 15% acid

37. SUMMARY OF POROUS ZONES:
 SHOW ALL IMPORTANT ZONES OF POROSITY AND CONTENTS THEREOF; CORED INTERVALS; AND ALL DRILL-STEM TESTS, INCLUDING DEPTH INTERVAL TESTED, CUSHION USED, TIME TOOL OPEN, FLOWING AND SHUT-IN PRESSURES, AND RECOVERIES

FORMATION	TOP	BOTTOM	DESCRIPTION, CONTENTS, ETC.	GEOLOGIC MARKERS	
				NAME	TOP MEAS. DEPTH TRUE VERT. DEPTH
				38.	
				Permian (Delaware) (Bone Springs) (Wolfcamp)	2920 6568 9860
				Pennsylvanian (Strawn) (Atoka) (Morrow)	11636 11720 12286
				Mississippian (Barnett Sh)	13210

El Paso NATURAL GAS
COMPANY

P. O. BOX 1384
JAL, NEW MEXICO 88252
PHONE: 505-395-2551

RECEIVED

March 15, 1983

MAR 25 1983

O. C. D.
ARTESIA, OFFICE

Oil Conservation Division
State of New Mexico
P.O. Drawer DD
Artesia, NM 88210

Gentlemen:

This is to advise that on March 5, 1983 the Cibola Energy Corp.'s Carthel Fed. #2 - Morrow gas well located in Unit G of S Section 5, Township 23-S, Range 29-E, Eddy County, New Mexico was temporarily disconnected from El Paso Natural Gas Company's gathering system. This meter is blind plated and will remain on location temporarily, but inoperative, until permanent status of the measuring arrangement is determined.

This disconnection was due to advise from the operator that the well will be plugged and abandoned. Meter No. 58-577-01, Site Code #35675-01

Yours truly,

PERMIAN DIVISION DISPATCHING DEPARTMENT

Joel A. Corder

Joel A. Corder
Coordinator, Division Gas Control

JAC:bl

cc: Oil Conservation Division - Santa Fe, NM
Production Control Dept.
H. O. Whitt
Gas Purchases
M. E. McEuen
Operator
Measurement
R. L. Tabb
Earl Smith
Vernon Rogers
Slim Gordon
W. L. Drury
File

UNITED STATES DEPARTMENT OF THE INTERIOR
GEOLOGICAL SURVEY
NEW MEXICO OIL & GAS INVESTIGATION
Artesia, NM 88210

C/SF

RELEASE DISPOSITION AND SERIAL NUMBER
NM 0556491
RECEIVED
DEC 28 1981

WELL COMPLETION OR RECOMPLETION REPORT AND LOG*

1a. TYPE OF WELL: OIL WELL GAS WELL DRY

b. TYPE OF COMPLETION: NEW WELL WORK OVER DEEP-EN PLUG BACK DIFF. RESVR.

2. NAME OF OPERATOR: Cibola Energy Corporation

3. ADDRESS OF OPERATOR: P.O. Box 1668, Albuquerque, New Mexico 87103

4. LOCATION OF WELL (Report location clearly and in accordance with any State requirements)*
At surface: 2030' FNL & 2080' FEL
At top prod. interval reported below
At total depth

14. PERMIT NO. DATE ISSUED

15. DATE SPUDDED: 6-18-81

16. DATE T.D. REACHED: 9-30-81

17. DATE COMPL. (Ready to prod.): 11-07-81

18. ELEVATIONS (DP, BEB, RT, GR, ETC.)*: 3003.4 Gr.

19. ELEV. CASINGHEAD

20. TOTAL DEPTH, MD & TVD: 13,270

21. PLUG, BACK T.D., MD & TVD: 12,800

22. IF MULTIPLE COMPL., HOW MANY*: single

23. INTERVALS DRILLED BY: →

ROTARY TOOLS: RT

CABLE TOOLS

24. PRODUCING INTERVAL(S), OF THIS COMPLETION—TOP, BOTTOM, NAME (MD AND TVD)*
12,726 - 12,734' Morrow

25. WAS DIRECTIONAL SURVEY MADE

26. TYPE ELECTRIC AND OTHER LOGS RUN: Compensated Neutron, Gamma Ray, Dual Laterolog, Computer Processed Log

27. WAS WELL CORED: No

28. CASING RECORD (Report all strings set in well)

CASING SIZE	WEIGHT, LB./FT.	DEPTH SET (MD)	HOLE SIZE	CEMENTING RECORD	AMOUNT PULLED
30"		30'	40"		
20"	94.5	496'	26"	75 sx Class C w/2% CaCl 625 sx Halad Lite 2% CaCl	
13 3/8"	54.5	2863'	17 1/2"	4000 sx Howco Lite 200 sx Class C	
9 5/8"	43.5	10249'	12 1/4"	3400 sx Trinity Lite 500 sx Class C	

29. LINER RECORD

SIZE	TOP (MD)	BOTTOM (MD)	SACKS CEMENT*	SCREEN (MD)	SIZE	DEPTH SET (MD)	PACKER SET (MD)
7"	9846	12,298	600 SX		2 3/8"	12,687	12,666
4 1/2"	12119	13,275	160 SX				

30. TUBING RECORD

31. PERFORATION RECORD (Interval, size and number)

12,726 - 12,734'	.39	2 shots per foot
13,182 - 13,192'	.39	4 shots per foot
13,200 - 13,208'	.39	4 shots per foot
13,200 - 13,208'	.39	5 shots per foot

32. ACID, SHOT, FRACTURE, CEMENT SQUEEZE, ETC.

DEPTH INTERVAL (MD)	AMOUNT AND KIND OF MATERIAL USED
12,726 - 12,734	1000 gal 7 1/2% MSR-100 acid
13,132 - 13,142	squeeze 105 sx Class H
13,200 - 13,208	1000 gal 7 1/2% 30,000 gal 2% KCL

33.* PRODUCTION

DATE FIRST PRODUCTION: 11-8-81

PRODUCTION METHOD (Flowing, gas lift, pumping—size and type of pump): Flowing

WELL STATUS (Producing or shut-in): Shut in

DATE OF TEST: 11-8-81

HOURS TESTED: →

CHOKE SIZE: →

PROD'N. FOR TEST PERIOD: →

OIL—BBL.: →

GAS—MCF.: see attachment

WATER—BBL.: →

GAS-OIL RATIO: →

FLOW. TUBING PRESS.: →

CASING PRESSURE: →

CALCULATED 24-HOUR RATE: →

OIL—BBL.: →

GAS—MCF.: 380.8

WATER—BBL.: →

OIL GRAVITY-API (CORR.): →

34. DISPOSITION OF GAS (Sold, used for fuel, vented, etc.): Well shut in

TEST WITNESSED BY: Phelps White

35. LIST OF ATTACHMENTS: Logs and Form C-122

36. I hereby certify that the foregoing and attached information is complete and correct as determined from all available records

SIGNED: [Signature]

TITLE: Operations Manager

DATE: 12-16-81

ACCEPTED FOR RECORD
PETER W. CHESTER
DEC 23 1981
TITLE: Operations Manager
U.S. GEOLOGICAL SURVEY
ROSWELL, NEW MEXICO

Posted ID-1
& Comp. Book
SI
1-8-82

*(See Instructions and Spaces for Additional Data on Reverse Side)

INSTRUCTIONS

General: This form is designed for submitting a complete and correct well completion report and log on all types of lands and leases to either a Federal agency or a State agency, or both, pursuant to applicable Federal and/or State laws and regulations. Any necessary special instructions concerning the use of this form and the number of copies to be submitted, particularly with regard to local, area, or regional procedures and practices, either are shown below or will be issued by, or may be obtained from, the local Federal and/or State office. See Instructions on Items 22 and 24, and 33, below regarding separate reports for separate completions.

If not filed prior to the time this summary record is submitted, copies of all currently available logs (drillers, geologists, sample and core analysis, all types electric, etc.), formation and pressure tests, and directional surveys, should be attached hereto, to the extent required by applicable Federal and/or State laws and regulations. All attachments should be listed on this form, see Item 35.

Item 4: If there are no applicable State requirements, locations on Federal or Indian land should be described in accordance with Federal requirements. (Consult local State or Federal office for specific instructions.)

Item 18: Indicate which elevation is used as reference (where not otherwise shown) for depth measurements given in other spaces on this form and in any attachments.

Items 22 and 24: If this well is completed for separate production from more than one interval zone (multiple completion), so state in Item 22 and in Item 24 show the producing interval, or intervals, top(s), bottom(s) and name(s) (if any) for only the interval reported in Item 33. Submit a separate report (page) on this form, adequately identified, for each additional interval to be separately produced, showing the additional data pertinent to such interval.

Item 29: "Sacks Cement": Attached supplemental records for this well should show the details of any multiple stage cementing and the location of the cementing tool.

Item 33: Submit a separate completion report on this form for each interval to be separately produced. (See instruction for Items 22 and 24 above.)

37. SUMMARY OF POROUS ZONES:

SHOW ALL IMPORTANT ZONES OF POROSITY AND CONTENTS THEREOF: CORED INTERVALS; AND ALL PHILLISTEN TESTS, INCLUDING DEPTH INTERVAL TESTED, CUSHION USED, TIME TOOL OPEN, FLOWING AND SHUT-IN PRESSURE, AND RECOVERIES

FORMATION	TOP	BOTTOM	DESCRIPTION, CONTENTS, ETC.
			38. GEOLOGIC MARKERS
	NAME	NEAR DEPTH	TOP TRUE VERT. DEPTH
	Permian (Delaware)	2920	
	(Bone Springs)	6568	
	(Wolfcamp)	9860	
	Pennsylvanian (Strawn)	11636	
	(Atoka)	11720	
	(Morrow)	12286	
	Mississippian (Barnett sh)	13210	