

Subject to Appropriation
 District Office
 State Lease - 4 copies
 Fee Lease - 3 copies

State of New Mexico
 Energy, Minerals and Natural Resources Department

Form C-182
 Revised 1-1-89

OIL CONSERVATION DIVISION
 P.O. Box 2088
 Santa Fe, New Mexico 87504-2088

DISTRICT I
 P.O. Box 1980, Hobbs, NM 88240

DISTRICT II
 P.O. Drawer DD, Aramis, NM 88210

DISTRICT III
 1000 Rio Bonito Rd., Aztec, NM 87410

WELL LOCATION AND ACREAGE DEDICATION PLAT

All Distances must be from the outer boundaries of the section

Operator SANTA FE ENERGY OPERATING PARTNERS LP		Lease P.G. 4 Federal		Well No. 1
Unit Letter C	Section 9	Township 23 South	Range 31 East	County Eddy
Actual Footage Location of Well: 900 feet from the North line and 1980 feet from the West line				
Ground level Elev. 3346.4	Producing Formation Morrow	Foot West Sand Dunes (Morrow)	Dedicated Acreage: 320 Acres	

- Outline the acreage dedicated to the subject well by colored pencil or backbone marks on the plat below.
- If more than one lease is dedicated to the well, outline each and identify the ownership thereof (both as to working interest and royalty).
- If more than one lease of different ownership is dedicated to the well, have the interest of all owners here consolidated by communitization, unitization, force-pooling, etc?
 Yes No If answer is "yes" type of consolidation one lease- see below
 If answer is "no" list the owners and tract descriptions which have actually been consolidated. (Use reverse side of this form if necessary.)
 No allowable will be assigned to the well until all interests have been consolidated (by communitization, unitization, force-pooling, or otherwise) or until a non-standard unit, eliminating such interest, has been approved by the Division.

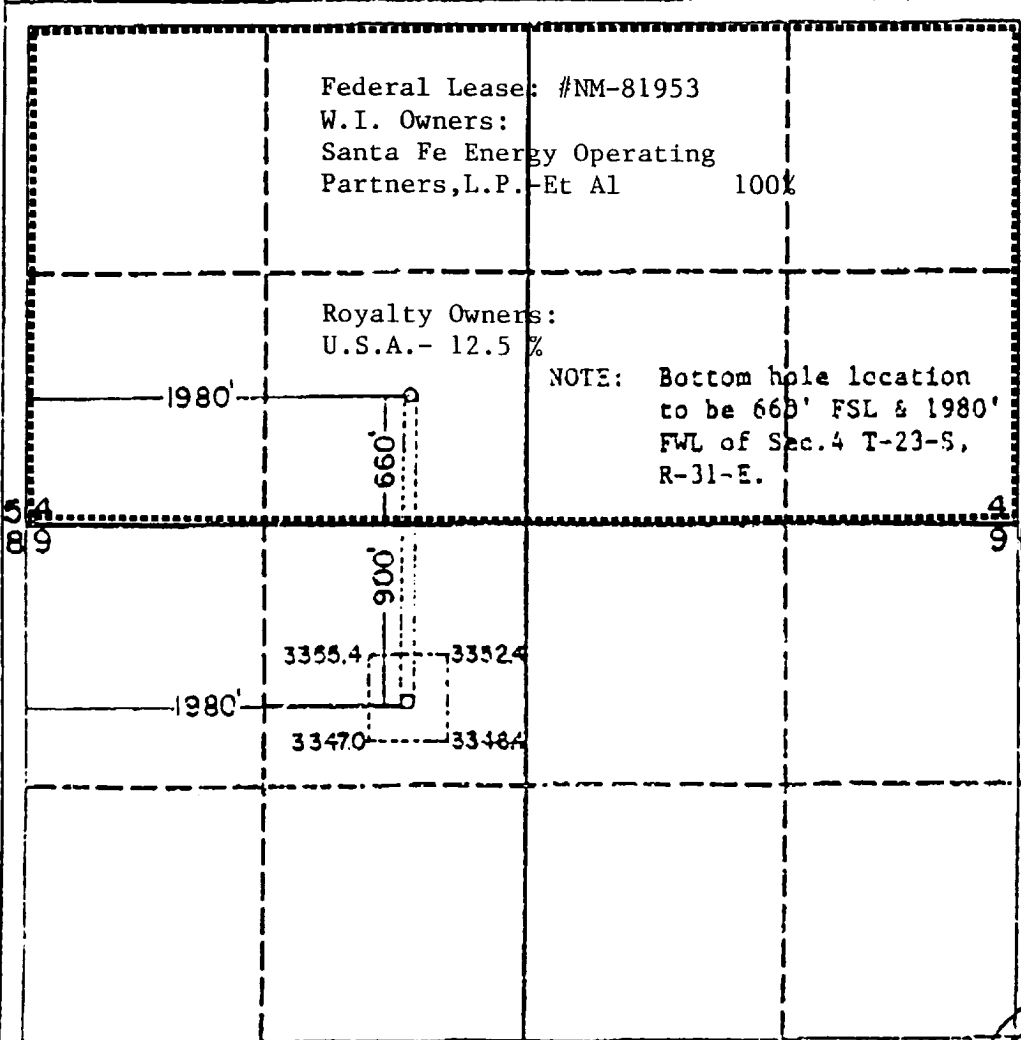

OPERATOR CERTIFICATION
 I hereby certify that the information contained herein is true and complete to the best of my knowledge and belief.

Signature
Darrell Roberts

Printed Name
 Darrell Roberts

Position
 Senior Drilling Engineer

Company
 Santa Fe Energy Operating Partners, L.P.

Date
 September 17, 1990

SURVEYOR CERTIFICATION
 I hereby certify that the well location shown on this plat was plotted from field notes of actual surveys made by me or under my supervision, and that the same is true and correct to the best of my knowledge and belief.

Date Surveyed
 September 9, 1990

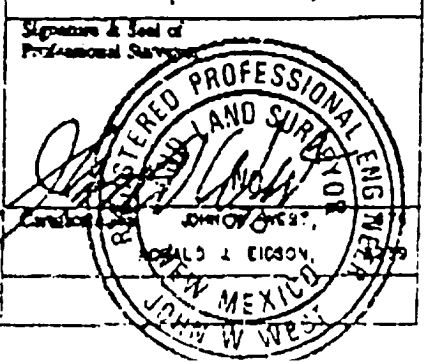

121830