

OIL CONSERVATION DIVISION

P.O. Box 2088

Santa Fe, New Mexico 87504-2088

DISTRICT I

P.O. Box 1980, Hobbs, NM 88240

DISTRICT II

P.O. Drawer DD, Artesia, NM 88210

DISTRICT III

1000 Rio Brazos Rd., Aztec, NM 87410

WELL LOCATION AND ACREAGE DEDICATION PLAT

All Distances must be from the outer boundaries of the section

Operator Enron Oil & Gas Company			Lease Rustler Bluff Federal		Well No. 1
Unit Letter M	Section 29	Township 24 South	Range 29 East	NMPM	County Eddy
Actual Footage Location of Well: 1195 feet from the South line and 935 feet from the West line					
Ground Level Elev. 2942.7	Producing Formation Delaware	Pool Und	Dedicated Acreage: 40 Acres		

1. Outline the acreage dedicated to the subject well by colored pencil or hachure marks on the plat below.
 2. If more than one lease is dedicated to the well, outline each and identify the ownership thereof (both as to working interest and royalty).
 3. If more than one lease of different ownership is dedicated to the well, have the interest of all owners been consolidated by communitization, unitization, force-pooling, etc.?
☐ Yes ☐ No If answer is "yes" type of consolidation _____
- If answer is "no" list of owners and tract descriptions which have actually been consolidated. (Use reverse side of this form necessary.) _____
- No allowable will be assigned to the well unit all interests have been consolidated (by communitization, unitization, forced-pooling, otherwise) or until a non-standard unit, eliminating such interest, has been approved by the Division.

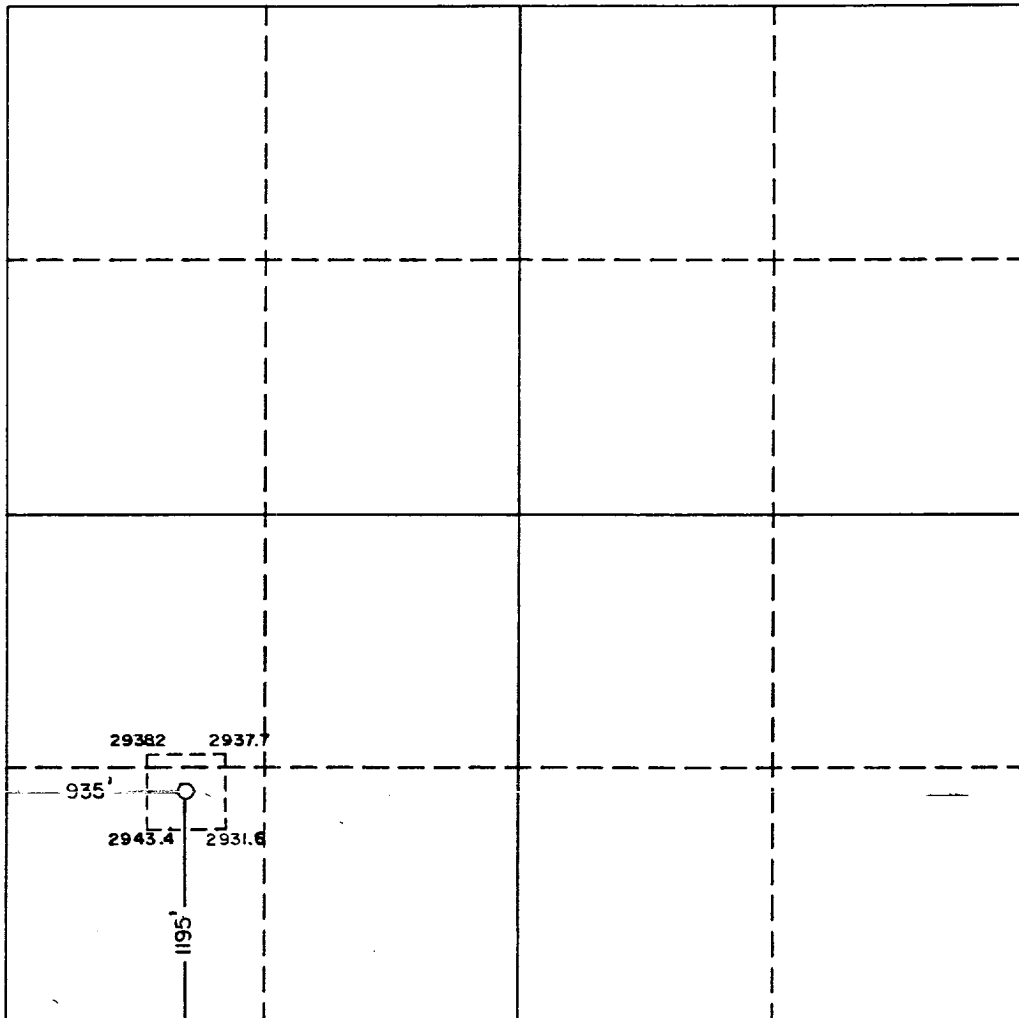

OPERATOR CERTIFICATION

I hereby certify the the information
contained herein is true and complete to the
best of my knowledge and belief.

Betty Gildon
Signature

Betty Gildon
Printed Name
Regulatory Analyst

Position
ENRON OIL & GAS COMPANY

Company
6/12/92

Date

SURVEYOR CERTIFICATION

I hereby certify that the well location shown
on this plat was plotted from field notes of
actual surveys made by me or under my
supervision, and that the same is true and
correct to the best of my knowledge and
belief.

Date Surveyed
June 2, 1992

Signature & Seal of
Professional Surveyor

Ronald J. Edson
Certificate No. JOHN W. WEST 876
RONALD J. EDSON 3238
MERRY L. JONES 7877

W-141692-110-0749