

District Office

## State of New Mexico

Revised 1-1-89

State Lease - 4 copies  
Fee Lease - 3 copies

Energy Minerals, and Natural Resources Department

DISTRICT IP. O. Box 1980  
Hobbs, NM 88240

## OIL CONSERVATION DIVISION

P. O. Box 2088  
Santa Fe, New Mexico 87504-2088DISTRICT IIP. O. Drawer DD  
Artesia, NM 88210DISTRICT III1000 Rio Brazos Rd  
Aztec, NM 87410

## WELL LOCATION AND ACREAGE DEDICATION PLAT

All distances must be from the outer boundaries of the section.

Operator <b>SANTA FE ENERGY OPER. PART. L.P.</b>			Lease <b>NORTH PURE GOLD '8' FEDERAL</b>		Well No. <b>3</b>
Unit Letter <b>H</b>	Section <b>8</b>	Township <b>23 SOUTH</b>	Range <b>31 EAST, N.M.P.M.</b>	County <b>EDDY</b>	
Actual Footage Location of Well					
1780 feet from the NORTH line and		660 feet from the EAST line			
Ground Level Elev. <b>3313'</b>	Producing Formation <b>Delaware</b>	Pool <b>Los Medanos (Delaware)</b>		40 Acres	

- Outline the acreage dedicated to the subject well by colored pencil or hatchure marks on the plat below.
- If more than one lease is dedicated to the well, outline each and identify the ownership thereof (both as to working interest and royalty).
- If more than one lease of different ownership is dedicated to the well, have the interest of all the owners been consolidated by communitization, unitization, forced-pooling, etc.?
 

☐ Yes
 ☐ No
 

If answer is "yes", type of consolidation \_\_\_\_\_

 If the answer is "no", list the owners and tract descriptions which have actually been consolidated. (Use the reverse side of this form if necessary.) \_\_\_\_\_  
 No allowable will be assigned to the well until all interests have been consolidated (by communitization, unitization, forced-pooling, or otherwise) or until a non-standard unit, eliminating such interest, has been approved by the division.

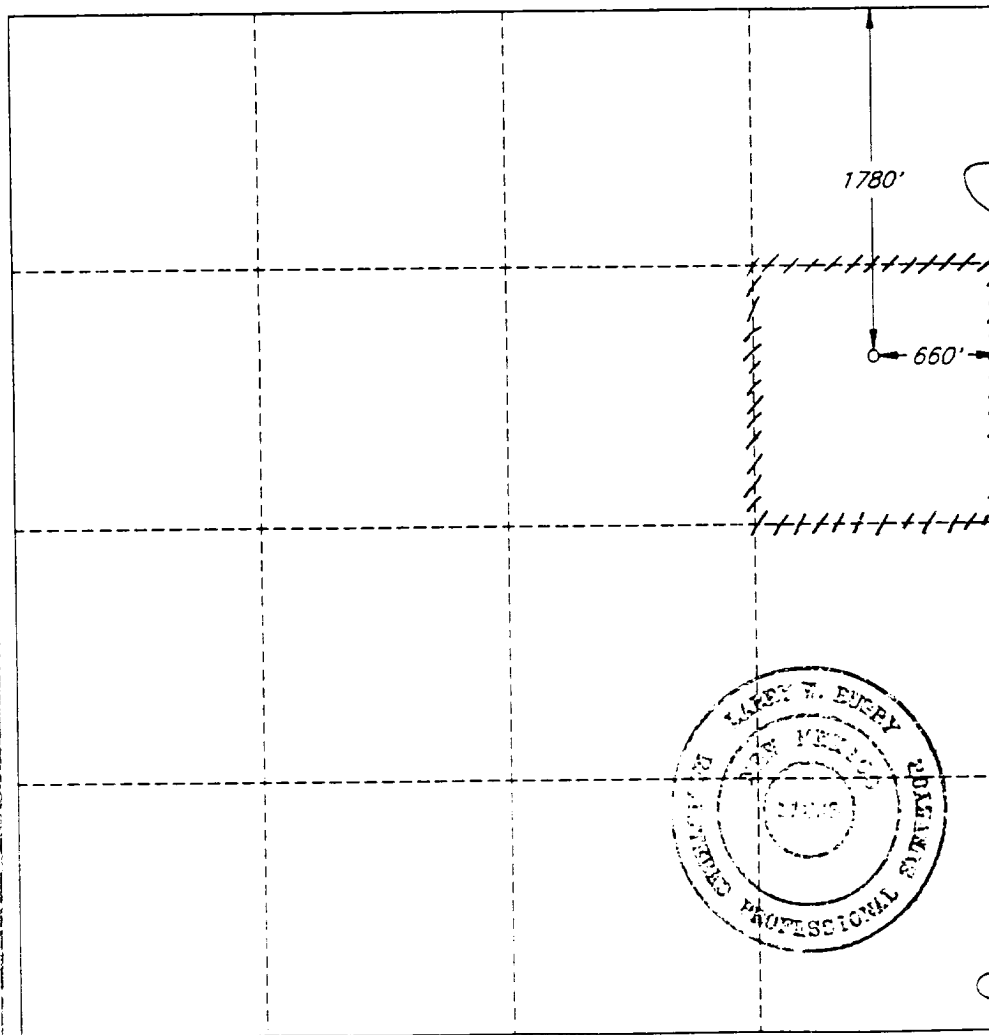

## OPERATOR CERTIFICATION

I hereby certify that the information herein is true and complete to the best of my knowledge and belief.

Signature

Printed Name

Terry McCullough

Position

Sr. Production Clerk

Company Santa Fe Energy

Operating Partners, L.P.

Date

July 1, 1993

## SURVEYOR CERTIFICATION

I hereby certify that the well location shown on this plat was plotted from field notes of actual surveys made by me or under my supervision, and that the same is true and correct to the best of my knowledge and belief.

Date Surveyed

JUNE 25, 1993

Signature and Seal of Professional Surveyor

Certificate No.

LARRY W. BUSBY R.P.S. #11398

JOB NO. 97088

V.H.B.