

(December 1990)

SUBMIT IN P ATE

(Other instructions on reverse side)

Form approved.

Budget Bureau No. 1004-0136

Expires: December 31, 1991

NEW OIL CONS. COM. APPLIED STATES
DRAWER DD DEPARTMENT OF THE INTERIOR
ARTESIA, NM 88210
BUREAU OF LAND MANAGEMENT

APPLICATION FOR PERMIT TO DRILL OR DEEPEN

1a. TYPE OF WORK

DRILL ☒DEEPEN ☐

b. TYPE OF WELL

OIL WELL ☒GAS WELL ☐OTHER ☐SINGLE ZONE ☒MULTIPLE ZONE ☐

2. NAME OF OPERATOR

Santa Fe Energy Operating Partners, L.P. ✓

20290

3. ADDRESS AND TELEPHONE NO.

550 W. Texas, Suite 1500, Midland, Texas 79701

RECEIVED

4. LOCATION OF WELL (Report location clearly and in accordance with any State requirements.)*

At surface

(C) 660 FNL, 1980' FWL, Sec 34, T-23-S, R-31-E

MAY 06 '94

At proposed prod. zone

14. DISTANCE IN MILES AND DIRECTION FROM NEAREST TOWN OR POST OFFICE*

21 miles east of Loving, New Mexico

ARTESIA, OFFICE

15. DISTANCE FROM PROPOSED*

LOCATION TO NEAREST

PROPERTY OR LEASE LINE, FT. 660'

(Also to nearest drlg. unit line, if any)

16. NO. OF ACRES IN LEASE

640

17. NO. OF ACRES ASSIGNED

TO THIS WELL

40

18. DISTANCE FROM PROPOSED LOCATION*

TO NEAREST WELL, DRILLING, COMPLETED,

OR APPLIED FOR, ON THIS LEASE, FT. 1320'

19. PROPOSED DEPTH

8200'

20. ROTARY OR CABLE TOOLS

Rotary

21. ELEVATIONS (Show whether DF, RT, GR, etc.)

3428 GR

22. APPROX. DATE WORK WILL START*

5-15-94

23.

PROPOSED CASING AND CEMENTING PROGRAM

R-111-P Potash

SIZE OF HOLE	GRADE, SIZE OF CASING	WEIGHT PER FOOT	SETTING DEPTH	QUANTITY OF CEMENT
17-1/2"	H-40 13-3/8"	48.0	600'	600 sx to circulate
12-1/4"	K-55 8-5/8"	32.0	4200'	2000 sx to circulate
7-7/8"	K-55 5-1/2"	15.50 & 17.0	8200'	Tie back to 4000'

We propose to drill to a depth sufficient to test the Delaware formation for oil. If productive 5-1/2" casing will be cemented at TD. If non-productive the well will be plugged in a manner consistent with Federal Regulations Specific programs as per Onshore Oil and Gas Order No. 1 are outlined in the following attachments.

Drilling Program

Exhibit A - Operations Plan

Exhibit B - BOP and Choke Diagram

Exhibit C - Drilling Fluid Program

Exhibit D - Auxiliary Equipment

Exhibit E - Topo Map of Location

Exhibit F - Map Showing Existing Wells

Exhibit F (A) Plat of Location

Exhibit G - Well Site Layout

Surface Use and Operations Plan

Post ID-1
 5-13-94
 New Line & API

IN ABOVE SPACE DESCRIBE PROPOSED PROGRAM: If proposal is to deepen, give data on present productive zone and proposed new productive zone. If proposal is to drill or deepen directionally, give pertinent data on subsurface locations and measured and true vertical depths. Give blowout preventer program, if any.

24.

SIGNED

Daniel Rohito

TITLE Division Drilling Engineer

DATE March 18, 1994

(This space for Federal or State office use)

PERMIT NO.

APPROVAL DATE

APPROVAL SUBJECT TO

GENERAL REQUIREMENTS AND

SPECIAL STIPULATIONS

ATTACHED

Application approval does not warrant or certify that the applicant holds legal or equitable title to those rights in the subject lease which would entitle the applicant to conduct operations thereon.

CONDITIONS OF APPROVAL, IF ANY:

Acting

APPROVED BY

Patricia S. McLean

TITLE

State Director

DATE

APR 26 1994

*See Instructions On Reverse Side

Title 18 U.S.C. Section 1001, makes it a crime for any person knowingly and willfully to make to any department or agency of the United States any false, fictitious or fraudulent statements or representations as to any matter within its jurisdiction.

DISTRICT I
P. O. Box 1980
Hobbs, NM 88240

DISTRICT II
P. O. Drawer DD
Artesia, NM 88210

DISTRICT III
1000 Rio Brazos Rd
Aztec, NM 87410

OIL CONSERVATION DIVISION
P. O. Box 2088
Santa Fe, New Mexico 87504-2088

WELL LOCATION AND ACREAGE DEDICATION PLAT
All distances must be from the outer boundaries of the section.

Operator SANTA FE ENERGY OPER. PART, L.P.			Lease STERLING SILVER '34' FED.		Well No. 3
Unit Letter C	Section 34	Township 23 SOUTH	Range 31 EAST, N.M.P.M.	County EDDY	
Actual Footage Location of Well 660 feet from the NORTH line and 1980 feet from the WEST line					
Ground Level Elev. 3428'	Producing Formation Delaware		Pool INGLE WELLS Sand Dunes, West (Delaware)		Acres 40

- Outline the acreage dedicated to the subject well by colored pencil or hatchure marks on the plat below.
- If more than one lease is dedicated to the well, outline each and identify the ownership thereof (both as to working interest and royalty).
- If more than one lease of different ownership is dedicated to the well, have the interest of all the owners been consolidated by communitization, unitization, forced-pooling, etc.?
☐ Yes ☐ No If answer is "yes", type of consolidation _____
If the answer is "no", list the owners and tract descriptions which have actually been consolidated. (Use the reverse side of this form if necessary.) _____
No allowable will be assigned to the well until all interests have been consolidated (by communitization, unitization, forced-pooling, or otherwise) or until a non-standard unit, eliminating such interest, has been approved by the division.

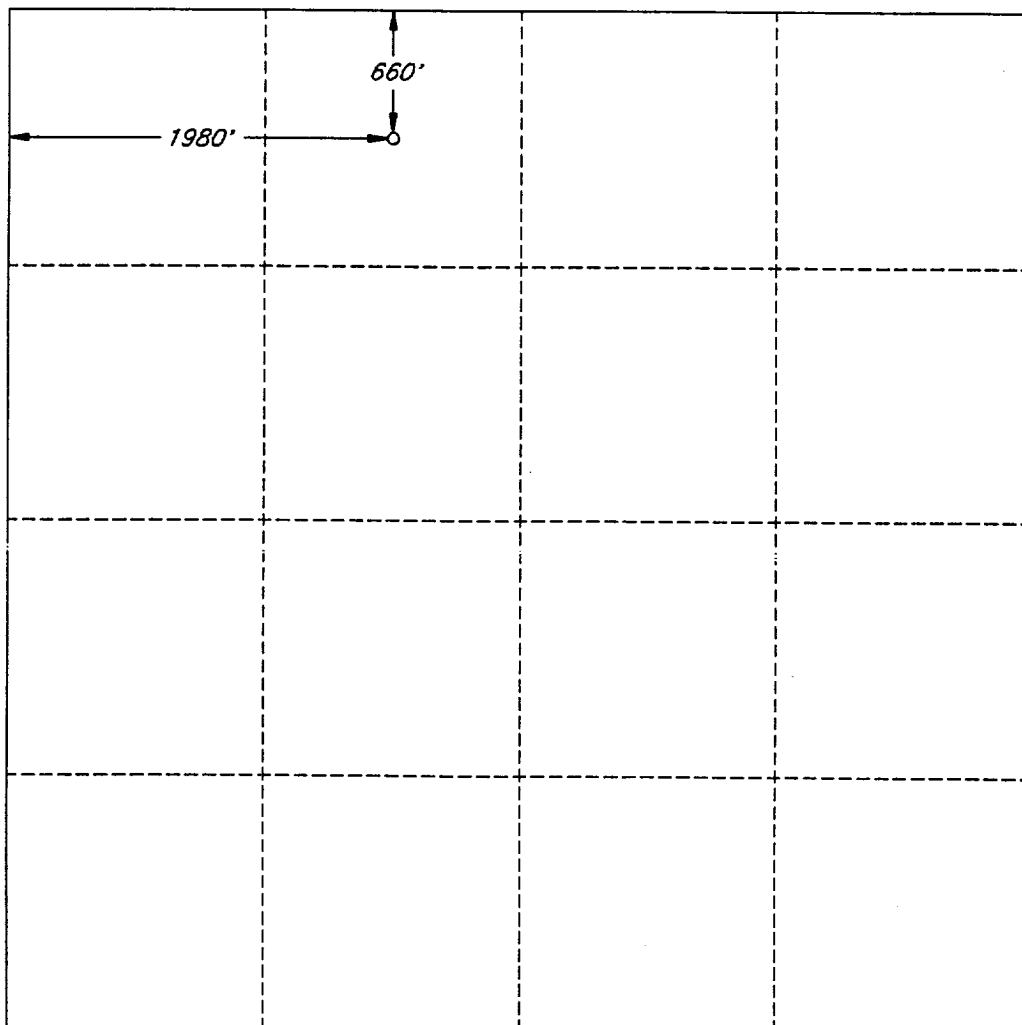

OPERATOR CERTIFICATION

I hereby certify that the information herein is true and complete to the best of my knowledge and belief.

Signature

Darrell Roberts

Printed Name

Darrell Roberts

Position

Division Drilling Engineer

Company Santa Fe Energy

Operating Partners, L.P.

Date

3-18-94

SURVEYOR CERTIFICATION

I hereby certify that the well location shown on this plat was plotted from field notes of actual surveys made by me or under my supervision, and that the same is true and correct to the best of my knowledge and belief.

Date Surveyed

Signature and Seal of Professional Surveyor

BEZNER
NO. 7920

V. L. BEZNER - R.P.S. #7920

cls / 31256 / 48SE

PROPOSED 3-M BOPE AND CHOKE ARRANGEMENT

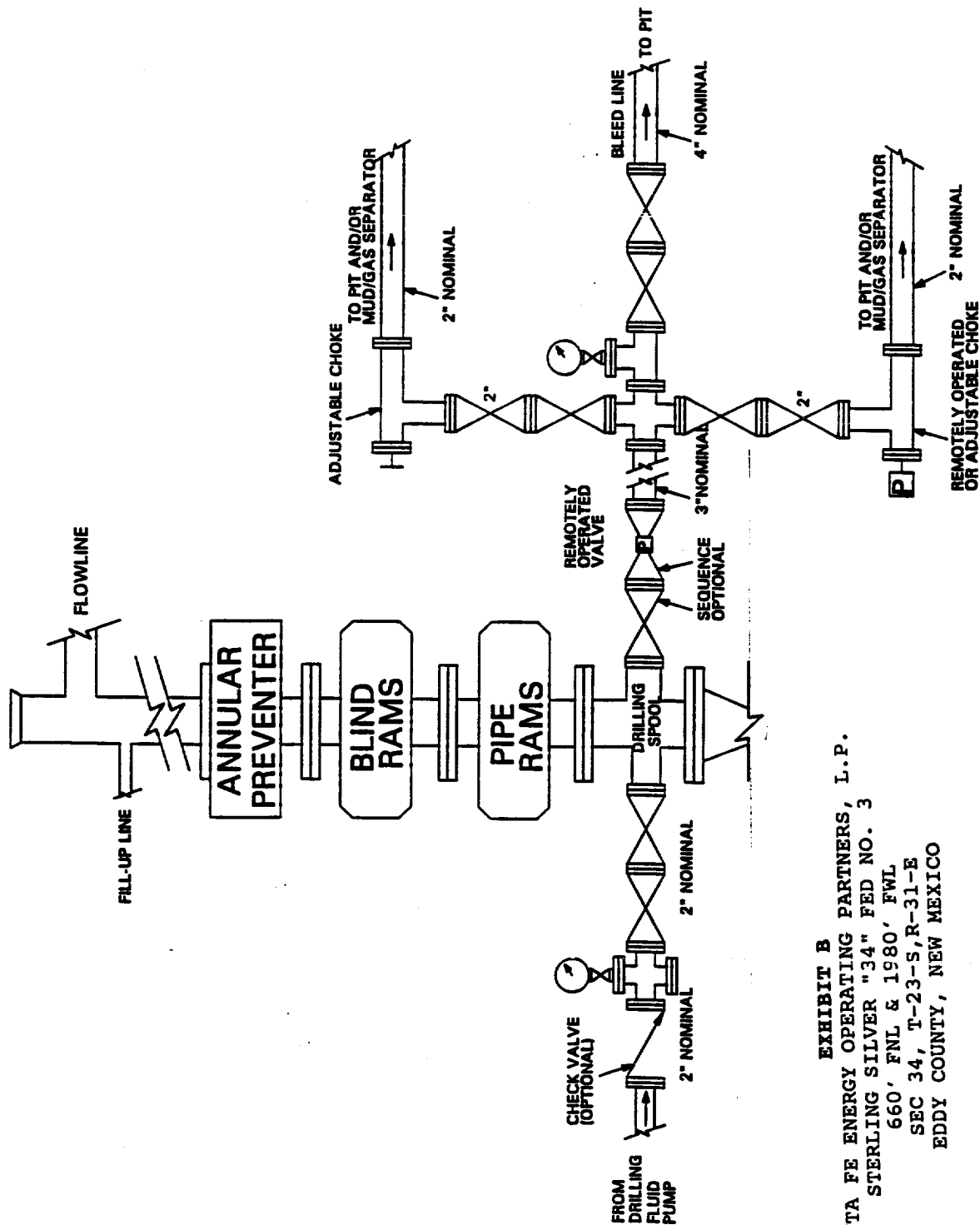

EXHIBIT B
 SANTA FE ENERGY OPERATING PARTNERS, L.P.
 STERLING SILVER "34" FED NO. 3
 660' FNL & 1980' FWL
 SEC 34, T-23-S, R-31-E
 EDDY COUNTY, NEW MEXICO