

NM OIL CONS. COMMISSION
DRAWER 3
ARTESIA, NEW MEXICO
UNIT 88210
UNITED STATES
DEPARTMENT OF THE INTERIOR
BUREAU OF LAND MANAGEMENT

SUBMIT IN 1 ☐ LIGATE*
(Other instructions on
reverse side)

30-015-28390
Form approved.
Budget Bureau No. 1004-0136
Expires August 31, 1985

APPLICATION FOR PERMIT TO DRILL, DEEPEN, OR PLUG BACK

1a. TYPE OF WORK

DRILL ☒

DEEPEN ☐

PLUG BACK ☐

b. TYPE OF WELL

OIL
WELL ☒

GAS
WELL ☐

OTHER

SINGLE
ZONE ☒

MULTIPLE
ZONE ☐

2. NAME OF OPERATOR

Pogo Producing Company

17891

3. ADDRESS OF OPERATOR

P.O.Box 10340, Midland, Texas 79702

4. LOCATION OF WELL (Report location clearly and in accordance with any State requirements.)

At surface

660' FNL & 330' FWL of Section 23, T-24S, R-29E

At proposed prod. zone

Unit (D)

Same

14. DISTANCE IN MILES AND DIRECTION FROM NEAREST TOWN OR POST OFFICE*

5 miles ESE of Malaga, New Mexico

15. DISTANCE FROM PROPOSED*

LOCATION TO NEAREST
PROPERTY OR LEASE LINE, FT.
(Also to nearest drlg. unit, if any)

330'

18. DISTANCE FROM PROPOSED LOCATION*
TO NEAREST WELL, DRILLING, COMPLETED,
OR APPLIED FOR, ON THIS LEASE, FT.

1320'

16. NO. OF ACRES IN LEASE

40

19. PROPOSED DEPTH

8100'

17. NO. OF ACRES ASSIGNED
TO THIS WELL

40

20. ROTARY OR CABLE TOOLS

Rotary

21. ELEVATIONS (Show whether DF, RT, GR, etc.)

2945' Ground Level

Carlsbad Controlled Water Basin

22. APPROX. DATE WORK WILL START*

Upon approval of App.

23.

PROPOSED CASING AND CEMENTING PROGRAM

SIZE OF HOLE	SIZE OF CASING	WEIGHT PER FOOT	SETTING DEPTH	QUANTITY OF CEMENT
17 1/2"	13 3/8"	54.5#	450'	Sufficient to Circulate
11"	8 5/8"	32 - 24#	3050'	Sufficient to Circulate
7 7/8"	5 1/2"	17 - 15.5#	8100'	1200 SX

AFTER SETTING PRODUCTION CASING, PAY ZONE WILL BE PERFORATED
STIMULATED AS NECESSARY.

SEE ATTACHED FOR: SUPPLEMENTAL DRILLING DATA
BOP SKETCH
SURFACE USE AND OPERATIONS PLAN

RECEIVED

MAR 16 1995

OIL CON. DIV.

Approved Subject to
General Requirements and
Special Stipulations
Attached

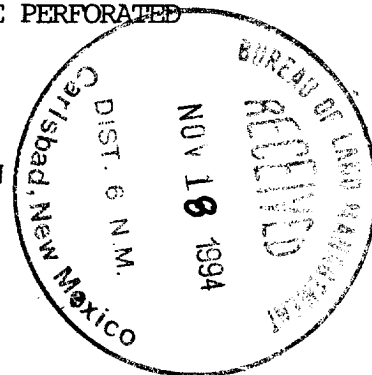

IN ABOVE SPACE DESCRIBE PROPOSED PROGRAM: If proposal is to deepen or plug back, give data on present productive zone and proposed new productive zone. If proposal is to drill or deepen directionally, give pertinent data on surface locations and measured and true vertical depths. Give blowout preventer program, if any.

24.

SIGNED

John H. C. Kelly

TITLE

Agent

DATE

November 17, 1994

(This space for Federal or State office use)

PERMIT NO.

APPROVAL DATE

APPROVED BY (ORIG. SCD) RICHARD L. MANUS

TITLE

AREA MANAGER

DATE

3-14-95

CONDITIONS OF APPROVAL, IF ANY:

*See Instructions On Reverse Side

DISTRICT I
P.O. Box 1980, Hobbs, NM 88240

State of New Mexico
Energy, Minerals and Natural Resources Department

Form C-102
Revised February 10, 1994
Instruction on back
Submit to Appropriate District Office
State Lease - 4 Copies
Fee Lease - 3 Copies

DISTRICT II
P.O. Drawer DD, Artesia, NM 88210

DISTRICT III
1000 Rio Brazos Rd., Aztec, NM 87410

OIL CONSERVATION DIVISION

P.O. Box 2088
Santa Fe, New Mexico 87504-2088

☐ AMENDED REPORT

WELL LOCATION AND ACREAGE DEDICATION PLAT

API Number 30-015-28390	Pool Code 96036	Pool Name Wildcat; Grp. 5
Property Code 15019	Property Name RIVER BEND FED. #8	Well Number 8
OGRID No. 017891	Operator Name POGO PRODUCING CO.	Elevation 2944'

Surface Location

UL or lot No.	Section	Township	Range	Lot Idn	Feet from the	North/South line	Feet from the	East/West line	County
D	23	24S	29E		460	NORTH	330	WEST	EDDY

Bottom Hole Location If Different From Surface

UL or lot No.	Section	Township	Range	Lot Idn	Feet from the	North/South line	Feet from the	East/West line	County

Dedicated Acres	Joint or Infill	Consolidation Code	Order No.

NO ALLOWABLE WILL BE ASSIGNED TO THIS COMPLETION UNTIL ALL INTERESTS HAVE BEEN CONSOLIDATED
OR A NON-STANDARD UNIT HAS BEEN APPROVED BY THE DIVISION

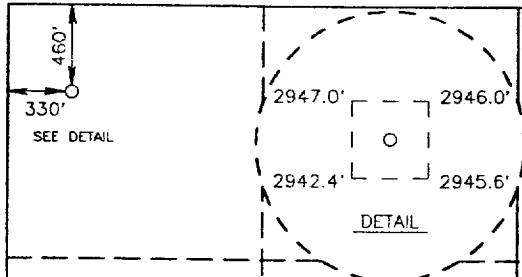
	<p>OPERATOR CERTIFICATION</p> <p>I hereby certify the the information contained herein is true and complete to the best of my knowledge and belief.</p> <p><i>James M. C. Ritchie, Jr.</i> Signature JAMES M. C. Ritchie, Jr. Printed Name Agent Title 2/20/95 Date</p>
	<p>SURVEYOR CERTIFICATION</p> <p>I hereby certify that the well location shown on this plat was plotted from field notes of actual surveys made by me or under my supervision, and that the same is true and correct to the best of my belief.</p> <p>FEBRUARY 10, 1995 Date Surveyed Signature & Seal of Professional Surveyor <i>John W. West</i> W.O. Num. 95-11-0190 Certificate No. ME 676 RONALD E. JOHNSON 3239</p>

Form 3160-5
 (June 1990)

UNITED STATES
 DEPARTMENT OF THE INTERIOR
 BUREAU OF LAND MANAGEMENT

FORM APPROVED
 Budget Bureau No. 1004-0135
 Expires: March 31, 1993

SUNDRY NOTICES AND REPORTS ON WELLS

Do not use this form for proposals to drill or to deepen or reentry to a different reservoir.
 Use "APPLICATION FOR PERMIT—" for such proposals

SUBMIT IN TRIPLICATE

1. Type of Well <input checked="" type="checkbox"/> Oil Well <input type="checkbox"/> Gas Well <input type="checkbox"/> Other	5. Lease Designation and Serial No. NM-81586
2. Name of Operator Pogo Producing Company	6. If Indian, Allottee or Tribe Name
3. Address and Telephone No. P.O. Box 10340, Midland, Texas 79702, 915-682-6822	7. If Unit or CA, Agreement Designation
4. Location of Well (Footage, Sec., T., R., M., or Survey Description) 660' FNL & 330' FWL of Section 23, T-24S, R-29E	8. Well Name and No. River Bend Federal # 8
	9. API Well No.
	10. Field and Pool, or Exploratory Area Wildcat (Bone Springs)
	11. County or Parish, State Eddy County, N.M.

12. CHECK APPROPRIATE BOX(s) TO INDICATE NATURE OF NOTICE, REPORT, OR OTHER DATA

TYPE OF SUBMISSION	TYPE OF ACTION
<input checked="" type="checkbox"/> Notice of Intent	<input type="checkbox"/> Abandonment
<input type="checkbox"/> Subsequent Report	<input type="checkbox"/> Recompletion
<input type="checkbox"/> Final Abandonment Notice	<input type="checkbox"/> Plugging Back
	<input type="checkbox"/> Casing Repair
	<input type="checkbox"/> Altering Casing
	<input checked="" type="checkbox"/> Other Change Location
	<input type="checkbox"/> Change of Plans
	<input type="checkbox"/> New Construction
	<input type="checkbox"/> Non-Routine Fracturing
	<input type="checkbox"/> Water Shut-Off
	<input type="checkbox"/> Conversion to Injection
	<input type="checkbox"/> Dispose Water

(Note: Report results of multiple completion on Well Completion or Recompletion Report and Log form.)

13. Describe Proposed or Completed Operations (Clearly state all pertinent details, and give pertinent dates, including estimated date of starting any proposed work. If well is directionally drilled, give subsurface locations and measured and true vertical depths for all markers and zones pertinent to this work.)*

Pogo Producing Company proposes to change surface location on the above captioned well to the following:

River Bend Federal # 8
 460' FNL & 330' FWL of Section 23, T-24S, R-29E
 Eddy County, New Mexico

This location has already been surveyed and staked.

14. I hereby certify that the foregoing is true and correct

Signed *James L. C. Riedel Jr.* Title Agent Date 2/6/95

(This space for Federal or State office use)

Approved by (ORIG. SGD.) RICHARD L. MANUS. AREA MANAGER Date 3-14-95
 Conditions of approval, if any:

DISTRICT I
P.O. Box 1980, Hobbs, NM 88240

DISTRICT II
P.O. Drawer DD, Artesia, NM 88210

DISTRICT III
1000 Rio Brazos Rd., Aztec, NM 87410

State of New Mexico
Energy, Minerals and Natural Resources Department

Form C-102
Revised February 10, 1994
Instruction on back
Submit to Appropriate District Office
State Lease - 4 Copies
Fee Lease - 3 Copies

OIL CONSERVATION DIVISION

P.O. Box 2088
Santa Fe, New Mexico 87504-2088

☐ AMENDED REPORT

WELL LOCATION AND ACREAGE DEDICATION PLAT

API Number	Pool Code 96036	Pool Name WILCOAT (Belle Springs)
Property Code 15019	Property Name RIVER BEND FEDERAL	Well Number 8
OGRID No. 017891	Operator Name POGO PRODUCING CO.	Elevation 2945'

Surface Location

UL or lot No. D	Section 23	Township 24S	Range 29E	Lot Idn	Feet from the 660'	North/South line NORTH	Feet from the 330'	East/West line WEST	County EDDY
--------------------	---------------	-----------------	--------------	---------	-----------------------	---------------------------	-----------------------	------------------------	----------------

¹¹ Bottom Hole Location If Different From Surface

UL or lot No.	Section	Township	Range	Lot Idn	Feet from the	North/South line	Feet from the	East/West line	County
Dedicated Acres 40	Joint or Infill	Consolidation Code	Order No.						

NO ALLOWABLE WILL BE ASSIGNED TO THIS COMPLETION UNTIL ALL INTERESTS HAVE BEEN CONSOLIDATED
OR A NON-STANDARD UNIT HAS BEEN APPROVED BY THE DIVISION

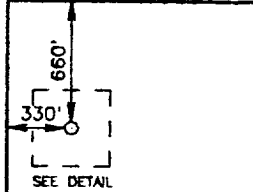
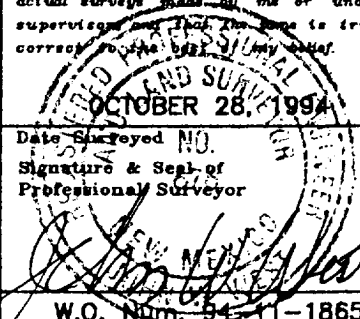
	2943.1'	2935.5'		
	2938.7'	2937.5'		
<u>DETAIL</u>				
OPERATOR CERTIFICATION				
I hereby certify the the information contained herein is true and complete to the best of my knowledge and belief.				
Signature James M. C. Ritchie Jr.				
Printed Name James M. C. Ritchie Jr.				
Title Agent				
Date November 17, 1994				
SURVEYOR CERTIFICATION				
I hereby certify that the well location shown on this plat was plotted from field notes of actual surveys made by me or under my supervision and that the same is true and correct to the best of my belief.				
Date Surveyed NO. OCTOBER 28, 1994				
Signature & Seal of Professional Surveyor 				
W.O. Num. 54-11-1865				
Certificate No. JOHN W. WEST, 676 RONALD J. EIDSON, 3239				

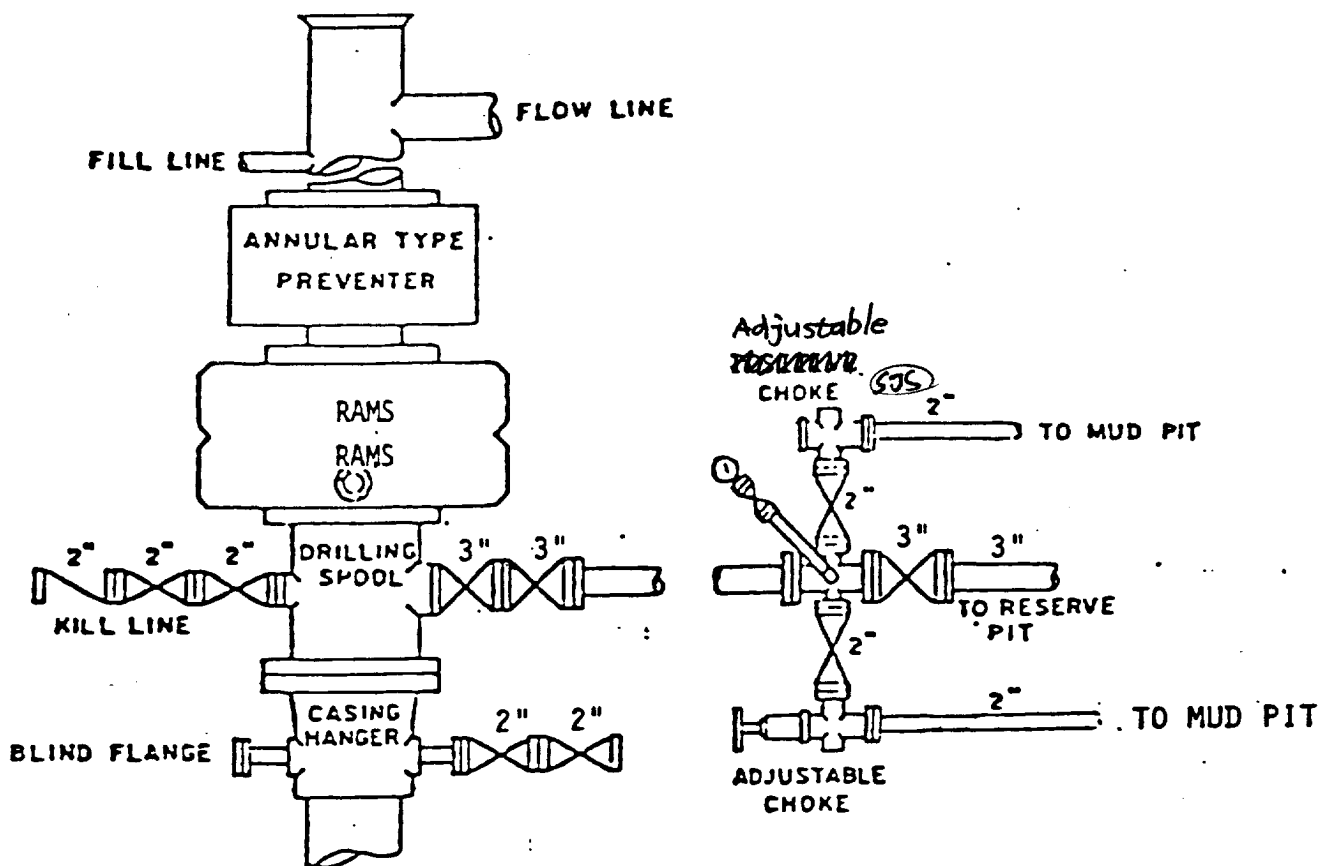

BOP STACK

3000 PSI WORKING PRESSURE

BOP ARRANGEMENT