

District I  
1625 N. French Dr., Hobbs, NM 88240  
District II  
1301 W. Grand Avenue, Artesia, NM 88210  
District III  
1000 Rio Brazos Road, Aztec, NM 87410  
District IV  
1220 S. St. Francis Dr., Santa Fe, NM 87505

State of New Mexico  
Energy Minerals and Natural Resources

Oil Conservation Division  
1220 South St. Francis Dr.  
Santa Fe, NM 87505

Form C-101  
Revised March 17, 1999

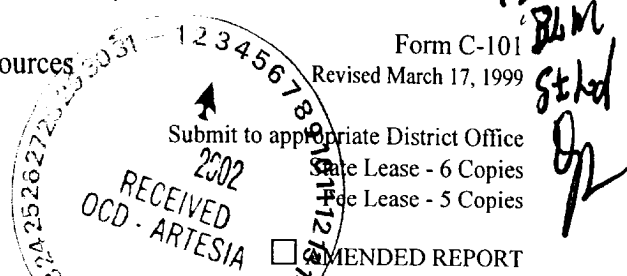

**APPLICATION FOR PERMIT TO DRILL, RE-ENTER, DEEPEN, PLUG BACK, OR ADD A ZONE**

<sup>1</sup> Operator Name and Address Samson Resources Company, Attn: Brad P. Hargrove Two West Second Street, Tulsa, OK 74103-3103		<sup>2</sup> Well ID Number 20165
		<sup>3</sup> API Number 30-015-32446
<sup>3</sup> Property Code 9912	<sup>5</sup> Property Name Loving 1 State	<sup>6</sup> Well No. 3

<sup>7</sup> Surface Location

UL or lot no.	Section	Township	Range	Lot Idn	Feet from the	North/South line	Feet from the	East/West line	County
E	1	24 South	27 East		1980'	North	660'	West	Eddy

<sup>8</sup> Proposed Bottom Hole Location If Different From Surface

UL or lot no.	Section	Township	Range	Lot Idn	Feet from the	North/South line	Feet from the	East/West line	County
<sup>9</sup> Proposed Pool 1 Black River Morrow					<sup>10</sup> Proposed Pool 2				

<sup>11</sup> Work Type Code N	<sup>12</sup> Well Type Code G	<sup>13</sup> Cable/Rotary R	<sup>14</sup> Lease Type Code S	<sup>15</sup> Ground Level Elevation 3139'
<sup>16</sup> Multiple N	<sup>17</sup> Proposed Depth 12,900'	<sup>18</sup> Formation Morrow	<sup>19</sup> Contractor Unknown	<sup>20</sup> Spud Date 9/15/02

<sup>21</sup> Proposed Casing and Cement Program

Hole Size	Casing Size	Casing weight/foot	Setting Depth	Sacks of Cement	Estimated TOC
17 1/2"	13 3/8"	48#	550'	383 cu.ft.	Surface
12 1/4"	9 5/8"	36#	2400'	788 cu.ft.	Surface
8 3/4"	7"	26#	10550'	234 cu.ft.	9000'
6 1/8"	4 1/2"	13.5#	12900'	327 cu.ft.	9550'

<sup>22</sup> Describe the proposed program. If this application is to DEEPEN or PLUG BACK, give the data on the present productive zone and proposed new productive zone. Describe the blowout prevention program, if any. Use additional sheets if necessary.

13 5/8" 5000 PSI Double RAM BOP

Move in drilling rig. Spud well and drill 17 1/2" hole to 550'. Run & cement 13 3/8" surface casing. NU & Test BOP equipment. Drill 12 1/4" hole to 2400'. Run & cement 9 5/8" intermediate casing. Drill 8 3/4" hole to 10,550'. Run & cement 7" casing. Drill 6 1/8" hole to 12,900' TD. Run open hole logs and evaluate. Run & cement 4 1/2" production casing. Release drilling rig. Clean location. Prepare to complete well.

<sup>23</sup> I hereby certify that the information given above is true and complete to the best of my knowledge and belief.		OIL CONSERVATION DIVISION	
Signature: <i>Billy Goodwin</i>		Approved by: <b>ORIGINAL SIGNED BY TIM W. GUM</b> <b>DISTRICT II SUPERVISOR</b>	
Printed name: Billy Goodwin		Title:	
Title: Senior Drilling Engineer		Approval Date: <b>SEP 16 2002</b>	Expiration Date: <b>SEP 16 2003</b>
Date: <i>B-30-02</i>	Phone: (918) 591-1822	Conditions of Approval: Attached <input type="checkbox"/>	

DISTRICT I  
1625 N. French Dr., Hobbs, NM 88240

DISTRICT II  
1301 W. Grand Avenue, Artesia, NM 88210

DISTRICT III  
1000 Rio Brazos Rd., Aztec, NM 87410

DISTRICT IV  
1220 S. St. Francis Dr., Santa Fe, NM 87505

State of New Mexico  
Energy, Minerals, and Natural Resources Department

OIL CONSERVATION DIVISION

1220 South St. Francis Dr.  
Santa Fe, New Mexico 87505

Form C-102  
Revised August 15, 2000  
Submit to Appropriate District Office  
State Lease - 4 copies  
Fee Lease - 3 copies

AMENDED REPORT

WELL LOCATION AND ACREAGE DEDICATION PLAT

<sup>1</sup> API Number		<sup>2</sup> Pool Code		<sup>3</sup> Pool Name <b>BLACK RIVER</b>	
<sup>4</sup> Property Code		<sup>5</sup> Property Name <b>LOVING 1 STATE</b>			<sup>6</sup> Well Number <b>3</b>
<sup>7</sup> OGRID No. <b>20165</b>		<sup>8</sup> Operator Name <b>SAMSON RESOURCES COMPANY</b>			<sup>9</sup> Elevation <b>3139'</b>

<sup>10</sup> Surface Location

UL or lot no.	Section	Township	Range	Lot Idn	Feet from the	North/South line	Feet from the	East/West line	County
E	1	24 SOUTH	27 EAST, N.M.P.M.		1980'	NORTH	660'	WEST	EDDY

<sup>11</sup> Bottom Hole Location If Different From Surface

UL or lot no.	Section	Township	Range	Lot Idn	Feet from the	North/South line	Feet from the	East/West line	County
<sup>12</sup> Dedicated Acres <b>32c</b>		<sup>13</sup> Joint or Infill		<sup>14</sup> Consolidation Code		<sup>15</sup> Order No.			

NO ALLOWABLE WELL BE ASSIGNED TO THIS COMPLETION UNTIL ALL INTERESTS HAVE BEEN CONSOLIDATED OR A NON-STANDARD UNIT HAS BEEN APPROVED BY THE DIVISION

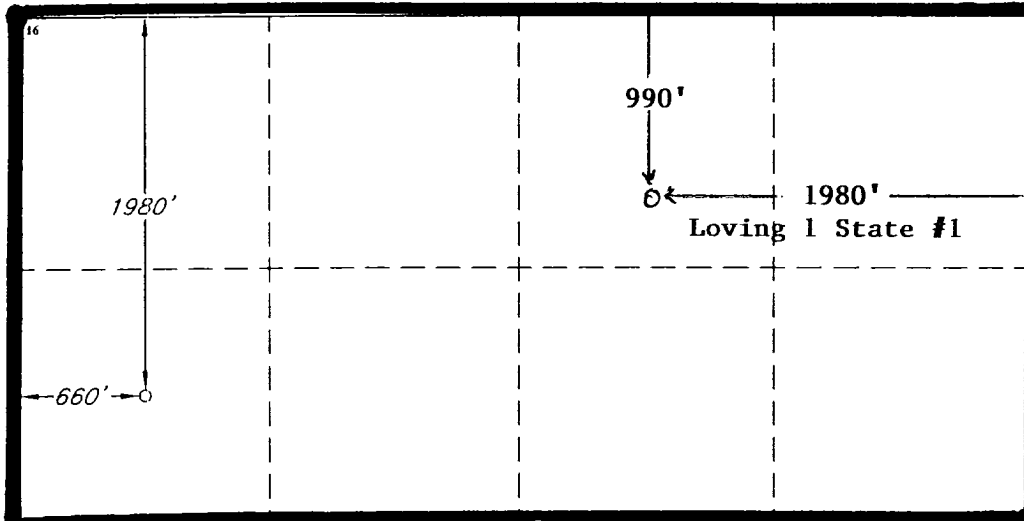

<sup>17</sup> OPERATOR CERTIFICATION

I hereby certify that the information contained herein is true and complete to the best of my knowledge and belief.

*Brad P. Hargrove*  
Signature

**Brad P. Hargrove**

Printed Name  
**Landman**

Title  
**September 12, 2002**

Date

<sup>18</sup> SURVEYOR CERTIFICATION

I hereby certify that the well location shown on this plat was plotted from field notes of actual surveys made by me or under my supervision, and that the same is true and correct to the best of my belief.

**AUGUST 20, 2002**  
Date of Survey

Signature and Seal of Professional Surveyor



Certificate Number  
**V. L. BEZNER R.P.S. #7920**

JOB # 83264 / 24NW / J.C.P.

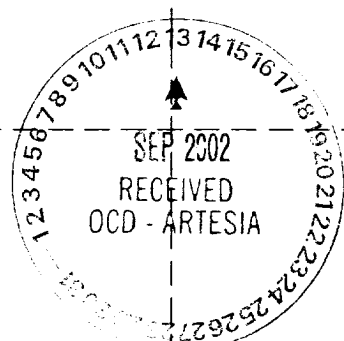

N/O = NORMALLY OPEN  
N/C = NORMALLY CLOSE

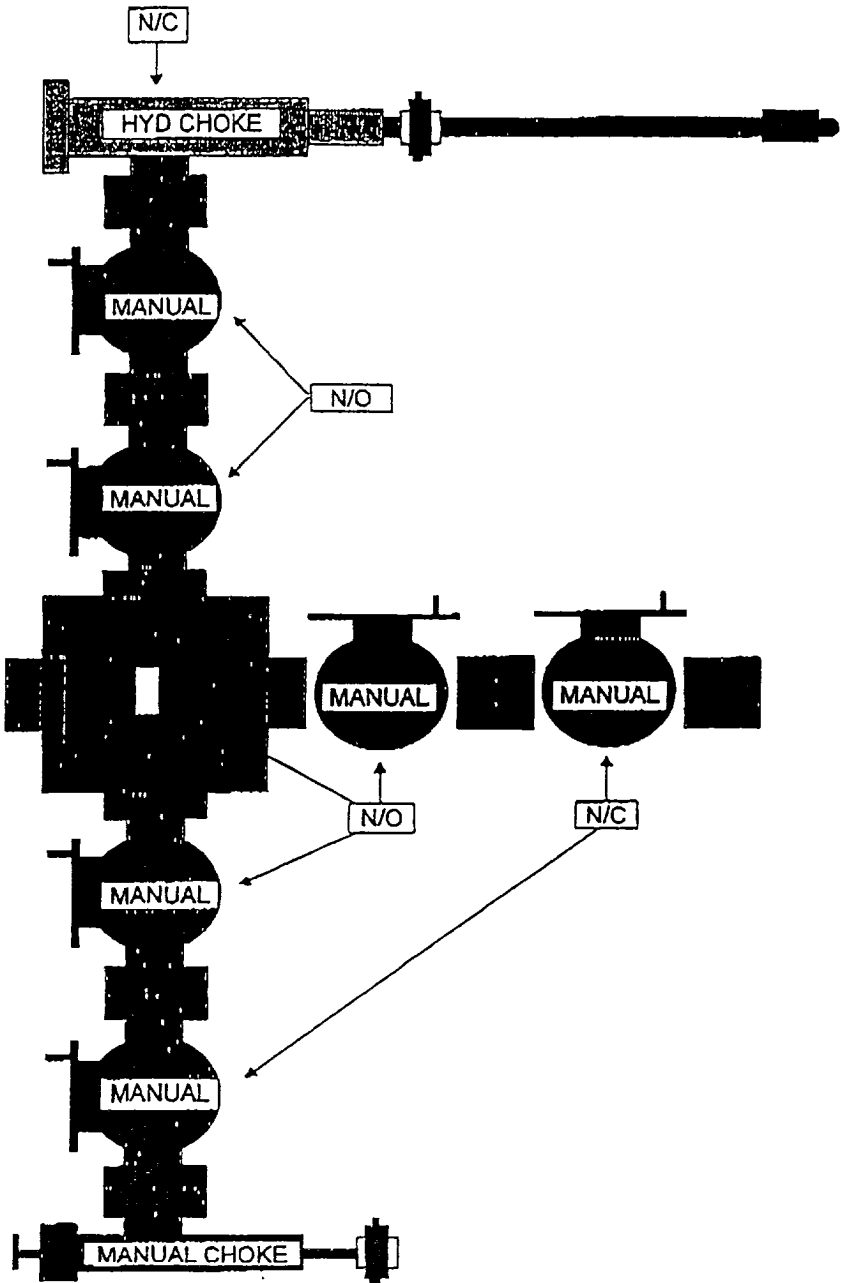

ROTARY TABLE

ROTARY  
BEAM

ROTARY  
BEAM

ROTATING  
HEAD

HYDRILL  
13 5/8" 5M

13 5/8" 5M

13 5/8" 5M  
BLIND RAMS

13 5/8" 5M  
PIPE RAMS

13 5/8" 5M

MUD  
CROSS

13 5/8" 5M

CHECK

MANUAL

MANUAL

HCR

MANUAL