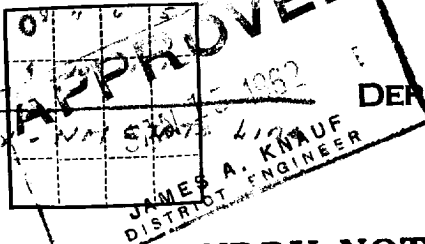

Form 9-331a  
(Feb. 1961)

(SUBMIT IN TRIPLICATE)

 UNITED STATES  
DEPARTMENT OF THE INTERIOR  
GEOLOGICAL SURVEY

 Land Office **New Mexico**  
 Lease No. **070791 - A**  
 Unit **RECEIVED**

JAN 17 1962

O. C. G.  
ARTESIA, OFFICE

# SUNDRY NOTICES AND REPORTS ON WELLS

NOTICE OF INTENTION TO DRILL	<input checked="" type="checkbox"/>	SUBSEQUENT REPORT OF WATER SHUT-OFF	
NOTICE OF INTENTION TO CHANGE PLANS		SUBSEQUENT REPORT OF SHOOTING OR ACIDIZING	
NOTICE OF INTENTION TO TEST WATER SHUT-OFF		SUBSEQUENT REPORT OF ALTERING CASING	
NOTICE OF INTENTION TO RE-DRILL OR REPAIR WELL		SUBSEQUENT REPORT OF RE-DRILLING OR REPAIR	
NOTICE OF INTENTION TO SHOOT OR ACIDIZE		SUBSEQUENT REPORT OF ABANDONMENT	
NOTICE OF INTENTION TO PULL OR ALTER CASING		SUPPLEMENTARY WELL HISTORY	
NOTICE OF INTENTION TO ABANDON WELL			

(INDICATE ABOVE BY CHECK MARK NATURE OF REPORT, NOTICE, OR OTHER DATA)

January 8, 1962

 Well No. **1** is located **842.16** ft. from **[N]** line and **330** ft. from **[W]** line of sec. **35**

 (Sec. and Sec. No.)  
**Sec. 35**

 (Twp.)  
**26S**

 (Range)  
**29E**

 (Meridian)  
**104W**

RECEIVED

 (Field)  
**without Record**

 (County or Subdivision)  
**Eddy County**

 (State or Territory)  
**New Mexico**

JAN 11 1962

 The elevation of the ~~derick~~ **ground elev.** above sea level is **2691.5** ft.
O. C. G.  
ARTESIA, OFFICE

## DETAILS OF WORK

(State names of and expected depths to objective sands; show sizes, weights, and lengths of proposed casings; indicate mudding jobs, cementing points, and all other important proposed work)

Anticipated start date: February 15, 1962. Drill cable tool hole into top of Delaware Sand. Run 550' 10-3/4" casing. Cement with sufficient amount of slurry to circulate to the surface. Run 1/2" casing to top of Delaware Sand, cement with 100 sacks cement which will fill approximately 1000' of annulus. Make open-hole completion.

 Estimated tops: Delaware line - 2681  
 Delaware sand - 2906

RECEIVED

JAN 12 1962

U. S. GEOLOGICAL SURVEY  
ARTESIA, NEW MEXICO

I understand that this plan of work must receive approval in writing by the Geological Survey before any action is taken.

Company **Curtis Hankamer**Address **1422 Bank of the Southwest Bldg.****Houston 2, Texas**By **Curtis Hankamer**  
Title **Operator**

**NEW MEXICO OIL CONSERVATION COMMISSION**  
**WELL LOCATION AND ACREAGE DEDICATION PLAT**

FORM C-128  
 Revised 5/1/57

**SEE INSTRUCTIONS FOR COMPLETING THIS FORM ON THE REVERSE SIDE**

**SECTION A**

Operator <b>Curtis Hankamer</b>		Lease <b>Pipkin "A"</b>		Well No. <b>1</b>
Unit Letter <b>D</b>	Section <b>35</b>	Township <b>26 South</b>	Range <b>29 East</b>	County <b>Eddy</b>
Actual Footage Location of Well: <b>842.16</b> feet from the <b>North</b> line and <b>330</b> feet from the <b>West</b> line				
Ground Level Elev. <b>2891.5</b>	Producing Formation <b>Delaware</b>	Pool <b>Pecos Del and Wichita</b>	Dedicated Acreage: <b>40</b> Acres	

1. Is the Operator the only owner in the dedicated acreage outlined on the plat below? YES ☒ NO ☐ ("Owner" means the person who has the right to drill into and to produce from any pool and to appropriate the production either for himself or for himself and another. (65-3-29 (e) NMSA 1955 (comp.)
2. If the answer to question one is "no," have the interests of all the owners been consolidated by communitization agreement or otherwise? YES ☐ NO ☐ If answer is "yes," Type of Consolidation \_\_\_\_\_
3. If the answer to question two is "no," list all the owners and their respective interests below:

**RECEIVED**

Owner	Land Description	<b>JAN 12 1962</b>
		<b>U. S. GEOLOGICAL SURVEY</b>
		<b>ARTESIA, NEW MEXICO</b>

**SECTION B**

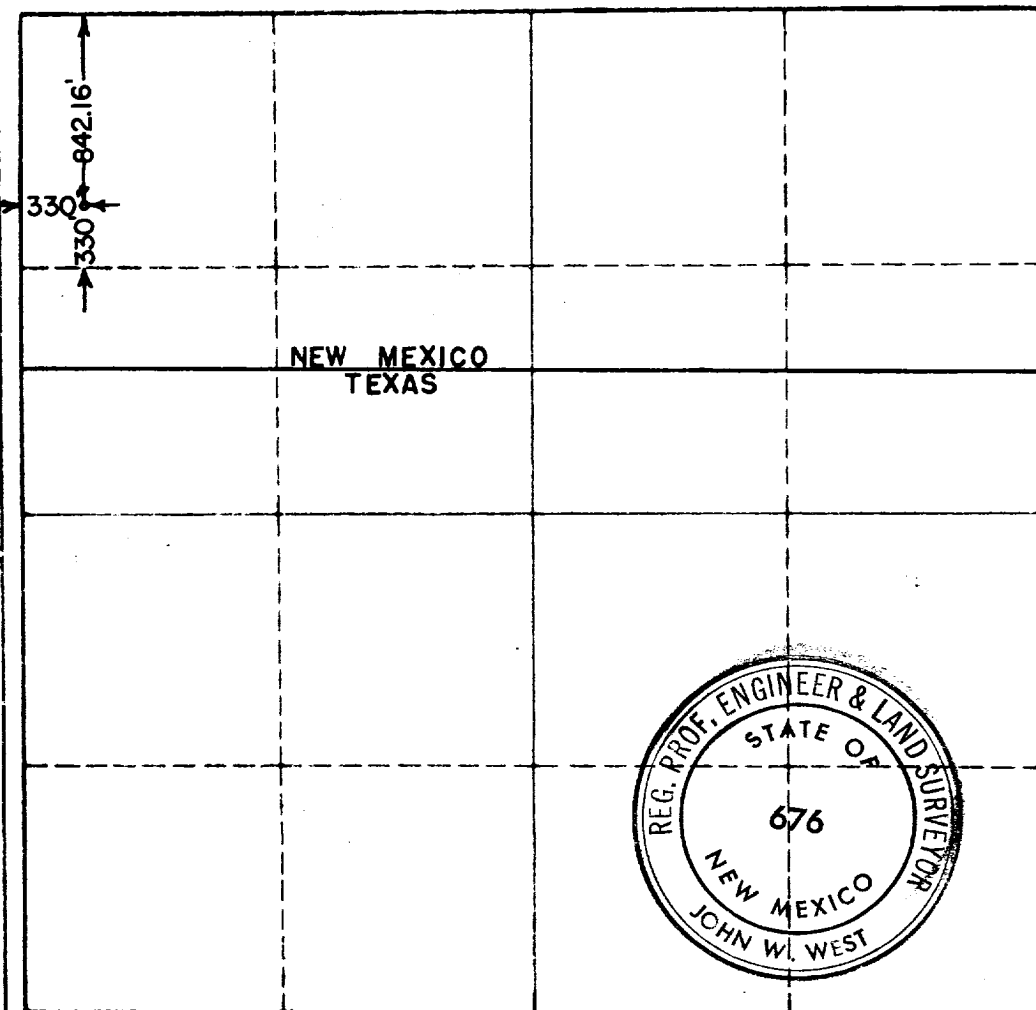

**CERTIFICATION**

I hereby certify that the information in SECTION A above is true and complete to the best of my knowledge and belief.

Name **Curtis Hankamer**  
 Position **Engr.**  
 Company **Curtis Hankamer**  
 Date **1/8/62**

I hereby certify that the well location shown on the plat in SECTION B was plotted from field notes of actual surveys made by me or under my supervision, and that the same is true and correct to the best of my knowledge and belief.

Date Surveyed **12-29-61**  
 Registered Professional Engineer and/or Land Surveyor, **JOHN W. WEST**  
 Certificate No. **John W West**  
 N.M. - P.E. & L.S. NO. 676

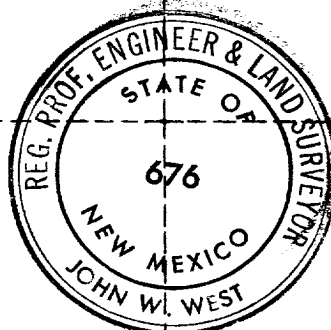

0 330 660 990 1320 1650 1980 2310 2640 2000 1500 1000 500 0