

UNITED STATES  
DEPARTMENT OF THE INTERIOR  
GEOLOGICAL SURVEY

38 015 20814

APPLICATION FOR PERMIT TO DRILL, DEEPEN, OR PLUG BACK

1a. TYPE OF WORK  
 DRILL  DEEPEN  PLUG BACK

b. TYPE OF WELL  
 OIL WELL  GAS WELL  OTHER  SINGLE ZONE  MULTIPLE ZONE

2. NAME OF OPERATOR  
**Black River Corporation**

3. ADDRESS OF OPERATOR  
**620 Commercial Bank Tower, Midland, Texas 79701**

4. LOCATION OF WELL (Report location clearly and in accordance with any State requirements.)\*  
 At surface **1986' FNL 330' FEL Sec. 4.**  
 At proposed prod. zone

14. DISTANCE IN MILES AND DIRECTION FROM NEAREST TOWN OR POST OFFICE\*  
**12 Miles SW White's City**

15. DISTANCE FROM PROPOSED LOCATION TO NEAREST PROPERTY OR LEASE LINE, FT. (Also to nearest drig. unit line, if any) **330'**

16. NO. OF ACRES IN LEASE **331.44**

17. NO. OF ACRES ASSIGNED TO THIS WELL **40 A out of Lot 7**

18. DISTANCE FROM PROPOSED LOCATION TO NEAREST WELL, DRILLING, COMPLETED, OR APPLIED FOR, ON THIS LEASE, FT. **1450**

19. PROPOSED DEPTH **1450**

20. ROTARY OR CABLE TOOLS **Rotary**

21. ELEVATIONS (Show whether DF, RT, GR, etc.) **3764 GR**

22. APPROX. DATE WORK WILL START\* **Feb. 20, 1973**

5. LEASE DESIGNATION AND SERIAL NO.  
**NM 0558959**

6. IF INDIAN, ALLOTTEE OR TRIBE NAME

7. UNIT AGREEMENT NAME

8. FARM OR LEASE NAME  
**BR Federal - 4**

9. WELL NO.  
**3**

10. FIELD AND POOL, OR WILDCAT  
**Wildcat**

11. SEC., T., R., M., OR BLK. AND SURVEY OR AREA  
**Sec. 4 T26S, R24E**

12. COUNTY OR PARISH **Eddy** 13. STATE **N.M.**

PROPOSED CASING AND CEMENTING PROGRAM

SIZE OF HOLE	SIZE OF CASING	WEIGHT PER FOOT	SETTING DEPTH	QUANTITY OF CEMENT
11	8-5/8	24	1280	300 Sx.
7-7/8	4-1/2	9.5	1400	35 Sx.

It is proposed to drill an 11 inch hole to 1280 feet. At which time 8-5/8 inch casing will be run and cement circulated to surface. After WOC a minimum of 18 hours the casing will be tested to 1000 PSI. If test OK, will drill with Delaware formation water to TD. A double ram BOP will be used while drilling this interval. At total depth, if well test appears productive, the 4-1/2 casing will be run with cement sufficient to return approximately 300 feet into the 8-5/8 casing.

IN ABOVE SPACE DESCRIBE PROPOSED PROGRAM: If proposal is to deepen or plug back, give data on present productive zone and proposed new productive zone. If proposal is to drill or deepen directionally, give pertinent data on subsurface locations and measured and true vertical depths. Give blowout preventer program, if any.

24. SIGNED Gene E. M... Agent TITLE Agent DATE Feb 20 1973

(This space for Federal or State office use)

APPROVED  
 APPROVED BY  
 CONDITIONS OF APPROVAL, IF ANY  
 FEB 22 1973  
 H. L. BEEKMAN  
 ACTING DISTRICT ENGINEER

PERMIT NO. \_\_\_\_\_ APPROVAL DATE \_\_\_\_\_ DATE \_\_\_\_\_  
 THIS APPLICATION IS VALID FOR OPERATIONS WITHIN 3 MONTHS.  
 MAY 22 1973  
 \*See Instructions On Reverse Side

DECLARED WATER BASIN  
 CEMENT BEHIND THE CASING MUST BE CIRCULATED

## Instructions

**General:** This form is designed for submitting proposals to perform certain well operations, as indicated, on all types of lands and leases for appropriate action by either a Federal or a State agency, or both, pursuant to applicable Federal and/or State laws and regulations. Any necessary special instructions concerning the use of this form and the number of copies to be submitted, particularly with regard to local, area, or regional procedures and practices, either are shown below or will be issued by, or may be obtained from, the local Federal and/or State office.

**Item 1:** If the proposal is to redrill to the same reservoir at a different subsurface location or to a new reservoir, use this form with appropriate notations. Consult applicable State or Federal regulations concerning subsequent work proposals or reports on the well.

**Item 4:** If there are no applicable State requirements, locations on Federal or Indian land should be described in accordance with Federal requirements. Consult local State or Federal office for specific instructions.

**Item 14:** Needed only when location of well cannot readily be found by road from the land or lease description. A plat, or plats, separate or on this reverse side, showing the roads to, and the surveyed location of, the well, and any other required information, should be furnished when required by Federal or State agency offices.

**Items 15 and 18:** If well is to be, or has been directionally drilled, give distances for subsurface location of hole in any present or objective production zone.

**Item 22:** Consult applicable Federal or State regulations, or appropriate officials, concerning approval of the proposal before operations are started.

NEW MEXICO OIL CONSERVATION COMMISSION  
WELL LOCATION AND ACREAGE DEDICATION PLAT

Form C-102  
Supersedes C-128  
Effective 1-1-65

All distances must be from the outer boundaries of the Section.

Operator <b>BLACK RIVER CORPORATION</b>		Lease <b>BR 4 FEDERAL</b>			Well No. <b>3</b>
Unit Letter <b>H</b>	Section <b>4</b>	Township <b>26 SOUTH</b>	Range <b>24 EAST</b>	County <b>EDDY</b>	
Actual Footage Location of Well: <b>330'</b> feet from the <b>EAST</b> line and <b>1986'</b> feet from the <b>NORTH</b> line					
Ground Level Elev. <b>3764</b>	Producing Formation <b>DELAWARE</b>	Pool <b>WIDCAT FILL</b>		Dedicated Acreage: <b>40</b> Acres	

1. Outline the acreage dedicated to the subject well by colored pencil or hachure marks on the plat below.
2. If more than one lease is dedicated to the well, outline each and identify the ownership thereof (both as to working interest and royalty).
3. If more than one lease of different ownership is dedicated to the well, have the interests of all owners been consolidated by communitization, unitization, force-pooling, etc?

Yes  No If answer is "yes," type of consolidation \_\_\_\_\_

If answer is "no," list the owners and tract descriptions which have actually been consolidated (Use reverse side of this form if necessary.) \_\_\_\_\_

No allowable will be assigned to the well until all interests have been consolidated (by communitization, unitization, forced-pooling, or otherwise) or until a non-standard unit, eliminating such interests, has been approved by the Commission.

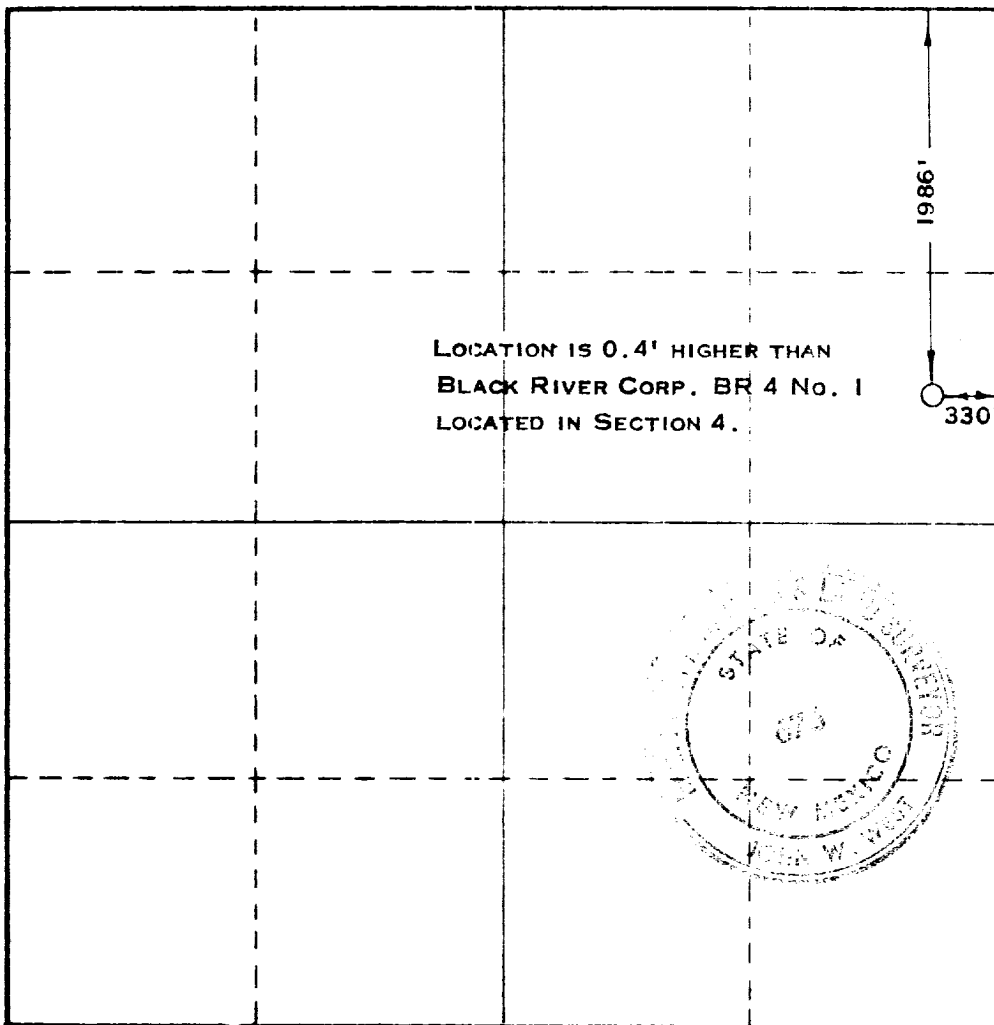

CERTIFICATION

I hereby certify that the information contained herein is true and complete to the best of my knowledge and belief.

Name: *Bruce B. Monroe*  
 Position: *Agent*  
 Company: *Black River Corp.*  
 Date: *Feb 31, 1973*

I hereby certify that the well location shown on this plat was plotted from field notes of actual surveys made by me or under my supervision, and that the same is true in context to the best of my knowledge and belief.

Date Surveyed: **FEBRUARY 14, 1973**  
 Registered Professional Engineer and/or Land Surveyor

*John W. West*  
 Certificate No. **676**

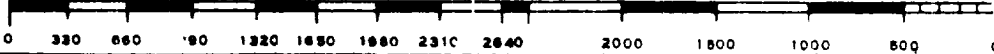

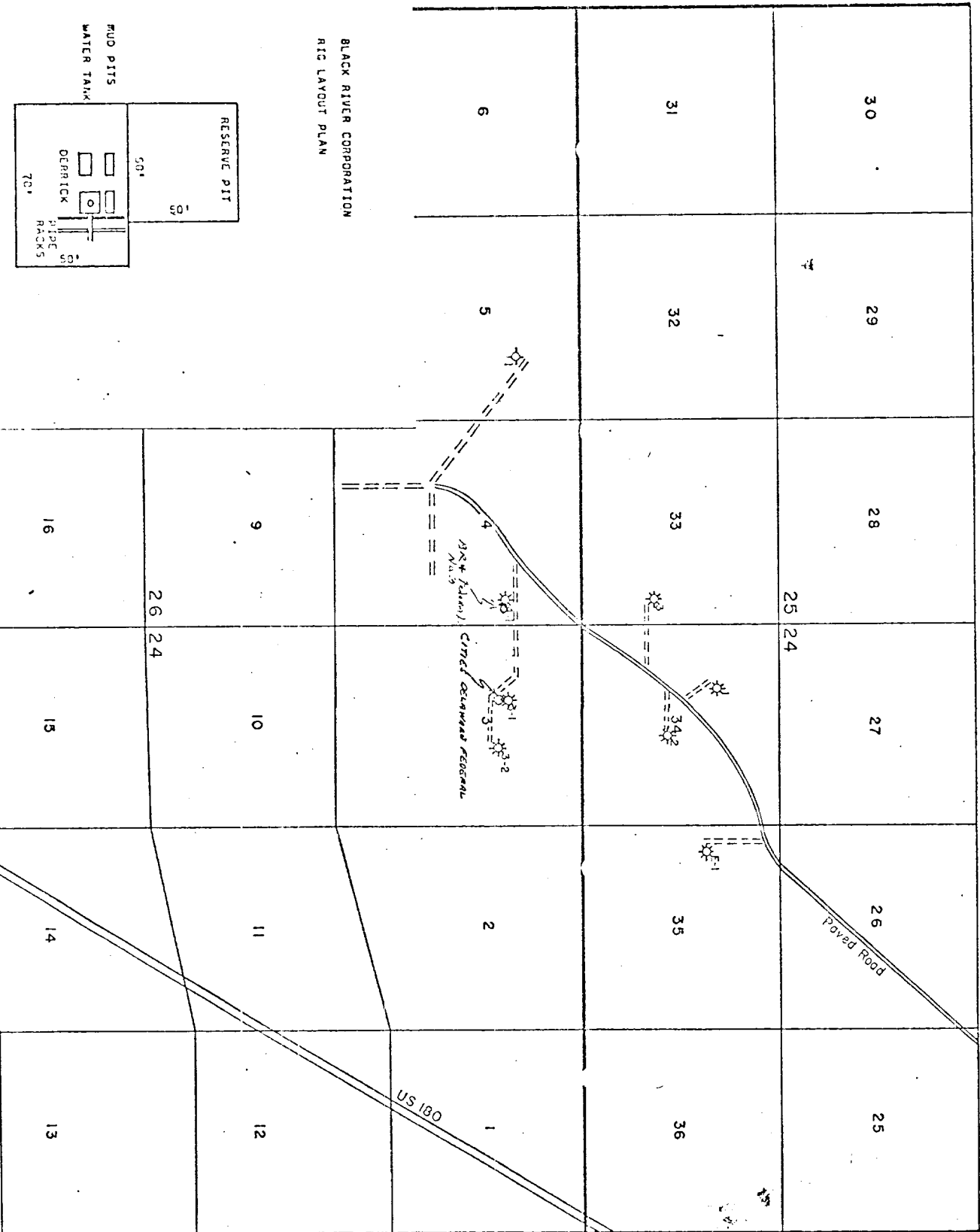

BLACK RIVER CORPORATION  
 RIC LAYOUT PLAN

If productive, tank battery and flow line will be located on drilling pad. Drilling water will be hauled to location. Waste will be hauled to proper waste disposal site. After completion, location and pits will be leveled and filled.

BLACK RIVER CORPORATION  
 WASHINGTON RANCH AREA  
 SURFACE USE DEVELOPMENT PLAN  
 WELL - 384 FEDERAL 3  
 DATE - February 14, 1973