

UNITED STATES  
DEPARTMENT OF THE INTERIOR  
GEOLOGICAL SURVEY

## APPLICATION FOR PERMIT TO DRILL, DEEPEN, OR PLUG BACK

## 1a. TYPE OF WORK

DRILL ☒DEEPEN ☐PLUG BACK ☐

## b. TYPE OF WELL

OIL  
WELL ☒GAS  
WELL ☐

OTHER

SINGLE  
ZONE ☒MULTIPLE  
ZONE ☐

## 2. NAME OF OPERATOR

J.C. Williamson, D.W. Underwood and Ralph E. Williamson

## 3. ADDRESS OF OPERATOR

Box 16, Midland, Texas 79701

## 4. LOCATION OF WELL (Report location clearly and in accordance with any State requirements.)\*

At surface

660 FSL and 1980 FWL Sec. 27, T26S, R30E

At proposed prod. zone

Delaware Sand

## 14. DISTANCE IN MILES AND DIRECTION FROM NEAREST TOWN OR POST OFFICE\*

19 miles SE of Malgalga

## 10. DISTANCE FROM PROPOSED\*

LOCATION TO NEAREST  
PROPERTY OR LEASE LINE, FT.  
(Also to nearest drlg. unit line, if any)

660 feet

## 16. NO. OF ACRES IN LEASE

769.91

17. NO. OF ACRES ASSIGNED  
TO THIS WELL

40

## 18. DISTANCE FROM PROPOSED LOCATION\*

TO NEAREST WELL, DRILLING, COMPLETED,  
OR APPLIED FOR, ON THIS LEASE, FT.

Wildcat

## 19. PROPOSED DEPTH

4000'

## 20. ROTARY OR CABLE TOOLS

Cable Tools

## 21. ELEVATIONS (Show whether DF, RT, GR, etc.)

3000.2 GR.

## 22. APPROX. DATE WORK WILL START\*

Dec. 10, 1973

## 23.

## PROPOSED CASING AND CEMENTING PROGRAM

SIZE OF HOLE	SIZE OF CASING	WEIGHT PER FOOT	SETTING DEPTH	QUANTITY OF CEMENT
13-3/8	12-3/4	44#	300'	300 sacks

IN ABOVE SPACE DESCRIBE PROPOSED PROGRAM: If proposal is to deepen or plug back, give data on present productive zone and proposed new productive zone. If proposal is to drill or deepen directionally, give pertinent data on subsurface locations and measured and true vertical depths. Give blowout preventer program, if any.

24.

SIGNED

TITLE

Partner

DATE

Nov. 26, 1973

(This space for Federal or State office use)

PERMIT NO.

APPROVAL DATE

APPROVED BY

CONDITIONS OF APPROVAL, IF ANY:

DEC - 6 1973

H. L. BECKMAN

ACTING DISTRICT ENGINEER

THIS APPROVAL IS VALID FOR 3 MONTHS.  
ARE NOT COMMENCED  
EXPIRES

MAR - 6 1974

DATE

\*See Instructions On Reverse Side

**N MEXICO OIL CONSERVATION COMMISSION  
WELL LOCATION AND ACREAGE DEDICATION PLAT**

Form C-102  
Supersedes C-128  
Effective 1-1-65

All distances must be from the outer boundaries of the Section

Operator <b>J.C. Williamson, D.W. Underwood &amp; Ralph E. Williamson</b>			Lease <b>McCarver Federal</b>		Well No. <b>21</b>
Unit Letter <b>N</b>	Section <b>27</b>	Township <b>26 South</b>	Range <b>30 East</b>	County <b>Eddy</b>	
Actual Footage Location of Well: <b>660</b> feet from the <b>South</b> line and <b>1980</b> feet from the <b>West</b> line					
Ground Level Elev. <b>3000.2</b>	Producing Formation <b>Delaware Sand</b>		Pool <b>Wildcat</b>	Dedicated Acreage <b>40</b>	

1. Outline the acreage dedicated to the subject well by colored pencil or hatchure marks on the plat below.
2. If more than one lease is dedicated to the well, outline each and identify the ownership thereof (both as to working interest and royalty).
3. If more than one lease of different ownership is dedicated to the well, have the interests of all owners been consolidated by communitization, unitization, force-pooling, etc?

☐ Yes    ☐ No    If answer is "yes," type of consolidation \_\_\_\_\_

If answer is "no," list the owners and tract descriptions which have actually been consolidated. (Use reverse side of this form if necessary.) \_\_\_\_\_

No allowable will be assigned to the well until all interests have been consolidated (by communitization, unitization, forced-pooling, or otherwise) or until a non-standard unit, eliminating such interests, has been approved by the Commission.

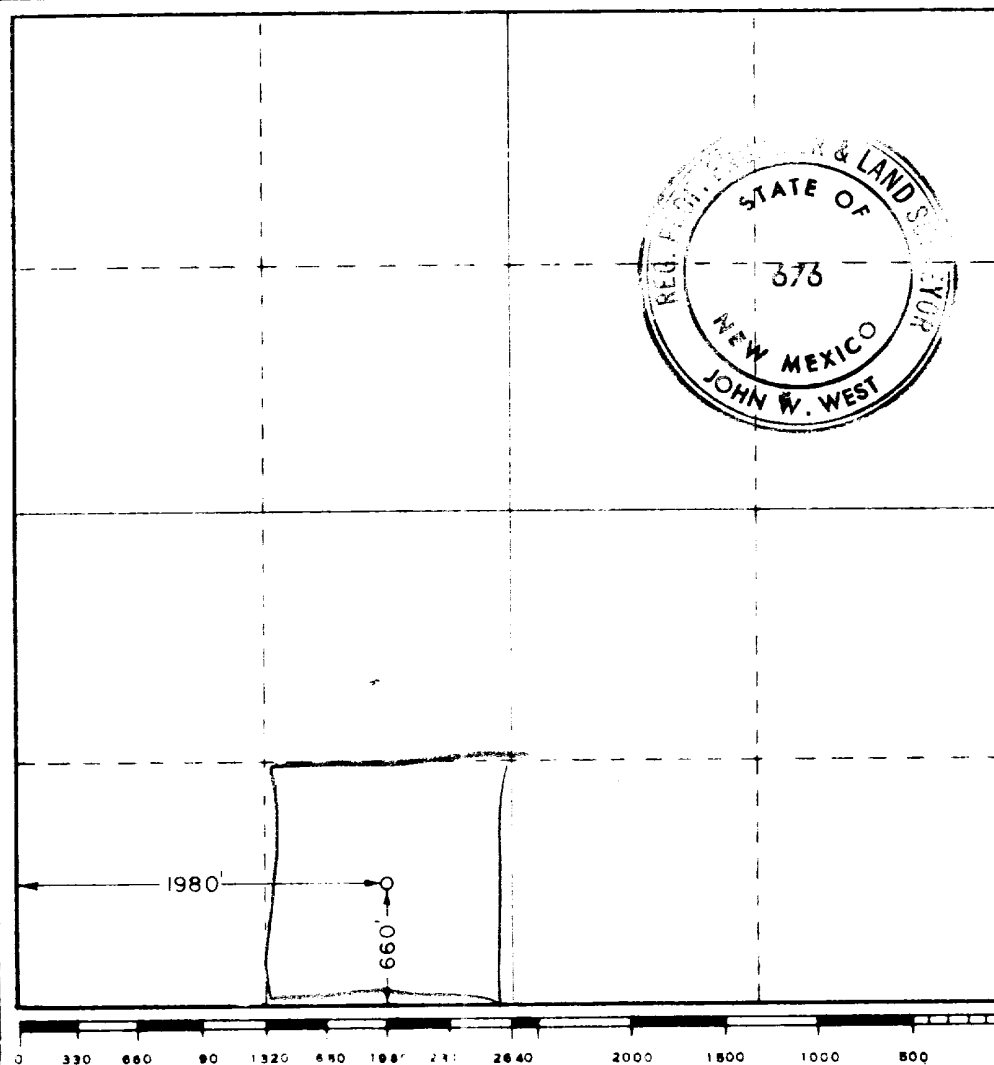

**CERTIFICATION**

I hereby certify that the information contained herein is true and complete to the best of my knowledge and belief.

*Ralph E. Williamson*  
**Ralph E. Williamson**

**Partner**

**Williamson, Underwood and  
Williamson**

Date  
**Nov. 26, 1973**

I hereby certify that the well location shown on this plat was plotted from field notes of actual surveys made by me or under my supervision, and that the same is true and correct to the best of my knowledge and belief.

Date Surveyed

**November 21, 1973**

Registered Professional Engineer  
and/or Land Surveyor

*John W. West*  
Certificate No.

**676**

**J. C. WILLIAMSON**

626 VAUGHN BUILDING

MIDLAND, TEXAS 79701

November 26, 1973

United States Department of the Interior  
Geological Survey  
Washington, D. C.

Re: J.C. Williamson, D.W. Underwood &  
Ralph E. Williamson #4 McCarver Federal  
660 From South and 1980 from West of  
Sec. 27, T26S, R30E, Eddy County,  
New Mexico

Gentlemen:

As per instructions for submitting an application to drill on shore or off-shore gas, oil or geothermal wells on public domain and acquired lands, J.C. Williamson, D. W. Underwood and Ralph E. Williamson answer these questions as follow:

1. Existing Roads: Exhibit "B", attached, shows existing roads in solid red lines.
2. Planned Access Roads: Planned access roads are shown on Exhibit "B" as dashed red lines.
3. Location of Well: As shown on above reference.
4. Lateral Roads to Location: None
5. Location of Tank Battery and Flow Lines: If the above well is productive, surface equipment will be set on location site.
6. Location and Types of Water Lines: Water to be hauled.
7. Methods for Handling Waste Deposits: A reserve pit located as per Exhibit "C" will be used for handling all wastes.
8. Location of Camps: None
9. Location of Air Strip: None

10. Position of the Rig, Mud Tank, Reserve Pit, Pipe Racks, and etc.: Cable tools.
11. Plans for Restoration of the Surface: After drilling the well, J. C. Williamson, D. W. Underwood and Ralph E. Williamson will level all pits and location as near to original ground level as possible. This location is located in an arid region on which there is no surface grass.
12. Blowout Preventor Diagram: Cable Tools.

Should you have any questions concerning any of the above, please do not hesitate to call or write.

Yours very truly,

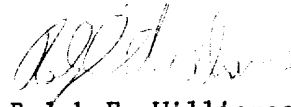

Ralph E. Williamson

REW:da

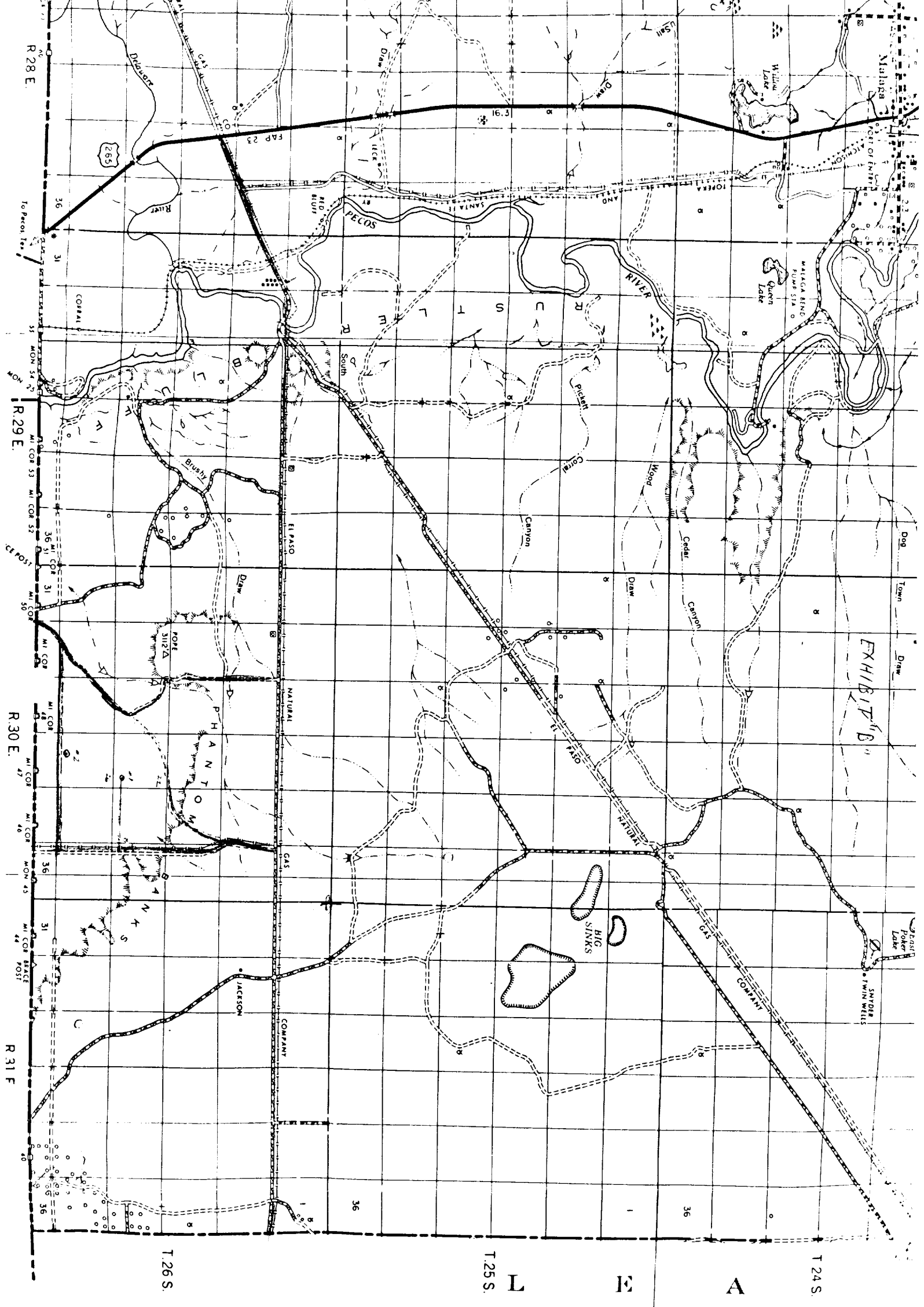

32° 00' 10'