

Federal Lse. No. NM-22628

All distances must be from the outer boundaries of the Section.

Operator Exxon Corporation		Lease Scheidt Federal		Well No. 1
Unit Letter K	Section 30	Township 26 South	Range 26 East	County Eddy
Actual Footage Location of Well: 2130' feet from the West line and 1,830 feet from the South line				
Ground Level Elev.	Producing Formation Silurian	Pool Wildcat	Dedicated Acreage: 320 Acres	

1. Outline the acreage dedicated to the subject well by colored pencil or hachure marks on the plat.
2. If more than one lease is dedicated to the well, outline each and identify the owner thereof (both as to working interest and royalty).
3. If more than one lease of different ownership is dedicated to the well, have the interests of all owners consolidated by communitization, unitization, force-pooling, etc?

☐ Yes ☐ No If answer is "yes," type of consolidation _____

If answer is "no," list the owners and tract descriptions which have actually been consolidated. (Use reverse side of this form if necessary.) _____

No allowable will be assigned to the well until all interests have been consolidated (by communitization, unitization, forced-pooling, or otherwise) or until a non-standard unit, eliminating such interests, has been approved by the Commission.

RECEIVED
FEB 17 1978
U.S. GEOLOGICAL SURVEY
ARTESIA, NEW MEXICO

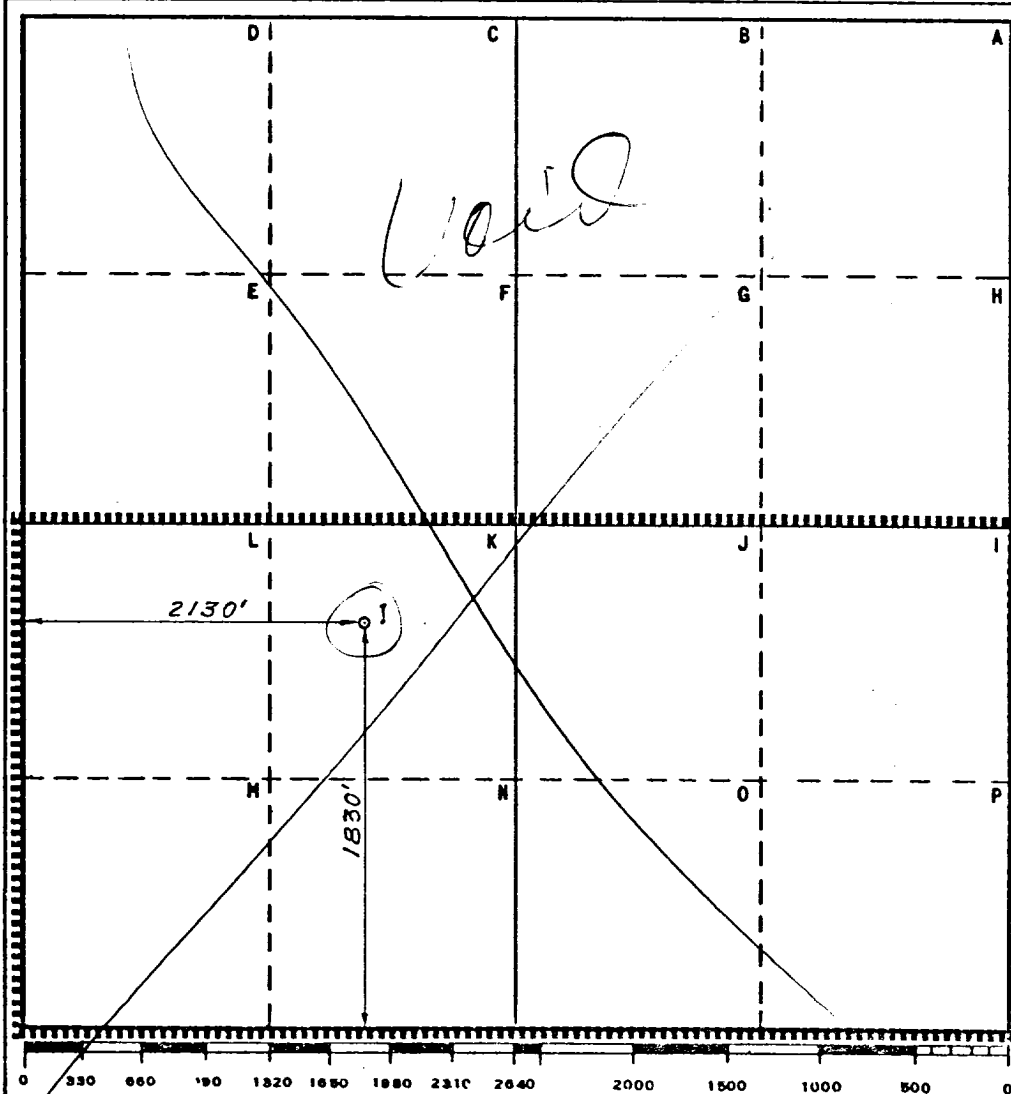

CERTIFICATION

I hereby certify that the information contained herein is true and complete to the best of my knowledge and belief.

Name
Melba Knippling
Position
Proration Specialist
Company **Exxon Corporation**
Box 1600 Midland, Texas
Date
2-9-78

I hereby certify that the well location shown on this plat was plotted from field notes of actual surveys made by me or under my supervision, and that the same is true and correct to the best of my knowledge and belief.

1-19-78

Date Surveyed

Registered Professional Engineer
and/or Land Surveyor

H.S. Hesterfeld
Certificate No.
1382

Scheidt Federal Well No. 1

1. The geologic name of the surface formation.

Castile

2. The estimated tops of important geologic markers.

Bell Canyon	1570'
Cherry Canyon	2540'
Brushy Canyon	3550'
Bone Spring	5080'
Dean	7650'
Wolfcamp	8020'
Atoka	9550'
Morrow	9820'
Mississippian Lime	11510'
Woodford	11640'
Silurian	11750'

3. The estimated depths at which anticipated water, oil or other mineral bearing formations are expected to be encountered.

Water - Shallow surface water not anticipated
Oil - 1570'
Gas - 10500' & 11750'

4. Proposed Casing Program:

<u>String</u>	<u>Size/Weight/Grade</u>	<u>Condition</u>	<u>Depth Interval</u>
Surface	13-3/8/61.0/K-55	New	0 - 100
	13-3/8/48.0/H-40	New	100 - 400
Intermediate	9-5/8/40.0/N-80	New	0 - 1800
	9-5/8/40.0/K-55	New	1800 - 5150
Production*	5/15.0/N-80	New or 2nd C1	0 - 1000
	5/15.0/J-55	New or 2nd C1	1000 - 7500
	5/15.0/N-80	New or 2nd C1	7500 - 11500
	5/15.0/P-110	New or 2nd C1	11500 - 13000

*Casing string run will be at least as strong as string shown. Actual pipe run may be different depending on casing available at time.

5. Minimum specifications for pressure control equipment:

a) Casinghead Equipment

"A" Section: 13-3/8" STC x 12" 3000 psi
"B" Section: 12" 3000 psi x 10" 5000 psi
Tubinghead: 10" 5000 psi x 6" 5000 psi
Adapter & Tree: 6" 5000 psi x 2-1/2" 5000 psi