

UNITED STATES
DEPARTMENT OF THE INTERIOR
GEOLOGICAL SURVEY

APPLICATION FOR PERMIT TO DRILL, DEEPEN, OR PLUG BACK

1a. TYPE OF WORK

DRILL ☒DEEPEN ☐PLUG BACK ☐

b. TYPE OF WELL

OIL
WELL ☒GAS
WELL ☐OTHER ☐SINGLE
ZONE ☒MULTIPLE
ZONE ☐

2. NAME OF OPERATOR

Pogo Producing Company ✓

3. ADDRESS OF OPERATOR

P.O. Box 10340 Midland, Texas 79702

4. LOCATION OF WELL (Report location clearly and in accordance with any State requirements.)*

At surface

990' FSL & 840' FWL

At proposed prod. zone

990' FSL & 840' FWL

14. DISTANCE IN MILES AND DIRECTION FROM NEAREST TOWN OR POST OFFICE*

9 Miles South of Malaga, New Mexico

15. DISTANCE FROM PROPOSED*

LOCATION TO NEAREST
PROPERTY OR LEASE LINE, FT.
(Also to nearest drlg. unit line, if any)

840'

18. DISTANCE FROM PROPOSED LOCATION*
TO NEAREST WELL, DRILLING, COMPLETED,
OR APPLIED FOR, ON THIS LEASE, FT.

None

16. NO. OF ACRES IN LEASE

1280

19. PROPOSED DEPTH

2700'

17. NO. OF ACRES ASSIGNED
TO THIS WELL

40

20. ROTARY OR CABLE TOOL

Cable Tool

21. ELEVATIONS (Show whether DF, RT, GR, etc.)

2614.2' GR

22. APPROX. DATE WORK WILL START*

March 25, 1981

23.

PROPOSED CASING AND CEMENTING PROGRAM

SIZE OF HOLE	SIZE OF CASING	WEIGHT PER FOOT	SETTING DEPTH	QUANTITY OF CEMENT
11"	8 5/8"	24.00#	220'	200 Sx Circulate
7 7/8"	5 1/2"	14.00#	2700'	600 Sx Circulate

Proposal is to drill a well to adequately test the Delaware Formation. Cement will be circulated to surface on the 8 5/8" surface string & 5 1/2" production string.

Completion or Abandonment will be performed in accordance with prudent practice and regulatory requirements.

Gas on this lease is not dedicated.

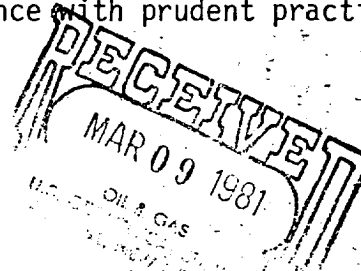

IN ABOVE SPACE DESCRIBE PROPOSED PROGRAM: If proposal is to deepen or plug back, give data on present productive zone and proposed new productive zone. If proposal is to drill or deepen directionally, give pertinent data on subsurface locations and measured and true vertical depths. Give blowout preventer program, if any.

SIGNED

TITLE Division Operations Mgr.

DATE March 2, 1981

(This space for Federal or State office use)

PERMIT NO.

(U.S. Sgd.) GEORGE H. STEWART

APPROVAL DATE

APPROVED BY

TITLE

DATE

CONDITIONS OF APPROVAL, IF ANY:

MAR 23 1981
JAMES A. GILLHAM
DISTRICT SUPERVISOR

**NEW MEXICO OIL CONSERVATION COMMISSION
WELL LOCATION AND ACREAGE DEDICATION PLAT**

Form C-102
Supersedes C-128
Effective 1-1-65

All distances must be from the outer boundaries of the Section.

Operator Pogo Producing Co.			Lease SAM Federal		Well No. 1
Unit Letter M	Section 25	Township 25 South	Range 28 East	County Eddy	
Actual Footage Location of Well: 990 feet from the South line and 840 feet from the West line					
Ground Level Elev. 2614.2	Producing Formation Delaware		Pool Wildcat Delaware	Dedicated Acreage: 40 Acres	

1. Outline the acreage dedicated to the subject well by colored pencil or hachure marks on the plat below.
2. If more than one lease is dedicated to the well, outline each and identify the ownership thereof (both as to working interest and royalty).
3. If more than one lease of different ownership is dedicated to the well, have the interests of all owners been consolidated by communitization, unitization, force-pooling, etc?

☐ Yes ☐ No If answer is "yes," type of consolidation _____

If answer is "no," list the owners and tract descriptions which have actually been consolidated. (Use reverse side of this form if necessary.) _____

No allowable will be assigned to the well until all interests have been consolidated (by communitization, unitization, forced-pooling, or otherwise) or until a non-standard unit, eliminating such interests, has been approved by the Commission.

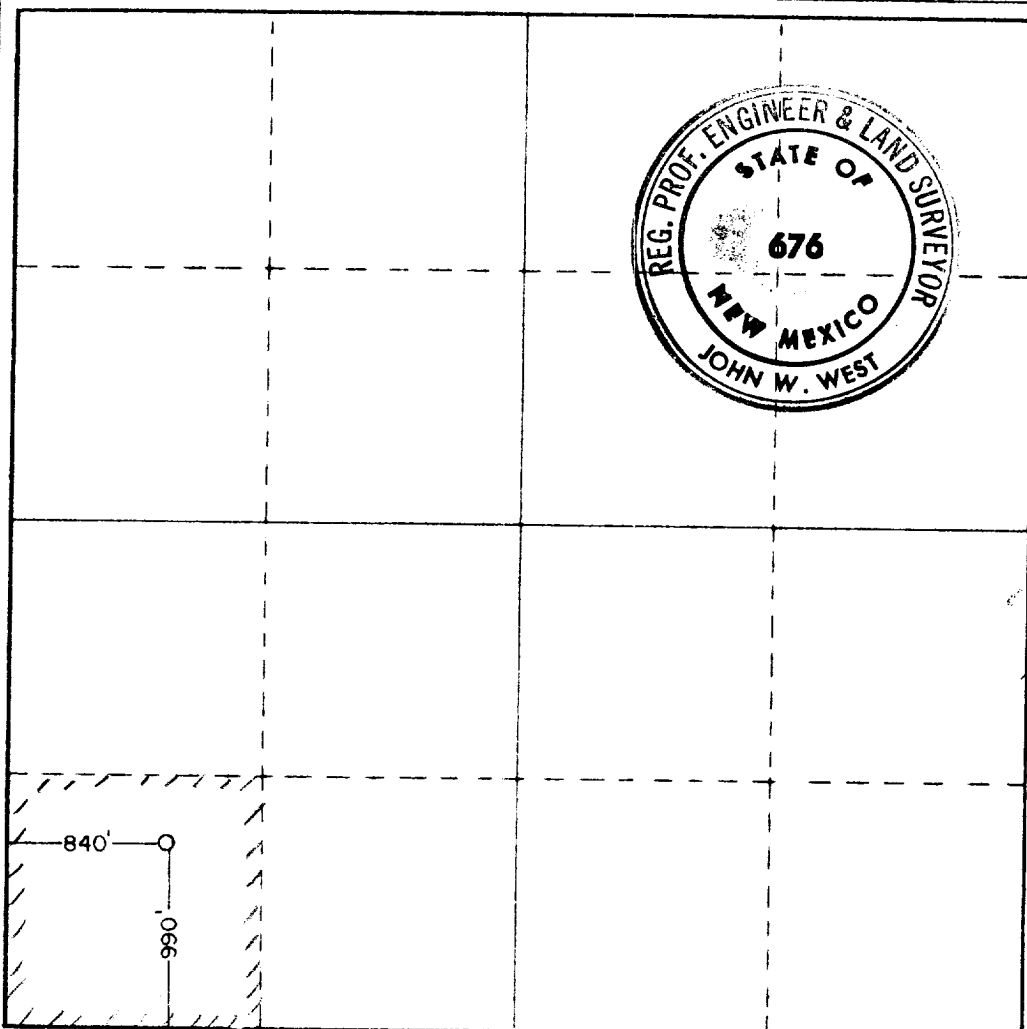

CERTIFICATION

I hereby certify that the information contained herein is true and complete to the best of my knowledge and belief.

B. J. Williams
 Name
B. J. Williams
 Position
Division Operations Manager
 Company
Pogo Producing Company
 Date
March 2, 1981

I hereby certify that the well location shown on this plat was plotted from field notes of actual surveys made by me or under my supervision and that the same is true and correct to the best of my knowledge and belief.

Date Surveyed
2-23-81
 Registered Professional Engineer and/or Land Surveyor

John W. West
 Certificate No. **JOHN W. WEST 676**
PATRICK A. ROMERO 6663
 Renewed **1-1-80** **1235**

APPLICATION FOR DRILLING

Pogo Producing Company

SAM Federal No. 1

Eddy County, New Mexico

In conjunction with permitting the captioned well for drilling in Section 25, T-25-S, R-28-E, Eddy County, New Mexico, Pogo Producing Company submits the following information in accordance with U.S.G.S. (NTL-6) letter dated July 1, 1976:

1. The surface formation is Quaternary Sand & Gravel.

2. Estimated tops of geologic markers as follows:

Triassic Red Beds	-	450'
Rustler Anhydrite & Dolomite	-	920'
Lamar Lime	-	2580'
Delaware Sand	-	2610'

3. The depth at which oil, gas or water are expected is: 2610'.

4. Casing Program and Cement:

All casing will be new or Class B

8 5/8" 24.00# K-55 STC @ 220' w/200 sxs C1 C w/2% CaCl plus 1/4# flocele per sx.

5 1/2" 14.00# K-55 STC @ 2700' w/400 sxs Lt w/1/4# flocele plus 5# gilsonite per sx plus 200 sxs C1 C w/2% CaCl.

5. Circulating Medium:

An earthen pit will be used to hold cuttings. The drilling mud program will be native mud w/Aquagel added for stabilization.

6. Adequate electrical and resistivity logs will be run from total depth to the base of the surface casing at 220', the gamma ray will be run to the surface.

7. No abnormal temperatures or additional hazards are expected to be encountered.

8. The anticipated starting date is March 25, 1981 with completion expected by May 9, 1981.



MULTIPOINT SURFACE USE AND OPERATION PLAN

Pogo Producing Company

SAM Federal No. 1

990' FSL & 840' FWL, Section 25, T-25-S, R-28-E

Eddy County, New Mexico

This plan is submitted with the Application for Permit to Drill the captioned well. The purpose of this plan is to describe the location of the proposed well, the proposed construction activities and operations plan, the magnitude of necessary surface disturbance involved and the procedures to be followed in rehabilitating the surface after completion of drilling operations.

1. Existing Roads:

Existing roads in the vicinity of the planned well are shown on Exhibit A, attached. The well is located 9 miles South of Malaga, New Mexico.

No additional improvement or maintenance of existing roads will be required.

2. Planned Access Roads:

An access road will be constructed from the existing rock & gravel road west to the location. The road will be constructed 12' wide of native rock and gravel, and will be approximately 70' in length. The centerline of the access road has been staked and flagged.

3. Location of Existing Wells:

The currently drilling Maddox Energy Corp. #1 Flower Draw "2" is located approximately 1½ miles SSW of the proposed location. See Exhibit B.

4. Location of Existing and/or Proposed Facilities:

There are no existing facilities on the lease at present. If production is established, producing facilities and a tank battery will be constructed on the drilling pad and no additional surface disturbance will be required.

5. Location and Type of Water Supply:

Water used in the drilling of the well will be purchased and trucked to the wellsite over existing roads as shown on Exhibit A.

6. Source of Construction Materials:

The location will be levelled from a gently sloping plain with native rock and gravel on location used for compaction.

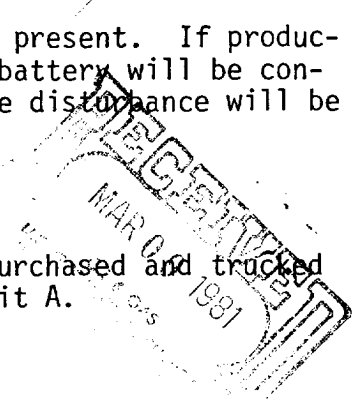

Page 2.

7. Method of Handling Waste Disposal:

- A. Drill cuttings will be disposed of in the drill cutting pit.
- B. Drilling fluids will be allowed to evaporate in the drilling pit. Oil produced during tests will be stored in steel test tanks until sold. Water produced during tests will be disposed of in the drilling pit.
- C. Trash, waste paper, garbage and junk will be buried in a separate trash pit and covered with a minimum of 24 inches of dirt. All waste material will be contained to prevent scattering by the wind. Location of trash pit is shown on Exhibit C.
- D. All trash and debris will be buried or removed from the wellsite within 30 days after cessation of drilling or completion operations.

8. Ancillary Facilities:

None required.

9. Well Site Layout:

- A. Exhibit C shows the relative location and dimensions of the well pad, drill cuttings pit, trash pit and major rig components.
- B. The proposed well site is situated on a gently sloping plain which will be levelled with the excess dirt and gravel used on the edge of the pad and access road.
- C. The reserve pit will be lined if required for use with rotary rig.
- D. The pad has been staked and flagged.

10. Plans For Restoration of the Surface:

- A. After completion of drilling and/or completion operations, all equipment and other materials not needed will be removed. Pits will be filled after sufficient drying time and the location cleaned of all trash and junk to leave the wellsite in an aesthetically pleasing condition.
- B. All unguarded pits containing fluids will be fenced until filled.
- C. After abandonment of the well, surface restoration will be in accordance with the agreement BLM regulations. Rehabilitation will be accomplished within 90 days after abandonment.

Page 3.

11. Other Information:

A. Terrain -

The proposed location will be situated on an undulating plain located due west of the Pecos River. Areal soil individuals tend to be shallow, composed of loamy sands, and contain limestone and chert inclusions. Drainage is to the east and is directly tributary to the Pecos River. Pedons belong to the Typic Paleorthid and Typic Paleorthid and Typic Calciorthid subgroups.

B. Floristics -

Chief plants occurring locally include *Prosopis juliflora*, *Larrea tridentata*, *Acacia constricta*, *Acacia gregii*, and *Koeberlinia spinosa*. Commonly occurring forbs include *Gutierrezia sarothrae* and several unidentified members of the Compositae. The Gramineae is represented by *Aristida* sp. and *Tridens pulchellus*.

C. Ponds and Streams -

The location lies approximately ½ mile due west of the Pecos River.

D. Occupied Dwellings -

There is a residence located approximately 3/4 miles SW of the proposed location.

E. Cultural Resources -

No archaeological resources were observed in the area.

F. Land Use -

Grazing and hunting in season.

G. Surface Ownership -

The surface is Federal land and the current grazing lessee is Mrs. Evelyn Cooksey, P.O. Box 91, Orla, Texas 79770

12. Operator's Representatives:

W. E. Barnes
3778 Maple
Odessa, Texas 79762
Home phone - (915) 362-7935

B. J. Williams
Suite 408 Blanks Building
P.O. Box 10340
Midland, Texas 79702
Office phone - (915) 682-6822
Home phone - (915) 694-2215

Pogo Producing Company
SAM Federal No. 1
Sec. 25, T-25-S, R-28-E
Eddy County, New Mexico

Page 4.

13. Certification:

I hereby certify that I or persons under my direct supervision, have inspected the proposed drillsite and access route; that I am familiar with the conditions which presently exist; that the statements made in this plan are, to the best of my knowledge, true and correct; and, that the work associated with the operations proposed herein will be performed by Pogo Producing Company and its contractors and sub-contractors in conformity with this plan and the terms and conditions under which it is approved.

Date

3/5/81

B. J. Williams

B. J. Williams
Division Operations Manager
Pogo Producing Company



The image displays three horizontal number lines, each representing a different unit of measurement:

- Miles:** A number line with tick marks at 2, 3, and 4, labeled "MILES".
- Feet:** A number line with tick marks at 12000, 15000, 18000, and 21000, labeled "FEET".
- Kilometers:** A number line with tick marks at 3, 4, and 5, labeled "KILOMETERS".

Road Classification 1946	
Dependable hard-surface	Dry weather road
Heavy-duty road	Loose-surface, graded
Secondary hard-surfaces	Unsurfaced, graded
all weather road 	Dirt road

More than two lanes indicated along road with tick at point of

Pogo Producing Company
SAM Federal No. 1
990' FSL & 840' FWL
Section 25, T-25-S, R-28-E
Eddy County, New Mexico

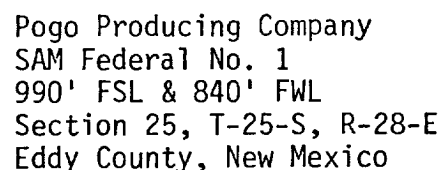

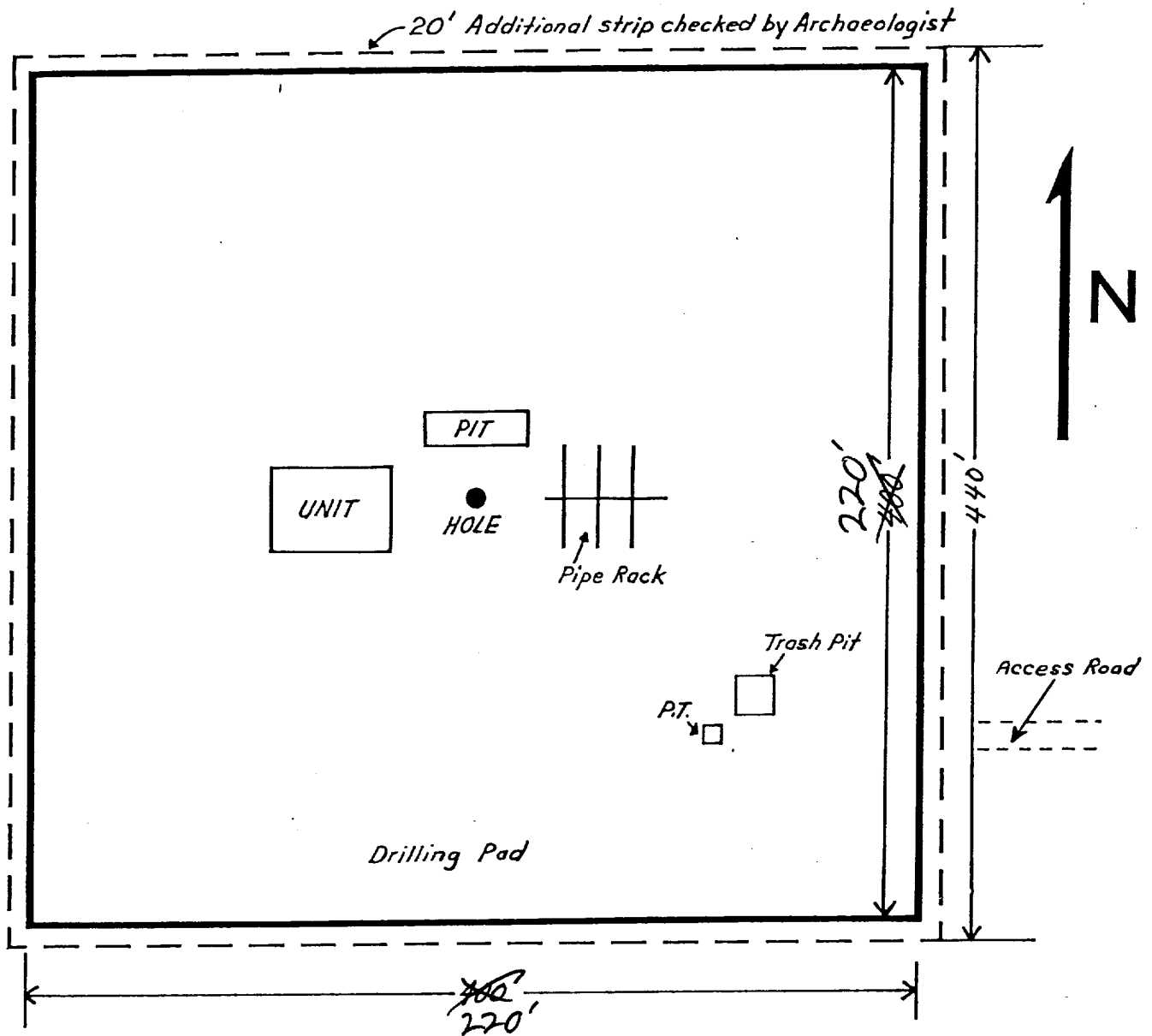

EXHIBIT C

Pogo Producing Company
 SAM Federal No. 1
 990' FSL & 840' FWL
 Sec. 25, T-25-S, R-28-E
 Eddy County, New Mexico