

# Yates Petroleum Corporation

Location Layout for Permian Basin  
Up to 12,000'

Adeline AIN Federal #10  
1980' FSL and 1830' FEL  
Section 6, T24S-R31E  
Eddy County, New Mexico  
NM-82904

**Yates Petroleum Corporation**  
105 SOUTH 4th STREET  
ARTESIA, NEW MEXICO 88210

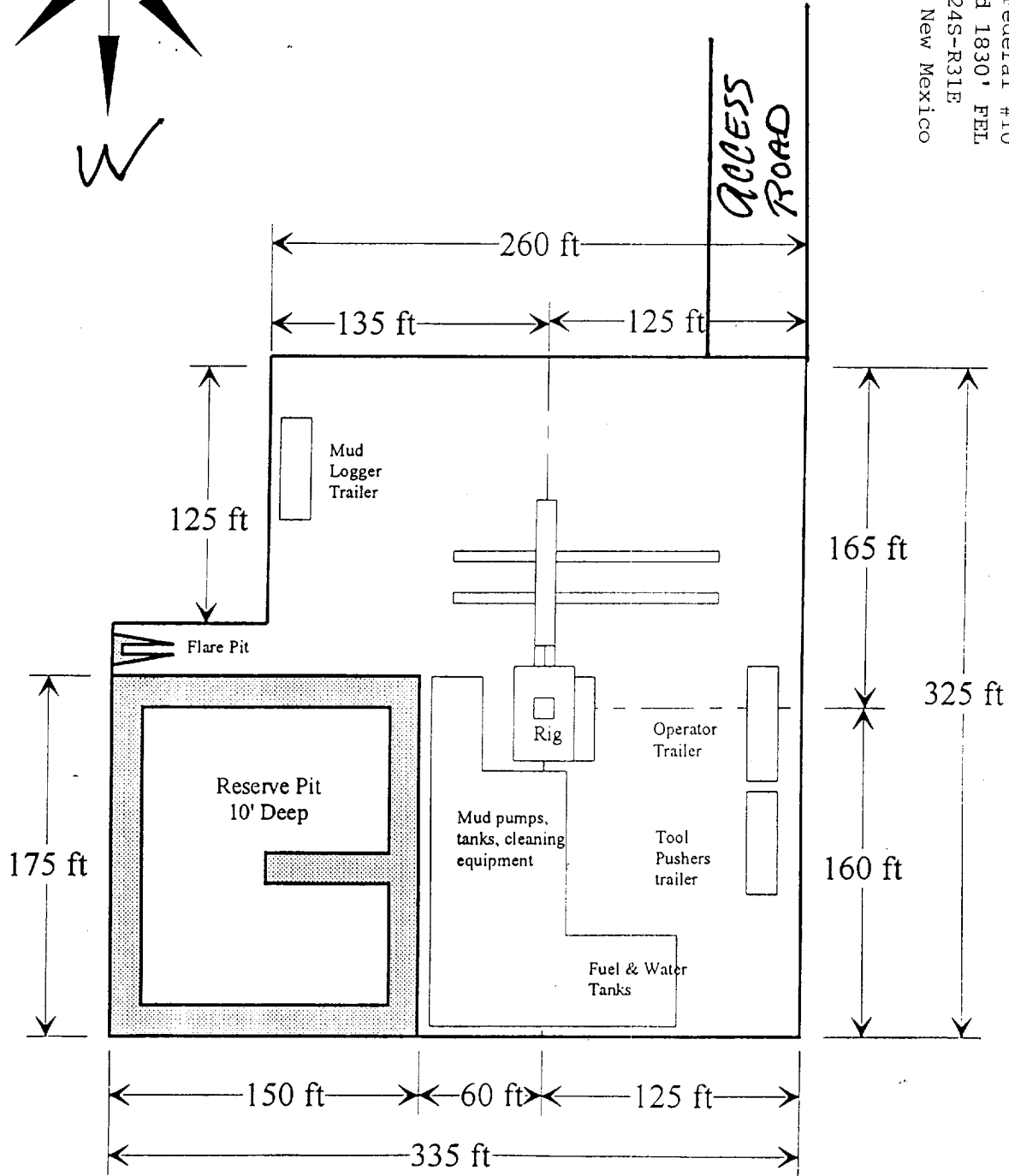
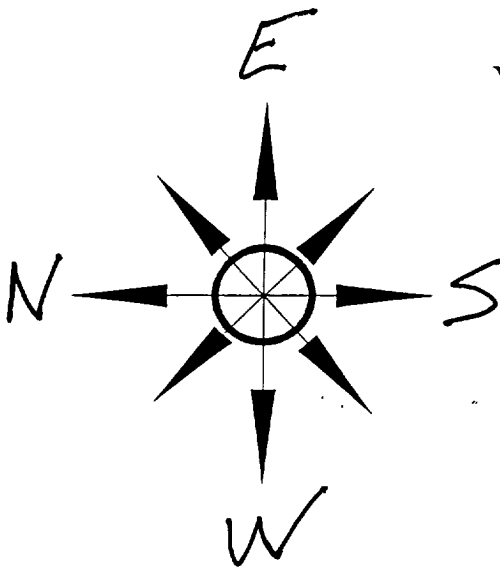

Distance from Well Head to Reserve Pit will vary between rigs

The above dimension should be a maximum