

| | |
|------------------------|---|
| NO. OF COPIES RECEIVED | |
| DISTRIBUTION | |
| SANTA FE | 1 |
| FILE | 1 |
| U.S.G.S. | 2 |
| LAND OFFICE | 1 |
| OPERATOR | 1 |

NEW MEXICO OIL CONSERVATION COMMISSION
RECEIVED

FEB 25 1981

O. C. D.

ARTESIA OFFICE

Form C-101
Revised 1-1-65

5A. Indicate Type of Lease
STATE ☐ FEE ☒
5. State Oil & Gas Lease No.

APPLICATION FOR PERMIT TO DRILL, DEEPEN, OR PLUG BACK

1. Type of Work
2. Type of Well
DRILL ☒ DEEPEN ☐ PLUG BACK ☐
OIL WELL ☐ GAS WELL ☒ OTHER ☐
SINGLE ZONE ☒ MULTIPLE ZONE ☐
Name of Operator

7. Unit Agreement Name

8. Farm or Lease Name

Shannon

9. Well No.

3

10. Field and Pool, or Wildcat

Wildcat Abo

Mesa Petroleum Co.
Address of Operator

1000 Vaughn Building / Midland, Texas 79701

Location of Well

UNIT LETTER G LOCATED 1980 FEET FROM THE North LINE

1980 FEET FROM THE East LINE OF SEC. 28 TWP. 6S RGE. 24E NMPM

12. County

Chaves

| | | |
|--|------------------------------------|--|
| 19. Proposed Depth 4000' | 19A. Formation Abo | 20. Rotary or C.T. Rotary |
| 21A. Kind & Status Plug. Bond Blanket | 21B. Drilling Contractor Desert | 22. Approx. Date Work will start June 4, 1981 |

Elevations (Show whether DF, RT, etc.)

3865.9' GR

PROPOSED CASING AND CEMENT PROGRAM

| SIZE OF HOLE | SIZE OF CASING | WEIGHT PER FOOT | SETTING DEPTH | SACKS OF CEMENT | EST. TOP |
|--------------|----------------|-----------------|---------------|-----------------|---------------|
| 17 1/2" | 13 3/8" | 48# | 800 | 500 | Surface |
| 11" | 8 5/8" | 24# | 2000 | 600 | Sufficient To |
| 7 7/8" | 4 1/2" | 10.5# | 4000 | 500 | Cover All Pay |

Propose to drill 17 1/2" hole to 800' using air. Will set 13 3/8" surface casing and cement to surface. Will reduce hole to 11" and drill to 2000' to set 8 5/8" intermediate casing. Will nipple up ram type BOPs and reduce hole to 7 7/8" and drill to total depth with air, foam, or mud as required. After log evaluation, 4 1/2" casing may be run and cemented back to surface casing or with sufficient kinds and amounts to isolate and seal off any fresh water, oil, or gas zones encountered.

APPROVAL VALID FOR 180 DAYS
PERMIT EXPIRES 9-6-81
UNLESS DRILLING UNDERWAY

Gas sales are not dedicated.

XC: NMOCD (6), TLS, Cen Rcds, Acctg, Hobbs Office, MEC, MAH, Partners, File

ABOVE SPACE DESCRIBE PROPOSED PROGRAM: IF PROPOSAL IS TO DEEPEN OR PLUG BACK, GIVE DATA ON PRESENT PRODUCTIVE ZONE AND PROPOSED NEW PRODUCTION ZONE. GIVE BLOWOUT PREVENTER PROGRAM, IF ANY.

I hereby certify that the information above is true and complete to the best of my knowledge and belief.

By R. E. Natch Title Regulatory Coordinator Date 2/25/81

(This space for State Use)

APPROVED BY W. A. Gressett TITLE SUPERVISOR, DISTRICT II DATE MAR 6 1981

CONDITIONS OF APPROVAL, IF ANY:

**NEW MEXICO OIL CONSERVATION COMMISSION
WELL LOCATION AND ACREAGE DEDICATION PLAT**

Form C-102
Supersedes C-128
Effective 1-1-65

All distances must be from the outer boundaries of the Section.

| | | | | | |
|---|-----------------------------------|--|-------------------------|---|----------------------|
| Operator Mesa Petroleum Co. | | | Lease Shannon | | Well No. 3 |
| Tract Letter G | Section 28 | Township 6 S | Range 24 E | County Chaves County | |
| Actual Footage Location of Well: | | | | | |
| 1980 feet from the North line and | | 1980 feet from the East line | | | |
| Ground Level Elev. 3865.9 | Producing Formation Abo | Pool Wildcat | | Dedicated Acreage: NE/4 160 Acres | |

- 1 Outline the acreage dedicated to the subject well by colored pencil or hachure marks on the plat below.
- 2 If more than one lease is dedicated to the well, outline each and identify the ownership thereof (both as to working interest and royalty).
- 3 If more than one lease of different ownership is dedicated to the well, have the interests of all owners been consolidated by communitization, unitization, force-pooling, etc?

☐ Yes ☐ No If answer is "yes," type of consolidation _____

If answer is "no," list the owners and tract descriptions which have actually been consolidated. (Use reverse side of this form if necessary.) _____

No allowable will be assigned to the well until all interests have been consolidated (by communitization, unitization, forced-pooling, or otherwise) or until a non-standard unit, eliminating such interests, has been approved by the Commission.

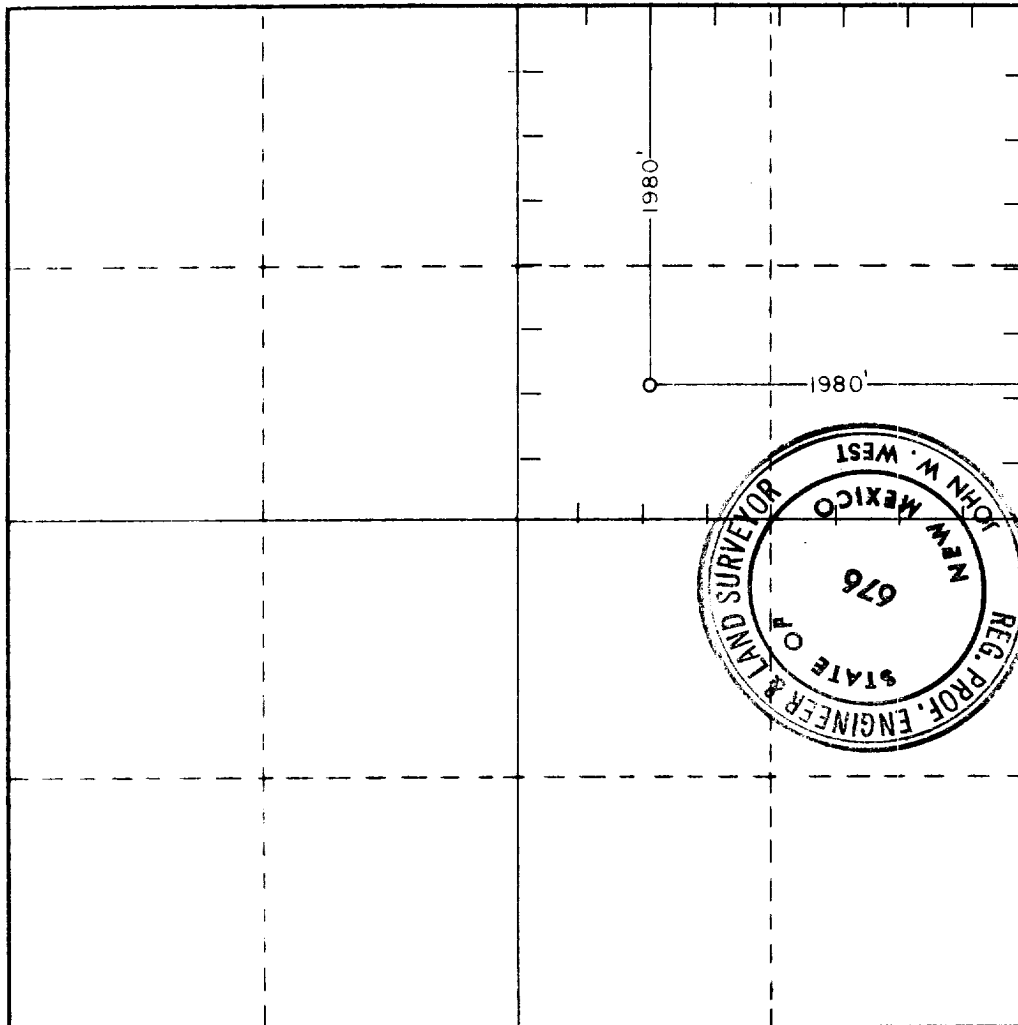

CERTIFICATION

I hereby certify that the information contained herein is true and complete to the best of my knowledge and belief.

R. E. Mathis

Name

R. E. Mathis

Position

Regulatory Coordinator

Company

Mesa Petroleum Co.

Date

2/25/81

I hereby certify that the well location shown on this plat was plotted from field notes of actual surveys made by me or under my supervision, and that the same is true and correct to the best of my knowledge and belief.

Date Surveyed

2-12-81

Registered Professional Engineer and/or Land Surveyor

John W. West

Certificate No. **JOHN W. WEST 676**
PATRICK A. ROMERO 6868
Ronald J. Eidson 3239

0 800 1000 1800 2000 2640 2810 3200 3600