

NEW MEXICO OIL CONSERVATION COMMISSION
WELL LOCATION AND ACREAGE LED OUT OF PLAT

All distances must be from the corner boundaries of the plat.

TRANSWESTERN GAS SUPPLY COMPANY			FIVEMILE TANK FEDERAL		3
Unit, letter	Section	Township	Range	County	
P	17	6-S	23-E	Chaves	
Actual Footage Location of Well:					
660 feet from the		EAST	line and	660 feet from the	SOUTH
Ground Level Elev.	Producing Formation		Pool	Dedicated Acreage:	
4117.0'	Abo		Undesignated Abo	160	

1. Outline the acreage dedicated to the subject well by colored pencil or hatchure marks on the plat below.
2. If more than one lease is dedicated to the well, outline each and identify the ownership thereof (both as to working interest and royalty). **Single Lease**
3. If more than one lease of different ownership is dedicated to the well, have the interests of all owners been consolidated by communitization, unitization, force-pooling, etc?

☐ Yes ☐ No If answer is "yes," type of consolidation _____

If answer is "no," list the owners and tract descriptions which have actually been consolidated. (Use reverse side of this form if necessary.) _____

No allowable will be assigned to the well until all interests have been consolidated (by communitization, unitization, forced-pooling, or otherwise) or until a non-standard unit, eliminating such interests, has been approved by the Commission.

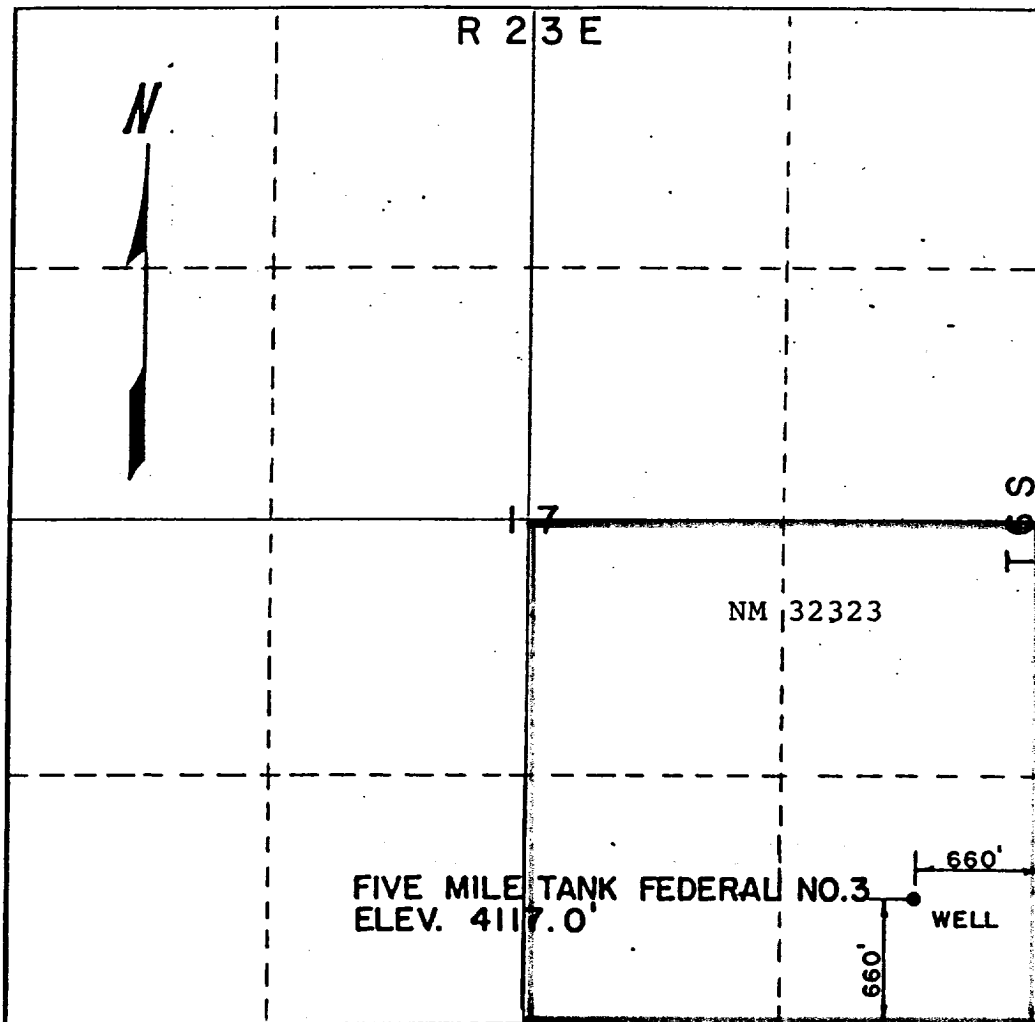

CERTIFICATION

I hereby certify that the information contained herein is true and complete to the best of my knowledge and belief.

Jerry N. Long
Name
JERRY N. LONG

Position
Agent

Company
TRANSWESTERN GAS SUPPLY CO.

Date
December 11, 1981

I hereby certify that the well location shown on this plat was plotted from field notes of actual surveys made by me or under my supervision, and that the same is true and correct to the best of my knowledge and belief.

REGISTERED PROFESSIONAL ENGINEER
December 11, 1981
Date Surveyed
HO: 277
Registered Professional Engineer
and/or Land Surveyor
Thomas T. Mann, P.E. & L.S.
N.M. License No. 277
Certificate No.